

Auxiliary Modules Solutions

SELECTOR GUIDE

APPLICATIONS:

- PTC heater
- DC / DC converter
- On-Board Charger (OBC)
- Electric AC
- Battery pack
- HV PDU



Application	Battery pack, DC / DC converter, On-Board Charger (OBC)			Splicing accessory loads
Product name	SHIELD-PACK™ HV280 2 WAY	SHIELD-PACK™ HV280 3 BAY HEADER*	SHIELD-PACK™ HV280 4 WAY	SHIELD-PACK™ HV280/630 SPLICE
Amperage at 85°C	40 A	40 A	40 A	40 A
Voltage	1000 V	1000 V	1000 V	1000 V
Orientation	90° 180°	180°	180°	180°
# of ways (power)	2	2	4	4
HVIL	✓	✓	✓	✓
Shielding	Individual	Individual	Individual	Individual
Vibration Class	V2	V2	V1	V1
Temperature Class	T3	T3	T3	T3
Sections power	2 - 5 mm²	2 - 5 mm²	3 - 5 mm²	3 - 5 mm²
Sections HVIL	0.5 mm²	0.5 mm²	0.5 - 0.75 mm²	0.5 - 0.75 mm²
See Page	12-13	14-15	16-17	18-19

* Please refer to this product for project with space constraints.

** Also compatible for individual cable shielding.

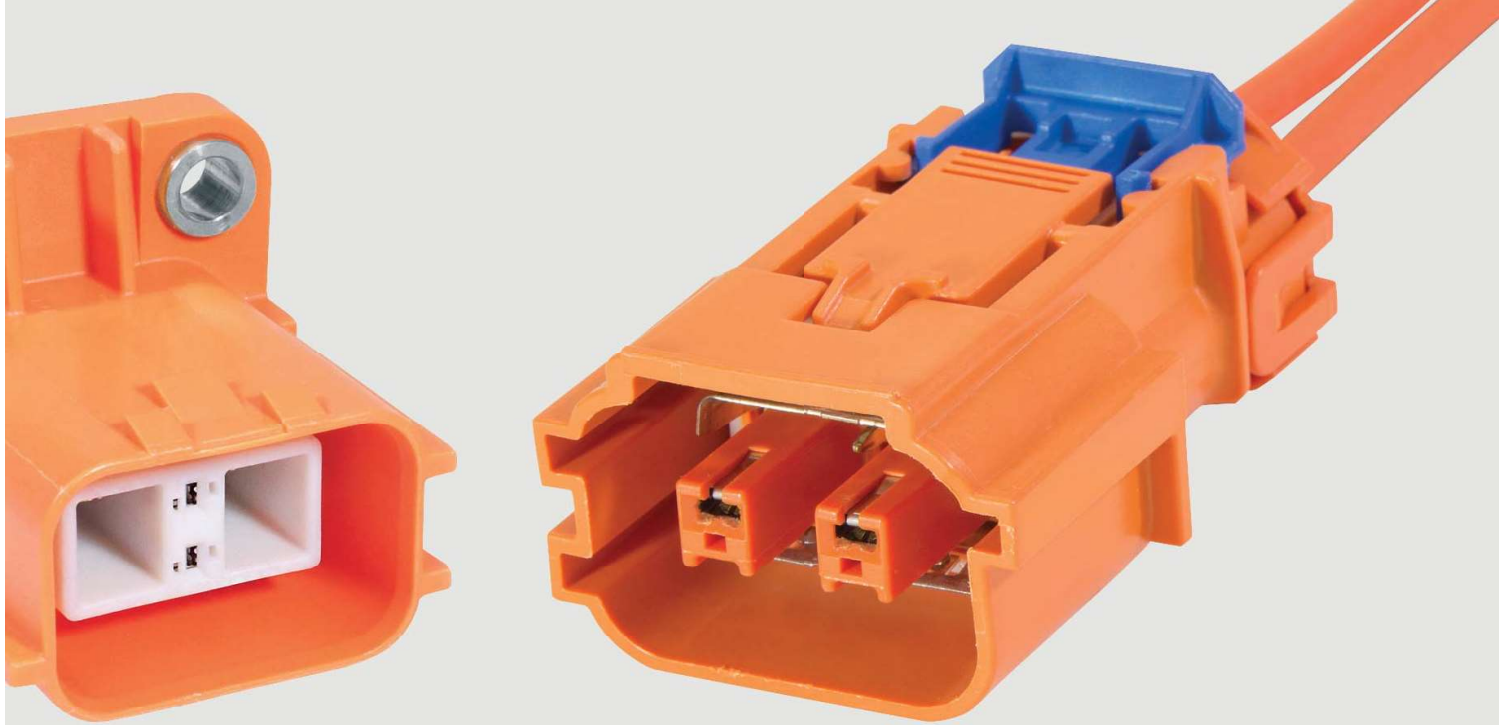

Battery pack, DC / DC converter, Electric AC, PTC heater, HV PDU, On-Board Charger (OBC)				On-Board Charger (OBC)	
SHIELD-PACK™ HV630	APEX® HV280	APEX® HV280 DIRECT MATE	SHIELD-PACK™ AK CLASS 1	16 & 32A ON-BOARD CHARGERS	APEX® 950 ON-BOARD CHARGER CONNECTOR
50 A	40 A	40 A	32 A	32 A	125 A
1000 V	1000 V	850 V	1000 V	600 V	750 V
180°	180°	180°	180°	180°	180°
2	2	2	2 & 3	4	4 + 1
×	✓	✓	✓	✓	✓
Individual	Bundle	Bundle**	Multicore	No	No
V2	V1	V2	V2	V1	V3
T3	T3	T3	T4	T3	T3
2 - 6 mm²	2.5 - 6 mm²	2.5 - 6 mm²	2.5 - 4.0 mm²	3 - 6 mm²	10 - 16 mm²
-	0.5 - 0.75 mm²	0.5 - 0.75 mm²	0.5 mm²	0.75 - 1.0 mm²	0.5 mm²
20-21	22-23	24-25	26-27	28-29	30-31

SHIELD-PACK™ HV280 2 WAY

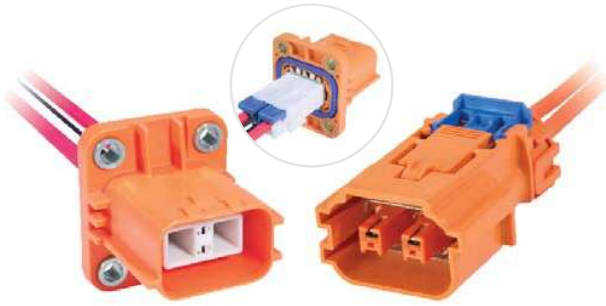

2 Way 180° Connection System
with Pluggable Inner Connector



2 Way 180° Connection System
without Pluggable Inner Connector



2 Way 90° Connection System

BENEFITS

- Inner connector with TPA can be plugged into header during device assembly (on wire-to-device)
- Industry-leading vibration performance
- Field proven design used across electrification market

FEATURES

- Tool-less unmating system
- Finger proof/touch safe
- Aluminum compression bushings
- ISO cable compatible

AVAILABLE CONFIGURATIONS

Connector Type	Wire-to-device, wire-to-wire
Cable Exit Orientation	90°, 180°
Cable Range (mm ²)	2 - 5 (power) 0.5 (HVIL)
Terminal Type	CTS 2.8, Metri-pack 2.8
# of Power Terminals	2
Shielding Type	Individual
HVIL	Shunt on female
Assembly Assurance	CPA/TPA
Number of Indexes	3 (180°), 1 (90°)

APPLICATIONS

Battery pack

DC / DC converter

On-board charger (OBC)

PERFORMANCE

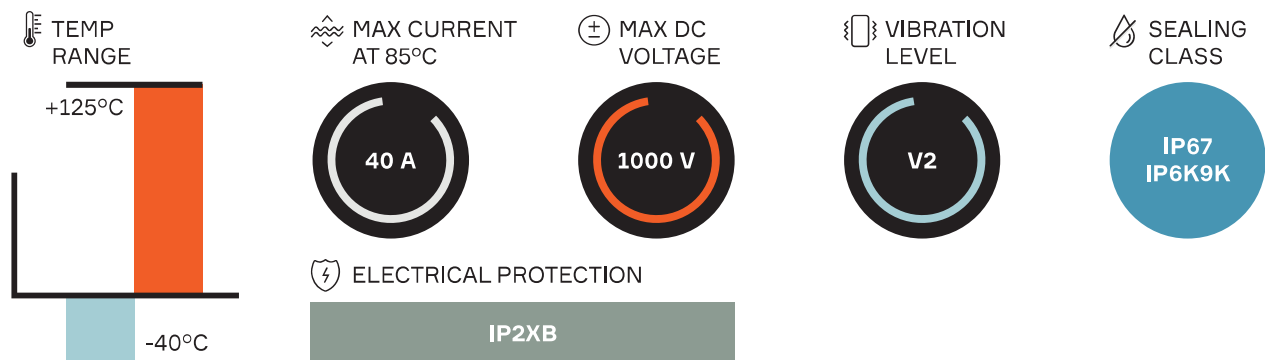

Index	Header with pluggable inner connector		Header	Male inline connector	Mating connector	BOM
	Outer Header	Inner connector				
2 Way 180° Connection System						
101	35201196	15526394	33240508	33358013	33339283	1
102	35201197	15526395	33240509	33358014	33353455	
103	35201198	15526396	33240510	33358015	33353456	
2 Way 90° Connection System						
101	33341078	33341079			33339283	1

ASSOCIATED PARTS

Part number	Decsription	BOM
Header		
13753470	Metri-pack 2.8 male terminal 1 - 2 mm ²	2
13753471	Metri-pack 2.8 male terminal 3 mm ²	
13790534	Metri-pack 2.8 male terminal 4 - 5 mm ²	
15432235	CTS HVIL female terminal 0.5 mm ²	2
15526390	TPA	1
Inline Male		
13753470	Metri-pack 2.8 male terminal 1 - 2 mm ²	2
13753471	Metri-pack 2.8 male terminal 3 mm ²	
13790534	Metri-pack 2.8 male terminal 4 - 5 mm ²	
13737699	Inner ferrule 3 mm ²	2
33292550	Inner ferrule 5 mm ²	
13737702	Outer ferrule 3 mm ²	2
33292551	Outer ferrule 5 mm ²	
15513453	Cable seal 3 mm ²	1
15513451	Cable seal 5 mm ²	1
13824779	TPA / strain relief 3 mm ²	1
13888072	TPA / strain relief 5 mm ²	1
Mating connector		
13882331	CTS 2.8 female terminal 3 - 5 mm ²	2
13737699	Inner ferrule 3 mm ²	2
33292550	Inner ferrule 5 mm ²	
13737702	Outer ferrule 3 mm ²	2
33292551	Outer ferrule 5 mm ²	
15513453	Cable seal 3 mm ²	1
15513451	Cable seal 5 mm ²	1
13824779	TPA / strain relief 3 mm ²	1
13888072	TPA / strain relief 5 mm ²	1

DIMENSION MEASUREMENT SAMPLE

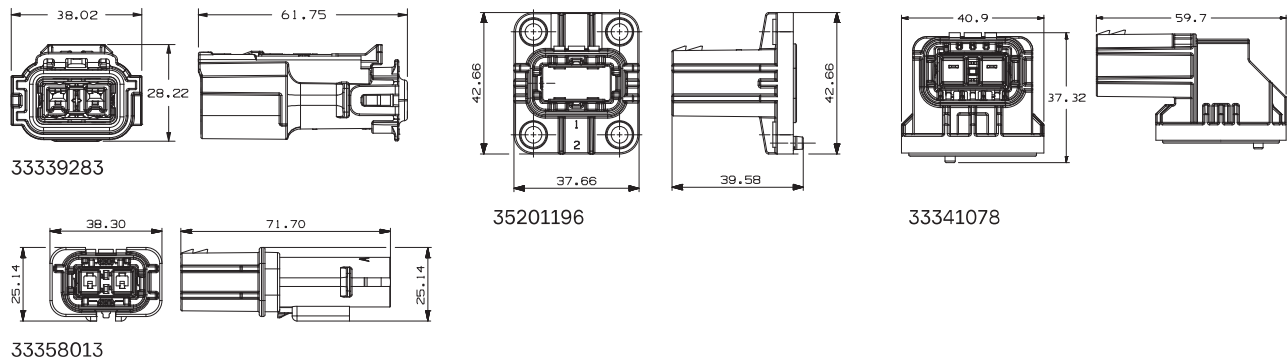

SHIELD-PACK™ HV280

3 BAY HEADER

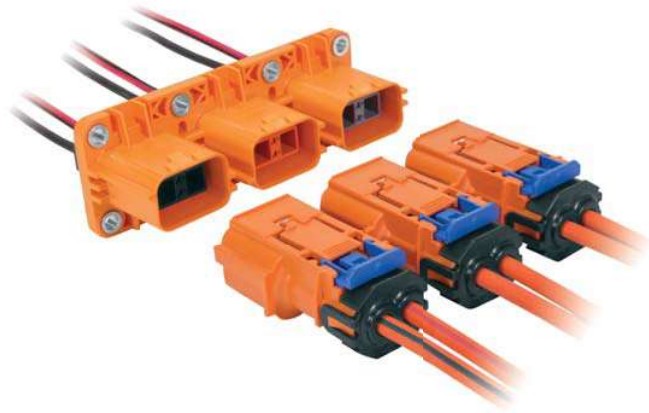

BENEFITS

- Answering to space constraints by having the 3 headers bolted together
- Inner connector with TPA can be plugged into header during device assembly (on wire-to-device)
- Industry-leading vibration performance
- Field proven design used across electrification market

FEATURES

- Tool-less unmating system
- Finger proof/touch safe
- Aluminum compression bushings
- ISO cable compatible

APPLICATIONS

Battery pack

DC / DC converter

On-board charger (OBC)

AVAILABLE CONFIGURATIONS

Connector Type	Wire-to-device
Cable Exit Orientation	180°
Cable Range (mm ²)	2 - 5 (power) 0.5 (HVIL)
Terminal Type	CTS 1.2, Metri-pack 2.8
# of Power Terminals	2
Shielding Type	Individual
HVIL	Shunt on female
Assembly Assurance	CPA/TPA
Number of Indexes	3

PERFORMANCE

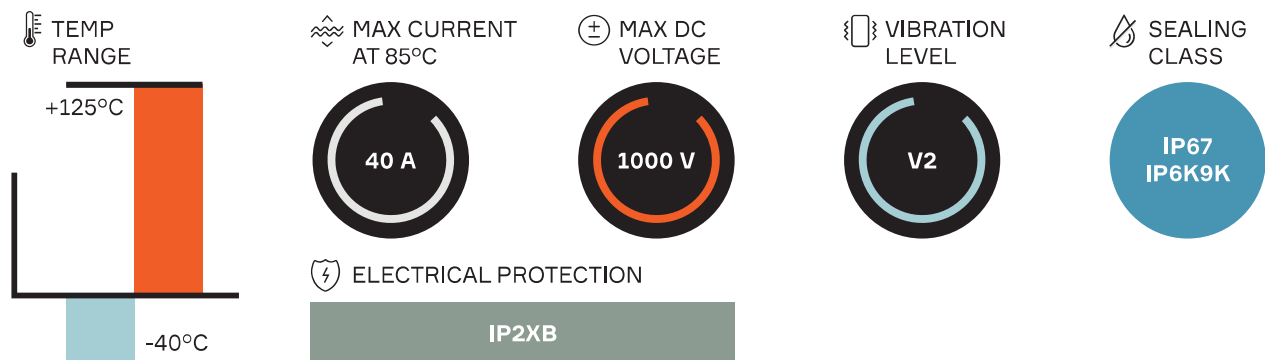

Index	Header outer	Header inner connector	Mating connector	BOM
103	33223976	15526396	33353456	1
104		15526397	33353457	
105		33137225	33353458	

ASSOCIATED PARTS

Part number	Decsription	BOM
Header		
13753470	Metri-pack 2.8 male terminal 1 - 2 mm ²	2
13753471	Metri-pack 2.8 male terminal 3 mm ²	
13790534	Metri-pack 2.8 male terminal 4 - 5 mm ²	
15432235	CTS HVIL female terminal 0.5 mm ²	2
15526390	TPA	1
Mating connector		
13882331	CTS 2.8 female terminal 3 - 5 mm ²	2
13737699	Inner ferrule 3 mm ²	2
33292550	Inner ferrule 5 mm ²	
13737702	Outer ferrule 3 mm ²	2
33292551	Outer ferrule 5 mm ²	
15513453	Cable seal 3 mm ²	1
15513451	Cable seal 5 mm ²	1
13824779	TPA / strain relief 3 mm ²	1
13888072	TPA / strain relief 5 mm ²	1

DIMENSION MEASUREMENT SAMPLE

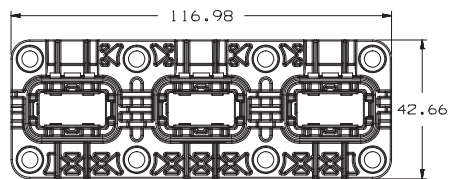

33223976

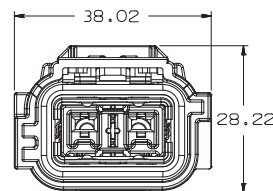
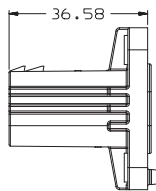

33353456

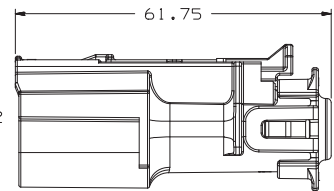

SHIELD-PACK™ HV280 4 WAY



BENEFITS

- No mechanical assist needed for mating
- Compact system design with integrated HVIL
- Robust error-proof assembly and system mating

FEATURES

- Tool-less unmating system
- Finger proof/touch safe
- 4 power circuits
- Panel mount to device with face seal (on wire-to-device)
- Aluminum compression bushings
- Internal HVIL (shunted in harness connector)
- ISO cable compatible

APPLICATIONS

Battery pack

DC / DC converter

On-board charger (OBC)

AVAILABLE CONFIGURATIONS

Connector Type	Wire-to-device
Cable Exit Orientation	180°
Cable Range (mm ²)	3 - 5 (power) 0.5 - 0.75 mm (HVIL)
Terminal Type	CTS 2.8
# of Power Terminals	4
Shielding	Individual
HVIL	Shunt on female
Assembly Assurance	CPA
Number of Indexes	2

PERFORMANCE

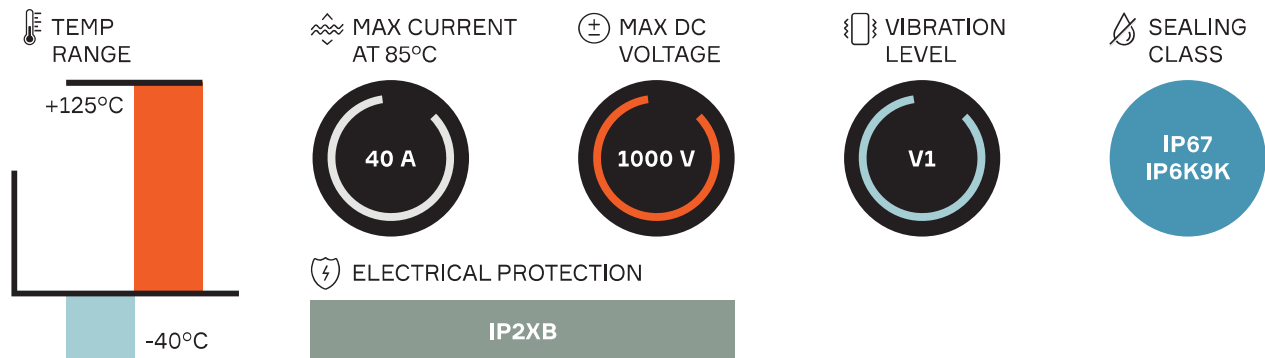

Index	Header outer	Header inner connector	Mating connector	BOM
101	35099959	35099976	33314147	1
102	35161787	35149737	33314148	

ASSOCIATED PARTS

Part number	Decsription	BOM
Header		
13597855	MTS 0.64 HVIL female terminal 0.5 - 0.75 mm	2
13753471	CTS 2.8 male terminal 3 - 5 mm ²	4
13790534	CTS 2.8 male terminal 4 - 5 mm ²	
33314145	TPA (Terminal Position Assurance)	2
Mating Connector		
13882331	CTS 2.8 female terminal 3 - 5 mm ²	4
13737699	Inner ferrule 3 mm ² ISO cable	4
33292550	Inner ferrule 5 mm ² ISO cable	
13737702	Outer ferrule 3 mm ² ISO cable	4
33292551	Outer ferrule 5 mm ² ISO cable	
35072736	3 mm ² ISO cable seal	1
35072735	5 mm ² ISO cable seal	
35072739	3 mm ² ISO cable seal cover	1
35072738	5 mm ² ISO cable seal cover	

DIMENSION MEASUREMENT SAMPLE

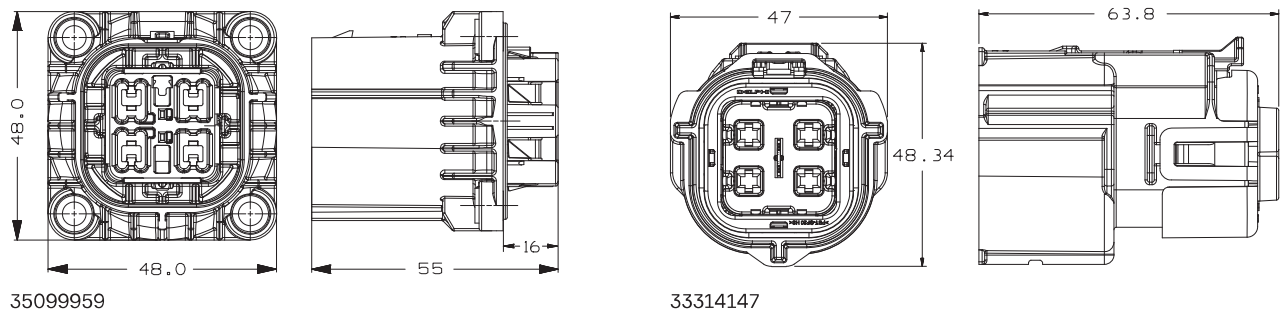

SHIELD-PACK™ HV280/630

SPLICE



BENEFITS

- Removes splices from the wiring harness and integrates splicing capabilities into connector
- No mechanical assist needed for mating

FEATURES

- Tool-less unmating system
- Finger proof/touch safe
- Panel mount to device with face seal
- Aluminum compression bushings
- Internal HVIL (shunted in harness connector)
- ISO cable compatible

APPLICATIONS

Splicing accessory loads

AVAILABLE CONFIGURATIONS

Connector Type	Wire-to-device
Cable Exit Orientation	180°
Cable Range (mm²)	3 - 5 (power) 0.5 - 0.75 (HVIL)
Terminal type	CTS 2.8(2) / 6.3(2)
# of Power Terminals	4
Shielding	Individual
HVIL	Shunt on female
Assembly Assurance	CPA
Number of Indexes	2

PERFORMANCE

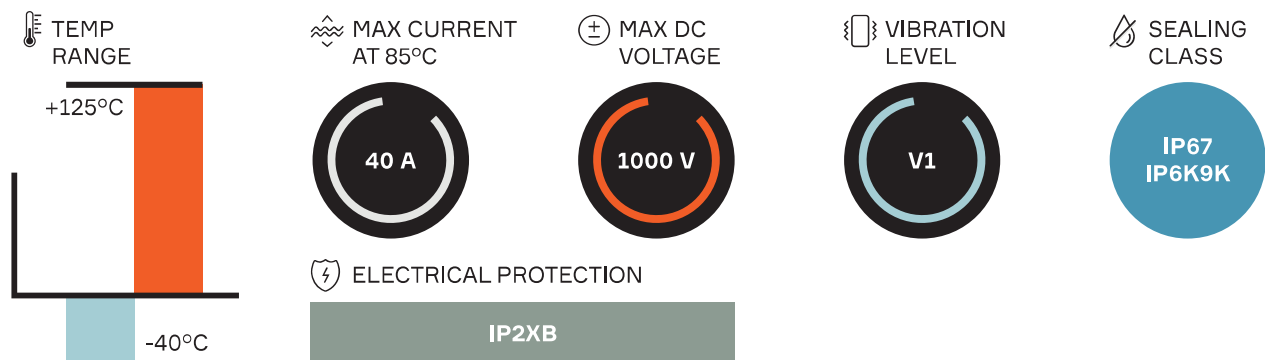

Index	Header outer	Header inner connector	Mating connector	BOM
101	33300632	33311166	33300634	1
102	33300633	33311167	33300635	

ASSOCIATED PARTS

Part number	Description	BOM
Header		
13597855	MTS 0.64 HVIL female terminal 0.5 - 0.75 mm	2
33299800	630/280 male terminal 3 - 5 mm ²	2
33299799	TPA (Terminal Position Assurance)	2
Mating Connector		
13882331	CTS 2.8 female terminal 3 - 5 mm ²	2
13984302	CTS 6.3 female terminal 2.5 - 4 mm ²	2
13984307	CTS 6.3 female terminal 4 - 6 mm ²	
13737699	Inner ferrule 3 mm ² ISO cable	4
33292550	Inner ferrule 5 mm ² ISO cable	
13737702	Outer ferrule 3 mm ² ISO cable	4
33292551	Outer ferrule 5 mm ² ISO cable	
35072736	3 mm ² ISO cable seal	1
35072735	5 mm ² ISO cable seal	
35072739	3 mm ² ISO cable seal cover	1
35072738	5 mm ² ISO cable seal cover	

APPLICATION GUIDE

Power circuits shown,
two sets of 2 in x 1 out

Application Guide for Aptiv 4W CTS 630/280 Shielded Connection
Typical Application – * Load Current Guidance



Terminal crimp wings are shown un-crimped.

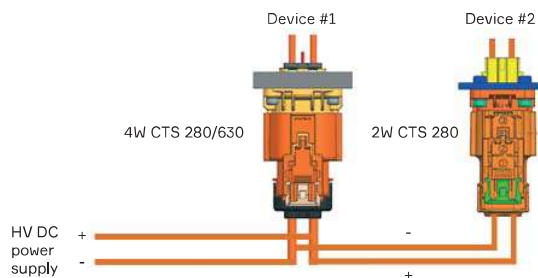

*** Typical steady state currents with 5 mm² cable on all circuits**

Input from DC power supply: 40 - 45 A
Current to Device #1: ≤ 40 A
Current to Device #2: ≤ 30 A

** Connector current ratings in vehicle applications will be affected by multiple factors including device heating, harness coverings, and device duty cycles. Please review application details with Aptiv Product Engineering for verification of current carrying capability.*

DIMENSION MEASUREMENT SAMPLE

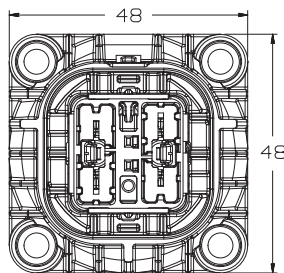

33300632

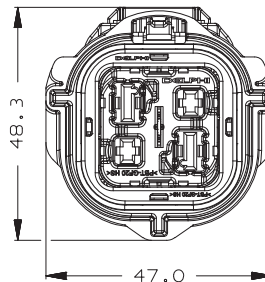
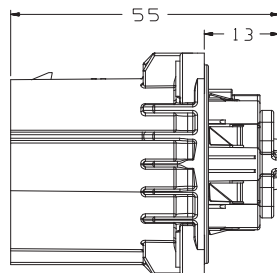

33300634

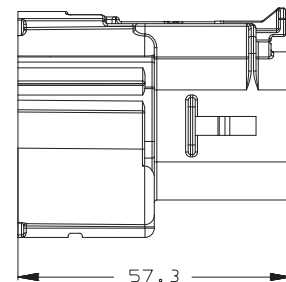

SHIELD-PACK™ HV630



HV630 Header and Mating connector*

BENEFITS

- Inner connector with TPA can be plugged into header during device assembly (on wire-to-device)
- Industry's most compact 630 2 way system
- Industry leading vibration performance
- External header housing is the same for the HV280 and HV630

FEATURES

- Tool-less unmating system
- Finger proof/touch safe
- Panel mount to device with face seal (on wire-to-device)
- Aluminum compression bushings
- ISO cable compatible
- Secondary terminal locking

APPLICATIONS

Battery pack

DC / DC converter

On-board charger (OBC)

AVAILABLE CONFIGURATIONS

Connector Type	Wire-to-device, wire-to-wire
Cable Exit Orientation	180°
Cable Range (mm ²)	3 - 6 (power)
Terminal Type	CTS 6.3
# of Power Terminals	2
Shielding Type	Individual
HVIL	None
Assembly Assurance	TPA (wire-to-device) CPA (wire-to-wire)
Number of Indexes	3 (wire-to-device) 3 (wire-to-wire)

* Mating connector is most commonly available with the natural beige color

PERFORMANCE

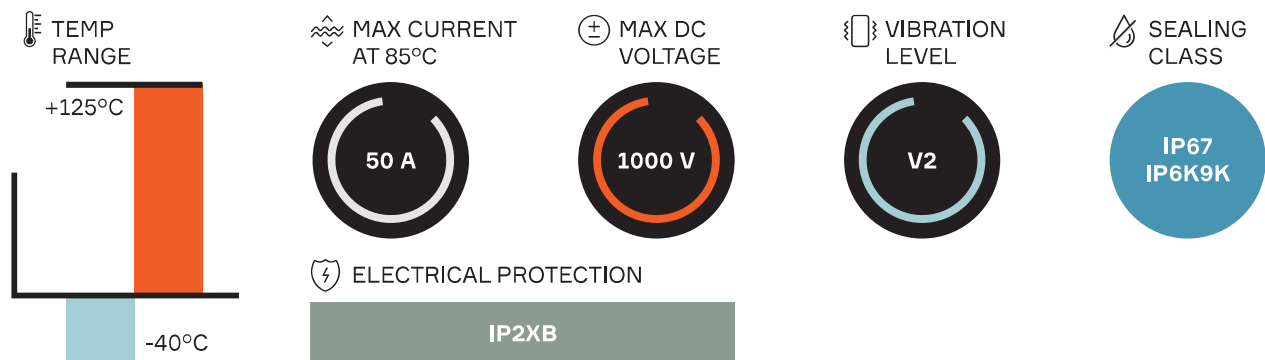

Index	Header outer	Header inner connector	Inline connector	Mating connector	BOM
101	35201196	35028833	35201706	35028839	1
102	35201197	35028834	35201707	35028840	
103	35201198	35028835	35201708	35028841	

ASSOCIATED PARTS

Part number	Description	BOM
Header		
33375907	2.4 - 3.4 cable OD 3 - 6 mm ²	2
35028830	TPA (Terminal Position Assurance)	1
Inline connector		
35063063	4.8 male terminal	2
Mating connector		
13737699	Inner ferrule 3 mm ² cable	2
13737700	Inner ferrule 4 mm ² cable	
33292550	Inner ferrule 5 mm ² & 6 mm ² cable	
13737702	Outer ferrule 3 mm ² & 4 mm ² cable	2
33292551	Outer ferrule 5 mm ² & 6 mm ² cable	
13824779	Seal retainers 3 mm ² & 4 mm ² cable	
13888072	Seal retainers 5 mm ² & 6 mm ² cable	1
15513453	Cable seal 3 mm ² cable	1
15513452	Cable seal 4 mm ² cable	
15513451	Cable seal 5 mm ² & 6 mm ² cable	

DIMENSION MEASUREMENT SAMPLE

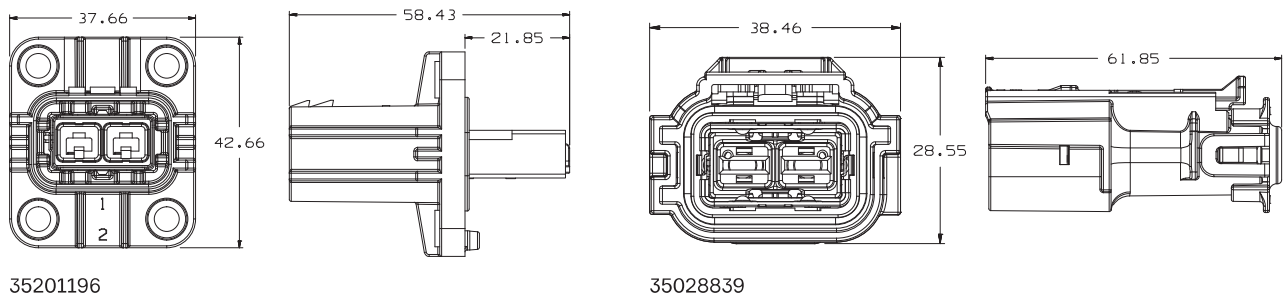

APEX[®] HV280



BENEFITS

- Two-stage disconnect for safe unmating
- Compact package with unique integrated electric interlock
- Header is sealed in both mated and unmated position

FEATURES

- Bundle shielding with external braid
- HVIL shunted in harness connector

APPLICATIONS

Battery pack

DC / DC converter

On-board charger (OBC)

AVAILABLE CONFIGURATIONS

Connector Type	Wire-to-device
Cable Exit Orientation	180°
Cable Range (mm ²)	2.5 - 6 (power) 0.5 - 0.75 (HVIL)
Terminal Type	Apex [®] 2.8
# of Power Terminals	2
Shielding	Bundle
HVIL	Shunt on female
Assembly Assurance	CPA
Number of Indexes	2

PERFORMANCE

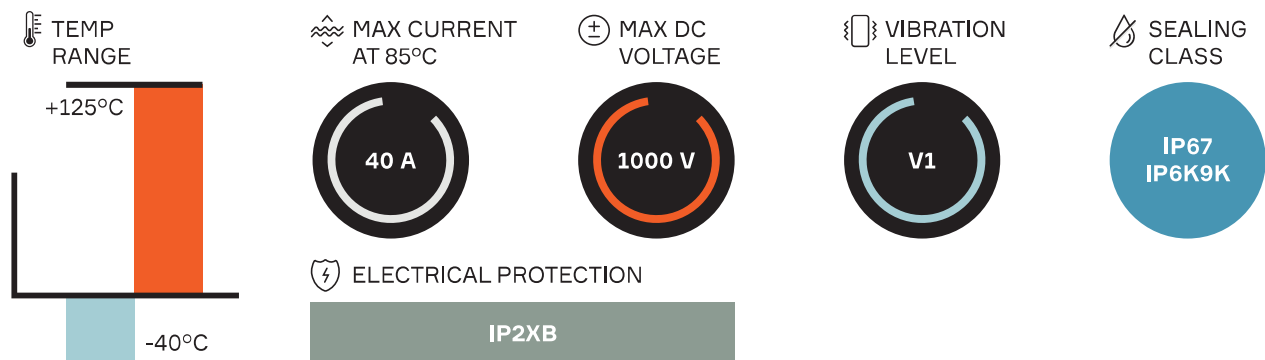

Index	Header connector	Mating connector	BOM
101	33511766	33517428	1
102	33511767	33511765	

ASSOCIATED PARTS

Part number	Description	BOM
Header		
15509074	APEX® 2.8 male terminal 2.5 mm²	2
15516298	APEX® 2.8 male terminal 4 - 6 mm²	
33511802	DCS2 1.5 male terminal gold-plated 0.22 - 0.35 mm²	2
10779703	DCS2 1.5 male terminal gold-plated 0.5 - 1.0 mm²	
Mating connector		
13627267	APEX® 2.5 mm²	2
10810733	APEX® 4 - 6 mm²	
Seals		
33512180	Header and mating: APEX® 2.8 female & male single wire seal 2.5 mm²	2
33512175	Header and mating: APEX® 2.8 female & male single wire seal red 4 mm²	
35289308	Header and mating: APEX® 2.8 female & male single wire seal 6 mm²	
15441379	Header: DCS/DSQ 1.5 red single wire seal 0.22 - 0.5 mm²	2
15441380	Header: DCS/DSQ 1.5 grey single wire seal 0.75 - 1.0 mm²	

DIMENSION MEASUREMENT SAMPLE

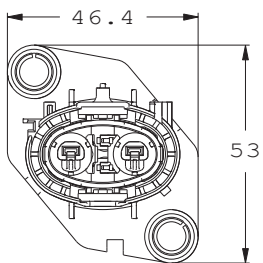

33511766

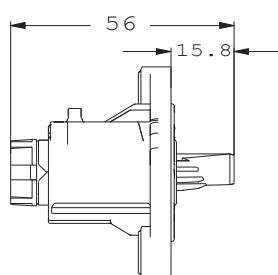

33517428

APEX[®] HV280 DIRECT MATE

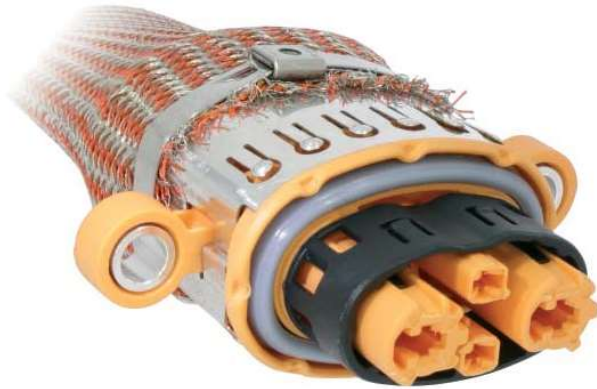

BENEFITS

- Same connector for both bundle and individual cable shielding
- Cost effective solution thanks to the direct connection between the female connector and the male terminals within the device case
- High EMC & RFI shielding performance with direct connection to metal device case

FEATURES

- Two HV power circuits (APEX[®] 2.8 mm terminal)
- Bundle shielding with external braid in serial production
- Individual cable shielding version available by request
- Integrated HVIL (HV interlock line)

APPLICATIONS

Battery pack

DC / DC converter

On-board charger (OBC)

AVAILABLE CONFIGURATIONS

Connector Type	Wire-to-device
Cable Exit Orientation	180°
Cable Range (mm ²)	2.5 - 6 (power) 0.5 - 0.75 (HVIL)
Terminal Type	APEX [®] 2.8
# of Power Terminals	2
Shielding	Bundle (also compatible for individual cable shielding)
HVIL	Pass-through or shunt on header
Assembly Assurance	None (screwed)
Number of Indexes	1

PERFORMANCE

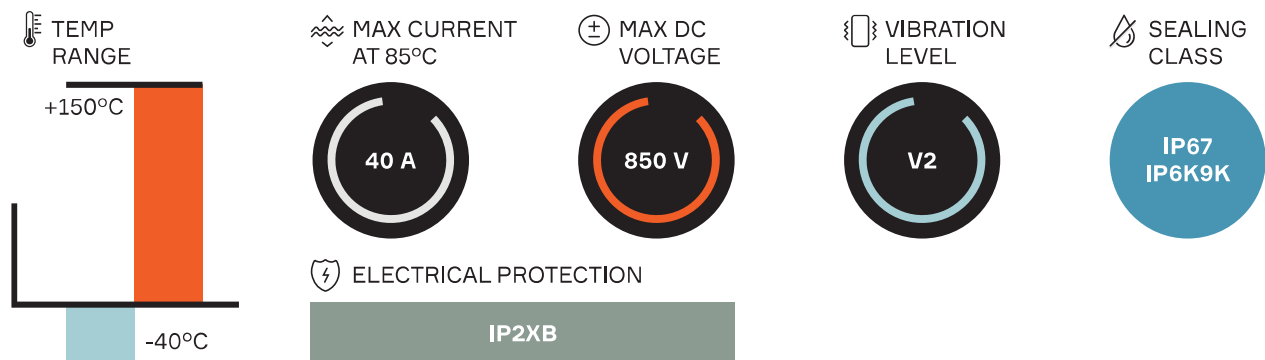

Header connector	Mating connector	BOM
Not needed (mates directly to device)	35208936	1

ASSOCIATED PARTS

Part number	Description	BOM
Mating connector		
15509074	APEX® 2.8 female terminal 2.5 mm²	2
15516298	APEX® 2.8 female terminal 4 - 6 mm²	
13834764	Single wire seal 3.4 - 4.4 mm	2
35206690	Cable strain relief	2
15549847	DSQ 1.5 female terminal silver-plated 0.35 - 0.5 mm²	2
15549848	DSQ 1.5 female terminal silver-plated 0.75 - 1.0 mm²	
15441379	DCS 1.5 red single wire seal 0.35 - 0.5 mm²	2
15441380	DCS 1.5 grey single wire seal 0.75 - 1 mm²	

DIMENSION MEASUREMENT SAMPLE

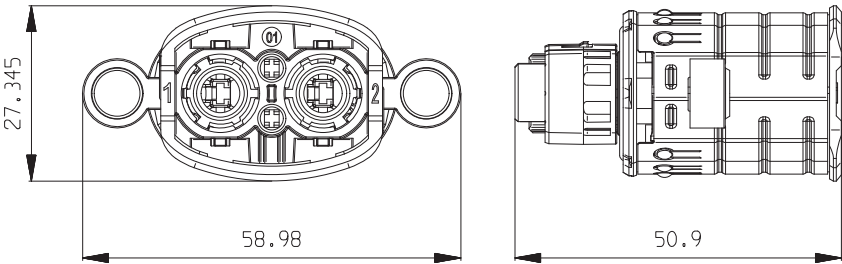

35208936

SHIELD-PACK™ AK CLASS 1 AK



BENEFITS

- Standard AK interface
- High vibrations and operating temperatures
- Multiple layouts & HVIL options in the same interface

FEATURES

- Designed according to AK interface specification and LV215 latest revision
- Finger proof/touch safe
- Multicore shielded cable for wiring simplification
- Fully interchangeable with other AK supplier sources

APPLICATIONS

Battery pack

DC / DC converter

Electric AC

PTC heater

HV PDU

On-board charger (OBC)

AVAILABLE CONFIGURATIONS

Connector Type	Wire-to-device
Cable Exit Orientation	180°
Cable Range (mm²)	2.5 - 4.0 (power) 0.5 - 0.75 (HVIL)
Terminal Type (mm)	2.8
# of Power Terminals	2
Shielding	Multicore
HVIL	Shunt on female or inline
Assembly Assurance	CPA/TPA
Number of Indexes	5

PERFORMANCE

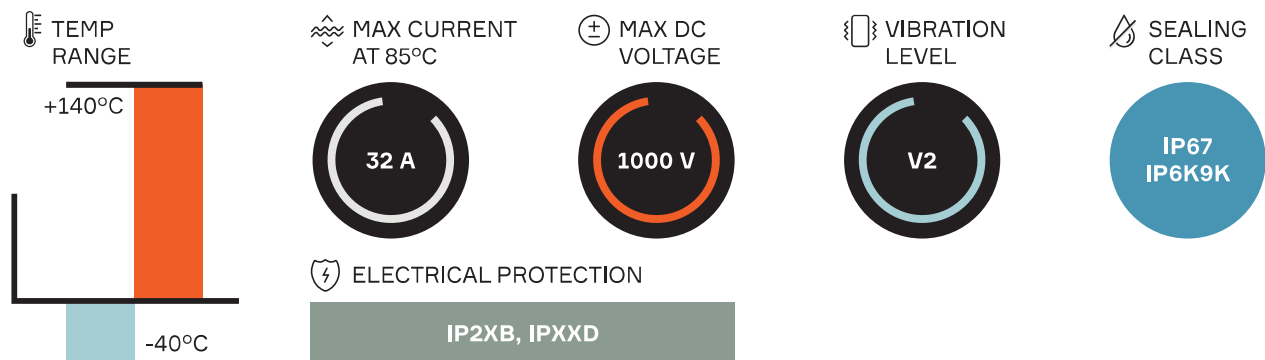

Code	Header 2 way	Header 3 way	Mating outer housing	BOM
A	35149836	35149842	33372017	1
B	35149837	35149843	33372014	
C	35149838	35149844	33372016	
D	35149839	35149845	33372015	
E	35149840	35149846	35061103	

ASSOCIATED PARTS

Part number	Decsription	BOM		
		2 way, HVIL pass-through	2 way, HVIL shunt	3 way
Header				
35194900	DCS-2 2.8 male terminal 2.5-4 mm² Ag	2	2	3
35149868	HVIL terminal 0.5 - 0.75	2	2	-
35149869	TPA (Terminal Position Assurance)	1	1	-
15540356	TPA (Terminal Position Assurance)	-	-	1
Mating Connector				
33514302	DCK 2.8 female terminal 2.5 mm² Ag	2	2	3
33522728	DCK 2.8 female terminal 4 mm² Ag or*			
13799603	CTS 2.8 female terminal 2.5 mm² Ag			
13882331	CTS 2.8 female terminal 4 mm² Ag			
33504709	Male duo twin 0.64 0.5 mm²	2	2	-
35174268	Spacer	1	1	1
35174446	Shielding	2	2	2
35174249	Cable strain relief 3 x 2.5 mm²	-	-	1
35174250	Cable seal 3 x 2.5 mm²	-	-	1
35174511	Inner housing 2 way	1	-	-
35174507	Cable strain relief 2 x 4.0 mm²	-	1	-
35174508	Cable seal 2 x 4.0 mm²	1	1	-
35174280	Inner ferrule	1	1	1
35174278	Outer ferrule	1	1	1
35174509	Inner housing sub-assembly	-	1	-
35174448	Inner housing 3 way	-	-	1
35174513	TPA (Terminal Position Assurance)	1	-	-
35174510	Cable strain relief 2 x 4.0 + 2 x 0.5 mm²	1	-	-

* Both DCK terminals and CTS terminals are compatible.

Component Kits**

Part number	Description (pass-through version)	Part number	Description (shunted version)
35122237	2 x 4 mm ² + 2 x 0.5 mm ² cable code A	33367712	2 x 4 mm ² cable code A
35122238	2 x 4 mm ² + 2 x 0.5 mm ² cable code B	35122240	2 x 4 mm ² cable code B
33367711	2 x 4 mm ² + 2 x 0.5 mm ² cable code C	35122241	2 x 4 mm ² cable code C
35122239	2 x 4 mm ² + 2 x 0.5 mm ² cable code D	33367710	2 x 4 mm ² cable code D
35086591	2 x 4 mm ² + 2 x 0.5 mm ² cable code E	35086590	2 x 4 mm ² cable code E

** Available configurations with associated BOM (Bill Of Materials).

DIMENSION MEASUREMENT SAMPLE

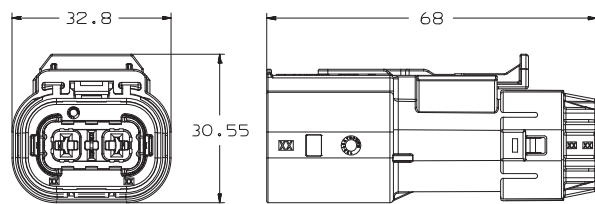

33367712

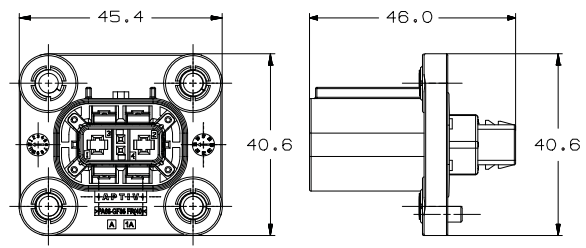

35149836

16 & 32A ON-BOARD CHARGERS



BENEFITS

- Field proven technology widely used across electrification market
- Configurable for both 1-phase and 3-phase applications
- Compact packaging

FEATURES

- Finger proof/touch safe
- Capability for 4 power circuits and 2 signal circuits
- Unshielded system with terminal spacing for HV applications
- One-stage locking system with CPA
- Aluminum compression bushings

APPLICATIONS

On-board charger (OBC)

AVAILABLE CONFIGURATIONS

Connector Type	Wire-to-device, wire-to-wire
Cable Exit Orientation	180°
Cable Range (mm ²)	3 - 5 (power) 0.75 - 1.0 (HVIL)
Terminal Type	HES 1.0 (signal) HES 2.4 (power)
# of Power Terminals	4 (2 signal terminals)
Shielding Type	Unshielded
HVIL	None
Assembly Assurance	CPA
Number of Indexes	2

PERFORMANCE

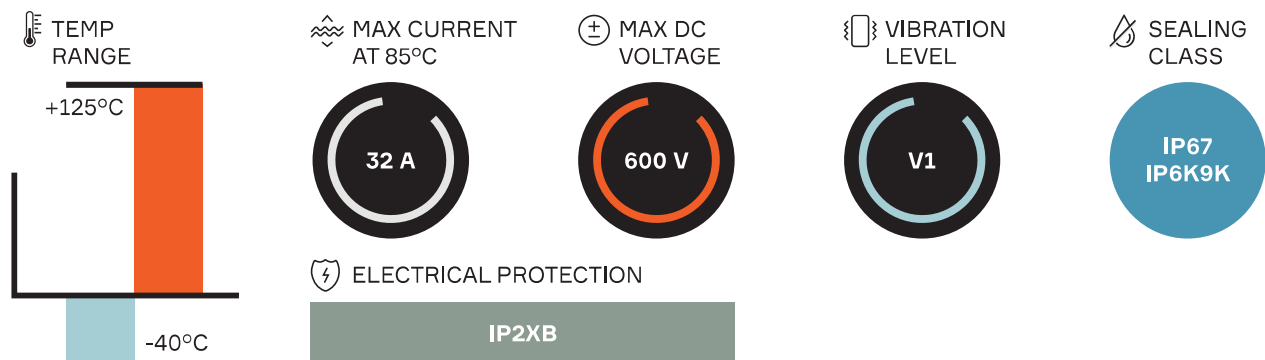

6 Way Device Connection System

Header connector	Mating connector		BOM
	16A	32A	
33229378	13879051 (2+2)	13879048 (2+2)	1
	15525754 (3+0)	15525753 (3+0)	
	13879050 (3+2)	13879047 (3+2)	
	13879049 (4+2)	13879046 (4+2)	

6 Way Inline Connection System

Male inline 16A	Male inline 32A	Mating connector	
		16A	32A
13990593 (2+2)	13990590 (2+2)	13879051 (2+2)	13879048 (2+2)
13990591 (4+2)	13990588 (4+2)	13879049 (4+2)	13879046 (4+2)

ASSOCIATED PARTS

Part number	Description	BOM
Header / Male inline		
13663724	1.0 HES gold-plated 0.75 - 1.0 mm²	2 or 4
13783283	2.4 HES gold-plated 2 - 3 mm²	2, 3, or 4
13783284	2.4 HES gold-plated 4 - 5 mm²	
Mating connector		
13663728	1.0 HES gold-plated 0.75 - 1.0 mm²	2 or 4
13783300	2.4 HES gold-plated 2 - 3 mm²	2, 3, or 4
13783301	2.4 HES gold-plated 4 - 5 mm²	

DIMENSION MEASUREMENT SAMPLE

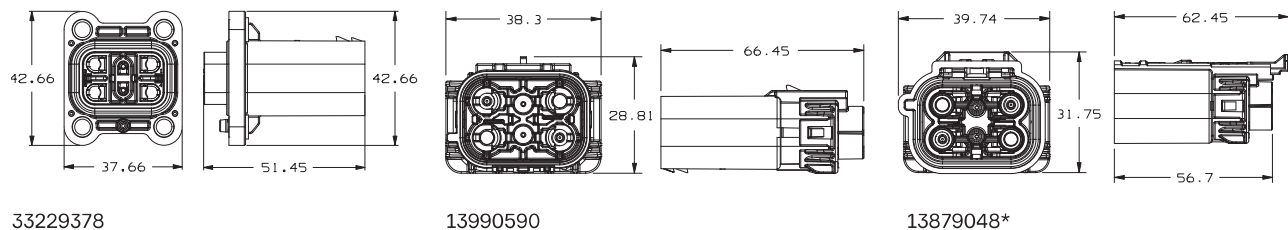

* Female connector is compatible with both device & inline male connectors.

Part numbers, specifications, dimensions and performance data in this document are for general references only and are subject to change without notice. To verify product information, please contact an Aptiv representative.



APEX[®] 950 ON-BOARD CHARGER CONNECTOR



BENEFITS

- Header is sealed in mated or unmated position
- Unshielded 4 + 1 way to connector designed for on-board chargers up to 125A 3-phase
- Panel mount to device with face seal to module

FEATURES

- Unique integrated electric interlock
- HVIL shunted in harness connector
- ErgoMate™ slider for easy handling and reduced mating force

APPLICATIONS

On-board charger (OBC)

AVAILABLE CONFIGURATIONS

Connector Type	Wire-to-device
Cable Exit Orientation	180°
Cable Range (mm ²)	10 - 16 (power) 0.5 (HVIL)
Terminal Type	9.5
# of Terminals	4 (9.5) + 1 (2.8)
Shielding Type	Unshielded
HVIL	Shunt on female
Assembly Assurance	CPA
Number of Indexes	1

PERFORMANCE

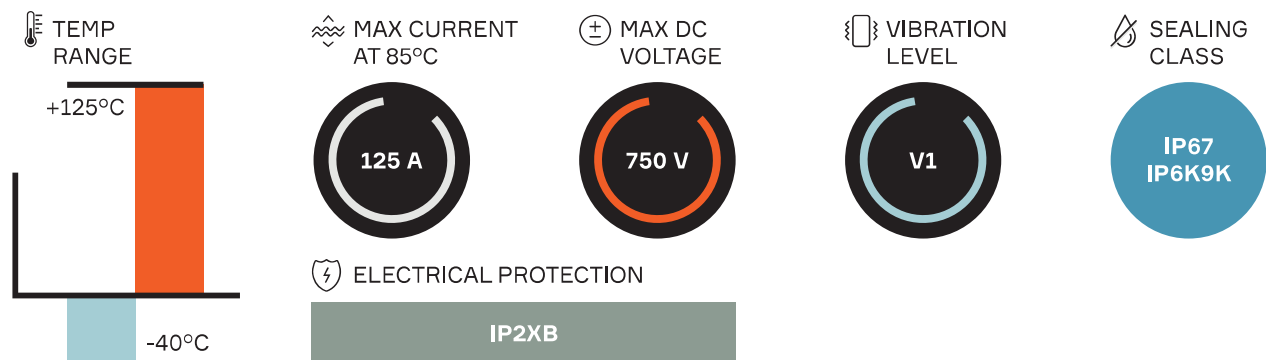

Header connector	Mating connector	BOM
33402137	33402139	1

ASSOCIATED PARTS

Part number	Description	BOM
Header		
33514386	APEX® 950 10 - 16 mm ²	4
15516298	APEX® 2.8 4 mm ²	1
10779703	DCS2 1.5 male terminal gold-plated 0.5 - 1.0 mm ²	2
Mating connector		
33514387	APEX® 950 10 - 16 mm ²	4
10810733	APEX® 2.8 4 mm ²	1
Seals		
33503295	Header and mating: APEX® 950 yellow single wire seal 16 mm ²	4
33503294	Header and mating: APEX® 950 blue single wire seal 10 mm ²	
33512175	Header and mating: APEX® 2.8 red single wire seal 4 mm ²	1
15441379	Header and mating: APEX® DCS 1.5 red single wire seal 0.22 - 0.5 mm ²	2

DIMENSION MEASUREMENT SAMPLE

