











# Rotary Switches

## Product Selection Guide

<b>Rotary</b>										
<b>Series</b>	<b>A</b>	<b>RTA</b>	<b>M</b>	<b>RBP12</b>	<b>RTBH</b>	<b>RTBV</b>	<b>R</b>	<b>F</b>	<b>H</b>	<b>P</b>
<b>Switch Type</b>	Multi-pole/ Multi-position	Multi-pole/ Multi-position	Half-inch	Multi-pole/ Multi-position	Right-angle Sealed	Right-angle Sealed	Rota-slide	Rota-slide	Power Rota-slide	Key Switch
<b>Miniature</b>		•		•				•		
<b>Low Profile</b>				•				•		•
<b>Screwdriver Slot</b>	•	•		•	•	•	•	•		
<b>Illumination</b>										
<b>Power</b>									•	
<b>Maximum Current</b>	2.5 Amps	150 mA	6 Amps	130 nA			5 Amps	4 Amps	12 Amps	4 Amps
<b>Momentary</b>										•
<b>Poles</b>	1-4	1-4	1 & 2	1-6			1 & 2	1 & 2	1 & 2	1 & 2
<b>Indexing</b>	30°, 45°, 90°		30° & 36°		15,22,5,36		36°	45° & 90°	45° & 90°	45° & 90°
<b>Splashproof</b>	•		•		•	•				
<b>Sealed</b>					•	•				
<b>Non-shorting/ Shorting Contacts</b>	•		•	•						
<b>Panel Mount Options</b>										
Front Mount										•
Rear Mount	•	•	•		•	•	•	•	•	
<b>PCB Mount Options</b>										
Vertical	•	•	•	•		•	•	•		•
<b>Terminations</b>										
Solder Lug	•	•	•				•	•	•	•
Wire Lead							•	•	•	•
Quick Connect										
PC	•	•	•	•	•	•	•	•		
<b>Page No.</b>	L-3	L-8	L-13	L-18	L-22	L-28	L-34	L-37	L-41	L-44

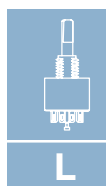

Rotary

# Rotary

A Series  
1-4 Pole Rotary Switches

SWITCH FUNCTION

30° INDEXING			
NO. POLES	MODEL NO.	SWITCH FUNCTION	TERMINALS
SP	A100	12 Position No Stops	A,1-12
	A102	SPDT	A,1,2*
	A103	3 Position	A,1-3*
	A104	4 Position	A,1-4*
	A105	5 Position	A,1-5*
	A106	6 Position	A,1-6*
	A107	7 Position	A,1-7
	A108	8 Position	A,1-8
	A109	9 Position	A,1-9
	A110	10 Position	A,1-10
	A112	12 Position	A,1-12
DP	A203	3 Position	A,C,1-3,7-9
	A204	4 Position	A,C,1-4,7-10
	A205	5 Position	A,C,1-5,7-11
	A206	6 Position	A,C,1-12
3P	A303	3 Position	A,B,C,1-3,5-7 9-11
	A304	4 Position	A,B,C,1-12

SP MODELS SCHEMATIC

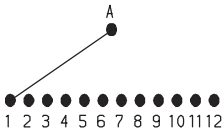

DP MODELS SCHEMATIC

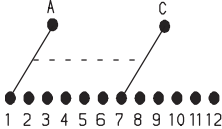

3P MODELS SCHEMATIC

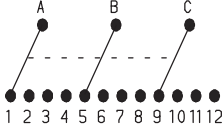

4P MODELS SCHEMATIC

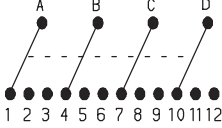

30° INDEXING			
NO. POLES	MODEL NO.	SWITCH FUNCTION	TERMINALS
4P	A402	4PDT	A,B,C,D,1,2,4,5,7, 8,10,11
	A403	3 Position	All Terminals

45° INDEXING			
NO. POLES	MODEL NO.	SWITCH FUNCTION	TERMINALS
SP	A115	3 Position	A,1,2,4*
	A125	8 Position	A,1,2,4,5,7,8,10,11

90° INDEXING			
NO. POLES	MODEL NO.	SWITCH FUNCTION	TERMINALS
SP	A114	2 Position	A,1,4*
	A124	4 Position	A,1,4,7,10
DP	A214	2 Position	A,C,1,4,7,10

TERMINAL NUMBERS

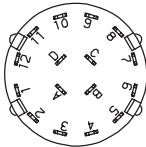

Terminal numbers molded on bottom of housing.

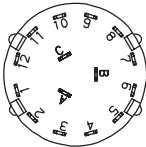

3P MODELS

4P MODELS  
SP MODELS (omit terminals B, C & D)  
DP MODELS (omit terminals B & D)

NOTE: \* These models with 'C' or 'MC' terminations have additional terminal no. 9 as switch support only. This terminal is not connected electrically inside switch.

All models with all options when ordered with 'G' or 'Q' contact material, see page L-6.

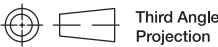
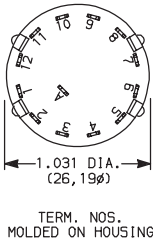
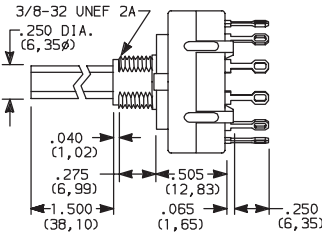
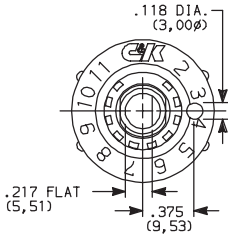

Dimensions are shown: Inch (mm)  
Specifications and dimensions subject to change

www.ck-components.com

# A Series 1-4 Pole Rotary Switches

## ACTUATOR

**15** 1.500" HIGH    **03** .375" HIGH    **05** .500" HIGH    **14** 1.500" HIGH    **42** 1.654" METRIC    **S1** SCREWDRIVER SLOT

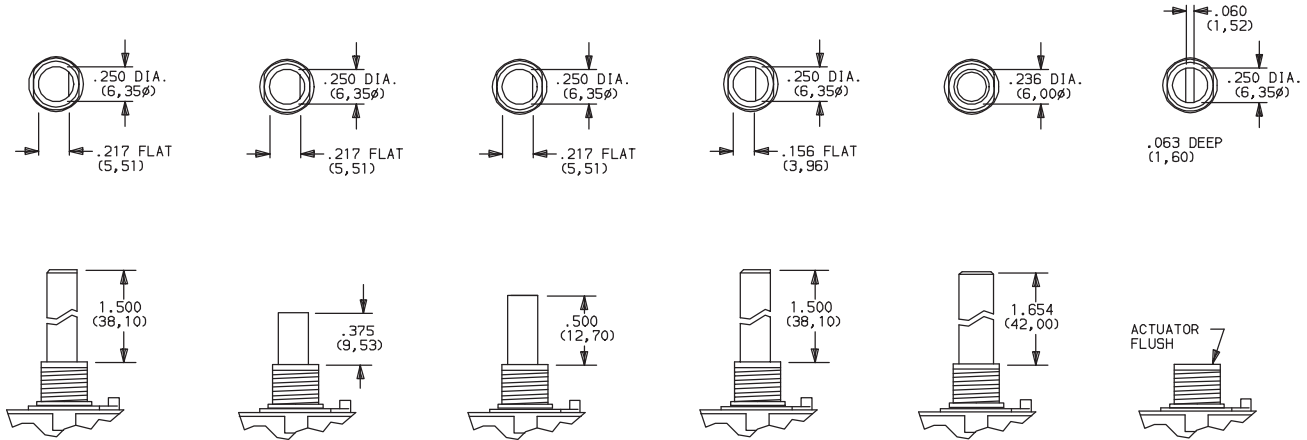

NOTE: Actuators shown in position 1, fully CCW.

## MOUNTING STYLE

**R** 3/8-32 THREAD    **M** M10 x .75 METRIC

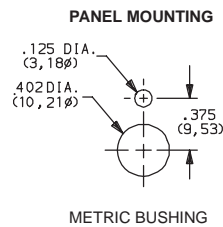
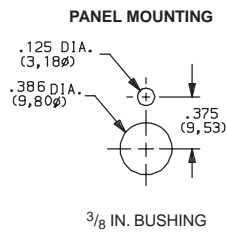
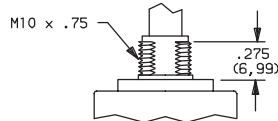
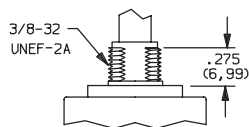

### TYPICAL INSTALLATION

Maximum force to push on knob should not exceed 10 in./lbs.

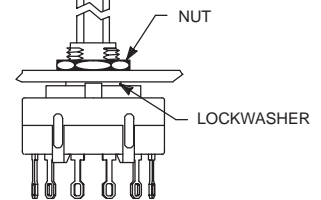

Install switch with stop ring (if used) and lockwasher in back of panel. Tighten hex nut from front of panel.

On PC mounted switches, use hex nut and lockwasher to hold stop ring in place.

Actuation torque: 8-16 oz./in.  
Maximum torque: 30 oz./in.

## SHORTING/NON-SHORTING CONTACTS

**N** NON-SHORTING CONTACTS (break-before-make)  
**S** SHORTING CONTACTS (make-before-break)

NOTE: 'S' shorting contacts are not available with A114, A124 and A214 models.

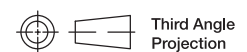

Dimensions are shown: Inch (mm)  
Specifications and dimensions subject to change

www.ck-components.com

A Series  
1-4 Pole Rotary Switches

TERMINATIONS

**Z** SOLDER LUG

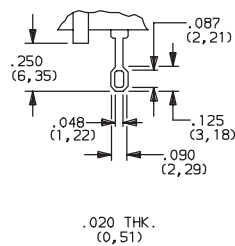

**C** PC THRU-HOLE

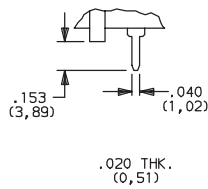

**MC** MODULAR BASE (for wave soldering)

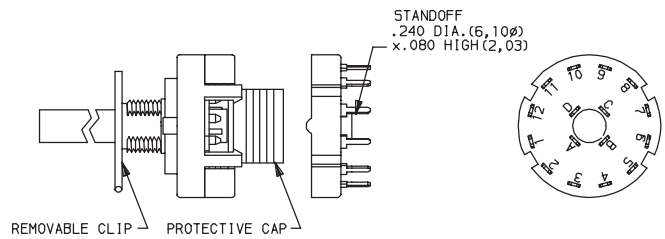

**NOTE:** Switches with 'C' or 'MC' terminations have additional terminal no. 9 as switch support only. This terminal is not connected electrically inside switch. Solder and clean switch base on PC board with other components, then snap on housing/actuator assembly. See page L-7 for installation instructions.

PC MOUNTING

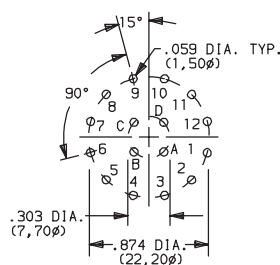

4P MODEL  
SP MODEL (omit terminals B, C & D)  
DP MODEL (omit terminals B & D)

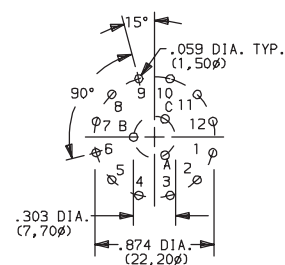

3P MODEL

CONTACT MATERIAL

OPTION CODE	CONTACT AND TERMINAL MATERIAL	RATING	
<b>Q</b>	SILVER <sup>2</sup>	POWER	SWITCH-2.5 AMPS @ 125 V AC; 350 mA @ 125V DC (UL/CSA). CARRY-5 AMPS CONTINUOUS.
<b>B</b>	GOLD <sup>1</sup>	LOW LEVEL/DRY CIRCUIT	0.4 VA MAX. @ 20 V AC or DC MAX
<b>G</b>	GOLD OVER SILVER <sup>3</sup>	LOW LEVEL/DRY CIRCUIT OR POWER	0.4 VA MAX. @ 20 V AC or DC MAX. or SWITCH-2.5 AMPS @ 125 V AC; 350 mA @ 125 V DC (UL/CSA). CARRY-5 AMPS CONTINUOUS.

\* Note: See Technical Data section of this catalog for RoHS compliant and compatible definition and specifications.

<sup>1</sup> MOVABLE CONTACTS: Copper alloy, with gold plate over nickel plate. STATIONARY CONTACTS & TERMINALS: Brass, with gold plate over nickel plate.

<sup>2</sup> MOVABLE CONTACTS: Coin silver, silver plated. STATIONARY CONTACTS & TERMINALS: Brass, silver plated (standard with all termination options).

<sup>3</sup> MOVABLE CONTACTS: Coin silver, with gold plate over nickel plate over silver plate. STATIONARY CONTACTS & TERMINALS: Brass, with gold plate over nickel plate over silver plate.

**NOTE:** Any models supplied with Q, B or G contact material are RoHS compliant.

All models   with all options when ordered with 'G' or 'Q' contact material.

**NOTE:** 'G' contact material is equivalent to both 'B' and 'Q' contact materials.

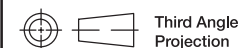

Third Angle  
Projection

Dimensions are shown: Inch (mm)  
Specifications and dimensions subject to change

www.ck-components.com

# A Series 1-4 Pole Rotary Switches

## FUNCTION

**NONE** NO SEAL

**E** EPOXY SEAL

**F** SPLASHPROOF BUSHING SEAL

**K** EPOXY & SPLASHPROOF BUSHING SEAL

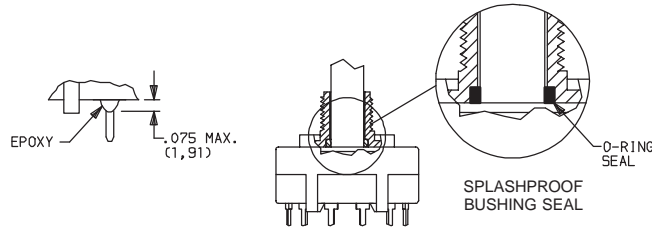

### Setting Stops on A112 and A125 Models

The number of switch positions is adjustable on A112 and A125 models only by means of a stop ring provided with each switch. The number of positions is pre-set on all other models and the stop ring is factory installed.

To set stops: Turn shaft fully counter-clockwise and insert stop ring tab in desired hole. Install lockwasher and nut to retain stop ring for both PC and panel mounting. Switch without stop ring has 12 positions.

### Soldering, Cleaning and Assembly Instructions for 'MC' Termination Option

#### Soldering

1. Insert switch base only into PC board.
2. Do not bend terminals.
3. Wave soldering recommended at 500F solder temperature.
4. Hand solder at 500F, 10 sec. max./terminal.

#### Cleaning

1. Flux clean using vapor degreaser and forced rinse or triple bath method.
2. Do not allow switch base to 'trap' fluids.
3. Freon TMC, TF or Methylene Chloride give excellent results.

#### Switch Assembly

1. Hold housing/shaft assembly by housing. Remove protective cap by squeezing tabs and discard. (FIG. 1)
2. *Do not push on switch shaft. Detent mechanism will come apart.*
3. While holding switch housing, align locating tab on base with notch on housing and engage 4 housing latches in slots on base. (FIG. 2)
4. Push firmly on housing until latches snap in place.
5. Remove clip from shaft and discard. Assembly is complete. (FIG. 3)

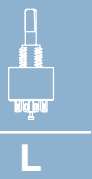
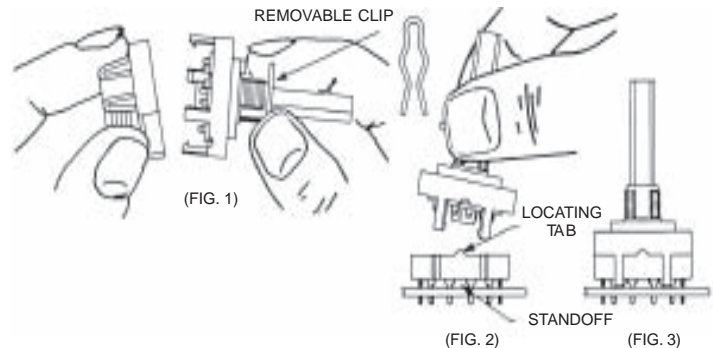

Rotary

## AVAILABLE HARDWARE

Stop ring

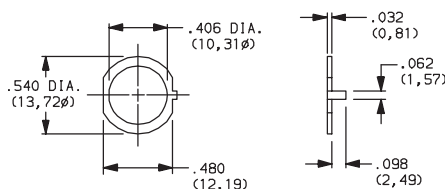

PART NO.

**767B00201**

Material: Brass

Finish: Nickel plated

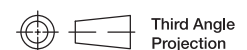

Dimensions are shown: Inch (mm)

Specifications and dimensions subject to change

# RTA Series

## 1-4 Poles Coded Rotary Switches



### Features/Benefits

- PCB or hand soldering versions
- Bushing mounting
- Multiple poles
- Decimal and hexadecimal codes
- Screwdriver slot or extended actuator
- RoHS Compliant

### Typical Applications

- Appliances
- Electronic alarm systems
- Medical
- Building automation
- HVAC air conditioning

### Electrical Data

	Silver	Gold
SWITCHING MODE:	BBM	BBM
MAX. SWITCHING POWER	5 VA	0.5 VA
MAX. SWITCHING CURRENT:	150 mA	20 mA
MAX. CARRYING CURRENT:	5 A	1 A
NOMINAL VOLTAGE AT 50 Hz	60 V	25 V
CONTACT RESISTANCE:	< 150 mΩ	< 150 mΩ
DIELECTRIC STRENGTH AT 50 Hz BETWEEN CONTACTS AND GROUND TERMINALS:	500 V r	500 V r
INSULATION RESISTANCE BETWEEN CONTACTS OR CONTACTS AND FRAME (500 V =):	10 <sup>9</sup> Ω	10 <sup>9</sup> Ω
NO. OF OPERATIONS:	10,000	10,000
BOUNCE:	< 5 ms	< 5 ms

### Mechanical Data

MAX. NO. OF BANKS: 1.  
 OPERATING TORQUE: 5 Ncm±20%.  
 END STOP TORQUE: < 60 Ncm.  
 STOP: With/without or adjustable  
 MOUNTING: By fixed index 9.5 mm (0.374) of center, for  
 bushing mount only

### Materials

BUSHING/HOUSING: PETP Thermoplastic  
 STATIONARY CONTACTS & TERMINALS: Nickel Plated Brass  
 with additional plating of Gold or Silver.  
 ROTOR: Gold or Silver plated Brass or PCB.  
 CODING PLATE: PA thermoplastic  
 ACTUATOR: Polysulfon thermoplastic  
 HARDWARE: Stop pin: Aluminum. Ball & Spring: Stainless steel.  
 Washer: PA. Nut: Brass.

### Environmental Data

OPERATING TEMPERATURE: -20°C to + 70°C -20°C to + 70°C  
 STORAGE TEMPERATURE: -40°C to + 85°C -40°C to + 85°C

**NOTE:** Specifications and materials listed above are for switches with standard options.  
 For information on specific and custom switches, consult Customer Service Center.

### Build-A-Switch

To order, simply select desired option from each category and place in the appropriate box. Available options are shown and described on pages L-9 thru L-12. For additional options not shown in catalog, consult Customer Service Center.

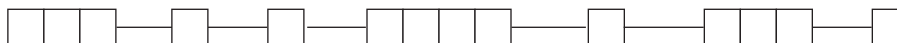

#### Designation

**RTA**

#### Indexing

- 2** 22.5 index (coded only)
- 3** 30° index (12 positions max.)
- 4** 36° index (10 positions max.)

#### Termination

- P** With PC Thru-hole
- C** With Solder Lugs
- H** Horizontal with PC Thru-hole

#### Switch Function

- 1W12** SP, 30° Index, 12 pos. no stop
- 1W10** SP, 36° Index, 10 pos. no stop
- 1S02** SP, 30° /36° Index, 2 pos.
- 1S03** SP, 30° /36° Index, 3 pos.
- 1S04** SP, 30° /36° Index, 4 pos.
- 1S05** SP, 30° /36° Index, 5 pos.
- 1S06** SP, 30° /36° Index, 6 pos.
- 1S07** SP, 30° /36° Index, 7 pos.
- 1S08** SP, 30° /36° Index, 8 pos.
- 1S09** SP, 30° /36° Index, 9 pos.
- 1S10** SP, 30° /36° Index, 10 pos.
- 1S11** SP, 30° Index, 11 pos.
- 1S12** SP, 30° Index, 12 pos.
- 2S02** DP, 30° /36° Index, 2 pos.
- 2S03** DP, 30° /36° Index, 3 pos.
- 2S04** DP, 30° /36° Index, 4 pos.
- 2S05** DP, 30° /36° Index, 5 pos.
- 2S06** DP, 30° Index, 6 pos.
- 3S02** 3P, 30° /36° Index, 2 pos.
- 3S03** 3P, 30° /36° Index, 3 pos.
- 4S02** 4P, 30° /36° Index, 2 pos.
- EW10** Direct + complement, 36° Index, no stop
- EW12** Direct + complement, 30° Index, no stop
- DW16** Direct, 22.5° Index, no stop
- ES\_\_** Direct + complement, with stop (specify stop position)
- DS\_\_** Direct, 22.5° Index, with stop (specify stop position)

#### Mounting Style

- W** Without bushing
- R** 3/8-32 Threaded Bushing
- M** M10x.75 Metric Threaded Bushing
- A** 3/8-32 Threaded Bushing with Offset Bracket
- B** M10x.75 Metric Threaded Bushing with Offset Bracket

#### Contact Material

- S** Silver plated, matte-tin terminal
- P** Gold plated, matte-tin terminal

#### Actuator (max.)

- 25N** .984 (25,0) with screwdriver slot
- 50N** 1.97 (50,0) with screwdriver slot
- FLS** Flush shaft with screwdriver slot and position indicator
- 25F** .984 (25,0) Shaft with flat
- 06F** .236 (6,0) Shaft with flat

- C** 3/8-32 Threaded Bushing with Straight Bracket
- D** M10x.75 Metric Threaded Bushing with Straight Bracket



Dimensions are shown: Inch (mm)  
 Specifications and dimensions subject to change

# RTA Series 1-4 Poles Coded Rotary Switches

## DESIGNATION



## RTA

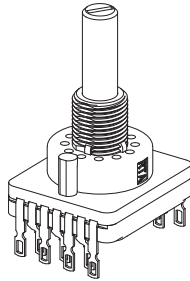

## TERMINATION



### P

WITH PC PINS

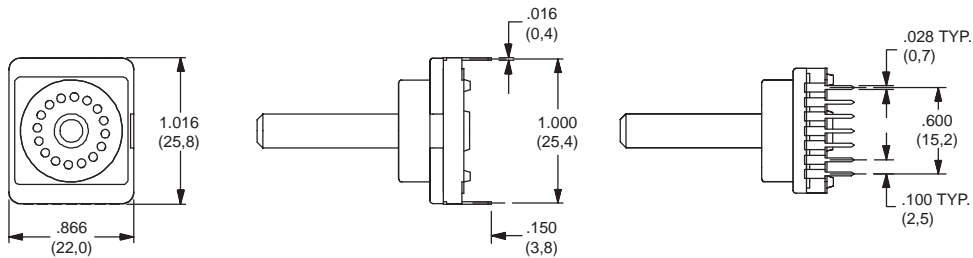

### C

WITH SOLDER LUGS

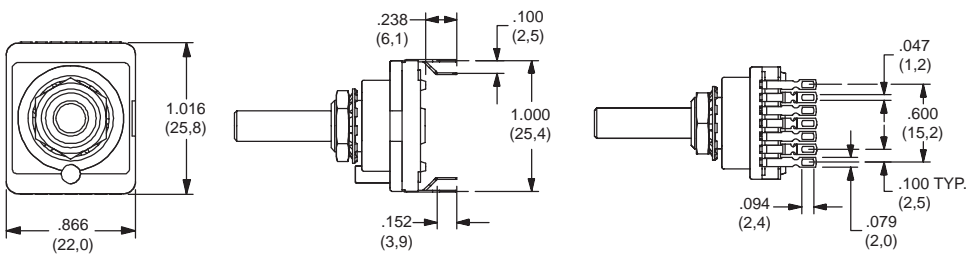

### H

Horizontal with PC Thru-hole

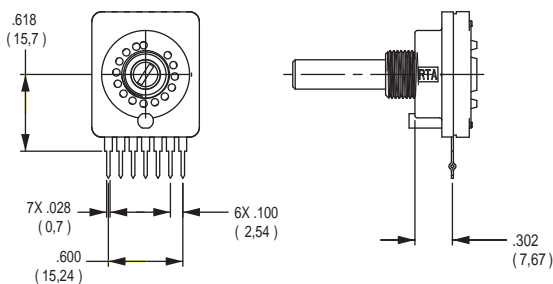

Note: "H" termination only available with the following options:

1. With A or B mounting styles
2. 36° degree indexing
3. Up to 5 positions max

## INDEXING



**2** 22.5 index, 16 positions max.

**3** 30 index, 12 positions max.

**4** 36 index, 10 positions max.

Both commons must be connected by user to ground.

**C&K**



Third Angle  
Projection

Dimensions are shown: Inch (mm)  
Specifications and dimensions subject to change

[www.ck-components.com](http://www.ck-components.com)



Rotary



# RTA Series

## 1-4 Poles Coded Rotary Switches

### SWITCH FUNCTION

NO. POLES	MODEL NO.	SWITCH FUNCTION	INDEX
SP	1W12	12 Positions No Stop	30°
	1W10	10 Positions No Stop	36°
	1S02	2 Positions	30°/36°
	1S03	3 Positions	30°/36°
	1S05	5 Positions	30°/36°
	1S06	6 Positions	30°/36°
	1S08	8 Positions	30°/36°
	1S09	9 Positions	30°/36°
	1S10	10 Positions	30°/36°
	1S11	11 Positions	30°
	1S12	12 Positions	30°

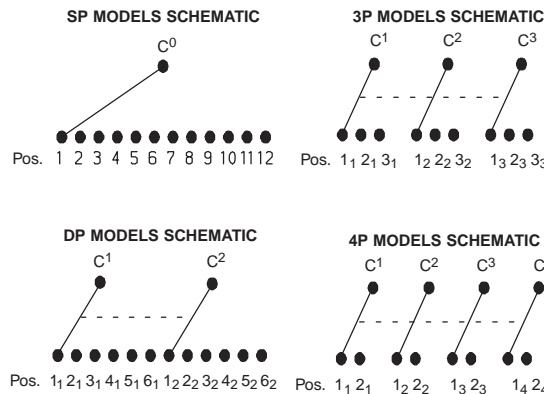

EW10	Direct + complement, 36° Index, no stop
EW12	Direct + complement, 30° Index, no stop
DW16	Direct, 22.5° Index, no stop
ES__	Direct + complement, with stop (specify stop position)
DS__	Direct, 22.5° Index, with stop (specify stop position)

NO. POLES	MODEL NO.	SWITCH FUNCTION	INDEX
DP	2W05	5 Positions No Stop	30°/36°
	2W06	6 Positions No Stop	30°
	2S02	2 Positions	30°/36°
	2S03	3 Positions	30°/36°
	2S04	4 Positions	30°/36°
	2S05	5 Positions	30°/36°
3P	3S02	2 Positions	30°/36°
	3S03	3 Positions	30°/36°
4P	4S02	2 Positions	30°/36°

22.5°	30°	36°		Pos.	1	2	3	4	5	6	7	8	9	10	11	12	13	14	15	16
Term.	Term.	Term.																		
E,J	M,N	L,N		C	•	•	•	•	•	•	•	•	•	•	•	•	•	•	•	•
F,I	H	D		1		•		•		•		•		•		•				•
D,K	D	B		2			•	•			•	•			•	•			•	•
A,N	A	I		4				•	•	•	•					•	•	•	•	•
B	J	J		8									•	•	•	•	•	•	•	•
—	C	K		1	•		•		•		•		•		•		•		•	
—	K	H		2	•	•			•	•			•	•			•	•		
—	B	A		4	•	•	•	•					•	•	•	•				
—	I	C		8	•	•	•	•	•	•	•	•								

#### Indexing Option Code 2, 22.5 INDEXING ANGLE PCB LAYOUT

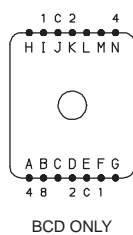

#### Indexing Option Code 3, 30 INDEXING ANGLE PCB LAYOUT

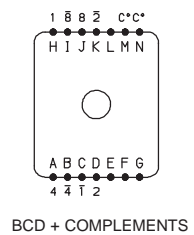
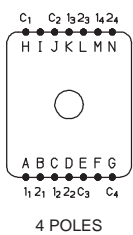
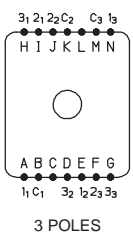
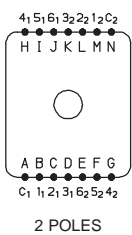
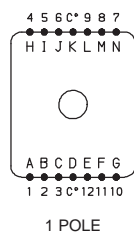

#### Indexing Option Code 4, 36 INDEXING ANGLE PCB LAYOUT

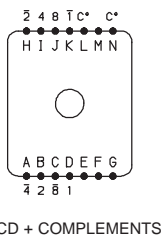
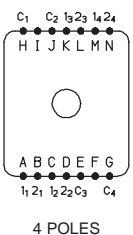
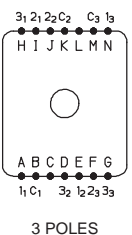
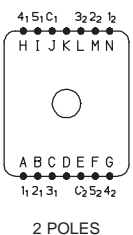
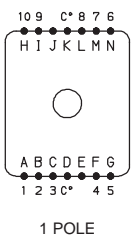

**NOTE:** Layout view from component side.

Common terminals that are in locations A-G are not connected to common terminals that are in locations H-N. For 7-12 position output customer must tie these commons together.



Dimensions are shown: Inch (mm)  
Specifications and dimensions subject to change

www.ck-components.com

# RTA Series 1-4 Poles Coded Rotary Switches

## MOUNTING STYLE



### W WITHOUT BUSHING

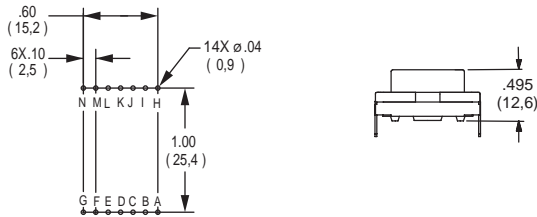

Note: W mounting style not available with H termination.

### M M10 x .75 METRIC THREADED BUSHING

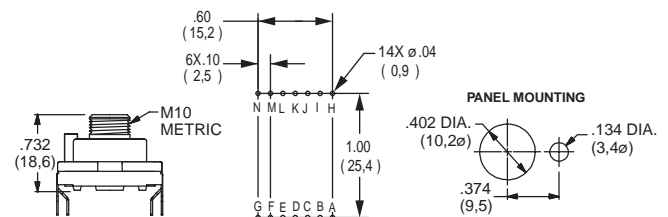

Note: M mounting style not available with H termination.

### R 3/8-32 THREADED BUSHING

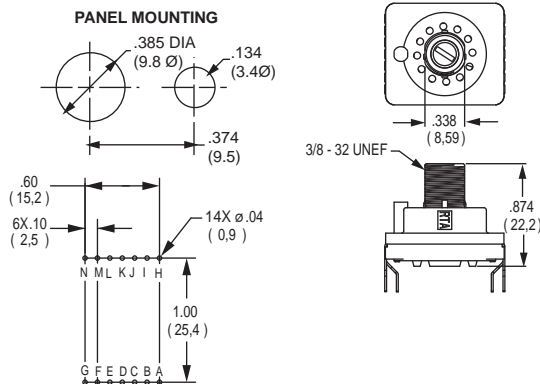

Note: R mounting style not available with H termination.

### A 3/8-32 THREADED BUSHING WITH BRACKET

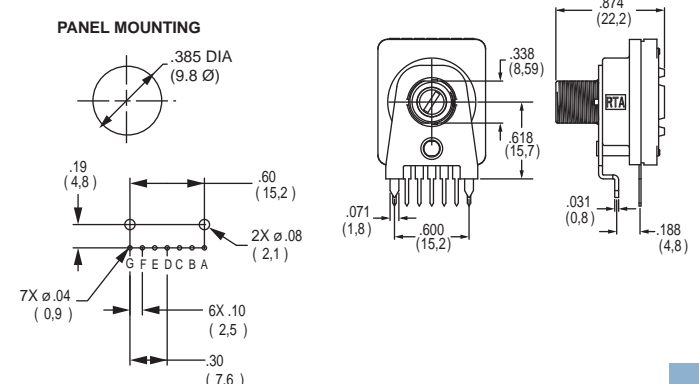

Note: A mounting style only available with H termination.

### B M10 x .75 METRIC THREADED BUSHING WITH BRACKET

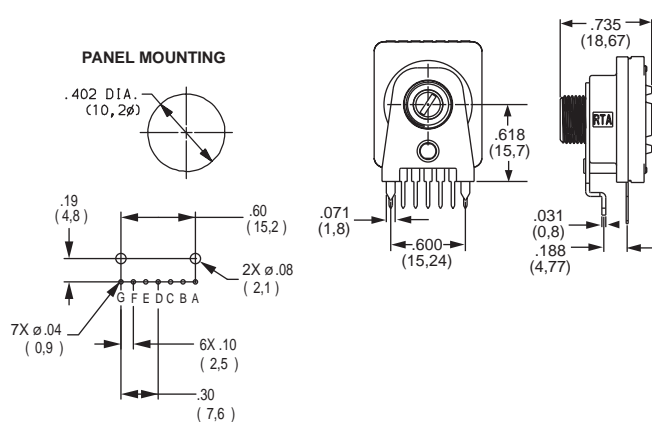

Note: B mounting style only available with H termination.

### C 3/8-32 THREADED BUSHING WITH STRAIGHT BRACKET

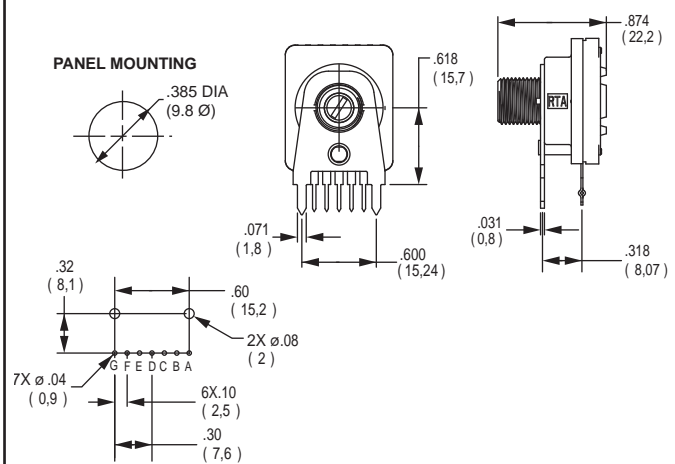

### D M10 x .75 METRIC THREADED BUSHING WITH STRAIGHT BRACKET

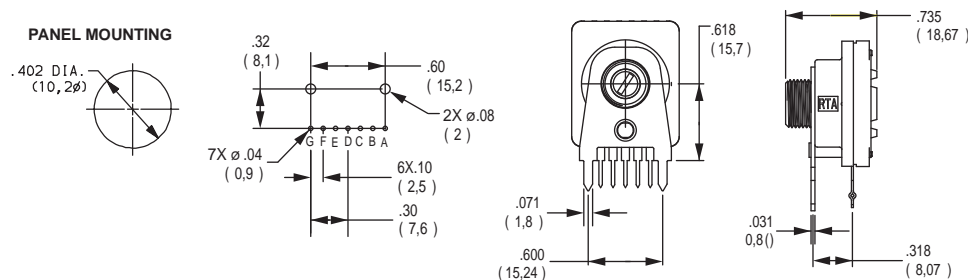

**C&K**

Third Angle Projection

Dimensions are shown: Inch (mm)  
Specifications and dimensions subject to change



Rotary

# RTA Series

## 1-4 Poles Coded Rotary Switches

### ACTUATOR

**25N** .984 (25,0) WITH SCREWDRIVER SLOT

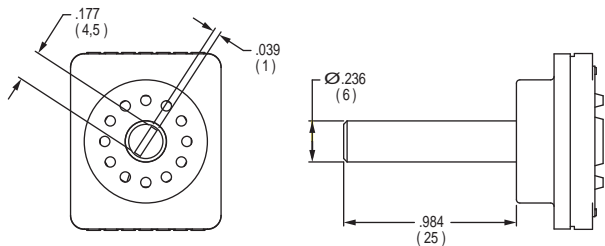

**50N** 1.97 (50,0) WITH SCREWDRIVER SLOT

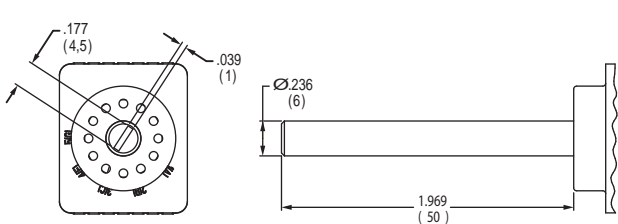

**FLS** FLUSH SHAFT WITH SCREWDRIVER SLOT AND POSITION INDICATOR

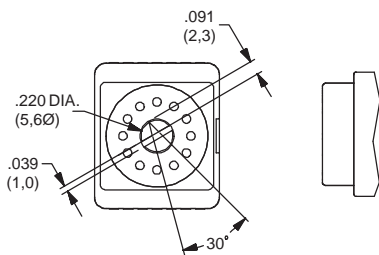

**25F** .984 (25,0) SHAFT WITH FLAT

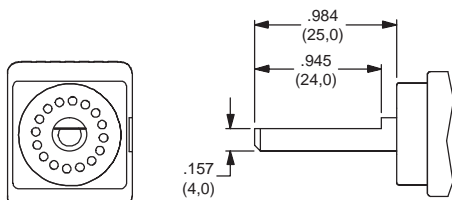

**06F** .236 (6,0) SHAFT WITH FLAT

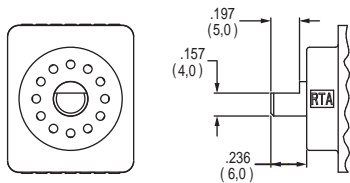

### CONTACT MATERIAL

OPTION CODE	CONTACT AND TERMINAL MATERIAL	RATING	
<b>S</b>	SILVER	LOW LEVEL/DRY CIRCUIT	SWITCH: 150 mA MAXIMUM, 60 V NOMINAL. POWER: 5 VA MAXIMUM. CARRY-5 AMPS MAXIMUM.
<b>P</b>	GOLD	LOW LEVEL/DRY CIRCUIT OR POWER	SWITCH: 20 mA MAXIMUM, 25 V NOMINAL. POWER: 0.5 VA MAXIMUM. CARRY: 1 AMP MAXIMUM.

\* Note: See Technical Data section of this catalog for RoHS compliant and compatible definition and specifications.

### AVAILABLE HARDWARE

Stop pins



PART NO.  
**Y200300200P**

NOTE: Additional nuts and lockwashers available separately, see section "Technical Data and Additional Hardware".

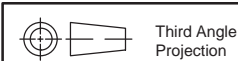

Dimensions are shown: Inch (mm)  
Specifications and dimensions subject to change

[www.ck-components.com](http://www.ck-components.com)

## M Series Half-inch Rotary Switches



## Features/Benefits

- **Multi-pole and multi-positions**
- **Panel and PCB mounting**
- **Stainless steel actuator**
- **Non-shorting contacts**
- **RoHS Compliant**

## Typical Applications

- **Test equipment**
- **Industrial equipment**
- **Medical equipment**



## Specifications

CONTACT RATING: Q contact material: Carry-6 AMPS continuous.  
Switch-250 mA max. @ 125 V AC or 28 DC. Non-shorting  
contacts standard. See page L-16 for additional ratings.

ELECTRICAL LIFE: 10,000 make-and-break cycles at 150 mA, 125 V AC or 28 DC.

CONTACT RESISTANCE: Below 20 mΩ typ. initial @  
2-4 V DC, 100 mA, for both silver and gold plate

INSULATION RESISTANCE:  $10^{10} \Omega \text{ min.}$

DIELECTRIC STRENGTH: 600 Vrms min. @ sea level.

OPERATING & STORAGE TEMPERATURE: -30°C to 85°C.

OPERATING TORQUE: 4-7 ounces-inches typ. initial.

SOLDERABILITY: Per MIL-STD-202F method 208D, or

EIA RS-186E method 9 (1 hour steam aging).

**NOTE:** Specifications and materials listed above are for switches with standard options. For information on specific and custom switches, consult Customer Service Center.

## Materials

HOUSING AND BUSHING: Zinc alloy, bright zinc plated, with clear chromate finish.

ACTUATOR: Zinc alloy, nickel plated or stainless steel.

BASE: Diallylphthalate (DAP) or melamine phenolic, with insert molded terminals.

ROTOR: Glass filled polyester (UL 94V-0).

## MOVABLE CONTACTS:

Non-shorting: Q contact material: Copper alloy, silver plated.  
See page L-16 for additional contact materials.

**STATIONARY CONTACT & ALL TERMINALS:** Q contact material: Copper alloy, silver plated. All terminals insert molded. All terminals present regardless of number of switch positions. See page L-16 for additional contact materials.

CONTACT SPRING: Music wire, phosphate coated.

STOP PIN: Stainless steel.

STOP RING: Brass.

HARDWARE: Nut: Brass, nickel plated; Lockwasher: Steel, nickel plated.

## Build-A-Switch

To order, simply select desired option from each category and place in the appropriate box. Available options are shown and described on pages L-14 thru L-18. For additional options not shown in catalog, consult Customer Service Center.

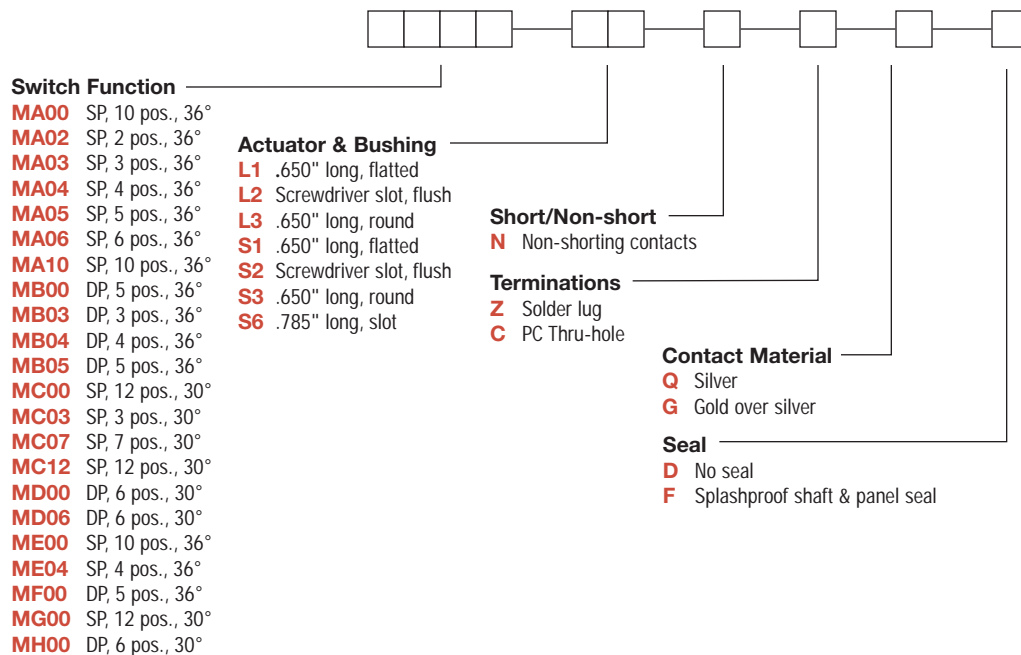

Dimensions are shown: Inch (mm)  
Specifications and dimensions subject to change

# M Series Half-inch Rotary Switches

## SWITCH FUNCTION

36° INDEXING			
NO. POLES	MODEL NO. WITH STOP PINS	MODEL NO. WITH STOP RINGS	SWITCH FUNCTION
SP	MA00	ME00	10 Positions No Stops
	MA02	—	2 Positions
	MA03	—	3 Positions
	MA04	ME04	4 Positions
	MA05	—	5 Positions
	MA06	—	6 Positions
	MA10	—	10 Positions
DP	MB00	MF00	5 Positions No Stops
	MB03	—	3 Positions
	MB04	—	4 Positions
	MB05	—	5 Positions

SP MODELS 36° INDEXING SCHEMATIC

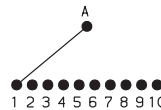

DP MODELS 36° INDEXING SCHEMATIC

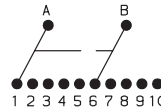

SP MODELS 30° INDEXING SCHEMATIC

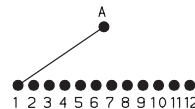

DP MODELS 30° INDEXING SCHEMATIC

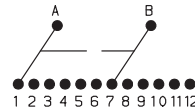

30° INDEXING			
NO. POLES	MODEL NO. WITH STOP PINS	MODEL NO. WITH STOP RINGS	SWITCH FUNCTION
SP	MC00	MG00	12 Positions No Stops
	MC03	—	3 Positions
	MC07	—	7 Positions
	MC12	—	12 Positions
DP	MD00	MH00	6 Positions No Stops
	MD06	—	6 Positions

All models with all options when ordered with S1-SB stainless steel actuator options.

**NOTE:** Number of positions or stops preset at factory (NOTE: MX00 models have full 360 rotation with no stops. Stop pins or stop rings supplied for user-selectable stops, see above). All terminals present regardless of number of switch positions. Hardware is available separately, see section "Technical Data and Additional Hardware".

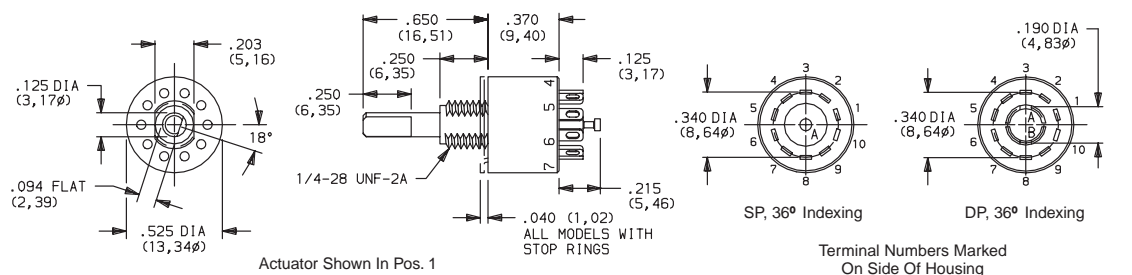

Part number shown: MA00L1NZQD

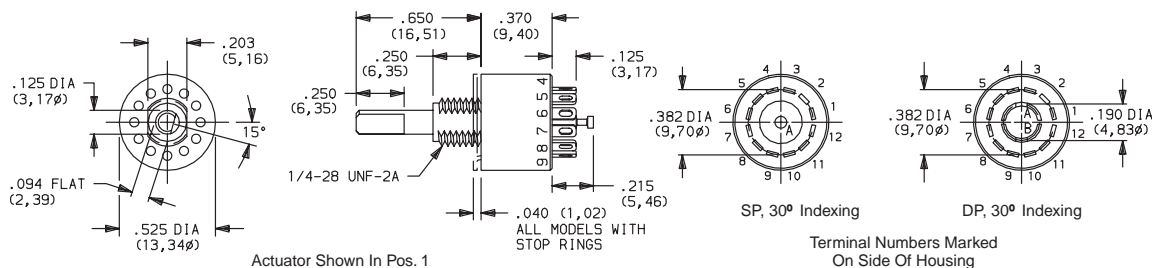

Part number shown: MC00L1NZQD



Third Angle Projection

Dimensions are shown: Inch (mm)  
Specifications and dimensions subject to change

www.ck-components.com

# M Series Half-inch Rotary Switches

## ACTUATOR (ZINC ALLOY)



### L1 .650" LONG, FLATTED

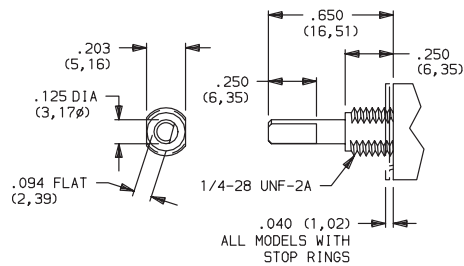

### L2 SCREWDRIVER SLOT, FLUSH

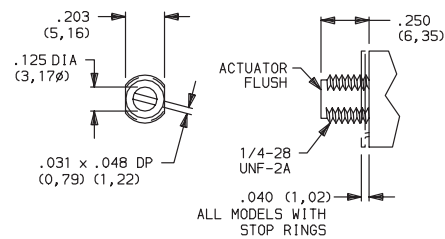

### L3 .650" LONG, ROUND

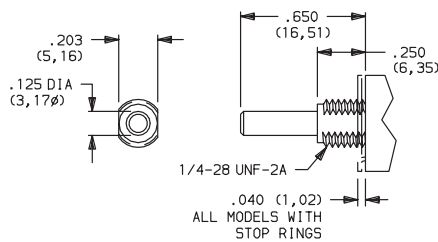

All actuators shown in pos. 1

## ACTUATOR (STAINLESS STEEL)



### S1 .650" LONG, FLATTED

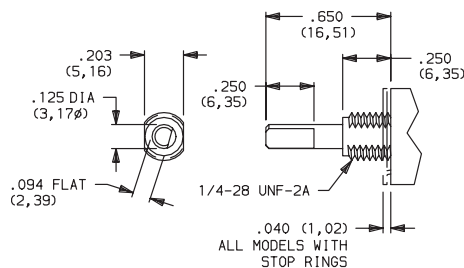

### S2 SCREWDRIVER SLOT, FLUSH

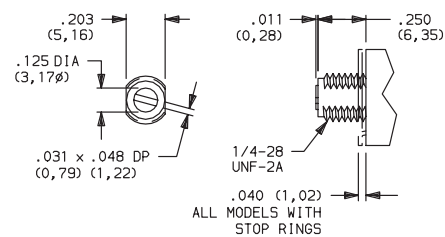

### S3 .650" LONG, ROUND

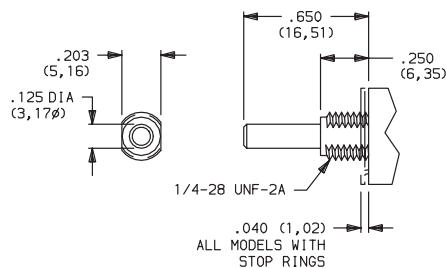

### S6 .785" LONG, SLOT

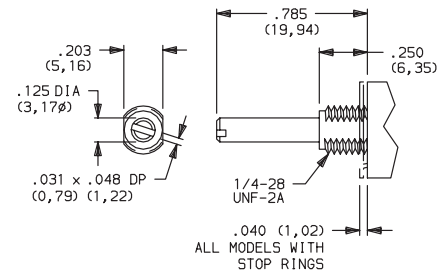

All actuators shown in pos. 1

All models UL/CSA when ordered with stainless steel actuators.



Dimensions are shown: Inch (mm)  
Specifications and dimensions subject to change

# M Series Half-inch Rotary Switches

## SHORTING/NON-SHORTING CONTACTS

### N NON-SHORTING CONTACTS

Break-before-make

## TERMINATIONS

### Z SOLDER LUG

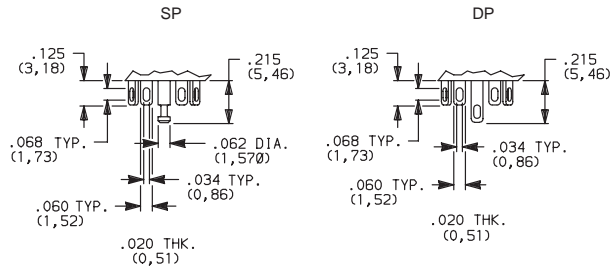

### C PC THRU-HOLE

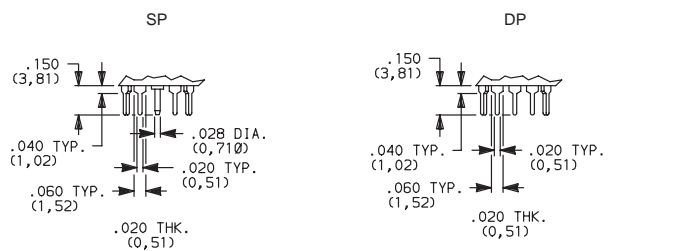

### PANEL MOUNTING

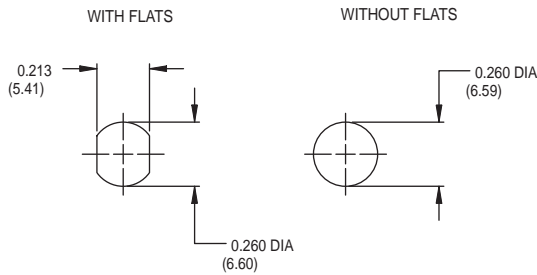

### PC MOUNTING 36° INDEXING

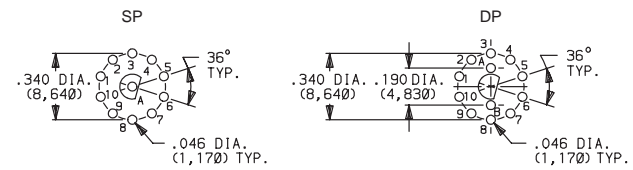

### PC MOUNTING 30° INDEXING

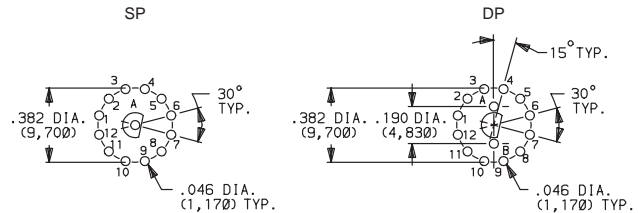

Hardware: All models, one mounting nut and lockwasher supplied standard. MA00 thru MD00 models: two stop pins and adhesive mylar washer supplied. ME00 thru MH00 models: two stop rings supplied. Hardware is available separately, see section "Technical Data and Additional Hardware".

**NOTE:** Q contact material standard. Terminal numbers marked on side of housing. All terminals insert molded. All terminals present regardless of number of switch positions.

Actuators and schematics shown in pos. 1.

## CONTACT MATERIAL

OPTION CODE	CONTACT MATERIAL	TERMINAL PLATING	RATING	
<b>Q</b>	SILVER <sup>1,2</sup>	SILVER <sup>2</sup>	POWER	CARRY: 6 AMPS CONTINUOUS. SWITCH: 250 mA @ 125 V AC or 28 V DC.
<b>G</b>	GOLD OVER SILVER <sup>3,4</sup>	GOLD <sup>4</sup>	LOW LEVEL/DRY CIRCUIT OR POWER	0.4 VA MAX. @ 20 V AC or DC MAX. or, CARRY: 6 AMPS CONTINUOUS. SWITCH: 250 mA @ 125 V AC or 28 V DC.

\* Note: See Technical Data section of this catalog for RoHS compliant and compatible definition and specifications.

<sup>1</sup> MOVABLE CONTACTS: Non-shorting: Copper alloy, silver plated.  
Shorting: Zinc alloy, silver plated.

<sup>2</sup> STATIONARY CONTACTS & ALL TERMINALS: Copper alloy, silver plated.

<sup>3</sup> MOVABLE CONTACTS: Non-shorting: Copper alloy, with gold plate over nickel plate, over silver plate.  
Shorting: Zinc alloy, with gold plate

<sup>4</sup> STATIONARY CONTACTS & ALL TERMINALS: Copper alloy, with gold plate over nickel plate over silver plate.

**NOTE:** Any models supplied with Q, G contact material are RoHS compliant.

All models  when ordered with S1-S6 stainless steel actuator options.



Third Angle  
Projection

Dimensions are shown: Inch (mm)  
Specifications and dimensions subject to change

**C&K**

# M Series Half-inch Rotary Switches

SEAL 

**D** NO EPOXY SEAL

**F** SPLASHPROOF SHAFT AND PANEL SEAL

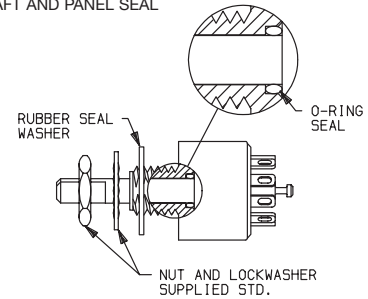

## Setting Stops With Stop Pins

### MA00, MB00, MC00 & MD00 Models Only:

The number of switch positions or stops are adjustable by means of stop pins provided with each switch. Switches are normally shipped with stop pins and hardware in bulk, not installed. Without stop pins, switches have full 360° rotation and no stops. Note that all two pole models begin to repeat when actuated 180° or more.

To set stops, refer to figures 1 & 2. Orient switch so that terminal no. 1 is as shown. Turn actuator to position 1, using flats on bushing and terminal no. 1 as reference. Install CCW stop pin in hole designated 'X'. Install second stop pin in hole number corresponding to the number of positions desired. Note that two pole models will begin to repeat when actuated 180° or more. To retain stop pins, use adhesive mylar washer included; see figure 3.

All models except MX00 models have number of switch positions or stops pre-set at factory and are not adjustable.

### Hardware:

Two stop pins, mounting nut, and lockwasher supplied standard.

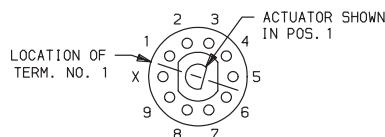

36° Indexing Models  
Top View

Fig. 1

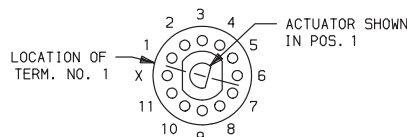

30° Indexing Models  
Top View

Fig. 2

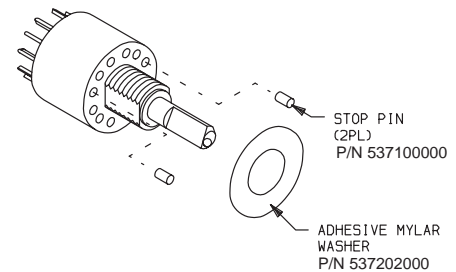

Fig. 3

## Setting Stops With Stop Rings

### ME00, MF00, MG00 & MH00 Models Only:

The number of switch positions or stops are adjustable by means of stop rings provided with each switch. These models are normally shipped with stop rings and hardware in bulk, not installed. Without stop rings, switches have full 360° rotation and no stops. Note that all two pole models begin to repeat when actuated 180° or more.

To set stops refer to figures 4 & 5. Orient switch so that terminal no. 1 is as shown. Turn actuator to pos. 1 using flats on bushing and terminal no. 1 as reference. See figure 6 and install inner stop ring with short tab in hole designated 'X'. Install outer stop ring with long tab in hole number corresponding to the number of positions desired. Note that all two pole models begin to repeat when actuated 180° or more. Use mounting nut and lockwasher to retain stop rings.

### All MEXX, MFXX, MGXX & MHXX Models (Except MX00 models):

Number of switch positions or stops are preset at factory, but are user adjustable.

### Hardware:

Two stop rings, mounting nut and lockwasher supplied standard.

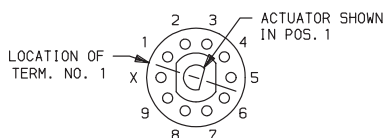

36° Indexing Models  
Top View

Fig. 4

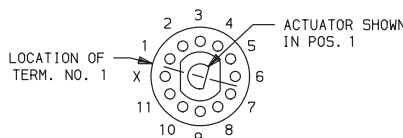

30° Indexing Models  
Top View

Fig. 5

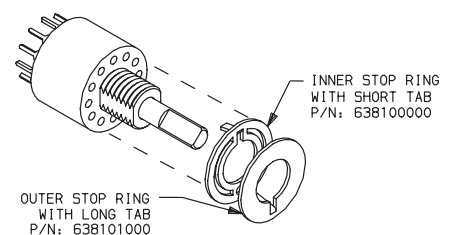

Fig. 6

**C&K**

Dimensions are shown: Inch (mm)  
Specifications and dimensions subject to change



RBP12 Series
1-6 Pole Miniature Rotary Switches



- Features/Benefits
- Rotary switch for low current
  - Shaft perpendicular to PCB
  - Index mechanism included in thickness of switch
  - Several actuation modes
  - Low profile
  - RoHS Compliant
- Typical Applications
- Medical
  - Instrumentation
  - Appliances

Electrical Data		Silver (S)	Gold (G)	Mechanical Data	
Switching mode		MBB-BBM	MBB-BBM	Max. number of banks	1
		Make Before Break, Break Before Make	Make Before Break, Break Before Make	Operating torque	2.5 Ncm ± 25% (1 pole)
Max. switching power		5 VA (resistive)	0.5 VA (resistive)	Stop strength	> 40 Ncm
Max. switching current		130 mA	20 mA	End stop	With/without or mobile
Max. carrying current		3 A	3 A	Contact material	Silver, Gold
Contact resistance		< 15 m ohms	< 25 m ohms	Insulating material	Thermoplastic
Dielectric strength	between contacts	1000 V	1000 V	<b>NOTE:</b> Specifications and materials listed above are for switches with standard options. For information on specific and custom switches, consult Customer Service Center.	
at 50 Hz	or contacts and ground	1000 V	1000 V		
Nominal voltage		150 V rms	150 V rms		
Number of operations		15,000	20,000		
Insulation resistance between contacts and contacts and frame (500 Vcc)		> 5 x 10 <sup>9</sup> ohms	> 5 x 10 <sup>9</sup> ohms		
<b>Environmental data</b>					
Storage temperature		- 25°C to + 70°C	- 25°C to + 85°C		
Salt spray		NA	48 H		
<b>Further data</b>					
Solderability		Hand: 350°C/5 s	Wave: 260°C/5 s max.		
Cleaning		Cleaning of modules prohibited			

Build-A-Switch

To order, simply select desired option from each category and place in the appropriate box. Available options are shown and described on pages L-19 thru L-21. For additional options not shown in catalog, consult Customer Service Center.

Designation

**RBP12**

Switch Function

**112S** SP, 30° Index, 12 pos. no stop  
**103B03** SP, 30° Index, 3 pos.  
**105B05** SP, 30° Index, 5 pos.  
**107B07** SP, 30° Index, 7 pos.  
**108B08** SP, 30° Index, 8 pos.  
**110B10** SP, 30° Index, 10 pos.  
**112B12** SP, 30° Index, 12 pos.  
**206S** DP, 30° Index, 6 pos. no stop  
**202B02** DP, 30° Index, 2 pos.  
**203B03** DP, 30° Index, 3 pos.  
**205B05** DP, 30° Index, 5 pos.  
**304B04** 3P, 30° Index, 4 pos.  
**403B03** 4P, 30° Index, 3 pos.  
**602B02** 6P, 30° Index, 2 pos.

Switching Mode

**N** Non-shorting BBM (break-before-make)  
**C** Shorting, MBB (make-before-break)

Actuator

**F** Screwdriver slot\*  
**AD** Plastic shaft, <20mm (.787)\*  
**S** Plastic shaft, 6mm (.236)\*  
**M** Thumbwheel

Contact Material

**S** Silver  
**G** Gold

\*Option: Metallic shaft available by request



Dimensions are shown: Inch (mm)  
Specifications and dimensions subject to change

# RBP12 Series

## 1-6 Pole Miniature Rotary Switches

DESIGNATION

RBP12

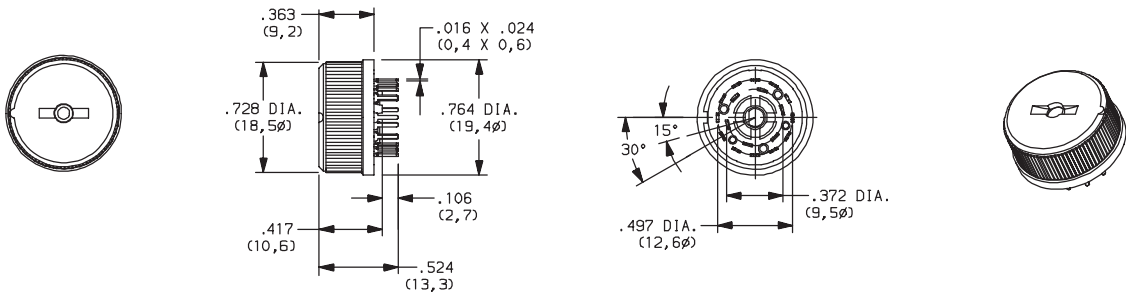

SWITCH FUNCTION

30° INDEXING		
NO. POLES	MODEL NO.	SWITCH FUNCTION
SP	<b>112S</b>	12 Position No Stops
	<b>103B03</b>	3 Positions
	<b>105B05</b>	5 Positions
	<b>107B07</b>	7 Positions
	<b>108B08</b>	8 Positions
	<b>110B10</b>	10 Positions
	<b>112B12</b>	12 Positions
DP	<b>206S</b>	6 Positions No Stop
	<b>202B02</b>	3 Positions
	<b>203B03</b>	3 Positions
	<b>205B05</b>	5 Positions

SP MODELS SCHEMATIC

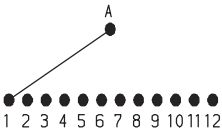

DP MODELS SCHEMATIC

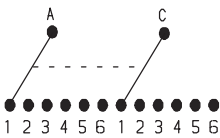

30° INDEXING		
NO. POLES	MODEL NO.	SWITCH FUNCTION
3P	<b>304B04</b>	4 Positions
4P	<b>403B03</b>	3 Positions
6P	<b>602B02</b>	2 Positions

3P MODELS SCHEMATIC

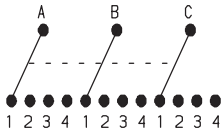

4P MODELS SCHEMATIC

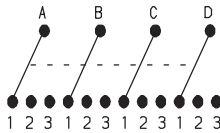

6P MODELS SCHEMATIC

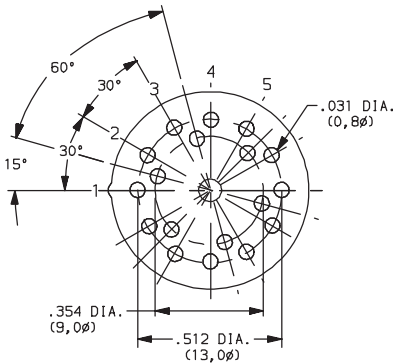
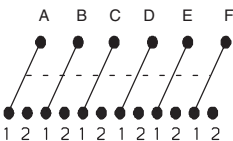

PC LAYOUTS

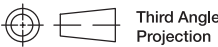
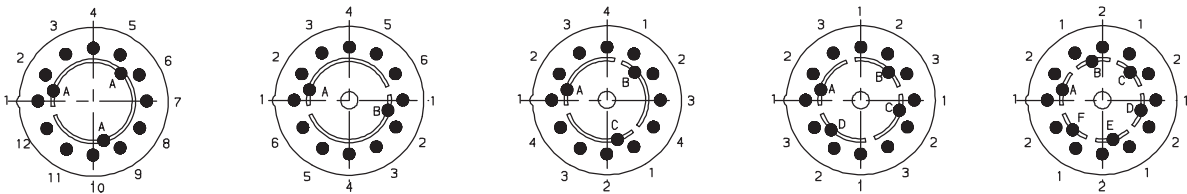

Dimensions are shown: Inch (mm)  
Specifications and dimensions subject to change

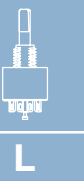

Rotary

# RBP12 Series

## 1-6 Pole Miniature Rotary Switches

SWITCHING MODE 

- N** NON-SHORTING, BBM (break-before-make)
- C** SHORTING, MBB (make-before-break)

ACTUATOR 

- F** SCREWDRIVER SLOT
- AD** PLASTIC SHAFT, <20 mm (.787)

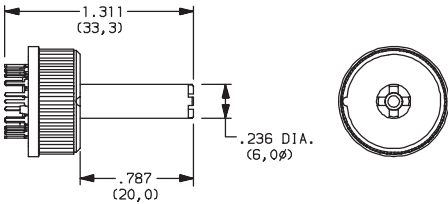
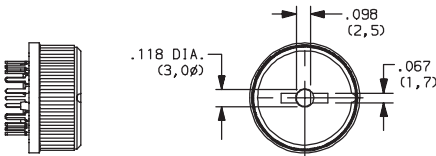

- M** THUMBWHEEL
- S** PLASTIC SHAFT, 6 mm (.236)

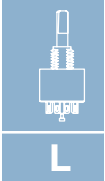
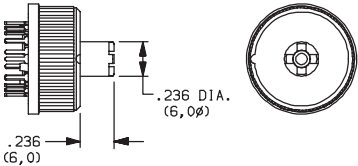
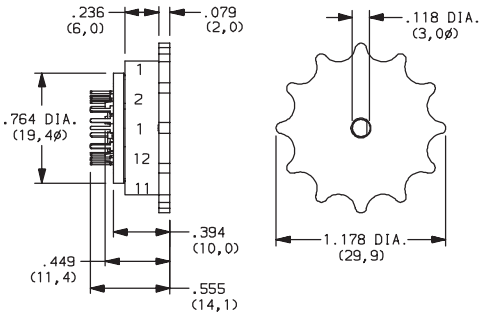

Rotary

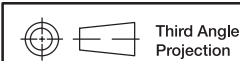

Dimensions are shown: Inch (mm)  
Specifications and dimensions subject to change

# RBP12 Series

## 1-6 Pole Miniature Rotary Switches

### CONTACT MATERIAL

OPTION CODE	CONTACT AND TERMINAL MATERIAL	RATING	
S	SILVER	LOW LEVEL/DRY CIRCUIT	SWITCH: 130 mA, POWER: 5 VA MAXIMUM. CARRY: 3 AMPS
G	GOLD	LOW LEVEL/DRY CIRCUIT OR POWER	SWITCH: 20 mA, POWER: 0.5 VA MAXIMUM. CARRY: 3 AMPS

\* Note: See Technical Data section of this catalog for RoHS compliant and compatible definition and specifications.

### AVAILABLE HARDWARE

F + FA SHAFT

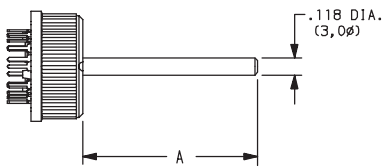

AD + FA SHAFT

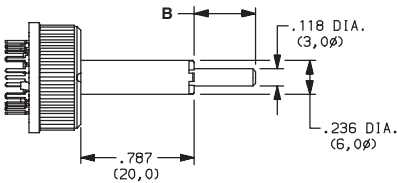

S + FA SHAFT

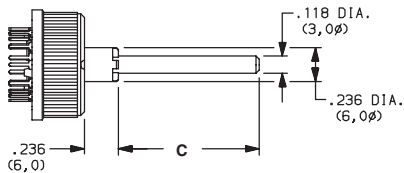

PART NUMBER	"A"
Y460P0067FP	.394 (10,0)
Y460P0060FP	.590 (15,0)
Y460P0090FP	.787 (20,0)
Y460320100P	.984 (25,0)
Y460P0018FP	1.969 (50,0)
Y460P0022FP	2.756 (70,0)

**NOTE:** FA metallic shaft, consult customer service for available lengths.



Third Angle Projection

Dimensions are shown: Inch (mm)

Specifications and dimensions subject to change

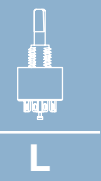

Rotary

# RTBH Series

## 1-2 Pole Coded Rotary Switches



### Features/Benefits

- **Totally sealed**
- **Detent angles, 15, 22.5, 30 and 36**
- **Multi pole**
- **Coding functions**
- **Robust construction**
- **RoHS Compliant**

### Typical Applications

- **Telecommunications**
- **Military**
- **Instrumentation**
- **Heavy-duty industrial equipment**

### Electrical Data

SWITCHING MODE:  
MAX. SWITCHING POWER:  
Max. SWITCHING CURRENT:  
MIN. SWITCHING CURRENT:  
MAX. CARRYING CURRENT:  
MAX. VOLTAGE:  
MIN. VOLTAGE:  
BOUNCE:  
CONTACT RESISTANCE after life:  
DIELECTRIC STRENGTH between contacts or contacts and frame:  
INSULATION RESISTANCE between contacts or contacts and frame:

### Silver

BBM\*  
5VA  
250 mA  
10 mA  
5A  
25V  
5V  
<5ms  
<100mΩ  
500 V rms  
>10<sup>9</sup>Ω

### Gold

BBM\*  
0.2VA  
20 mA  
1 mA  
1A  
25V  
1V  
<5ms  
<100mΩ  
500 V rms  
>10<sup>9</sup>Ω

### Environmental Data

OPERATING TEMPERATURE: -25°C to +70°C  
STORAGE TEMPERATURE: -40°C to +85°C  
TOTALLY SEALED: Immersion test acc. to MIL R22.097 F and NFC 20631/QF

\* BBM= Break Before Make (non-starting)

### Materials

HOUSING: PBT thermoplastic and PC thermoplastic  
STATIONARY CONTACTS & TERMINALS: Nickel plated Brass with additional Gold or Silver plating, insert molded in PBT thermoplastic.  
ROTOR: Printed circuit, gold or silver plated.  
ACTUATOR: Steel  
BUSHING: Brass  
HARDWARE: Stop pin and spring: Stainless steel  
All models are RoHS compliant and compatible.

**NOTE:** Specifications and materials listed above are for switches with standard options. For information on specific and custom switches, consult Customer Service Center.

### Mechanical Data

NUMBER OF BANKS: 1 to 4  
OPERATING TORQUE: 5 Ncm±30% (with 1 module)  
MECHANICAL STOP RESISTANCE: >70 Ncm  
BUSHING MOUNTING TORQUE: 100 Ncm

### Build-A-Switch

To order, simply select desired option from each category and place in the appropriate box. Available options are shown and described on pages L-23 thru L-27. For additional options not shown in catalog, consult Customer Service Center.



### Designation

**RTBH**

### Indexing

- 1** 15°/24 positions max.
- 2** 22.5°/16 positions max.
- 3** 30°/12 positions max.
- 4** 36°/10 positions max.

### Number of Banks\*\*

- 1** 1 Bank
- 2** 2 Banks
- 3** 3 Banks
- 4** 4 Banks

**Switch Function Number of Poles or code (binary code = B, complement = C, direct +complement = BC) (first digit), Stop (with=S, without=W), Maximum Position (third & fourth digit)**

- 1S02** SP, 02 positions with stop
- 1S03** SP, 03 positions with stop
- 1S04** SP, 04 positions with stop
- 1S05** SP, 05 positions with stop
- 1S06** SP, 06 positions with stop
- 1S07** SP, 07 positions with stop
- 1S10** SP, 10 positions with stop
- 1W10** SP, 10 positions without stop
- 1S11** SP, 11 positions with stop
- 1S12** SP, 12 positions with stop
- 1W12** SP, 12 positions without stop
- 1S14** SP, 14 positions with stop
- 1S16** SP, 16 positions with stop
- 1W16** SP, 16 positions without stop
- 1S24** SP, 24 positions with stop
- 1W24** SP, 24 positions without stop
- 2S04** DP, 4 positions with stop
- 2S05** DP, 5 positions with stop
- 2S06** DP, 6 positions with stop
- GS\_\_** Gray Code with stop (indicate position)

### Shaft Diameter & Style

- N** Standard Shaft .236(6,0)
- P** Standard Shaft .250(6,3)
- F** Standard Shaft .236(6,0)
- G** Shaft with flat .250(6,3)
- S** Shaft with flat .236(6,0)
- T** Shaft with flat .250(6,3)

### Seal

- A** Standard bushing for panel mount
- D** Sealed bushing for panel mount

### Contact Material

- S** Silver plated, matte-tin terminal
- P** Gold plated, matte-tin terminal

### Actuator Length

- Z** (.984) 25 mm

### Actuator Option Angle\*

- N** None for actuators without a flat
- 0** 0° angle
- 3** 30° angle
- 6** 60° angle
- 9** 90° angle
- 2** 120° angle
- 8** 180° angle
- 7** 270° angle

- GW\_\_** Gray Code without stop (indicate position) only can be 10,12, 16, 24 based on indexing
- BS\_\_** Binary Code with stop (indicate position)
- BW\_\_** Binary Code without stop (indicate position) only can be 10,12, 16, 24 based on indexing
- CS\_\_** Complement with stop (indicate position)
- CW\_\_** Complement without stop (indicate position) only can be 10,12, 16, 24 based on indexing
- ES\_\_** Direct+Complement with stop (indicate position)
- EW\_\_** Direct+Complement without stop (indicate position) only can be 10,12, 16, 24 based on indexing

\* Other angles available by request

\*\* Several functions can be combined. For more information consult us.

\*\*\*Note: Metric diameter shafts are only available with metric diameter bushings, standard 1.250 inch diameter shafts are only available with standard 3/8 diameter bushings.

**NOTE:** S&T Shaft Diameter and Style are only available with Actuator Option angle 0, 6, 9, 2.



Dimensions are shown: Inch (mm)  
Specifications and dimensions subject to change

Dimensions L		
Number modules	inch	mm
<b>1</b>	0.500	12.7
<b>2</b>	0.700	17.78
<b>3</b>	0.900	22.86
<b>4</b>	1.100	27.94

Dimensions A	
A: (standard)	
0.984 inch (25 mm)	

Dimensions B	
0.236 or 0.250 inch	
(Ø6 or 6.35 mm)	

- Rotary

[illegible]

- [www.ck-components.com](http://www.ck-components.com)

## RTBH Series 1-2 Pole Coded Rotary Switches

## SWITCH FUNCTION

Switch Function Number of Poles or code (binary code = B, complement = C, direct +complement = BC)  
(first digit), Stop (with=S, without=W), Maximum Position (third & fourth digit)

<b>1S02</b>	SP, 02 positions with stop	<b>2S04</b>	DP, 4 positions with stop
<b>1S03</b>	SP, 03 positions with stop	<b>2S05</b>	DP, 5 positions with stop
<b>1S04</b>	SP, 04 positions with stop	<b>2S06</b>	DP, 6 positions with stop
<b>1S05</b>	SP, 05 positions with stop	<b>GS__</b>	Gray Code with stop (indicate position)
<b>1S06</b>	SP, 06 positions with stop	<b>GW__</b>	Gray Code without stop (indicate position) only can be 10,12, 16, 24 based on indexing
<b>1S07</b>	SP, 07 positions with stop	<b>BS__</b>	Binary Code with stop (indicate position)
<b>1S10</b>	SP, 10 positions with stop	<b>BW__</b>	Binary Code without stop (indicate position) only can be 10,12, 16, 24 based on indexing
<b>1W10</b>	SP, 10 positions without stop	<b>CS__</b>	Complement with stop (indicate position)
<b>1S11</b>	SP, 11 positions with stop	<b>CW__</b>	Complement without stop (indicate position) only can be 10,12, 16, 24 based on indexing
<b>1S12</b>	SP, 12 positions with stop	<b>ES__</b>	Direct+Complement with stop (indicate position)
<b>1W12</b>	SP, 12 positions without stop	<b>EW__</b>	Direct+Complement without stop (indicate position) only can be 10,12, 16, 24 based on indexing
<b>1S14</b>	SP, 14 positions with stop		
<b>1S16</b>	SP, 16 positions with stop		
<b>1W16</b>	SP, 16 positions without stop		
<b>1S24</b>	SP, 24 positions with stop		
<b>1W24</b>	SP, 24 positions without stop		

## 1 Single Pole Function 1S10, 1S12, 1S16, 1S24

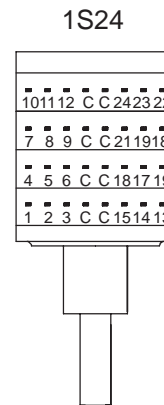
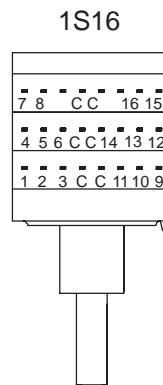
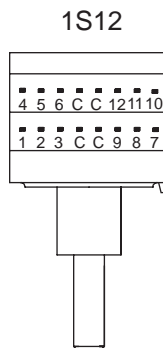
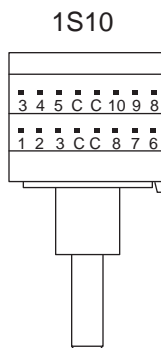
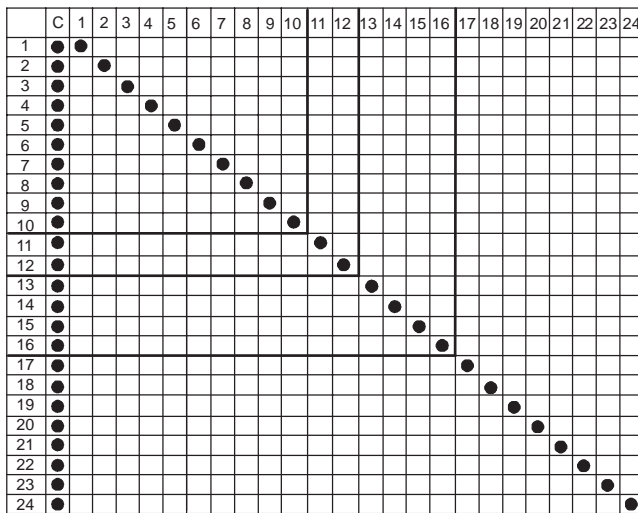

**NOTE:** Switch depicted from top down onto PCB.

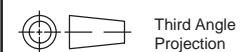

Dimensions are shown: Inch (mm)  
Specifications and dimensions subject to change

# RTBH Series 1-2 Pole Coded Rotary Switches

## SWITCH FUNCTION

### 2 DOUBLE POLE FUNCTION

	C <sub>1</sub>	1 <sub>1</sub>	2 <sub>1</sub>	3 <sub>1</sub>	4 <sub>1</sub>	5 <sub>1</sub>	6 <sub>1</sub>	C <sub>2</sub>	1 <sub>2</sub>	2 <sub>2</sub>	3 <sub>2</sub>	4 <sub>2</sub>	5 <sub>2</sub>	6 <sub>2</sub>
1	●	●						●	●					
2	●		●					●		●				
3	●			●				●			●			
4	●				●			●				●		
5	●					●		●					●	
6	●						●	●						●

2S06

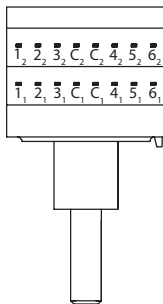

NOTE: Switch depicted from top down onto PCB.

### B BINARY DIRECT CODE

	C	1	2	4	8	16
0	●	●	●	●	●	●
1	●	●	●	●	●	●
2	●	●	●	●	●	●
3	●	●	●	●	●	●
4	●	●	●	●	●	●
5	●	●	●	●	●	●
6	●	●	●	●	●	●
7	●	●	●	●	●	●
8	●	●	●	●	●	●
9	●	●	●	●	●	●
10	●	●	●	●	●	●
11	●	●	●	●	●	●
12	●	●	●	●	●	●
13	●	●	●	●	●	●
14	●	●	●	●	●	●
15	●	●	●	●	●	●
16	●	●	●	●	●	●
17	●	●	●	●	●	●
18	●	●	●	●	●	●
19	●	●	●	●	●	●
20	●	●	●	●	●	●
21	●	●	●	●	●	●
22	●	●	●	●	●	●
23	●	●	●	●	●	●

BS10 BS12 BS16

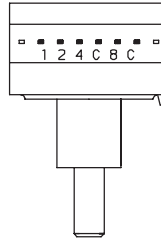

BS24

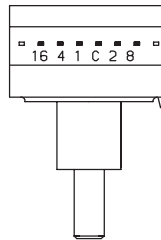

NOTE: Switch depicted from top down onto PCB.

### C COMPLEMENT BINARY CODE

	C	1	2	4	8	16
0	●	●	●	●	●	●
1	●	●	●	●	●	●
2	●	●	●	●	●	●
3	●	●	●	●	●	●
4	●	●	●	●	●	●
5	●	●	●	●	●	●
6	●	●	●	●	●	●
7	●	●	●	●	●	●
8	●	●	●	●	●	●
9	●	●	●	●	●	●
10	●	●	●	●	●	●
11	●	●	●	●	●	●
12	●	●	●	●	●	●
13	●	●	●	●	●	●
14	●	●	●	●	●	●
15	●	●	●	●	●	●
16	●	●	●	●	●	●
17	●	●	●	●	●	●
18	●	●	●	●	●	●
19	●	●	●	●	●	●
20	●	●	●	●	●	●
21	●	●	●	●	●	●
22	●	●	●	●	●	●
23	●	●	●	●	●	●

CS10 CS12 CS16

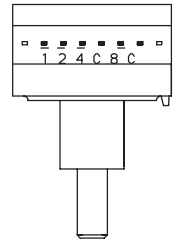

CS24

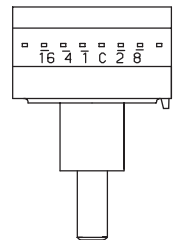

NOTE: Switch depicted from top down onto PCB.

### G GRAY CODE

	C	1	2	3	4	5
1	●	●	●	●	●	●
2	●	●	●	●	●	●
3	●	●	●	●	●	●
4	●	●	●	●	●	●
5	●	●	●	●	●	●
6	●	●	●	●	●	●
7	●	●	●	●	●	●
8	●	●	●	●	●	●
9	●	●	●	●	●	●
10	●	●	●	●	●	●
11	●	●	●	●	●	●
12	●	●	●	●	●	●
13	●	●	●	●	●	●
14	●	●	●	●	●	●
15	●	●	●	●	●	●
16	●	●	●	●	●	●
17	●	●	●	●	●	●
18	●	●	●	●	●	●
19	●	●	●	●	●	●
20	●	●	●	●	●	●
21	●	●	●	●	●	●
22	●	●	●	●	●	●
23	●	●	●	●	●	●
24	●	●	●	●	●	●

GS10 GS12 GS16

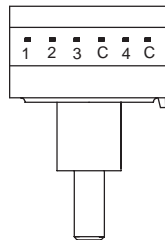

GS24

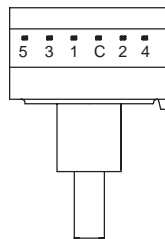

NOTE: Switch depicted from top down onto PCB.

### E DIRECT AND COMPLEMENT BINARY CODE

	C	1	2	4	8	16	C	1	2	4	8	16
0	●	●	●	●	●	●	●	●	●	●	●	●
1	●	●	●	●	●	●	●	●	●	●	●	●
2	●	●	●	●	●	●	●	●	●	●	●	●
3	●	●	●	●	●	●	●	●	●	●	●	●
4	●	●	●	●	●	●	●	●	●	●	●	●
5	●	●	●	●	●	●	●	●	●	●	●	●
6	●	●	●	●	●	●	●	●	●	●	●	●
7	●	●	●	●	●	●	●	●	●	●	●	●
8	●	●	●	●	●	●	●	●	●	●	●	●
9	●	●	●	●	●	●	●	●	●	●	●	●
10	●	●	●	●	●	●	●	●	●	●	●	●
11	●	●	●	●	●	●	●	●	●	●	●	●
12	●	●	●	●	●	●	●	●	●	●	●	●
13	●	●	●	●	●	●	●	●	●	●	●	●
14	●	●	●	●	●	●	●	●	●	●	●	●
15	●	●	●	●	●	●	●	●	●	●	●	●
16	●	●	●	●	●	●	●	●	●	●	●	●
17	●	●	●	●	●	●	●	●	●	●	●	●
18	●	●	●	●	●	●	●	●	●	●	●	●
19	●	●	●	●	●	●	●	●	●	●	●	●
20	●	●	●	●	●	●	●	●	●	●	●	●
21	●	●	●	●	●	●	●	●	●	●	●	●
22	●	●	●	●	●	●	●	●	●	●	●	●
23	●	●	●	●	●	●	●	●	●	●	●	●

ES10 ES12 ES16

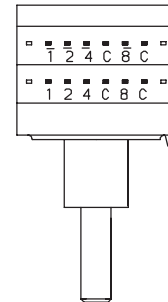

ES24

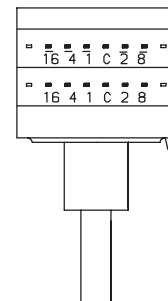

NOTE: Switch depicted from top down onto PCB.



# RTBH Series

## 1-2 Pole Coded Rotary Switches

SEAL 

**A** STANDARD BUSHING FOR PANEL MOUNT

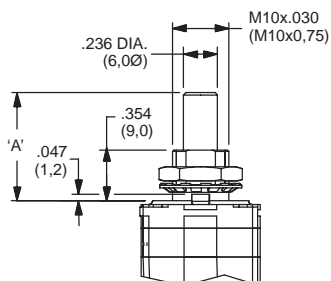

**D** SEALED BUSHING FOR PANEL MOUNT

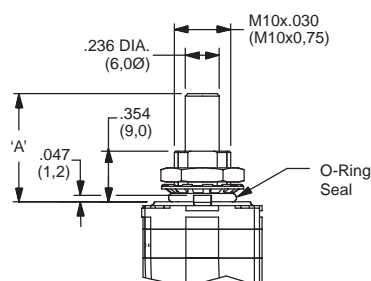

SHAFT DIAMETER & STYLE 

**N** METRIC SHAFT 0.236 (6,0)

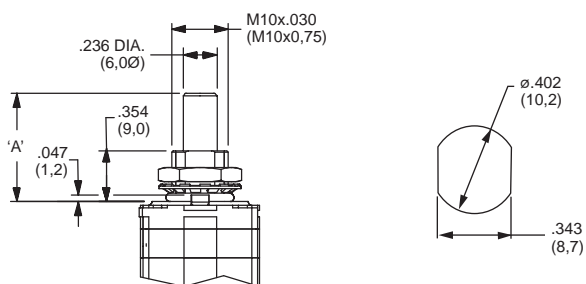

**P** STANDARD SHAFT 0.25 (6,3)

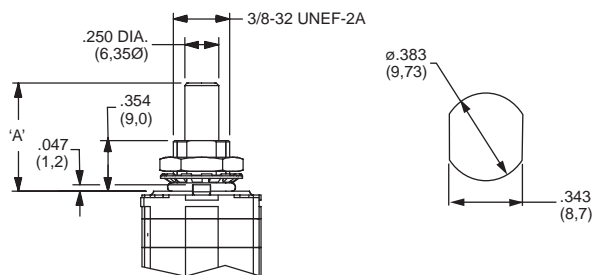

**F** METRIC SHAFT WITH FLAT 0.236 (6,0)

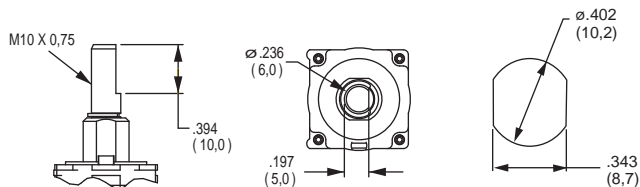

**G** STANDARD SHAFT WITH FLAT 0.25 (6,3)

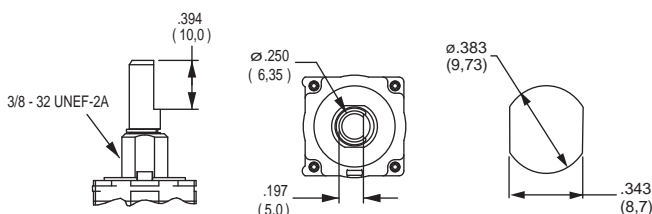

**S** METRIC SHAFT WITH FLAT 0.236 (6,0)

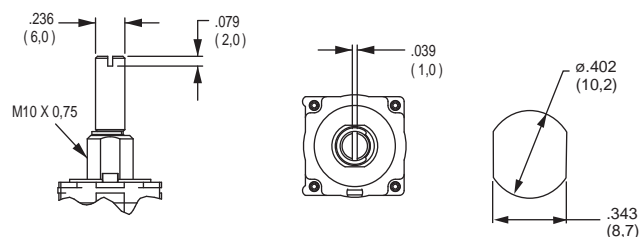

**T** STANDARD SHAFT WITH FLAT 0.25 (6,3)

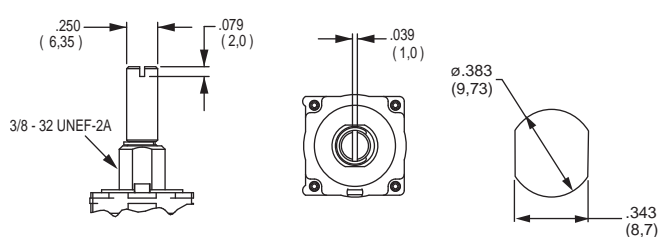

\*\*\*Note: Metric diameter shafts are only available with metric diameter bushings, standard 1.250 inch diameter shafts are only available with standard 3/8 diameter bushings.



Third Angle  
Projection

Dimensions are shown: Inch (mm)

Specifications and dimensions subject to change

**C&K**

# C&K RTBH Series 1-2 Pole Coded Rotary Switches

## ACTUATOR OPTION ANGLE



SHAFT WITH FLAT OPTIONS

**N (None)** FOR ACTUATORS WITHOUT A FLAT

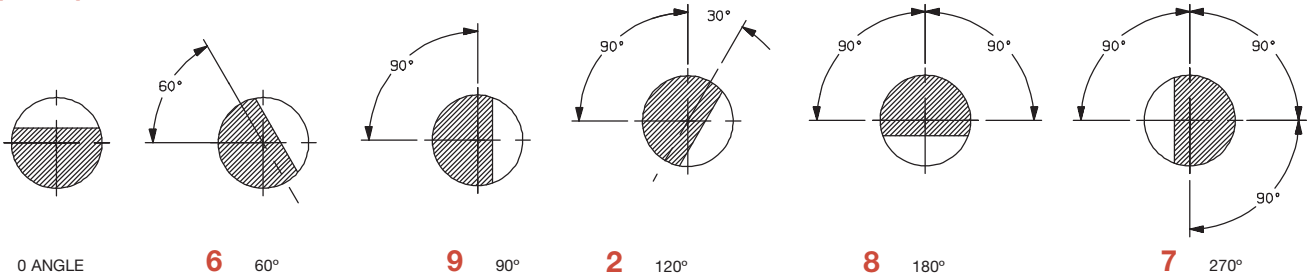

SHAFT WITH SLOT OPTIONS

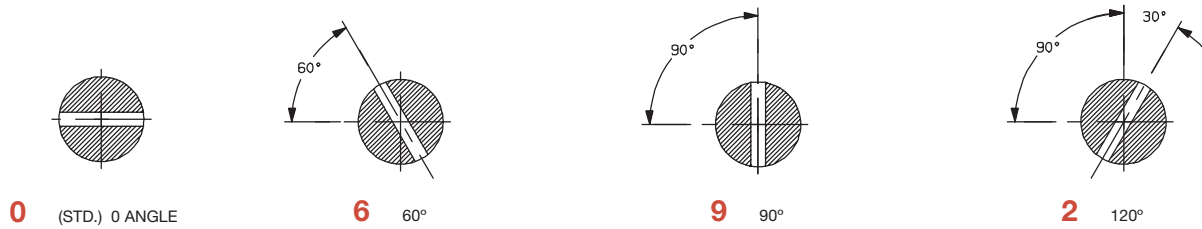

## ACTUATOR LENGTH



**Z** (.984) 0,25 mm STANDARD SHAFT

Other lengths available by request.

## CONTACT MATERIAL



OPTION CODE	CONTACT AND TERMINAL MATERIAL	RATING
<b>S</b>	SILVER	SWITCH: 250 mA, POWER: 5 VA; CARRY: 5 AMPS
<b>P</b>	GOLD	SWITCH: 20 mA, POWER: 0.2 VA; CARRY: 1 AMP

\* Note: See Technical Data section of this catalog for RoHS compliant and compatible definition and specifications.

### SWITCHING POWER

**S** (SILVER CONTACTS)

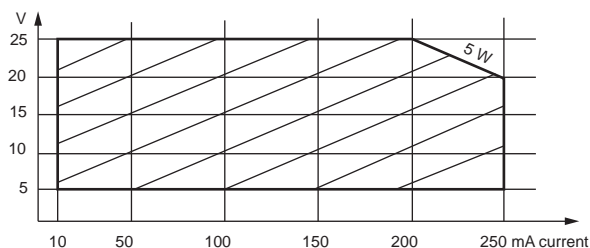

**P** (GOLD CONTACTS)

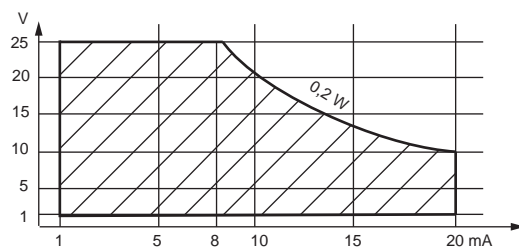

**C&K**



Third Angle  
Projection

Dimensions are shown: Inch (mm)  
Specifications and dimensions subject to change

# RTBV Series

## 1-2 Pole Coded Rotary Switches



### Features/Benefits

- **Totally sealed**
- **Detent angles, 15 , 22.5 , 30 and 36**
- **Multi pole**
- **Coding functions**
- **Robust construction**
- **RoHS Compliant**

### Typical Applications

- **Telecommunications**
- **Military**
- **Instrumentation**
- **Heavy-duty industrial equipment**

### Electrical Data

SWITCHING MODE:  
MAX. SWITCHING POWER:  
MAX. SWITCHING CURRENT:  
MIN. SWITCHING CURRENT:  
MAX. CARRYING CURRENT:  
MAX. VOLTAGE:  
MIN. VOLTAGE:  
BOUNCE:  
CONTACT RESISTANCE after life:  
DIELECTRIC STRENGTH between contacts or contacts and frame:  
INSULATION RESISTANCE between contacts or contacts and frame:

### Silver

BBM\*  
5VA  
250 mA  
10 mA  
5A  
25V  
5V  
<5ms  
<100mΩ  
500 V rms  
>10<sup>9</sup>Ω

### Gold

BBM\*  
0.2VA  
20 mA  
1 mA  
1A  
25V  
1V  
<5ms  
<100mΩ  
500 V rms  
>10<sup>9</sup>Ω

### Environmental Data

OPERATING TEMPERATURE: -25°C to +70°C  
STORAGE TEMPERATURE: -40°C to +85°C  
TOTALLY SEALED: Immersion test acc. to MIL R22.097 F and NFC 20631/QF

\* BBM= Break Before Make (non-starting)

### Materials

HOUSING: PBT thermoplastic and PC thermoplastic  
STATIONARY CONTACTS & TERMINALS: Nickel plated Brass with additional Gold or Silver plating, insert molded in PBT thermoplastic.  
ROTOR: Printed circuit, gold or silver plated.  
ACTUATOR: Steel  
BUSHING: Brass  
HARDWARE: Stop pin and spring: Stainless steel  
All models are RoHS compliant and compatible.

**NOTE:** Specifications and materials listed above are for switches with standard options. For information on specific and custom switches, consult Customer Service Center.

### Mechanical Data

NUMBER OF BANKS: 1 to 10  
OPERATING TORQUE: 5 Ncm±30% (with 1 module)  
MECHANICAL STOP RESISTANCE: >70 Ncm  
BUSHING MOUNTING TORQUE: 100 Ncm

### Build-A-Switch

To order, simply select desired option from each category and place in the appropriate box. Available options are shown and described on pages L-29 thru L-33. For additional options not shown in catalog, consult Customer Service Center.

<p><b>Designation</b> <b>RTBV</b></p> <p><b>Indexing</b> 1 15°/24 positions max. 2 22.5°/16 positions max. 3 30°/12 positions max. 4 36°/10 positions max.</p> <p><b>Number of Banks**</b> 1 1 Bank 2 2 Banks 3 3 Banks 4 4 Banks</p> <p><b>Switch Function Number of Poles or code (binary code = B, complement = C, direct +complement = BC) (first digit), Stop (with=S, without=W), Maximum Position (third &amp; fourth digit)</b>  <b>1S02</b> SP, 02 positions with stop  <b>1S03</b> SP, 03 positions with stop  <b>1S04</b> SP, 04 positions with stop  <b>1S05</b> SP, 05 positions with stop  <b>1S06</b> SP, 06 positions with stop  <b>1S07</b> SP, 07 positions with stop  <b>1S10</b> SP, 10 positions with stop  <b>1W10</b> SP, 10 positions without stop  <b>1S11</b> SP, 11 positions with stop  <b>1S12</b> SP, 12 positions with stop  <b>1W12</b> SP, 12 positions without stop  <b>1S14</b> SP, 14 positions with stop  <b>1S16</b> SP, 16 positions with stop  <b>1W16</b> SP, 16 positions without stop  <b>1S24</b> SP, 24 positions with stop  <b>1W24</b> SP, 24 positions without stop  <b>2S04</b> DP, 4 positions with stop  <b>2S05</b> DP, 5 positions with stop  <b>2S06</b> DP, 6 positions with stop</p>	<p><b>Contact Material</b> S Silver plated, matte-tin terminal P Gold plated, matte-tin terminal</p> <p><b>Actuator Length</b> Z (.984) 25 mm</p> <p><b>Actuator Option Angle*</b> N None for actuators without a flat 0 0° angle 3 30° angle 6 60° angle 9 90° angle 2 120° angle 8 180° angle 7 270° angle</p> <p><b>Shaft Diameter &amp; Style***</b> N Standard Shaft .236(6,0) P Standard Shaft .250(6,3) F Standard Shaft .236(6,0) G Shaft with flat .250(6,3) S Shaft with flat .236(6,0) T Shaft with flat .250(6,3)</p> <p><b>Seal</b> A Standard bushing for panel mount D Sealed bushing for panel mount</p> <p><b>GS_</b> Gray Code with stop (indicate position)  <b>GW_</b> Gray Code without stop (indicate position) only can be 10,12, 16, 24 based on indexing  <b>BS_</b> Binary Code with stop (indicate position)  <b>BW_</b> Binary Code without stop (indicate position) only can be 10,12, 16, 24 based on indexing  <b>CS_</b> Complement with stop (indicate position)  <b>CW_</b> Complement without stop (indicate position) only can be 10,12, 16, 24 based on indexing  <b>ES_</b> Direct+Complement with stop (indicate position)  <b>EW_</b> Direct+Complement without stop (indicate position) only can be 10,12, 16, 24 based on indexing</p>
--	--

\* Other angles available by request

\*\* Several functions can be combined. For more information consult us.

\*\*\*Note: Metric diameter shafts are only available with metric diameter bushings, standard 1.250 inch diameter shafts are only available with standard 3/8 diameter bushings.

**NOTE:** S&T Shaft Diameter and Style are only available with Actuator Option angle 0, 6, 9, 2.



Dimensions are shown: Inch (mm)  
Specifications and dimensions subject to change

## DESIGNATION



## RTBV DIMENSIONAL DRAWINGS

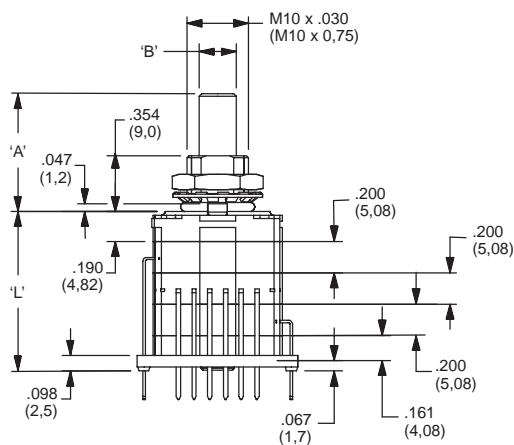
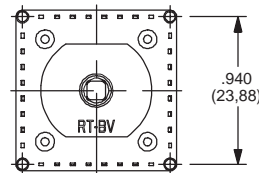
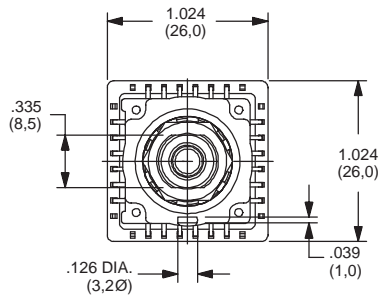

Dimensions L		
Number modules	inch	mm
1	0.419	10.65
2	0.619	15.73
3	0.819	20.81
4	1.02	25.89

### Dimensions A

A: (standard)  
0.984 inch (25 mm)

### Dimensions B

0.236 or 0.250 inch  
(Ø6 or 6.35 mm)

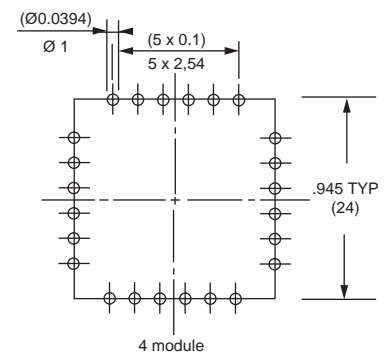
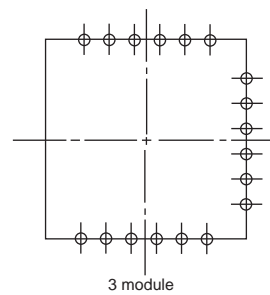
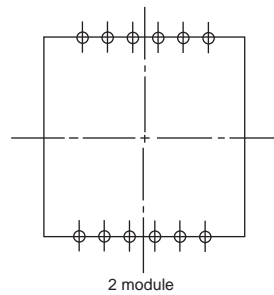
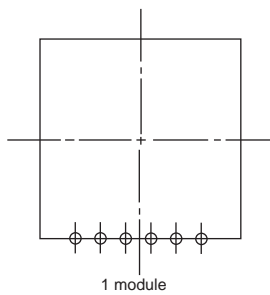

Rotary

## INDEXING



- 1 15° index/24 positions
- 2 22.5° index/16 positions
- 3 30° index/12 positions
- 4 36° index/10 positions



### Third Angle Projection

Dimensions are shown: Inch (mm)  
Specifications and dimensions subject to change

RTBV Series  
1-2 Pole Coded Rotary Switches

NUMBER OF BANKS

- 1 1 BANK
- 2 2 BANKS
- 3 3 BANKS
- 4 4 BANKS

NOTE: Several functions can be combined. For more information consult customer service.

SWITCH FUNCTION

Switch Function Number of Poles or code (binary code = B, complement = C, direct +complement = BC) (first digit), Stop (with=S, without=W), Maximum Position (third & fourth digit)

- 1S02

SP, 02 positions with stop
- 1S03

SP, 03 positions with stop
- 1S04

SP, 04 positions with stop
- 1S05

SP, 05 positions with stop
- 1S06

SP, 06 positions with stop
- 1S07

SP, 07 positions with stop
- 1S10

SP, 10 positions with stop
- 1W10

SP, 10 positions without stop
- 1S11

SP, 11 positions with stop
- 1S12

SP, 12 positions with stop
- 1W12

SP, 12 positions without stop
- 1S14

SP, 14 positions with stop
- 1S16

SP, 16 positions with stop
- 1W16

SP, 16 positions without stop
- 1S24

SP, 24 positions with stop
- 1W24

SP, 24 positions without stop
- 2S04

DP, 4 positions with stop
- 2S05

DP, 5 positions with stop
- 2S06

DP, 6 positions with stop
- GS\_

Gray Code with stop (indicate position)
- GW\_

Gray Code without stop (indicate position) only can be 10,12, 16, 24 based on indexing
- BS\_

Binary Code with stop (indicate position)
- BW\_

Binary Code without stop (indicate position) only can be 10,12, 16, 24 based on indexing
- CS\_

Complement with stop (indicate position)
- CW\_

Complement without stop (indicate position) only can be 10,12, 16, 24 based on indexing
- ES\_

Direct+Complement with stop (indicate position)
- EW\_

Direct+Complement without stop (indicate position) only can be 10,12, 16, 24 based on indexing

- 1 Single Pole Function 1S10, 1S12, 1S16, 1S24

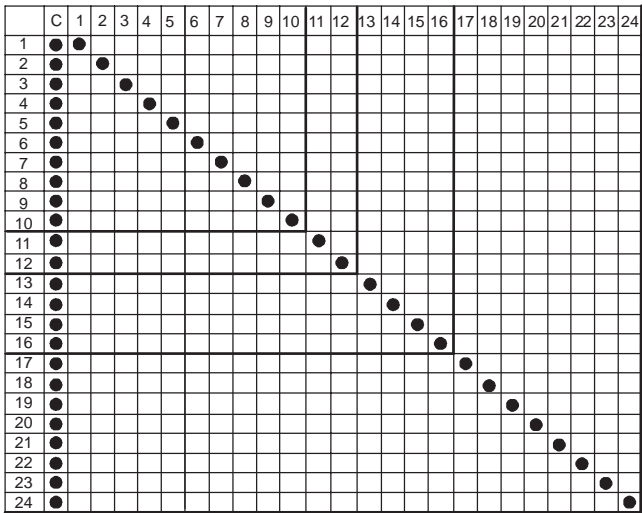

1S10

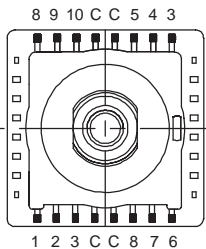

1S12

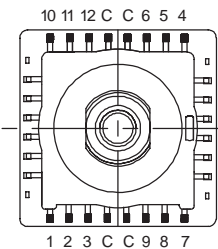

1S16

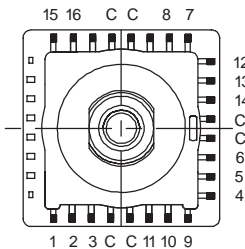

1S24

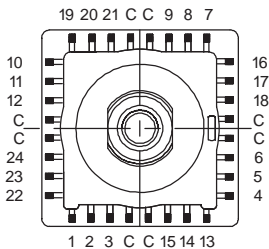

Third Angle  
Projection

Dimensions are shown: Inch (mm)  
Specifications and dimensions subject to change



# RTBV Series 1-2 Pole Coded Rotary Switches

## SWITCH FUNCTION

### 2 DOUBLE POLE FUNCTION

	C <sub>1</sub>	1 <sub>1</sub>	2 <sub>1</sub>	3 <sub>1</sub>	4 <sub>1</sub>	5 <sub>1</sub>	6 <sub>1</sub>	C <sub>2</sub>	1 <sub>2</sub>	2 <sub>2</sub>	3 <sub>2</sub>	4 <sub>2</sub>	5 <sub>2</sub>	6 <sub>2</sub>
1	●	●						●	●					
2	●		●					●		●				
3	●			●				●			●			
4	●				●			●				●		
5	●					●		●					●	
6	●						●	●						●

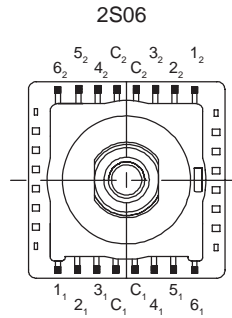

### B BINARY DIRECT CODE

	C	1	2	4	8	16
0	●					
1	●	●				
2	●		●			
3	●	●	●			
4	●			●		
5	●	●			●	
6	●	●	●	●		
7	●	●	●			
8	●					●
9	●	●				●
10	●		●			●
11	●	●	●			●
12	●			●		●
13	●	●			●	●
14	●	●	●	●		●
15	●	●	●			●
16	●					●
17	●	●				●
18	●		●			●
19	●	●	●			●
20	●			●		●
21	●	●			●	●
22	●	●	●	●		●
23	●	●	●			●

BS10 BS12 BS16

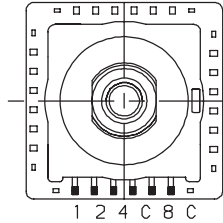

BS24

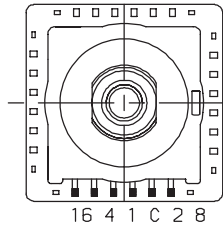

### C COMPLEMENT BINARY CODE

	C	1	2	4	8	16
0	●	●	●	●	●	●
1	●	●	●	●	●	●
2	●	●	●	●	●	●
3	●	●	●	●	●	●
4	●	●	●	●	●	●
5	●	●	●	●	●	●
6	●	●	●	●	●	●
7	●	●	●	●	●	●
8	●	●	●	●	●	●
9	●	●	●	●	●	●
10	●	●	●	●	●	●
11	●	●	●	●	●	●
12	●	●	●	●	●	●
13	●	●	●	●	●	●
14	●	●	●	●	●	●
15	●	●	●	●	●	●
16	●	●	●	●	●	●
17	●	●	●	●	●	●
18	●	●	●	●	●	●
19	●	●	●	●	●	●
20	●	●	●	●	●	●
21	●	●	●	●	●	●
22	●	●	●	●	●	●
23	●	●	●	●	●	●

CS10 CS12 CS16

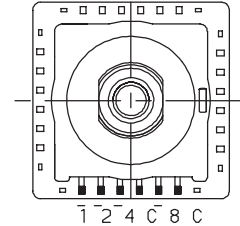

CS24

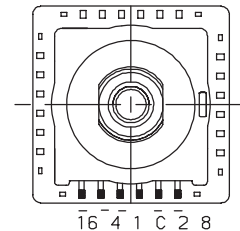

### G GRAY CODE

	C	1	2	3	4	5
1	●					
2	●	●				
3	●		●			
4	●			●		
5	●				●	
6	●	●	●			
7	●		●	●		
8	●			●	●	
9	●	●		●		●
10	●	●	●			●
11	●	●	●	●		
12	●	●	●		●	
13	●	●	●			●
14	●	●	●	●		
15	●	●	●		●	
16	●	●	●			●
17	●	●	●	●		
18	●	●	●		●	
19	●	●	●	●		
20	●	●	●		●	
21	●	●	●	●		
22	●	●	●		●	
23	●	●	●	●		
24	●	●	●		●	

GS10 GS12 GS16

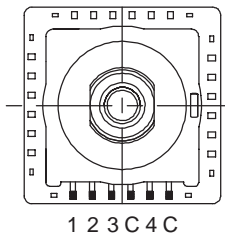

GS24

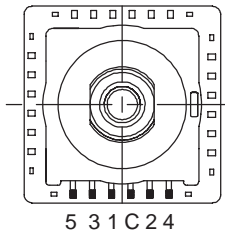

### E DIRECT AND COMPLEMENT BINARY CODE

	C	1	2	4	8	16	C	1	2	4	8	16
0	●						●	●	●	●	●	●
1	●	●					●	●	●	●	●	●
2	●		●				●	●	●	●	●	●
3	●	●	●				●	●	●	●	●	●
4	●			●			●	●	●	●	●	●
5	●	●			●		●	●	●	●	●	●
6	●	●	●	●			●	●	●	●	●	●
7	●	●	●				●	●	●	●	●	●
8	●	●				●	●	●	●	●	●	●
9	●	●					●	●	●	●	●	●
10	●	●	●				●	●	●	●	●	●
11	●	●	●	●			●	●	●	●	●	●
12	●	●	●			●	●	●	●	●	●	●
13	●	●	●				●	●	●	●	●	●
14	●	●	●	●			●	●	●	●	●	●
15	●	●	●			●	●	●	●	●	●	●
16	●	●					●	●	●	●	●	●
17	●	●					●	●	●	●	●	●
18	●	●	●				●	●	●	●	●	●
19	●	●	●	●			●	●	●	●	●	●
20	●	●			●		●	●	●	●	●	●
21	●	●	●			●	●	●	●	●	●	●
22	●	●	●	●			●	●	●	●	●	●
23	●	●	●			●	●	●	●	●	●	●

ES10 ES12 ES16

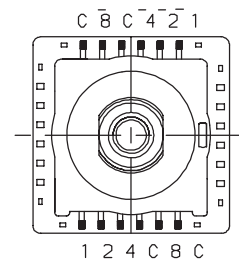

ES24

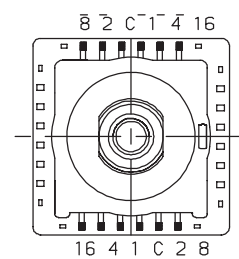

Rotary

# RTBV Series

## 1-2 Pole Coded Rotary Switches

### SEAL

**A** STANDARD BUSHING FOR PANEL MOUNT

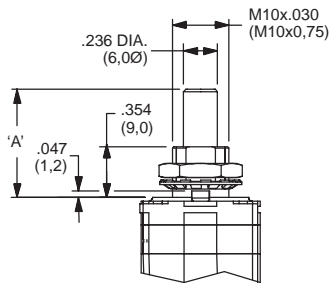

**D** SEALED BUSHING FOR PANEL MOUNT

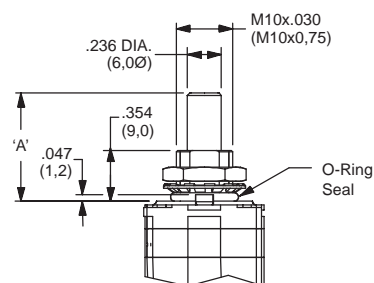

### SHAFT DIAMETER & STYLE

**N** STANDARD SHAFT 0.236 (6,0)

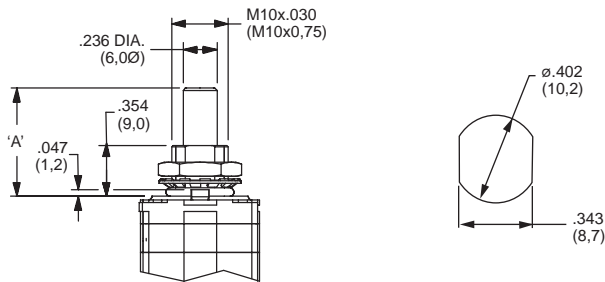

**P** STANDARD SHAFT 0.250 (6,3)

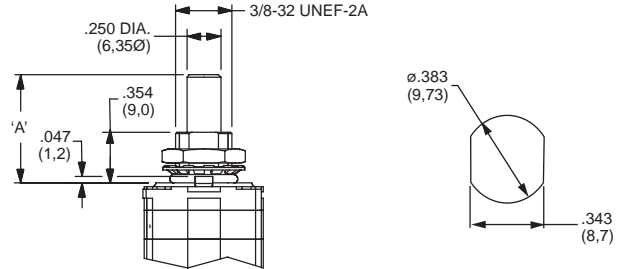

**F** SHAFT WITH FLAT 0.236 (6,0)

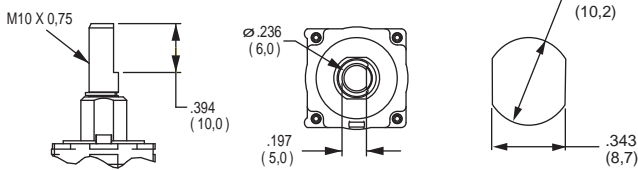

**G** SHAFT WITH FLAT 0.250 (6,3)

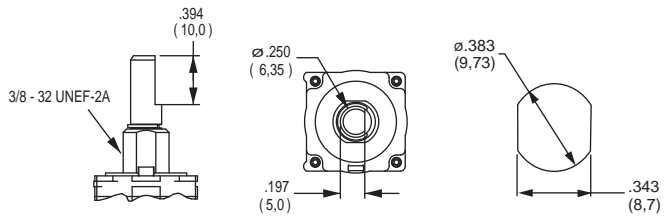

**S** SHAFT WITH SLOT 0.236 (6,0)

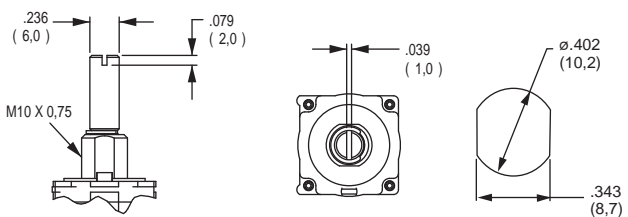

**T** SHAFT WITH SLOT 0.250 (6,3)

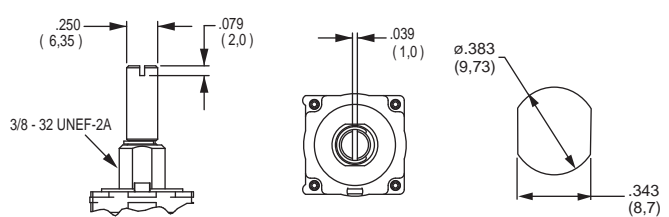

\*\*\*Note: Metric diameter shafts are only available with metric diameter bushings, standard 1.250 inch diameter shafts are only available with standard 3/8 diameter bushings.



Dimensions are shown: Inch (mm)  
Specifications and dimensions subject to change

**C&K**

# RTBV Series 1-2 Pole Coded Rotary Switches

## ACTUATOR OPTION ANGLE



SHAFT WITH FLAT OPTIONS

**N (None)**

FOR ACTUATORS WITHOUT A FLAT

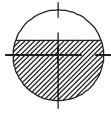

**0** 0 ANGLE

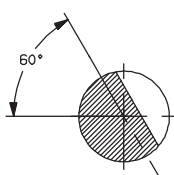

**6** 60°

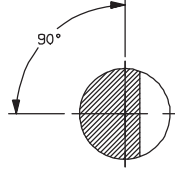

**9** 90°

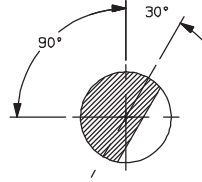

**2** 120°

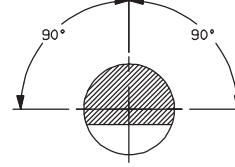

**8** 180°

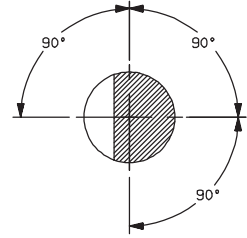

**7** 270°

SHAFT WITH SLOT OPTIONS

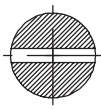

**0** 0 ANGLE

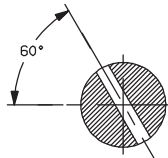

**6** 60°

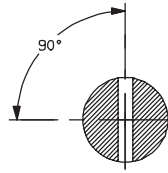

**9** 90°

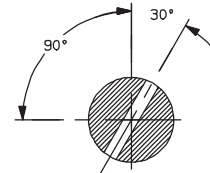

**2** 120°

\* Note: S&T Shaft Diameter and Style are only available with Actuator Option Angle 0, 6, 9, 2.

## ACTUATOR LENGTH



**Z**

(.984) 0,25 mm STANDARD SHAFT

Other lengths available by request.

## CONTACT MATERIAL



OPTION CODE	CONTACT AND TERMINAL MATERIAL	RATING
<b>S</b>	SILVER	SWITCH: 250 mA, POWER: 5 VA; CARRY: 5 AMPS
<b>P</b>	GOLD	SWITCH: 20 mA, POWER: 0.2 VA; CARRY: 1 AMP

\* Note: See Technical Data section of this catalog for RoHS compliant and compatible definition and specifications.

## SWITCHING POWER

**S**

(SILVER CONTACTS)

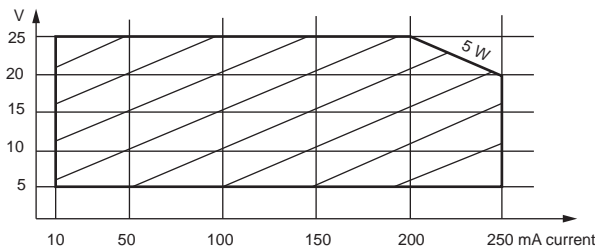

Switching power: 5 W  
Max. voltage: 25 V  
Min. voltage: 5 V  
Max. switching current: 250 mA  
Min. switching current: 10 mA

**P**

(GOLD CONTACTS)

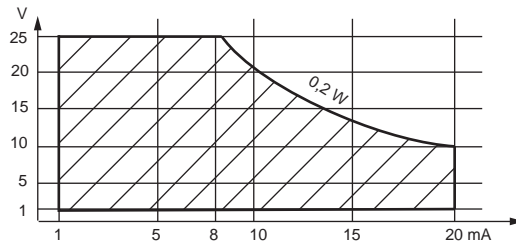

Switching power: 0.2 W  
Max. voltage: 25 V  
Min. voltage: 1 V  
Max. switching current: 20 mA  
Min. switching current: 1 mA

**C&K**



Third Angle  
Projection

Dimensions are shown: Inch (mm)  
Specifications and dimensions subject to change



Rotary



# R Series

## ROTA-SLIDE® Rotary Switches



### Features/Benefits

- Multi-pole and multi-position
- Positive detent
- Panel and PCB mounting
- Enclosed
- RoHS Compliant

### Typical Applications

- Ceiling fans
- Industrial equipment
- Portable tools



### Specifications

CONTACT RATING: Q contact material: 5 AMPS @ 125 V AC; 2.5 AMPS @ 250 V AC; 0.5 AMP @ 125 V DC; 1/8 HP @ 125 and 250 VAC (UL/CSA).  
See page L-36 for additional ratings.

ELECTRICAL LIFE: 10,000 make-and-break cycles at full load.

CONTACT RESISTANCE: Below 10 m  $\Omega$  typ. initial @ 2-4 V DC, 100 mA, for both silver and gold plated contacts.

INSULATION RESISTANCE: 10<sup>9</sup>  $\Omega$  min.

DIELECTRIC STRENGTH: 1,000 Vrms min. @ sea level.

INDEXING: 36°-one contact models, 10 position max.; two contact models, 5 position max.

OPERATING & STORAGE TEMPERATURE: -30°C to 95°C

### Materials

HOUSING & BUSHING: 6/6 nylon (UL 94V-2).  
ACTUATOR: 6/6 nylon (UL 94V-2).  
CONTACTS & TERMINALS: Q contact material: Copper, silver plated.  
See page L-36 for additional contact materials.  
CONTACT SPRING: Music wire or stainless steel.  
MOUNTING NUT: Steel, zinc plated.  
TERMINAL SEAL: Epoxy.

**NOTE:** Any models supplied with Q or B contact material are RoHS compliant.

**NOTE:** Specifications and materials listed above are for switches with standard options. For information on specific and custom switches, consult Customer Service Center.

### Build-A-Switch

To order, simply select desired option from each category and place in the appropriate box. Available options are shown and described on pages L-35 and L-36. For additional options not shown in catalog, consult Customer Service Center.



#### Switch Function

- R100** SP, 36° Index, 10 pos. no stops
- R103** SP, 36° Index, 3 pos.
- R104** SP, 36° Index, 4 pos.
- R108** SP, 36° Index, 8 pos.
- R203** DP, 36° Index, 3 pos.
- R204** DP, 36° Index, 4 pos.
- R205** DP, 36° Index, 5 pos.

#### Actuator

- 07** .500" high with .156" flat
- 05** .375" high with .156" flat
- 15** Screwdriver slot without bushing

#### Mounting Style

- RR** 3/8-32 threaded bushing
- RN** PC without bushing
- RS** PC without bushing

#### Terminations

- 03** Solder lug with hole
- 01** Solder lug with notch
- 02** PC Thru-hole
- WC** Wire Lead

#### Contact Material

- Q** Silver
- B** Gold

#### Seal

- NONE** No seal
- E** Epoxy seal



Dimensions are shown: Inch (mm)  
Specifications and dimensions subject to change

# R Series ROTA-SLIDE® Rotary Switches

## SWITCH FUNCTION

SP MODELS 36° INDEXING			
NO. POLES	MODEL NO.	SWITCH FUNCTION	TERMINALS
SP	<b>R100</b>	10 Position No Stops	All Terminals
	<b>R103</b>	3 Position	10-1-2-3
	<b>R104</b>	4 Position	10-1-2-3-4
	<b>R108</b>	8 Position	10-1-2-3-4-5-6-7-8

SP MODELS 36° INDEXING  
SCHEMATIC

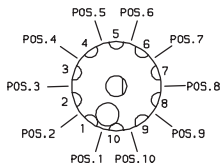

DP MODELS 36° INDEXING			
NO. POLES	MODEL NO.	SWITCH FUNCTION	TERMINALS
DP	<b>R203</b>	3 Position	10-1-2-3,5-6-7-8
	<b>R204</b>	4 Position	All Terminals
	<b>R205</b>	5 Position	All Terminals

DP MODELS 36° INDEXING  
SCHEMATIC

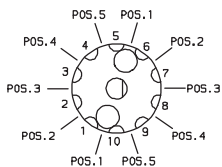

All models with all options when ordered with 'Q' contact material.

**NOTE:** Break-before-make contacts. Actuators and contacts are shown in position 1. No common terminal is present. Switching function is provided by movable contacts shorting adjacent pairs of stationary contacts.

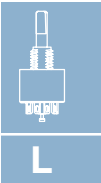
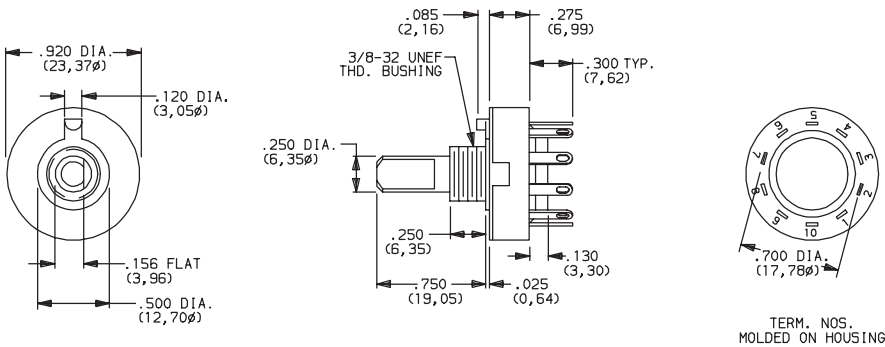

Rotary

## ACTUATOR

- 07**
.500" HIGH WITH .156" FLAT
- 05**
.375" HIGH WITH .156" FLAT
- 15**
SCREWDRIVER SLOT

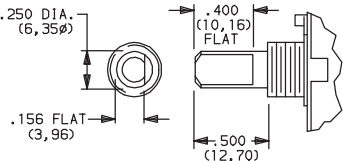

Shown with 'RR' mounting style. For mounting styles without bushing, add .250 (6,35) to actuator length.

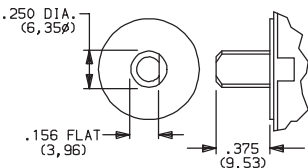

Shown with 'RN' mounting style.

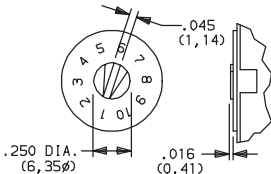

Arrow on actuator marked red (std.). Shown with 'RS' mounting style.

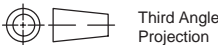

Dimensions are shown: Inch (mm)  
Specifications and dimensions subject to change

# R Series ROTA-SLIDE® Rotary Switches

## MOUNTING STYLE

**RR** 3/8-32 THREADED BUSHING

**RN** PC WITHOUT BUSHING

**RS** PC SCREWDRIVER SLOT WITHOUT BUSHING

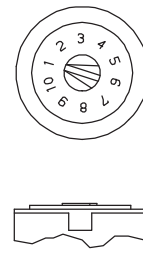
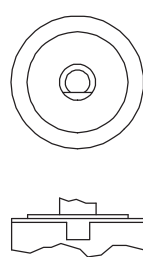
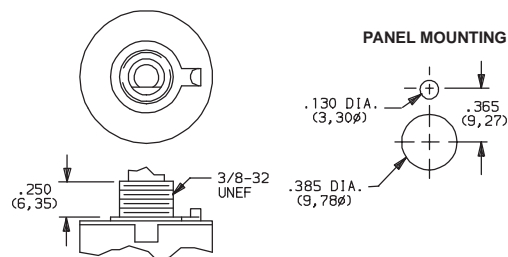

Position numbers and characters are molded on housing.

Mounting nut included (part number 175000100).

## TERMINATIONS

**03** SOLDER LUG WITH HOLE

**01** SOLDER LUG WITH NOTCH

**02** PC THRU-HOLE

**WC** WIRE LEAD

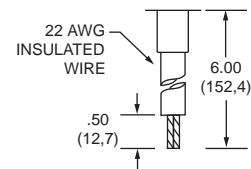
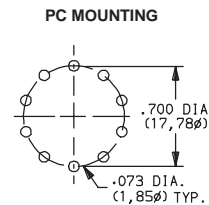
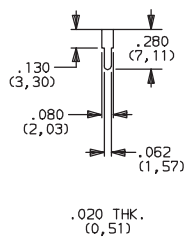
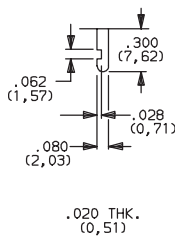
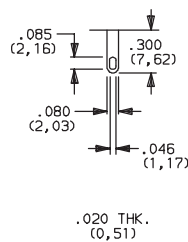

## CONTACT MATERIAL

OPTION CODE	CONTACT AND TERMINAL MATERIAL	RATING	
		POWER	5 AMPS @ 125 V AC; 2.5 AMPS @ 250 V AC; 0.5 AMP @ 125 V DC (UL/CSA); 1/8 HP @ 125 and 250 VAC (UL/CSA).
<b>Q</b>	SILVER <sup>2</sup>		
<b>B</b>	GOLD <sup>1</sup>	LOW LEVEL/DRY CIRCUIT	0.4 VA MAX. @ 20 V AC or DC MAX.

\* Note: See Technical Data section of this catalog for RoHS compliant and compatible definition and specifications.

<sup>1</sup> CONTACTS & TERMINALS: Copper, with gold plate over nickel plate.

<sup>2</sup> CONTACTS & TERMINALS: Copper, silver plated. (Standard with all termination options.)

**NOTE:** Any models supplied with Q, B or G contact material are RoHS compliant.

All models  with all options when ordered with 'Q' contact material.

## SEAL

**NONE** NO SEAL

**E** EPOXY SEAL

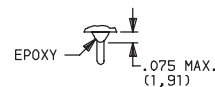

**C&K**



Third Angle  
Projection

Dimensions are shown: Inch (mm)  
Specifications and dimensions subject to change

[www.ck-components.com](http://www.ck-components.com)

# F Series Miniature ROTA-SLIDE® Rotary Switches

## Features/Benefits

- Multi-pole and multi-position
- Panel and PCB mounting
- Positive detent
- Value added capability
- RoHS Compliant

## Typical Applications

- Small appliances
- Testing fixtures
- Safety equipment



## Specifications

CONTACT RATING: Q contact material: 4 AMPS @ 125 V AC or 28 V DC; 2 AMPS @ 250 V AC (UL/CSA). See page L-40 for additional ratings.

ELECTRICAL LIFE: 10,000 make-and-break cycles at full load.

CONTACT RESISTANCE: Below 10 m  $\Omega$  typ. initial @ 2-4 V DC, 100 mA, for both silver and gold plated contacts.

INSULATION RESISTANCE: 10<sup>9</sup>  $\Omega$  min.

DIELECTRIC STRENGTH: 1,000 Vrms min. @ sea level.

INDEXING: 45° or 90° -one contact models; two contact models, 4 pos. max. Models with common terminal -90°, 4 pos. max.

OPERATING & STORAGE TEMPERATURE: -30°C to 65°C

## Materials

HOUSING & BUSHING: 6/6 Nylon (UL 94V-2).

ACTUATOR: 6/6 nylon (UL 94V-2).

CONTACTS: Q contact material: Copper, silver plated. See page L-40 for additional contact materials.

TERMINALS: Q contact material: Copper, silver plated. See page L-39 for additional contact materials.

CONTACT SPRING: Music wire or stainless steel.

MOUNTING NUT: Brass, nickel plated.

TERMINAL SEAL: Epoxy.

**NOTE:** Any models supplied with Q or B contact material are RoHS compliant.

**NOTE:** Specifications and materials listed above are for switches with standard options. For information on specific and custom switches, consult Customer Service Center.

## Build-A-Switch

To order, simply select desired option from each category and place in the appropriate box. Available options are shown and described on pages L-38 thru L-40. For additional options not shown in catalog, consult Customer Service Center.

<div style="display: flex; justify-content: space-around; align-items: center;"> <div style="border: 1px solid black; width: 30px; height: 20px;"></div> <div style="border: 1px solid black; width: 30px; height: 20px;"></div> <div style="border: 1px solid black; width: 30px; height: 20px;"></div> <div style="border: 1px solid black; width: 30px; height: 20px;"></div> <div style="border: 1px solid black; width: 30px; height: 20px;"></div> <div style="border: 1px solid black; width: 30px; height: 20px;"></div> <div style="border: 1px solid black; width: 30px; height: 20px;"></div> <div style="border: 1px solid black; width: 30px; height: 20px;"></div> <div style="border: 1px solid black; width: 30px; height: 20px;"></div> <div style="border: 1px solid black; width: 30px; height: 20px;"></div> </div>		
<b>Switch Function</b> <b>FA05</b> SP, 90° Index, 3 pos. <b>F103</b> SP, 45° Index, 3 pos. <b>F203</b> DP, 45° Index, 3 pos. <b>FA01</b> SPDT, 90° Index <b>FC03</b> SP, W/Common 90° Index, 3 pos.	<b>Actuator</b> <b>15</b> Screwdriver slot without bushing <b>08</b> .585" high with .156" flat	<b>Mounting Style</b> <b>RN</b> PC <b>RS</b> 5/16-32 threaded bushing
	<b>Terminations</b> <b>02</b> PC Thru-hole <b>WC</b> Wire lead	<b>Contact Material</b> <b>Q</b> Silver <b>B</b> Gold
		<b>Seal</b> <b>NONE</b> No seal <b>E</b> Epoxy seal

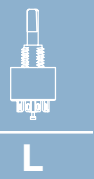

Rotary



Dimensions are shown: Inch (mm)  
Specifications and dimensions subject to change

# F Series

## Miniature ROTA-SLIDE® Rotary Switches

SWITCH FUNCTION

45° INDEXING			
NO. POLES	MODEL NO.	SWITCH FUNCTION	TERMINALS
SP	F103	3 Position	8-1-2-3*
DP	F203	3 Position	All Terminals

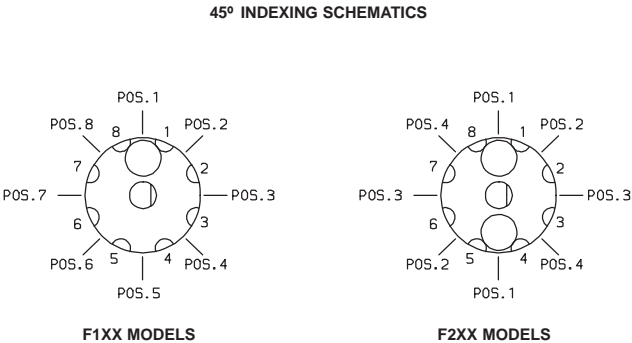

Break-before-make contacts. Terminal numbers are molded on bottom of housing. Actuators are shown in position 1.

F1XX, F2XX models: No common terminal is present. Switching function is provided by movable contacts shorting adjacent pairs of stationary contacts.

**NOTE:** \*Switches with '02' PC terminations have additional terminal no. 5 as switch support only. This terminal is not connected electrically inside switch.

90° INDEXING			
NO. POLES	MODEL NO.	SWITCH FUNCTION	TERMINALS
SP	FA01	SPDT	8-1-3
	FA05	3 Position	8-1-3-5
SP WITH COMMON	FC03	3 Position	C-1,C-2,C-3

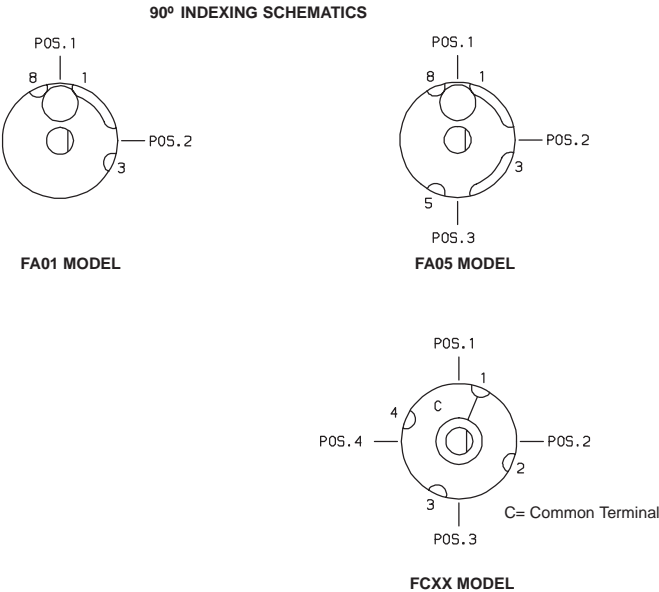

Break-before-make contacts. Terminal numbers are molded on bottom of housing. Actuators are shown in position 1.

FAXX models: No common terminal is present. Switching function is provided by movable contacts shorting adjacent pairs of stationary contacts.

FCXX models: Common terminal is present.

**NOTE:** \*Switches with '02' PC terminations have additional terminal no. 5 as switch support only. This terminal is not connected electrically inside switch.

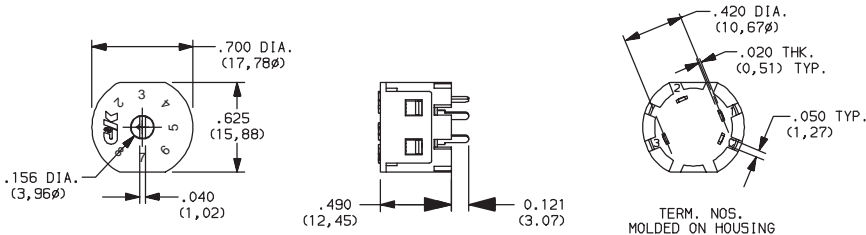

Part number show: FC0315RN02Q



Third Angle Projection

Dimensions are shown: Inch (mm)  
Specifications and dimensions subject to change



# F Series Miniature ROTA-SLIDE® Rotary Switches

## ACTUATOR

**15** SCREWDRIVER SLOT WITHOUT BUSHING

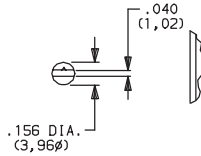

Shown with 'RN' mounting style; not available with 'RS' mounting style or FCXX models.

**08** .585" HIGH WITH .156" FLA

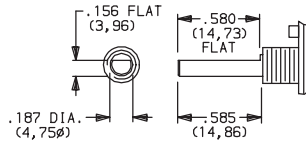

Must be ordered with 'RS' mounting style.

## MOUNTING STYLE

**RN** PC

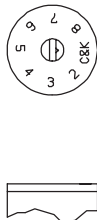

PC mount, no bushing, position numbers molded standard. Shown with '15' actuator; not available with '08' actuator or FCXX models.

**RS** 5/16-32 THREADED BUSHING

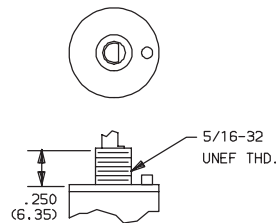

Panel mount, with 5/16 in.-32 threaded bushing. Mounting nut (P/N 175020201) included. Must be ordered with '08' actuator option.

**PANEL MOUNTING**

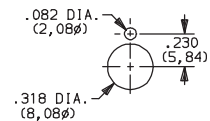

5/16 IN. BUSHING

## TERMINATIONS

**02** PC THRU-HOLE

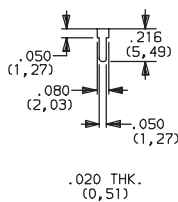

**WC** WIRE LEAD

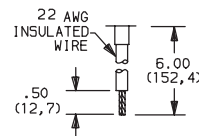

Black wire standard, other colors and lengths available, consult Customer Service Center. UL style 1015.

**F1XX, F2XX & FAXX Models**

**02** PC THRU-HOLE

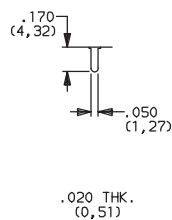

**FCXX Models**

**PC MOUNTING**

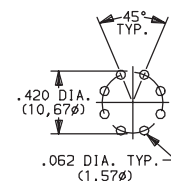

Third Angle Projection

Dimensions are shown: Inch (mm)  
Specifications and dimensions subject to change

**C&K**

# F Series

## Miniature ROTA-SLIDE® Rotary Switches



### CONTACT MATERIAL

OPTION CODE	CONTACT AND TERMINAL MATERIAL	RATING	
Q	SILVER <sup>2</sup>	POWER	4 AMPS @ 125 V AC or 28 V DC; 2 AMPS @ 250 V AC (UL/CSA).
B	GOLD <sup>1</sup>	LOW LEVEL/DRY CIRCUIT	0.4 VA MAX. @ 20 V AC or DC MAX.

\* Note: See Technical Data section of this catalog for RoHS compliant and compatible definition and specifications.

<sup>1</sup> CONTACTS & TERMINALS: Copper, with gold plate over nickel plate.  
<sup>2</sup> CONTACTS & TERMINALS: Copper, silver plated (standard with all termination options).

**NOTE:** Any models supplied with Q or B contact material are RoHS compliant.

All models   with all options when ordered with 'Q' contact material.

### SEAL

**NONE** NO SEAL

**E** EPOXY SEAL

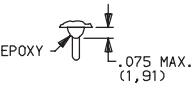

Not available on FCXX models.

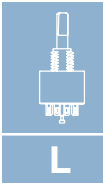

Rotary

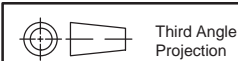

Dimensions are shown: Inch (mm)  
Specifications and dimensions subject to change

# H Series Power ROTA-SLIDE® Rotary Switches

## Features/Benefits

- Multi-pole and multi-position
- Positive detent
- Power switching up to 12 AMPS
- Value added capability
- RoHS Compliant

## Typical Applications

- Small appliances
- Industrial equipment
- Elevators



## Specifications

CONTACT RATING: 12 Amps @ 125 V AC; 6 AMPS @ 250 V AC;  
1 AMP @ 125 V DC (UL/CSA).  
ELECTRICAL LIFE: 10,000 make-and-break cycles at full load.  
INSULATION RESISTANCE:  $10^9 \Omega$  min.  
DIELECTRIC STRENGTH: 1,000 Vrms min. @ sea level.  
INDEXING: 45°-one contact models, 8 positions max.; two contact  
models, 4 positions max.  
OPERATING & STORAGE TEMPERATURE: -30°C to 95°C

## Materials

HOUSING & BUSHING: 6/6 nylon (UL 94V-2).  
ACTUATOR: 6/6 nylon (UL 94V-2).  
CONTACTS & TERMINALS: Copper, silver plated.  
CONTACT SPRING: Music wire or stainless steel.  
MOUNTING NUT: Steel, zinc plated.  
TERMINAL SEAL: Epoxy.

**NOTE:** Any models supplied with Q, B or G contact material are RoHS compliant.

**NOTE:** Specifications and materials listed above are for switches with standard options.  
For information on specific and custom switches, consult Customer Service Center.

## Build-A-Switch

To order, simply select desired option from each category and place in the appropriate box. Available options are shown and described on pages L-42 thru L-43. For additional options not shown in catalog, consult Customer Service Center.

<p><b>Switch Function</b></p> <p><b>H203</b> DP, 45° Index, 3 pos.</p> <p><b>H101</b> SPST, 45° Index</p> <p><b>H202</b> DPDT, 45° Index</p> <p><b>H204</b> DP, 45° Index, 4 pos.</p>	<p><b>Actuator</b></p> <p><b>07</b> .275" high with .156" flat</p>	<p><b>Mounting Style</b></p> <p><b>RR</b> 3/8-40 threaded bushing</p>	<p><b>Terminations</b></p> <p><b>05</b> .110" quick connect</p> <p><b>01</b> Solder lug with notch</p>	<p><b>Contact Material</b></p> <p><b>Q</b> Silver</p>
---	--	---	--	---

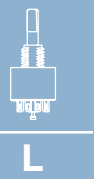

Rotary



Dimensions are shown: Inch (mm)  
Specifications and dimensions subject to change



# H Series

## Power ROTA-SLIDE® Rotary Switches

SWITCH FUNCTION

SP MODELS 45° INDEXING			
NO. POLES	MODEL NO.	SWITCH FUNCTION	TERMINALS
SP	H101	SPST	8-1

DP MODELS 45° INDEXING			
NO. POLES	MODEL NO.	SWITCH FUNCTION	TERMINALS
DP	H202	DPDT	7-8-1, 3-4-5
	H203	3 Position	All Terminals
	H204	4 Position	All Terminals

SP MODELS 45° INDEXING SCHEMATIC

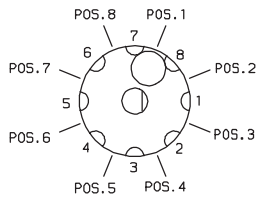

DP MODELS 45° INDEXING SCHEMATIC

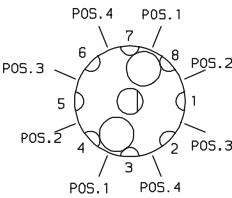

NOTE: Break-before-make contacts. Terminal numbers are molded on bottom of housing. Actuators and contacts are shown in position 1. No common terminal is present. Switching function is provided by movable contacts shorting adjacent pairs of stationary contacts.

All models with all options.

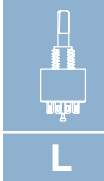

Rotary

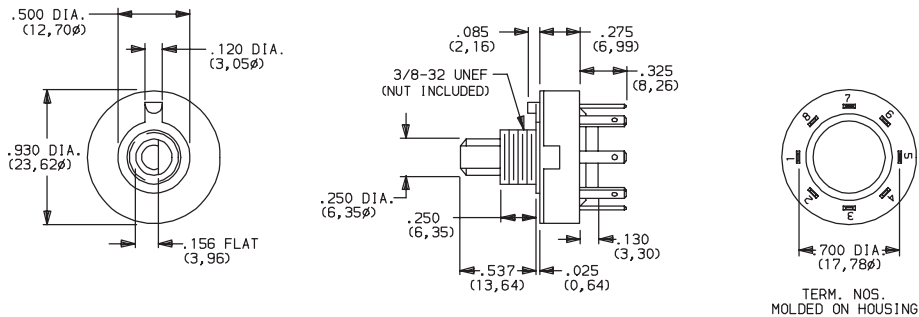

Part number shown: H10107RR05Q

ACTUATOR

**07** .275" HIGH WITH .156" FLAT

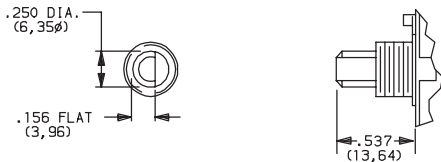

Dimensions are shown: Inch (mm)  
Specifications and dimensions subject to change

# H Series Power ROTA-SLIDE® Rotary Switches

## MOUNTING STYLE

**RR** 3/8-32 THREADED BUSHING

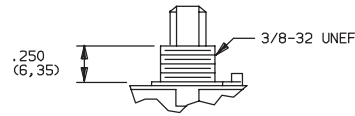

### PANEL MOUNTING

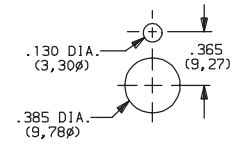

Mounting nut included (part number 175000100).

## TERMINATIONS

**05** SOLDER LUG WITH HOLE

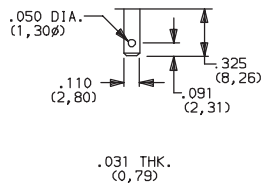

**01** SOLDER LUG WITH NOTCH

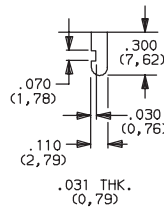

Not available on models with 90° indexing.

## CONTACT MATERIAL

OPTION CODE	CONTACT AND TERMINAL MATERIAL	RATING	
		POWER	12 AMPS @ 125 V AC; 6 AMPS @ 250 V AC; 1 AMP @ 125 V DC.
<b>Q</b>	SILVER <sup>1</sup>		

\* Note: See Technical Data section of this catalog for RoHS compliant and compatible definition and specifications.

<sup>1</sup> CONTACTS & TERMINALS: Copper, silver plated.

**NOTE:** Any models supplied with Q contact material are RoHS compliant.

All models   with all options.



Rotary



Third Angle  
Projection

Dimensions are shown: Inch (mm)  
Specifications and dimensions subject to change

# P Series

## Low Profile Key Switches



### Features/Benefits

- Low profile design
- Multi-pole and multi-position
- Panel and PCB mounting
- Variety of termination styles
- RoHS Compliant

### Typical Applications

- CATV
- Low cost security devices
- Lawn equipment



### Specifications

CONTACT RATING: Q contact material: 4 AMPS @ 125 V AC or 28 V DC; 2 AMPS @ 250 V AC (UL/CSA). See page L-46 for additional ratings.

ELECTRICAL LIFE: 10,000 make-and-break cycles at full load.

CONTACT RESISTANCE: Below 10 mΩ typ. initial @ 2-4 V DC, 100 mA, for both silver and gold plated contacts.

INSULATION RESISTANCE: 10<sup>9</sup> Ω min.

DIELECTRIC STRENGTH: 1,000 Vrms min. @ sea level.

INDEXING: 45° or 90°, 2-3 positions. Other functions available, consult Customer Service Center.

OPERATING & STORAGE TEMPERATURE: -30°C to 65°C

### Materials

HOUSING: One piece, 6/6 nylon (UL94V-2), black. Finish, matte.

KEY: One nickel plated brass key.

CONTACTS AND TERMINALS: Q contact material: Copper, silver plated. See page L-46 for additional contact materials.

CONTACT SPRING: Music wire or stainless steel.

TERMINAL SEAL: Epoxy.

**NOTE:** Any models supplied with Q, B or G contact material are RoHS compliant.

**NOTE:** Specifications and materials listed above are for switches with standard options. For information on specific and custom switchlocks, consult Customer Service Center.

### Build-A-Switch

To order, simply select desired option from each category and place in the appropriate box. Available options are shown and described on pages L-45 thru L-46. For additional options not shown in catalog, consult Customer Service Center.

#### Switch Function

- P10113** SP, 90° Index, Keypull pos. 1
- P20013** DP, 45° Index, Keypull pos. 1
- P20113** DP, 90° Index, Keypull pos. 1
- P1011U** SP, 90° Index, keypull pos. 1 & 2
- P2011U** DP, 90° Index, keypull pos. 1 & 2

#### Keying

- 3** One nickel plated brass key
- 2** Two nickel plated brass keys

#### Type

- W** Low profile key switch

#### Finish

- M** Matte finish

#### Terminations

- 03** Solder lug with hole
- 02** PC Thru-hole
- WC** Wire lead

#### Mounting Style

- N** With nut

#### Contact Material

- Q** Silver
- B** Gold
- G** Gold over silver

#### Seal

- NONE** No seal
- E** Epoxy seal

#### Color

- 2** Black



Dimensions are shown: Inch (mm)  
Specifications and dimensions subject to change

# P Series Low Profile Key Switches

## SWITCH FUNCTION

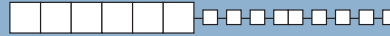

NO. POLES	MODEL NO.	CONNECTED TERMINALS (see terminal location below.)			KEY PULL POSITIONS	SWITCH CONFIGURATION	INDEXING
		POS.1	POS. 2	POS. 3			
DP	<b>P20013</b>	8-1,4-5	1-2,5-6	2-3, 6-7	Position 1		45°
SP DP	<b>P10113</b> <b>P20113</b>	8-1 8-1,4-5	1-3 1-3,5-7		Position 1		90°
SP DP	<b>P1011U</b> <b>P2011U</b>	8-1 8-1,4-5	1-3 1-3,5-7		Position 1 & 2		

### LEGEND

- = Detent Positions (45° or 90°).
- ⊙ = Key pull possible in these positions.
- ⊙ = Stop positions.

All models with all options when ordered with 'G' or 'Q' contact material.

### TERMINAL NUMBERS



Terminal numbers molded on bottom of housing.

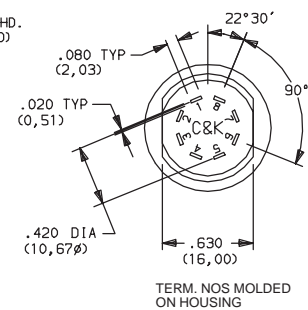
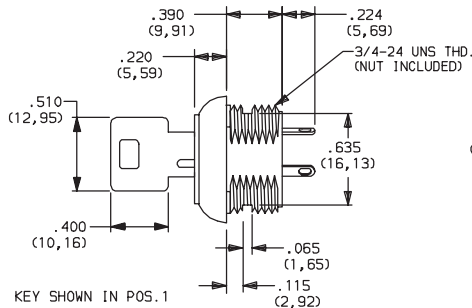
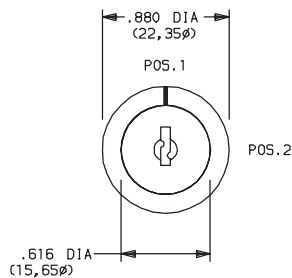

## KEYING



- 3** ONE NICKEL PLATED BRASS KEY
- 2** TWO NICKEL PLATED BRASS KEYS

**NOTE:** All models provided with the same key code.  
For replacement keys or special features, consult Customer Service Center.

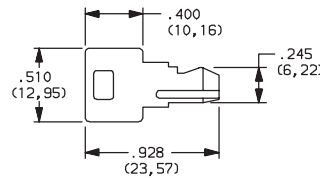

## TYPE

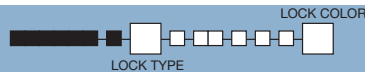

- W** LOW PROFILE KEY SWITCH

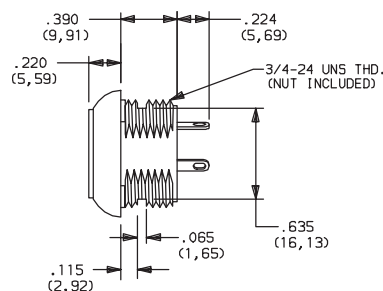

OPTION CODE	COLOR
<b>2</b>	<b>BLACK</b>

**NOTE:** Standard housing color is black. Special colors or mixed housing and key plug colors available, consult Customer Service Center.



Third Angle Projection



Dimensions are shown: Inch (mm)  
Specifications and dimensions subject to change



Rotary

P Series  
Low Profile Key Switches

FINISH

M MATTE FINISH

TERMINATIONS

03 SOLDER LUG WITH HOLE

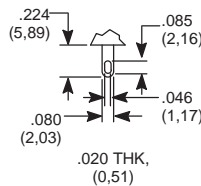

02 PC THRU-HOLE

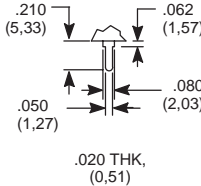

PC MOUNTING

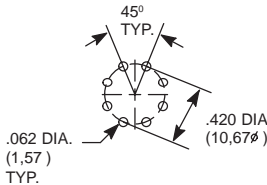

WC WIRE LEAD

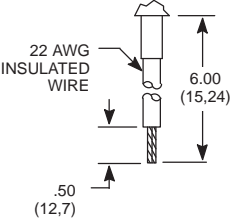

Black wire standard, other colors, gages, and lengths available, consult Customer Service Center. UL style 1015.

MOUNTING STYLE

N WITH NUT

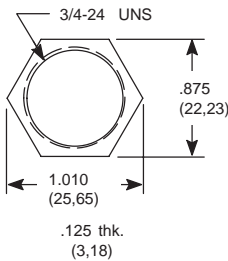

PANEL MOUNTING

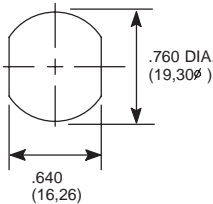

MOUNTING STYLE	PANEL THICKNESS
N (with nut)	.215 (5,46) max.

Nut part number: 175050700

CONTACT MATERIAL

OPTION CODE	CONTACT AND TERMINAL MATERIAL	RATING	
Q	SILVER <sup>2</sup>	POWER	4 AMPS @ 125 V AC or 28 V DC; 2 AMPS @ 250 AC V AC (UL/CSA).
B	GOLD <sup>1</sup>	LOW LEVEL/DRY CIRCUIT	0.4 VA MAX. @ 20 V AC or DC MAX
G	GOLD OVER SILVER <sup>3</sup>	LOW LEVEL/DRY CIRCUIT OR POWER	0.4 VA MAX. @ 20 V AC or DC MAX. or 4 AMPS @ 125 V AC or 28 V DC; 2 AMPS @ 250 V AC (UL/CSA)

\* Note: See Technical Data section of this catalog for RoHS compliant and compatible definition and specifications.

<sup>1</sup> CONTACTS & TERMINALS: Copper, with gold plate over nickel plate.

<sup>2</sup> CONTACTS & TERMINALS: Copper, silver plated (Standard with all termination options).

<sup>3</sup> CONTACTS & TERMINALS: Copper, with gold plate over silver plate.

**NOTE:** Any models supplied with Q, B or G contact material are RoHS compliant.

All models  with all options when ordered with 'G' or 'Q' contact material.

**NOTE:** 'G' contact material is equivalent to both 'B' and 'Q' contact materials.

SEAL

NONE NO SEAL

E EPOXY SEAL

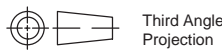
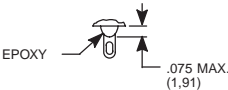

Third Angle Projection

Dimensions are shown: Inch (mm)  
Specifications and dimensions subject to change

C&K

# Mouser Electronics

Authorized Distributor

Click to View Pricing, Inventory, Delivery & Lifecycle Information:

[C&K Components:](#)

[AT527M](#)