

DO NOT
SCALE FROM
THIS PRINT

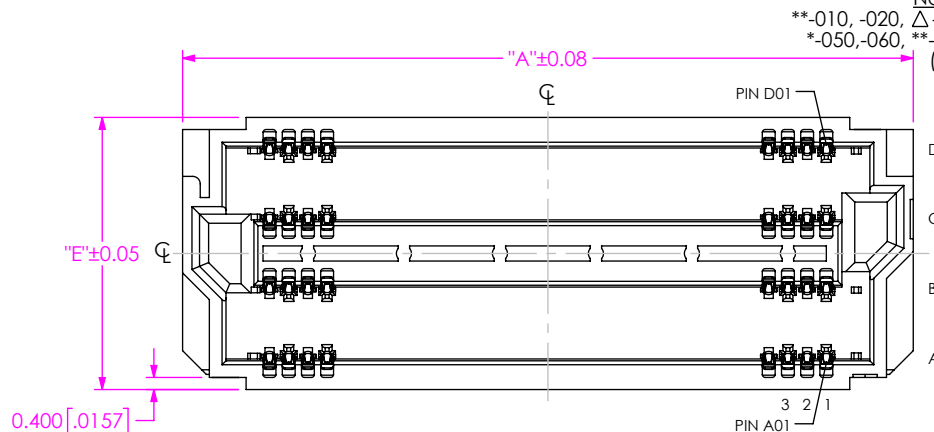

No OF POSITIONS
**-010, -020, Δ-025, **-030, Δ-037, -040,
*-050, -060, **-070, **-080, **-090, -100
(PER ROW)

LEAD STYLE
-03.5: 3.5MM

PLATING SPECIFICATION

-L: 10μ" SELECTIVE GOLD
IN CONTACT AREA,
MATTE TIN ON TAIL
-S: 30μ" SELECTIVE GOLD
IN CONTACT AREA,
MATTE TIN ON TAIL
-STL: 30μ" SELECTIVE GOLD
IN CONTACT AREA,
TIN/LEAD ON TAIL.

ROW

-04: 4 ROW
-06: 6 ROW (NOT AVAILABLE WITH
-A OR BLANK OPTIONS)
-08: 8 ROW

TAPE & REEL
(SEE NOTE 7)

-TR: TAPE & REEL
-FR: FULL QTY TAPE AND REEL

OPTION

BLANK: NO ALIGNMENT PIN
-A: ALIGNMENT PIN (SEE SHT 4, FIG 4)
-L: SQUEEZE LATCH (SEE SHT 6, FIG 7,
NOT AVAILABLE WITH -A OPTION,
ONLY AVAILABLE IN -025 & -037 POS
WITH -04, -06 & -08 ROW)
-T: TH LOCKING TOOL (SEE SHT 6, FIG 8,
NOT AVAILABLE WITH -A OPTION,
ONLY AVAILABLE IN -025 & -037 POS
WITH -04, -06 & -08 ROW)
-S: SM LOCKING TOOL (SEE SHT 7, FIG 9,
NOT AVAILABLE WITH -A OPTION,
ONLY AVAILABLE IN -025 & -037 POS
WITH -06 & -08 ROW)

TERMINATION

-0: COLUMN (SEE NOTE 8)
-2: BALL (95.5% TIN/3.8% SILVER/0.7% COPPER)
(FOR EXISTING CUSTOMERS ONLY)

(PACKAGING: TAPE & REEL, SEE NOTE 1)
(☒ = ONLY AVAILABLE IN -025, -037 & -100 POSITIONS.
ONLY AVAILABLE WITH -0 TERMINATION)
(Δ = ONLY AVAILABLE IN -L, -T & -S OPTION)
(** = NOT RELEASED)

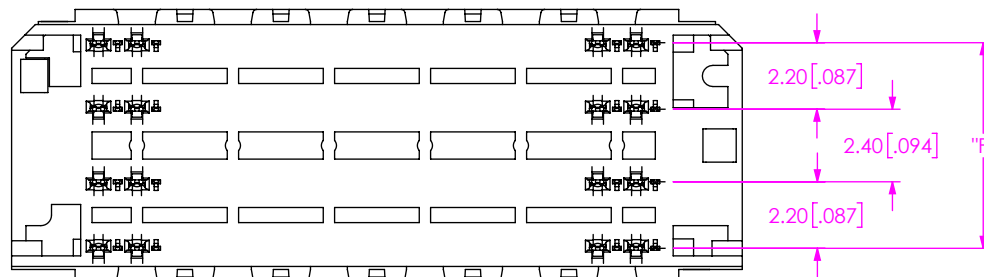
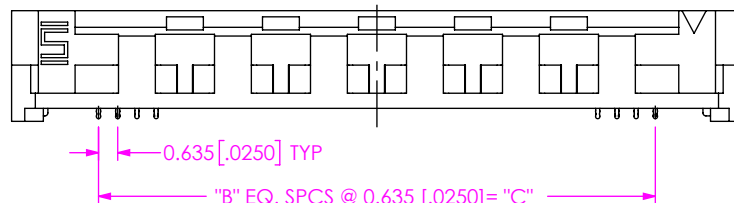
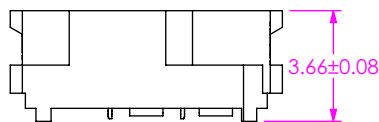

TABLE 4		
No. OF ROWS	"E"	"F"
-04	9.00 [0.354]	6.80 [0.268]
-06	13.60 [0.535]	11.40 [0.449]
-08	18.20 [0.717]	16.00 [0.630]

TABLE 1		
STACK HEIGHT		
APF6 LEAD STYLE	APM6 LEAD STYLE	
	-01.5	-06.5
-03.5	5.00 [0.197]	10.00 [0.394]

FIG 1
APF6-030-03.5-XXX-04-0-XR SHOWN
(SOME CENTER FEATURES REMOVED FOR CLARITY)

TABLE 2			
No OF POS PER ROW	"A"	"B"	"C"
-010	11.47 [0.451]	9	5.72 [0.225]
-020	17.82 [0.701]	19	12.07 [0.475]
-030	24.17 [0.951]	29	18.42 [0.725]
-040	30.52 [1.201]	39	24.77 [0.975]
-050	36.87 [1.451]	49	31.12 [1.225]
-060	43.22 [1.701]	59	37.47 [1.475]
-070	49.57 [1.951]	69	43.82 [1.725]
-080	55.92 [2.201]	79	50.17 [1.975]
-090	62.27 [2.451]	89	56.52 [2.225]
-100	68.62 [2.701]	99	62.87 [2.475]

NOTES:

1. TAPE & REEL IS STANDARD PACKAGING.
2. NOTE DELETED.
3. NOTE DELETED.
4. K-DOT PROVIDED AS STANDARD.
5. MEASURE BOTH OUTSIDE ROWS ONLY.
6. SEE SHEET 3 FOR PROCESSING INFORMATION.
7. ORDERS WILL BE PACKAGED ACCORDING TO THE SAMTEC PACKAGING EFFICIENCY STANDARDS (SPES) FOUND ON WWW.SAMTEC.COM.
8. PARTS ARE SOLDERED WITH OPTIMIZED SOLDER PASTE VOLUME IN PLACE OF AN ATTACHED SOLDER BALL. FOR MORE INFORMATION, CONTACT SAMTEC'S INTERCONNECT PROCESSING GROUP (IPG@SAMTEC.COM)

F:\dwg\sw\axisprod\assembly\pf635mm\APF6-XXX-XX.X-XXX-XX-X-XX-XR.sldr

PROPRIETARY NOTE

THIS DOCUMENT CONTAINS CONFIDENTIAL AND PROPRIETARY INFORMATION AND ALL DESIGN, MANUFACTURING, REPRODUCTION, USE, PATENT RIGHTS AND SALES RIGHTS ARE EXPRESSLY RESERVED BY SAMTEC, INC. THIS DOCUMENT SHALL NOT BE DISCLOSED, IN WHOLE OR PART, TO ANY UNAUTHORIZED PERSON OR ENTITY NOR REPRODUCED, TRANSFERRED OR INCORPORATED IN ANY OTHER PROJECT IN ANY MANNER WITHOUT THE EXPRESS WRITTEN CONSENT OF SAMTEC, INC.

DO NOT SCALE DRAWING
SHEET SCALE: 4:1
MATERIAL:
INSULATOR: LCP, UL 94 V-0; COLOR: BLACK
CONTACT: COPPER ALLOY

samtec

520 PARK EAST BLVD, NEW ALBANY, IN 47150
PHONE: 812-944-6733 FAX: 812-948-5047
e-Mail info@SAMTEC.com code 55322

DESCRIPTION:
APF6 0.635MM SOCKET ARRAY ASSEMBLY

DWG. NO.

APF6-XXX-XX.X-XXX-XX-X-XX-XR

BY: B BLESSING 5/26/2018 SHEET 1 OF 7

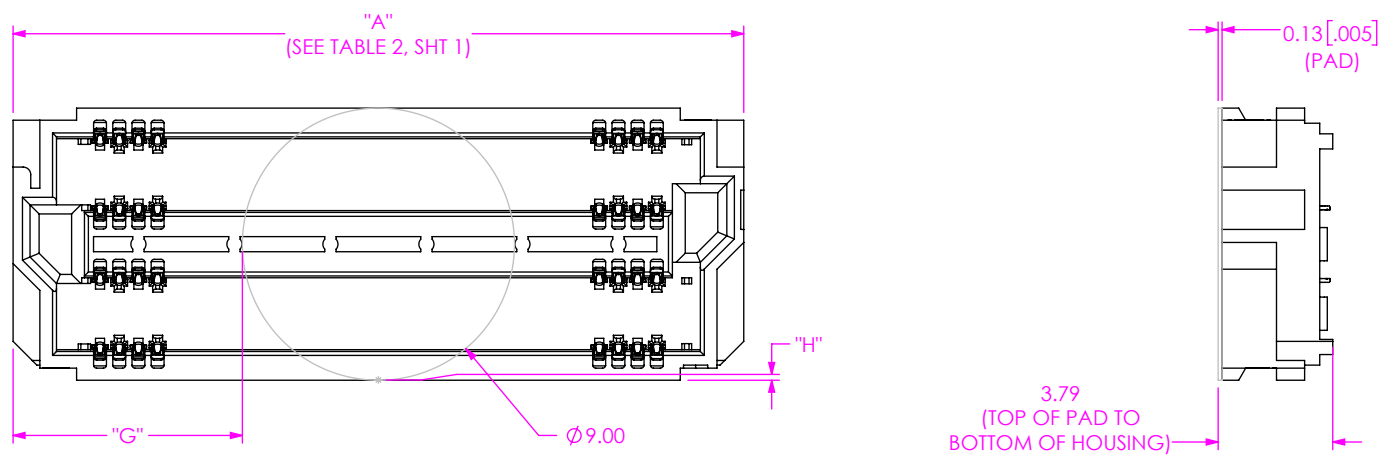

FIG 2
POLYIMIDE PAD
APF6-030-03.5-XXX-04-0-XR SHOWN
(SOME CENTER FEATURES REMOVED FOR CLARITY)

TABLE 5													
-No. OF ROWS	"G"												"H"
	-010	-020	-025	-030	-037	-040	-050	-060	-070	-080	-090	-100	
-04													0.00 [0.000]
-06	1.23 [0.049]	4.41 [0.174]	6.70 [0.264]	7.58 [0.299]	10.51 [0.414]	10.76 [0.424]	13.93 [0.549]	17.11 [0.674]	20.28 [0.799]	23.46 [0.924]	26.63 [1.049]	29.81 [1.174]	2.30 [0.091]
-08													4.60 [0.181]

• PROPRIETARY NOTE •

THIS DOCUMENT CONTAINS CONFIDENTIAL AND PROPRIETARY INFORMATION AND ALL DESIGN, MANUFACTURING, REPRODUCTION, USE, PATENT RIGHTS AND SALES RIGHTS ARE EXPRESSLY RESERVED BY SAMTEC, INC. THIS DOCUMENT SHALL NOT BE DISCLOSED, IN WHOLE OR PART, TO ANY UNAUTHORIZED PERSON OR ENTITY NOR REPRODUCED, TRANSFERRED OR INCORPORATED IN ANY OTHER PROJECT IN ANY MANNER WITHOUT THE EXPRESS WRITTEN CONSENT OF SAMTEC, INC.

520 PARK EAST BLVD, NEW ALBANY, IN 47150
PHONE: 812-944-6733 FAX: 812-948-5047
e-Mail info@SAMTEC.com code 55322

DO NOT SCALE DRAWING

SHEET SCALE: 4:1

DESCRIPTION:
APF6 0.635MM SOCKET ARRAY ASSEMBLY

DWG. NO.
APF6-XXX-XX.X-XXX-XX-X-XX-XR

BY: B BLESSING 5/26/2018 SHEET 2 OF 7

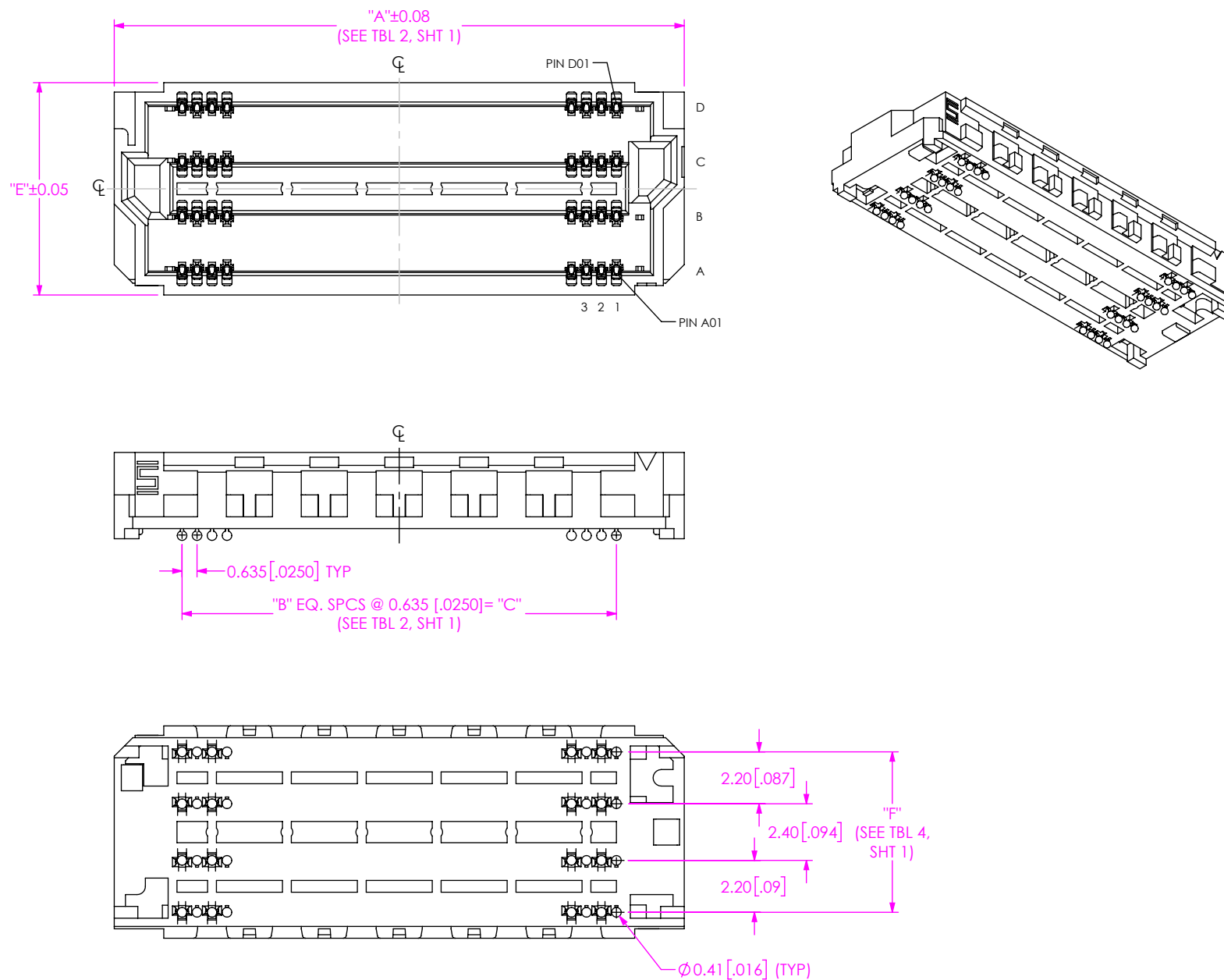

FIG 3
APF6-030-03.5-XXX-04-2-XR SHOWN
(SOLDER BALL OPTION)
(SOME CENTER FEATURES REMOVED FOR CLARITY)

PROPRIETARY NOTE
THIS DOCUMENT CONTAINS CONFIDENTIAL AND PROPRIETARY INFORMATION AND ALL DESIGN, MANUFACTURING, REPRODUCTION, USE, PATENT RIGHTS AND SALES RIGHTS ARE EXPRESSLY RESERVED BY SAMTEC, INC. THIS DOCUMENT SHALL NOT BE DISCLOSED, IN WHOLE OR PART, TO ANY UNAUTHORIZED PERSON OR ENTITY NOR REPRODUCED, TRANSFERRED OR INCORPORATED IN ANY OTHER PROJECT IN ANY MANNER WITHOUT THE EXPRESS WRITTEN CONSENT OF SAMTEC, INC.

samtec
520 PARK EAST BLVD, NEW ALBANY, IN 47150
PHONE: 812-944-6733 FAX: 812-948-5047
e-Mail info@SAMTEC.com code 55322

DO NOT SCALE DRAWING

SHEET SCALE: 4:1

DESCRIPTION:
APF6 0.635MM SOCKET ARRAY ASSEMBLY

DWG. NO.
APF6-XXX-XX.X-XXX-XX-X-XX-XR

BY: B BLESSING 5/26/2018 SHEET 3 OF 7

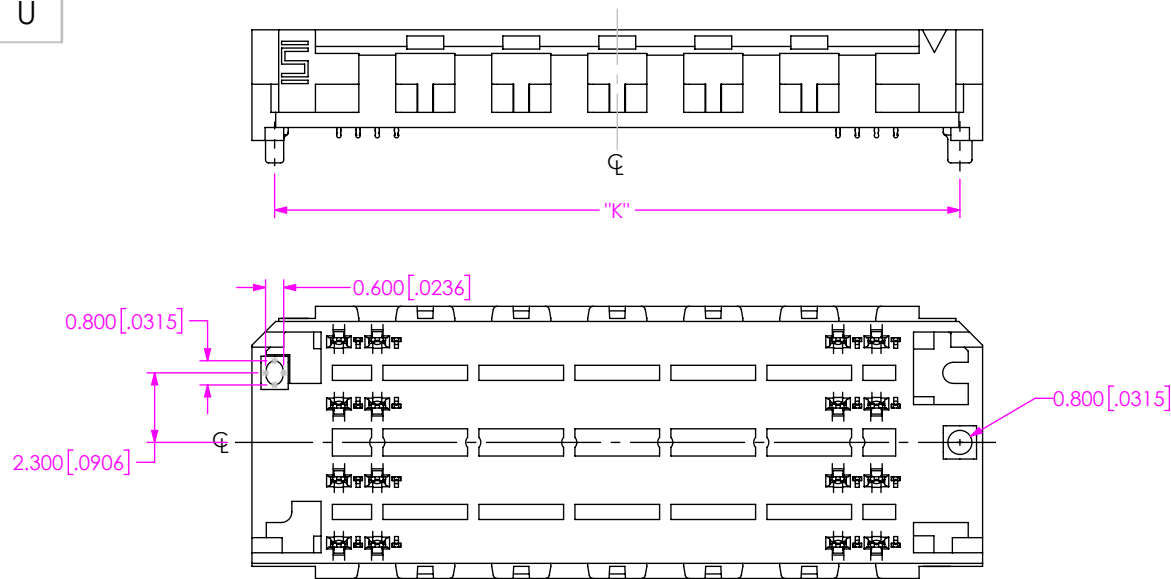

FIG 4
-A: ALIGNMENT PIN
APF6-030-03.5-XXX-04-0-A-XR SHOWN
(SAME AS FIG 1, EXCEPT AS SHOWN)
(SOME CENTER FEATURES REMOVED FOR CLARITY)

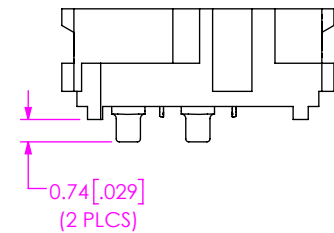

TABLE 7	
No OF POS PER ROW	"K"
-010	9.97 [0.392]
-020	16.32 [0.642]
-030	22.67 [0.892]
-040	29.02 [1.142]
-050	35.37 [1.392]
-060	41.72 [1.642]
-070	48.07 [1.892]
-080	54.42 [2.142]
-090	60.77 [2.392]
-100	67.12 [2.642]

CAT-APF6-XXX-XX-VT
PROCESSING FIXTURE
(SEE TABLE 8)

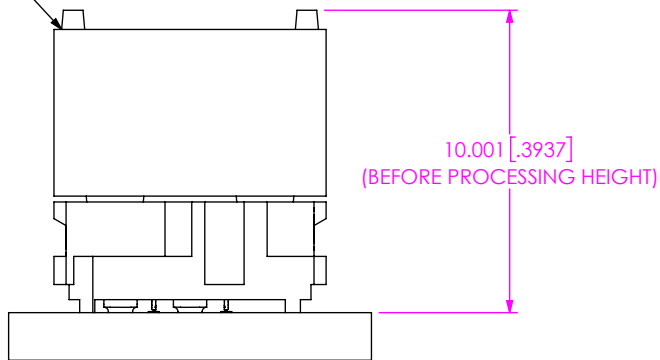

FIG 5
APF6-100-03.5-XXX-XX-0-XR PROCESSING VIEW
(CAT-APF6-XXX-XX-VT)

TABLE 8		
APF6 FIXTURE TOOLS		
PART NUMBER	POSITIONS	ROW
CAT-APF6-100-04-VT	-100	-04
CAT-APF6-100-08-VT	-100	-08

NOTE:
FIG 4 DIMENSION 10.001 (TOP OF PCB TO TOP OF PROCESSING FIXTURE) INDICATES CONNECTOR/FIXTURE HEIGHT ON PCB TO GUARANTEE ENOUGH REFLOW OVEN WORKING SPACE, DIMENSION 10.001, PCB THICKNESS AND THE HEIGHT OF THE COMPONENTS ON THE OTHER SIDE OF THE BOARD NEED TO BE CONSIDERED.

* PROPRIETARY NOTE * THIS DOCUMENT CONTAINS CONFIDENTIAL AND PROPRIETARY INFORMATION AND ALL DESIGN, MANUFACTURING, REPRODUCTION, USE, PATENT RIGHTS AND SALES RIGHTS ARE EXPRESSLY RESERVED BY SAMTEC, INC. THIS DOCUMENT SHALL NOT BE DISCLOSED, IN WHOLE OR PART, TO ANY UNAUTHORIZED PERSON OR ENTITY NOR REPRODUCED, TRANSFERRED OR INCORPORATED IN ANY OTHER PROJECT IN ANY MANNER WITHOUT THE EXPRESS WRITTEN CONSENT OF SAMTEC, INC.	samtec 520 PARK EAST BLVD, NEW ALBANY, IN 47150 PHONE: 812-944-6733 FAX: 812-948-5047 e-Mail: info@SAMTEC.com code 55322	
	DO NOT SCALE DRAWING	DESCRIPTION: APF6 0.635MM SOCKET ARRAY ASSEMBLY
	SHEET SCALE: 4:1	DWG. NO. APF6-XXX-XX.X-XXX-XX-X-XX-XR
		BY: B BLESSING 5/26/2018 SHEET 4 OF 7

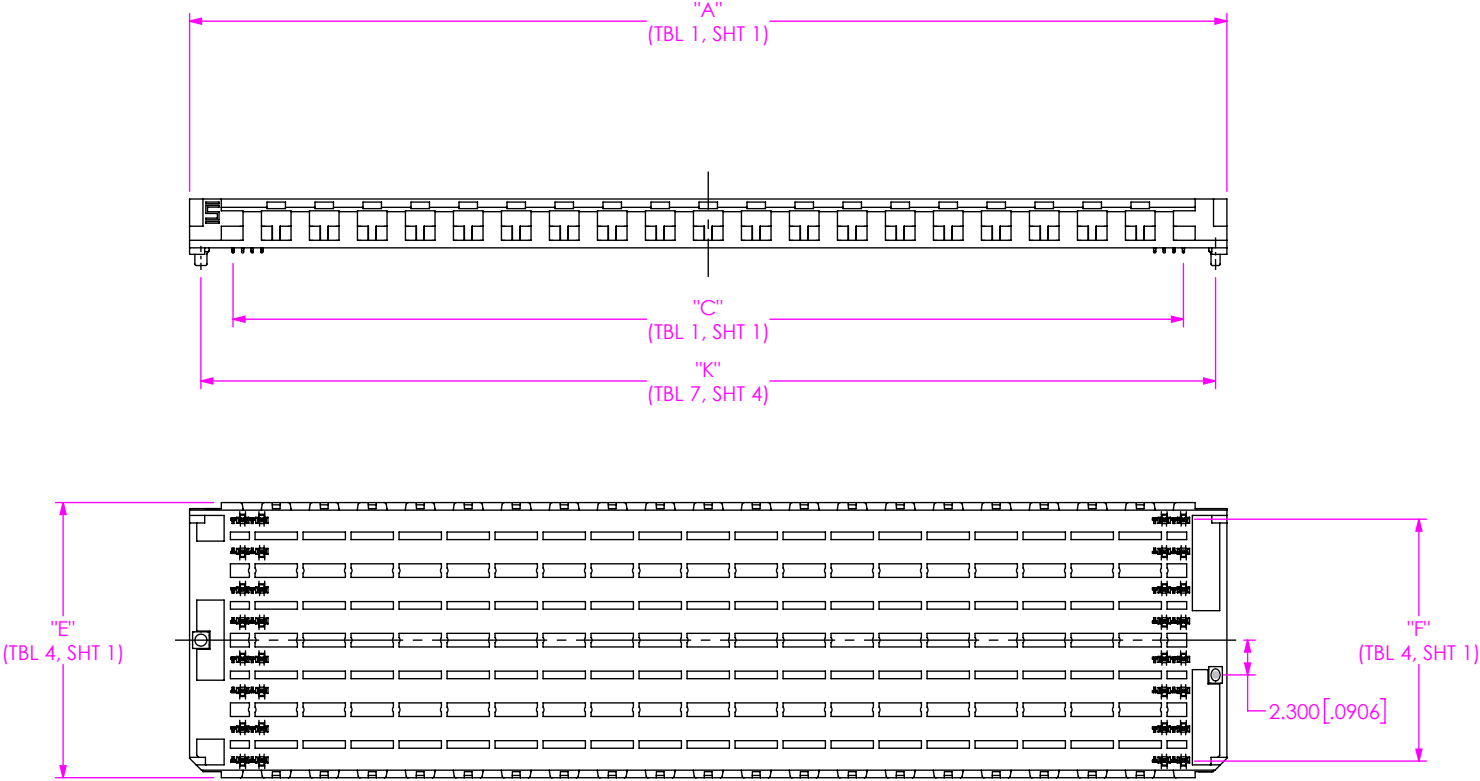

FIG 6
APF6-100-03.5-S-08-0-A-XR
(SAME AS FIG 1 EXCEPT AS SHOWN)

• PROPRIETARY NOTE •
THIS DOCUMENT CONTAINS CONFIDENTIAL AND
PROPRIETARY INFORMATION AND ALL DESIGN,
MANUFACTURING, REPRODUCTION, USE, PATENT RIGHTS
AND SALES RIGHTS ARE EXPRESSLY RESERVED BY SAMTEC,
INC. THIS DOCUMENT SHALL NOT BE DISCLOSED, IN WHOLE
OR PART, TO ANY UNAUTHORIZED PERSON OR ENTITY NOR
REPRODUCED, TRANSFERRED OR INCORPORATED IN ANY
OTHER PROJECT IN ANY MANNER WITHOUT THE EXPRESS
WRITTEN CONSENT OF SAMTEC, INC.

SHEET SCALE: 4:1

samtec

520 PARK EAST BLVD, NEW ALBANY, IN 47150
PHONE: 812-944-6733 FAX: 812-948-5047
e-Mail info@SAMTEC.com code 55322

DESCRIPTION:
APF6 0.635MM SOCKET ARRAY ASSEMBLY

DWG. NO.
APF6-XXX-XX.X-XXX-XX-X-XX-XR

BY: B BLESSING 5/26/2018 SHEET 5 OF 7

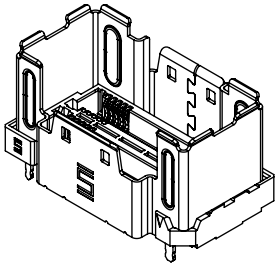
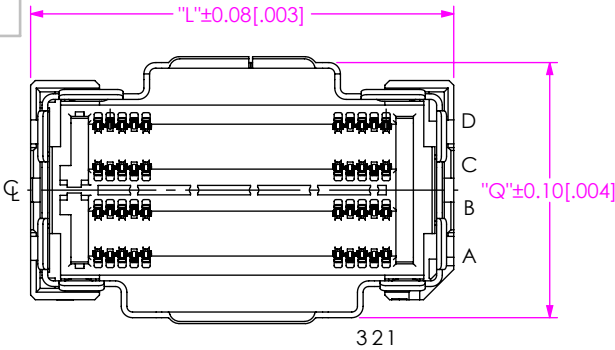

TABLE 9					
No OF POS	"L"	"M"	"N"	"P"	"U"
-025	22.39 [.881]	24	15.24 [.600]	17.59 [.693]	21.18 [.834]
-037	30.01 [1.181]	36	22.86 [.900]	25.21 [.993]	28.80 [1.134]

TABLE 10			
No. OF ROWS	"Q"	"R"	"S"
-04	13.50 [.531]	9.90 [.390]	11.60 [.457]
-06	18.10 [.713]	14.50 [.571]	16.20 [.638]
-08	22.70 [.894]	19.10 [.752]	20.80 [.819]

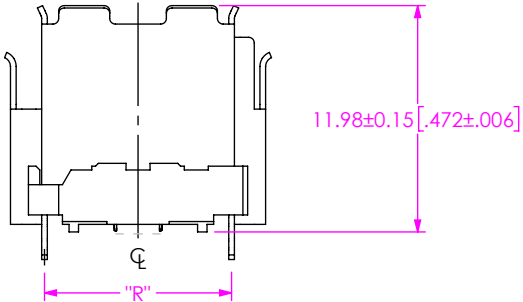
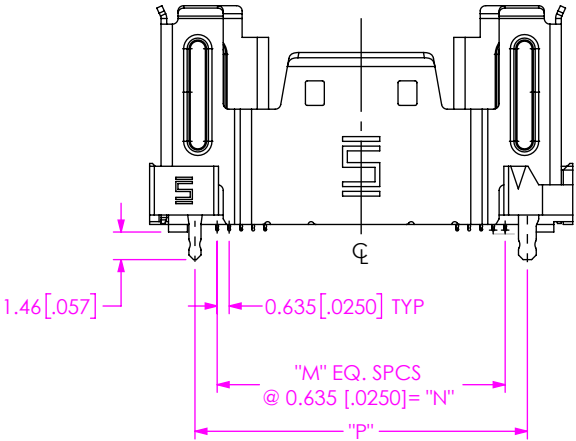

FIG 7
-L: SQUEEZE LATCH
APF6-025-03.5-XXX-04-0-L-XR SHOWN
(SAME AS FIG 1, EXCEPT AS SHOWN)
(SOME CENTER FEATURES REMOVED FOR CLARITY)

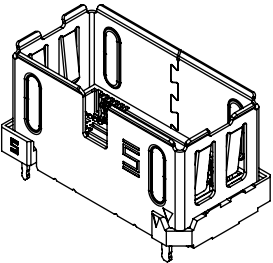
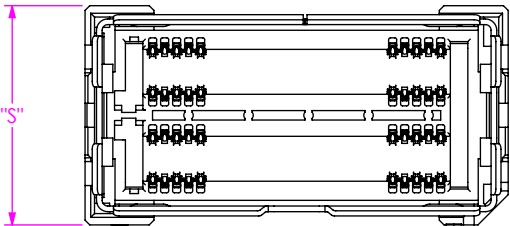
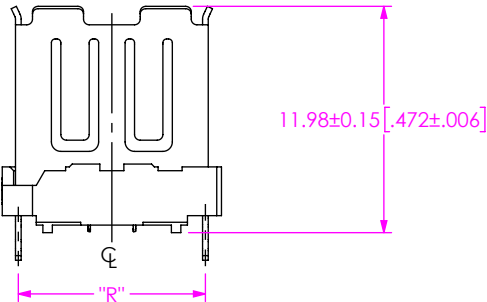
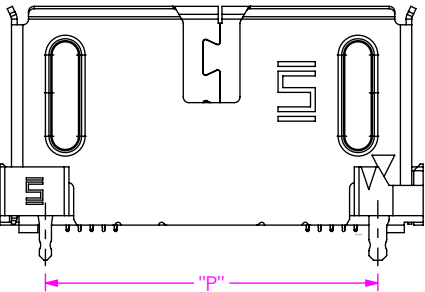

FIG 8
-T: LOCKING TOOL
APF6-025-03.5-XXX-04-0-T-XR SHOWN
(SAME AS FIG 1 & FIG 7, EXCEPT AS SHOWN)
(SOME CENTER FEATURES REMOVED FOR CLARITY)



PROPRIETARY NOTE
THIS DOCUMENT CONTAINS CONFIDENTIAL AND PROPRIETARY INFORMATION AND ALL DESIGN, MANUFACTURING, REPRODUCTION, USE, PATENT RIGHTS AND SALES RIGHTS ARE EXPRESSLY RESERVED BY SAMTEC, INC. THIS DOCUMENT SHALL NOT BE DISCLOSED, IN WHOLE OR PART, TO ANY UNAUTHORIZED PERSON OR ENTITY NOR REPRODUCED, TRANSFERRED OR INCORPORATED IN ANY OTHER PROJECT IN ANY MANNER WITHOUT THE EXPRESS WRITTEN CONSENT OF SAMTEC, INC.

samtec

520 PARK EAST BLVD, NEW ALBANY, IN 47150
PHONE: 812-944-6733 FAX: 812-948-5047
e-Mail: info@SAMTEC.com code 55322

SHEET SCALE: 5:2

DESCRIPTION:
APF6 0.635MM SOCKET ARRAY ASSEMBLY

DWG. NO.
APF6-XXX-XX.X-XXX-XX-X-XX-XR

BY: B BLESSING 5/26/2018 SHEET 6 OF 7

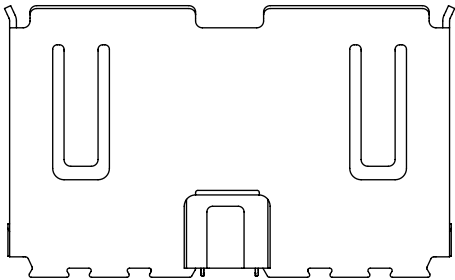
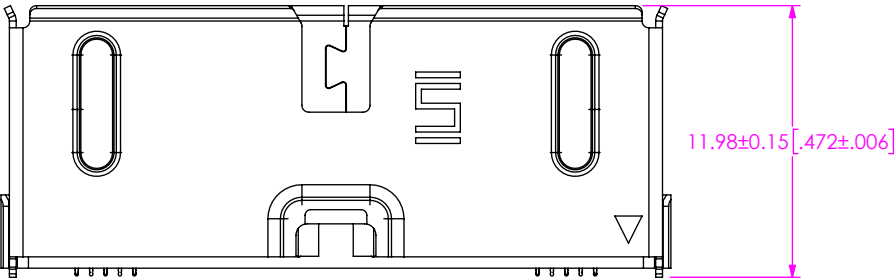
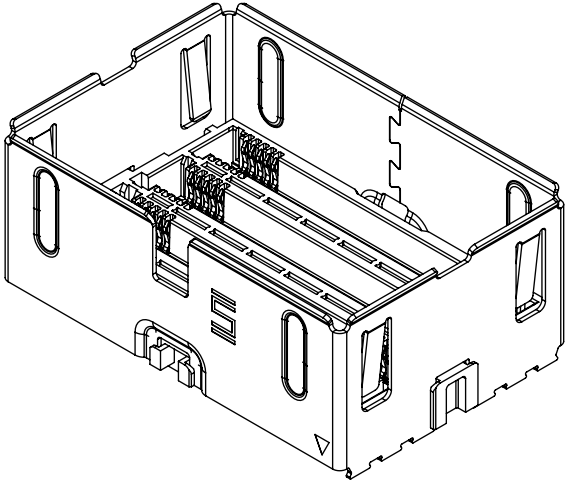
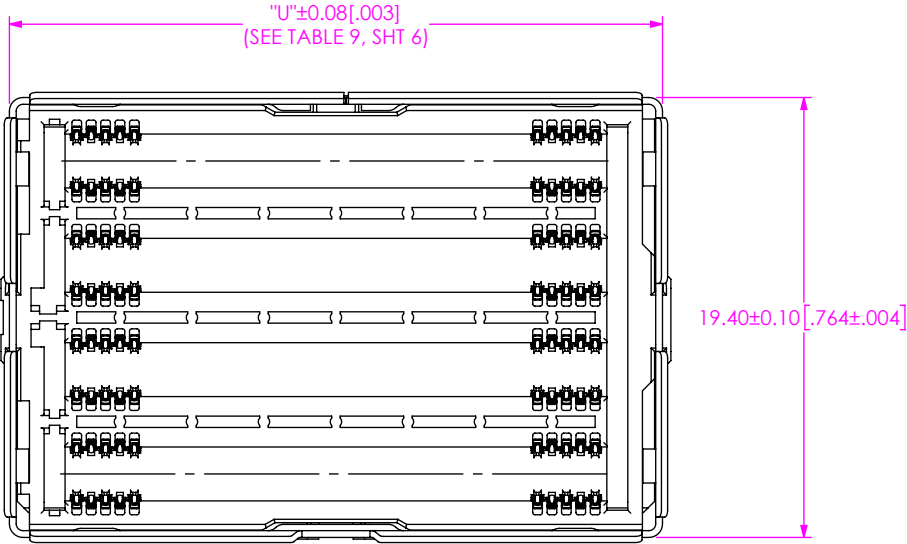

FIG 9
-S: SM LOCKING TOOL
APF6-037-03.5-XXX-08-0-S-XR SHOWN
(SAME AS FIG 1 & FIG 7, EXCEPT AS SHOWN)
(SOME CENTER FEATURES REMOVED FOR CLARITY)

PROPRIETARY NOTE
THIS DOCUMENT CONTAINS CONFIDENTIAL AND PROPRIETARY INFORMATION AND ALL DESIGN, MANUFACTURING, REPRODUCTION, USE, PATENT RIGHTS AND SALES RIGHTS ARE EXPRESSLY RESERVED BY SAMTEC, INC. THIS DOCUMENT SHALL NOT BE DISCLOSED, IN WHOLE OR PART, TO ANY UNAUTHORIZED PERSON OR ENTITY NOR REPRODUCED, TRANSFERRED OR INCORPORATED IN ANY OTHER PROJECT IN ANY MANNER WITHOUT THE EXPRESS WRITTEN CONSENT OF SAMTEC, INC.

samtec
520 PARK EAST BLVD, NEW ALBANY, IN 47150
PHONE: 812-944-6733 FAX: 812-948-5047
e-Mail info@SAMTEC.com code 55322

SHEET SCALE: 4:1

DESCRIPTION:
APF6 0.635MM SOCKET ARRAY ASSEMBLY

DWG. NO.
APF6-XXX-XX.X-XXX-XX-X-XX-XR

BY: B BLESSING 5/26/2018 SHEET 7 OF 7