

Sep.1.2025 Copyright 2025 HIROSE ELECTRIC CO., LTD. All Rights Reserved.  
In case of consideration for using Automotive equipment / device which demand high reliability, kindly contact our sales window correspondents.

5 Fig. 2(1 : 1)

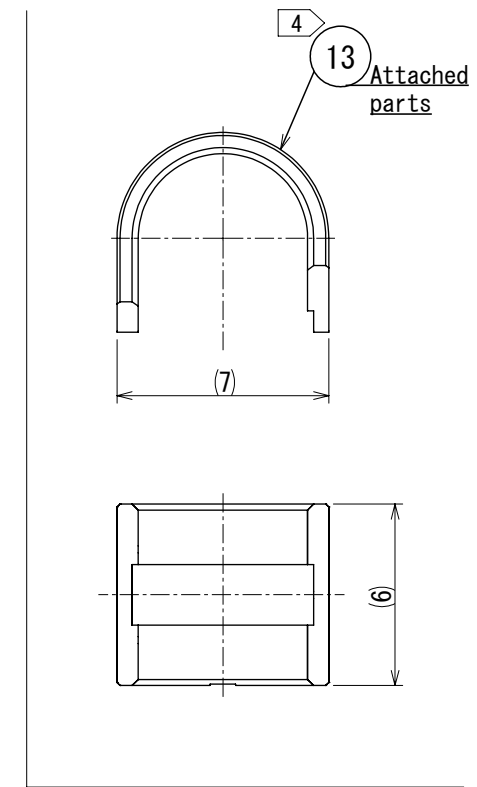
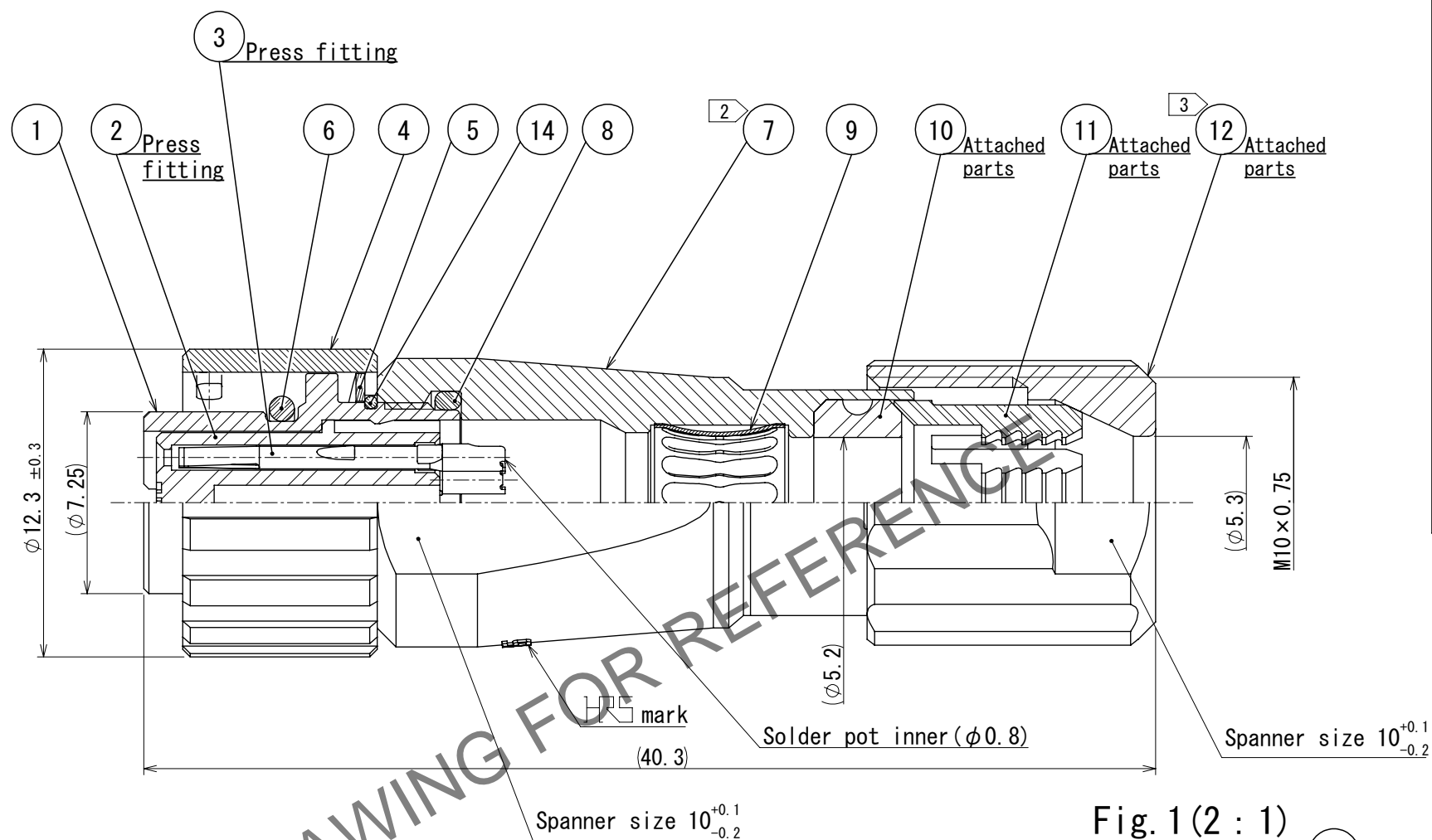
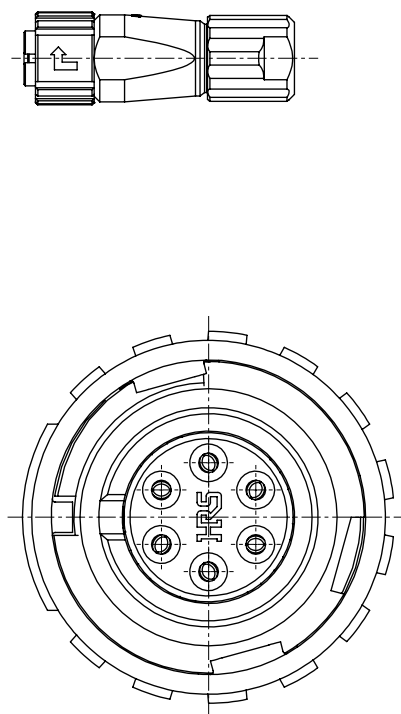
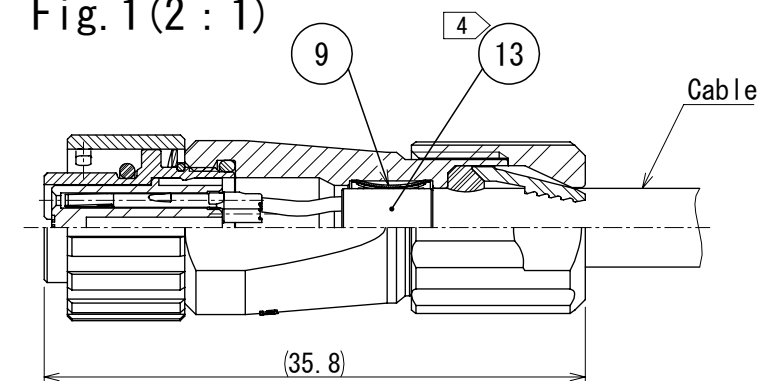

Fig. 1(2 : 1)



- Notes
- 1 Plating(Ref. No. 3)  
Contact area : Gold 0.2 μm min.  
Others : Gold and Nickel  
Under plating : Nickel 2 μm min.
  - 2 The recommended clamp torque of Ref.No. 7 to be 1 to 1.5N·m.  
Thread locker to the threaded portion of Ref.No. 1 applies to prevent Ref.No. 7 from loosening.  
Recommended thread locker:Loctite 263, Henkel Japan Ltd.
  - 3 The recommended clamp torque of Ref.No. 12 to be 0.8 to 1N·m.  
Thread locker and lock primer to the threaded portion M10×0.75 of Ref.No. 7 applies to prevent Ref.No. 12 from loosening.  
Recommended thread locker and lock primer : Loctite 263, Lock primer 7649, Henkel Japan Ltd.
  - 4 Fasten Ref.No. 13 to the cable with the cable crimping tool.  
And make Ref.No. 13 contact with Ref.No. 9 (Refer to Fig.1).  
Refer to the technical specification ETAD-C0099 for details.  
Applicable cable crimping tool : HR10A-TC-02(CL150-0041-2)  
(The hole diameter for crimping:hulai φ5.3)
  - 5 Fig.2 shows the appearance after assembly.
  - 6 Applicable cable assembly fixture : LF07BP-T01(CL150-0232-0)  
Cable assembly fixture is used as a receptacle stand of extract and the part No. 1 of an assembly.
  - 7 Rotation examples of No. 4, 7 and 12 to 1 are shown.

△ CAD change

NO.	MATERIAL	FINISH	REMARKS	NO.	MATERIAL	FINISH	REMARKS
7	Zinc alloy	Nickel plating		14	Stainless steel		
6	Chloroprene rubber	(Black)		13	Brass	Nickel plating	
5	Stainless steel			12	Polyphenylene sulfide	(Natural, Brown)	UL94V-0
4	Zinc alloy	Nickel plating		11	Polyamide	(Natural, Milky white)	UL94V-0
3	Phosphor bronze	1		10	Chloroprene rubber	(Black)	
2	Polyphenylene sulfide	(Black) UL94V-0		9	Phosphor bronze	Nickel plating	
1	Zinc alloy	Nickel plating		8	Chloroprene rubber	(Black)	

NO.	MATERIAL	FINISH	REMARKS	NO.	MATERIAL	FINISH	REMARKS
7	Zinc alloy	Nickel plating		14	Stainless steel		
6	Chloroprene rubber	(Black)		13	Brass	Nickel plating	
5	Stainless steel			12	Polyphenylene sulfide	(Natural, Brown)	UL94V-0
4	Zinc alloy	Nickel plating		11	Polyamide	(Natural, Milky white)	UL94V-0
3	Phosphor bronze	1		10	Chloroprene rubber	(Black)	
2	Polyphenylene sulfide	(Black) UL94V-0		9	Phosphor bronze	Nickel plating	
1	Zinc alloy	Nickel plating		8	Chloroprene rubber	(Black)	

OVER	TO	TOLERANCES	UNITS	COUNT	DESCRIPTION OF REVISIONS	DESIGNED	CHECKED	DATE
6	18	±0.3	mm	1	DIS-C-00019617	Y.J. KOGA	HY. KOBAYASHI	2025. 04. 21
6	18	±0.5	ANGULAR		APPROVED : HY. KOBAYASHI	2018. 02. 22	DRAWING No. EDC-113835-31-00	
18	50	±0.7	HIROSE ELECTRIC CO., LTD.		CHECKED : HY. KOBAYASHI	2018. 02. 22	PART No. LF07WBP-6S (31)	
50	125	±1	HRS		DESIGNED : TY. SUZUKI	2018. 02. 22	CODE No. CL0136-0001-1-31	
ASSEMBLY DRAWING					DRAWN : TY. SUZUKI	2018. 02. 22		