

Sep.1.2025 Copyright 2025 HIROSE ELECTRIC CO., LTD. All Rights Reserved.
In case of consideration for using Automotive equipment / device which demand high reliability, kindly contact our sales window correspondents.

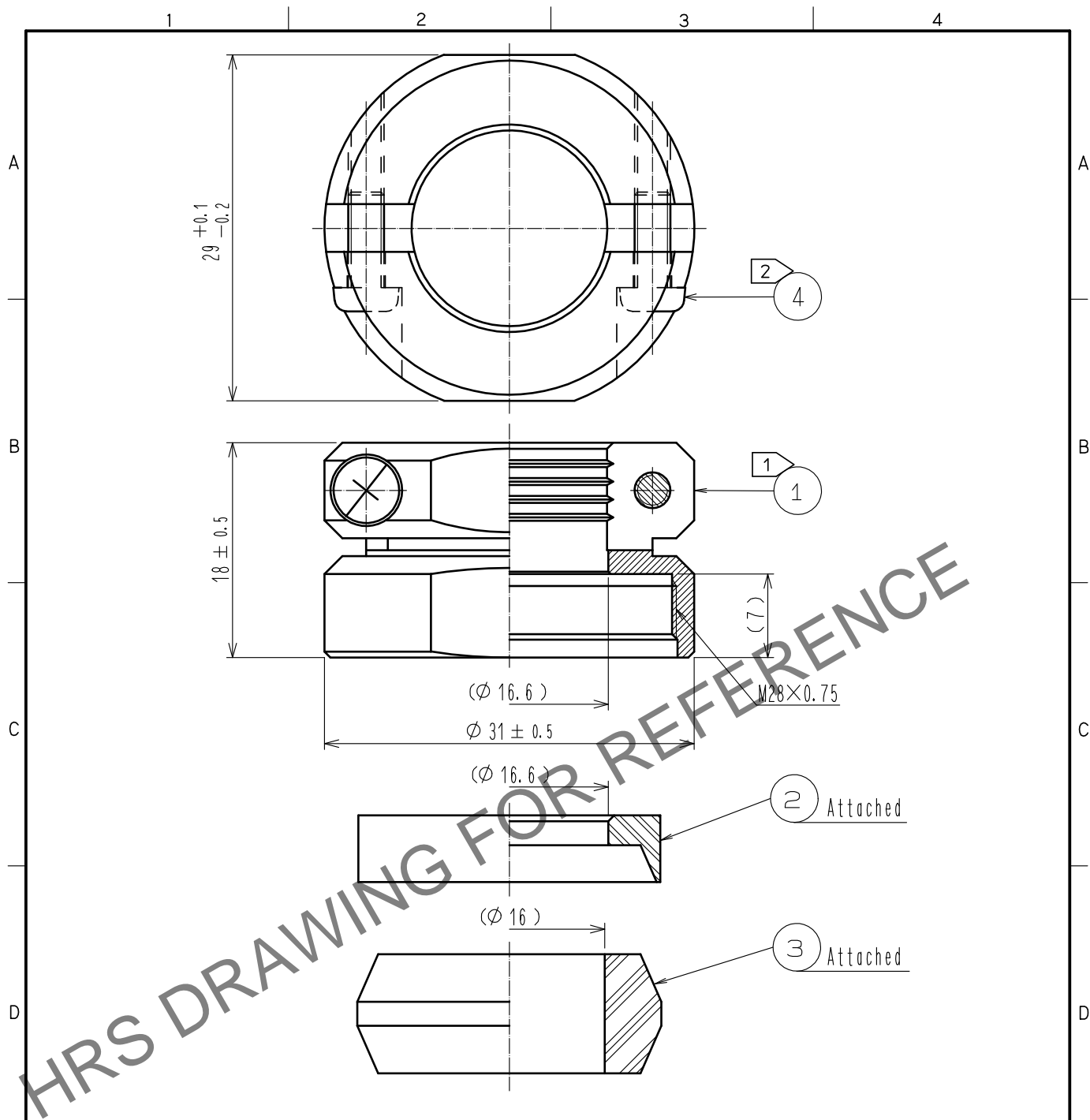

- Notes
- ① The recommended clamp torque of ref. No. ① : 5 to 5.5 N · m .
LOCTITE 263, HENKEL JAPAN or equevalent is recommended to prevent
ref. No. ① from loosening.
 - ② The recommended clamp torque of ref. No. ④ to be 0.65 to 0.7 N · m .
 - ③ The cable pull and twisting strength, waterproof tightness and other characteristics
may differ, depending on the cable structure. Please confirm before the use.

2	PPS	(Black) UL94V-0	4	Stainless steel	M3×0.5×8				
1	Brass	Black chrome plating	3	Silicone rubber	(Black)				
NO.	MATERIAL	FINISH . REMARKS		NO.	MATERIAL	FINISH . REMARKS			
UNITS mm		SCALE 2 : 1		COUNT	DESCRIPTION OF REVISIONS		DESIGNED	CHECKED	DATE
HIROSE ELECTRIC CO., LTD.		APPROVED	HY. KOBAYASHI		15. 09. 10	DRAWING NO.	EDC-110617-72-72		
		CHECKED	HY. KOBAYASHI		15. 09. 10	PART NO.	JR25WCC-16(72)		
		DESIGNED	TH. KAMEYA		15. 09. 09	CODE NO.	CL114-2067-3-72		
		DRAWN	TH. KAMEYA		15. 09. 09				1