

1			2			3			4		
COUNT	DESCRIPTION OF REVISIONS	BY	CHKD	DATE		COUNT	DESCRIPTION OF REVISIONS	BY	CHKD	DATE	
△						△					
△						△					
△						△					

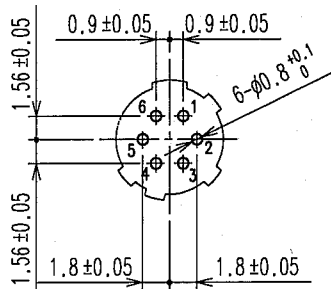

PCB LAYOUT

(INDICATES THE SIDE OF THE SURFACE TO WHICH DIP POSTS ARE INSERTED.)

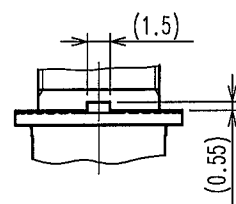
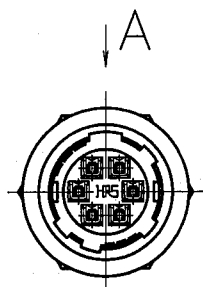

A DETAIL OF MOUNTING GUIDE

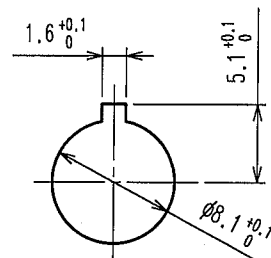
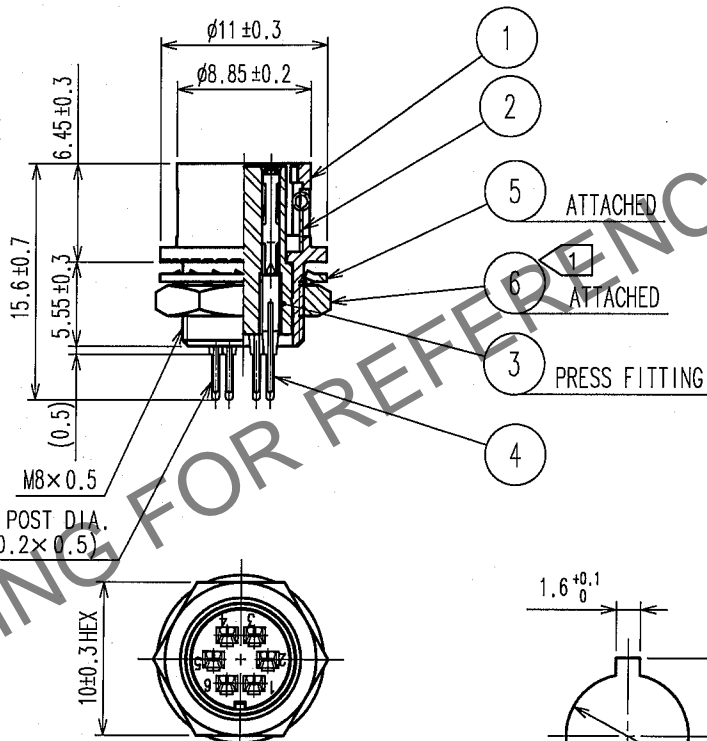

PANEL CUTOUT
t 0.7~2

NOTE ① THE RECOMMENDED CLAMP TORQUE OF REF.NO. ⑥ : 1.5N · m.
LOCTITE 242, HENKEL JAPAN OR EQUIVALENT IS RECOMMENDED TO PREVENT
REF. NO. ⑥ FROM LOOSENING.

3	PBT	(BLACK) UL94V-0	6	BRASS	NICKEL PLATING
2	STAINLESS STEEL		5	PHOSPHOR BRONZE	NICKEL PLATING
1	ZINC ALLOY	MATTE FINISH NICKEL PLATED	4	PHOSPHOR BRONZE	SILVER PLATING 2 μm min.
NO.	MATERIAL	FINISH, REMARKS	NO.	MATERIAL	FINISH, REMARKS

CODE NO. (OLD) CL		DRAWN H.Kish 05.08.31	DESIGNED H.Kish 05.08.31	CHECKED E. Kuroi 05.09.02	APPROVED M. Sato 05.09.02	RELEASED
DRAWING NO. EDC4-042752-73		PART NO. HR10G-7R-6SB(73)				
SCALE 2 : 1		CODE NO. CL110-1805-1-73				
UNITS mm		1/1				