



*Image for illustrative purpose only*

## Summary

[Request a quote](#)

[Catalog](#)

Nb of contacts Triax	1
Socket / Receptacle	Socket / Receptacle - Elbow
Locking system	Push-pull
Size	0S
Suggested matching part	<a href="#">FFA.0S.650.CLLC32</a>
Series	S - Indoor Stepped Insert

[https://www.lemo.com/int\\_en/solutions/originals/s-indoor-stepped-insert/epl-0s-650-ntd.html](https://www.lemo.com/int_en/solutions/originals/s-indoor-stepped-insert/epl-0s-650-ntd.html)

LEMO products and services are provided "as is". LEMO makes no warranties or representations with regard to LEMO product & services or use of them, express, implied or statutory, including for accuracy, completeness, or security. The user is fully responsible for his products and applications using LEMO components.

# Technical details

## Electrical Configuration

Nb of contacts Triax	1
Contact Termination Triax	PCB - Straight
Insert configuration value	0S.650 - 1 Triax (50 Ohm)
Insulator	T: PTFE
Rated current	6 A
Impedance	50 Ohms
Test voltage (kV rms)	1.2
Cable type	RGT 178, RGT 174

## Form & Material

Shell style / Model id	EPL - Elbow receptacle for printed circuit
Socket / Receptacle	Elbow
Housing material	Brass (nickel plated [SAE AMS QQ N 290]) collet and crimping tube, brass (chrome plated [SAE AMS 2460]) collet nut
Locking system	Push-pull
Keying	Circular, male
Colour	Grey
Weight	8.08 g

## Environment

Technical domain	Audio Video, Energy and Industrial, Semiconductor, Test and Measurement
Environmental sealing (IP rating)	IP50
Endurance	5000 mating cycles
Temperature range	-55°C / +250°C (max. temperature valid for short periods of use.)
Climatical Category	55/175/21
Humidity (max)	<=95% [at 60 deg C /140 F]
Shielding (min)	75 dB (10 MHz)
Shielding (min)	40 dB (1 GHz)
Shock Resistance	100 g [ 6 ms]
Vibration	15 g [10 Hz - 2000 Hz]
Salt Spray Corrosion	>144 hr

[https://www.lemo.com/int\\_en/solutions/originals/s-indoor-stepped-insert/epl-0s-650-ntd.html](https://www.lemo.com/int_en/solutions/originals/s-indoor-stepped-insert/epl-0s-650-ntd.html)

LEMO products and services are provided "as is". LEMO makes no warranties or representations with regard to LEMO product & services or use of them, express, implied or statutory, including for accuracy, completeness, or security. The user is fully responsible for his products and applications using LEMO components.

# Drawings

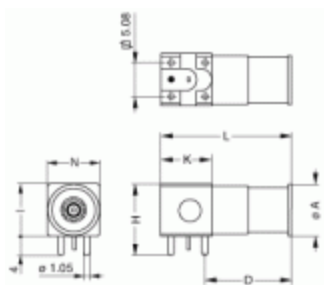

## Dimensions

	A	L	N	I	H	d
mm.	8.8	23.6	9	9	13	5.08
in.	0.35	0.93	0.35	0.35	0.51	0.2

# Recommended By Lemo

## Accessories

Compatible cap	<a href="#">BRE.0S.200.NAS</a>
----------------	--------------------------------

# CAD

## Documents

PCB	<a href="#">Download</a>
PCB Eagle	<a href="#">Download</a>
Kicad	<a href="#">Download</a>
PCB Altium	<a href="#">Download</a>