



*Image for illustrative purpose only*

## Summary

[Request a quote](#)

[Catalog](#)

Number of contacts Low Voltage	32
Wire Size/AWG	34 - 28
Gender	Standard
Socket / Receptacle	Socket / Receptacle - Fixed Panel Rear Mounted
Locking system	Push-pull
Jacket cable outside diameter [mm]	1.00 - 15.60 mm
Size	2P
Suggested matching part	<a href="#">CAB.M32.GLA.C72G</a>
Series	REDEL P - Push-Pull

[https://www.lemo.com/int\\_en/solutions/redel/redel-p-push-pull/ckb-m32-gllg.html](https://www.lemo.com/int_en/solutions/redel/redel-p-push-pull/ckb-m32-gllg.html)

LEMO products and services are provided "as is". LEMO makes no warranties or representations with regard to LEMO product & services or use of them, express, implied or statutory, including for accuracy, completeness, or security. The user is fully responsible for his products and applications using LEMO components.

# Technical details

## Electrical Configuration

Number of contacts Low Voltage	32
Contact Termination Low voltage	Solder
Insert configuration value	2P.M32 - 32 Low V.
Insulator	L: PEEK for solder contacts
Rated current	2 A
Test voltage contact-contact	1.06 (kV DC)
Air clearance	0.35 mm
Creepage distance	0.35 mm
Bucket Dia.	0.5 mm (0.019in)
Contact Dia.	0.5 mm (0.019in)
Wire Size/AWG	34 - 28
Gender	Standard

## Form & Material

Shell style / Model id	CK - Fixed receptacle with two nuts (back panel mounting)
Socket / Receptacle	Fixed Panel Rear Mounted
Housing material	PSU (Polysulfone), grey
Locking system	Push-pull
Keying	B: 3 keys (alpha=0, gamma=60, Plug: male contacts, Receptacle: female contacts)
Colour	Grey
Weight	6.85 g

[https://www.lemo.com/int\\_en/solutions/redel/redel-p-push-pull/ckb-m32-gllg.html](https://www.lemo.com/int_en/solutions/redel/redel-p-push-pull/ckb-m32-gllg.html)

LEMO products and services are provided "as is". LEMO makes no warranties or representations with regard to LEMO product & services or use of them, express, implied or statutory, including for accuracy, completeness, or security. The user is fully responsible for his products and applications using LEMO components.

## Environment

Technical domain	Energy and Industrial, Medical, Test and Measurement, Transportation, Aerospace and UAV
Environmental sealing (IP rating)	IP50
Endurance	>5000 mating cycles
Temperature range	-50°C / +150°C
F ret (max)	250 N
F ret (min)	150 N
Steam sterilization	Fully sterilizable (Steam, Gamma, ETO) following our protocols and tests in line with ISO 11134 and IEC 60601-1 standards. For more details on sterilization methods and cycles, please contact us.

## Cable fixation

Jacket cable outside diameter [mm]	1.00 - 15.60 mm
------------------------------------	-----------------

## Drawings

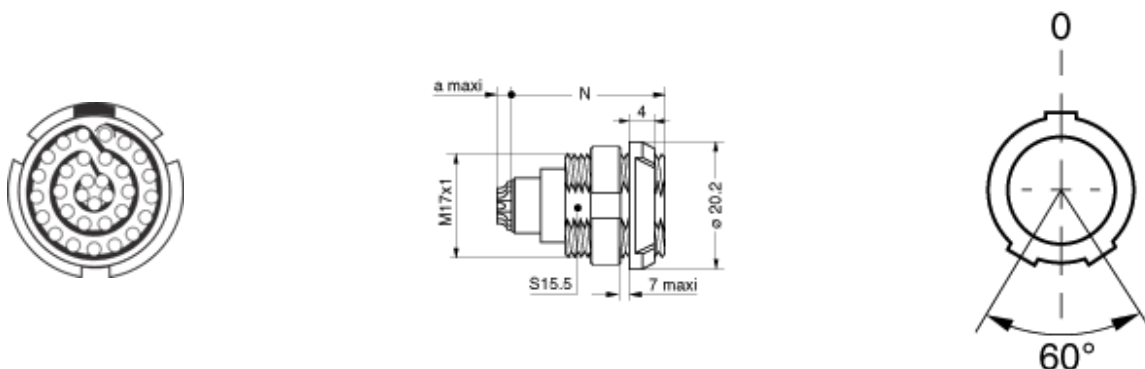

## Dimensions

	N	a
mm.	23.8	3.4-4.9
in.	0.94	

[https://www.lemo.com/int\\_en/solutions/redel/redel-p-push-pull/ckb-m32-gllg.html](https://www.lemo.com/int_en/solutions/redel/redel-p-push-pull/ckb-m32-gllg.html)

LEMO products and services are provided "as is". LEMO makes no warranties or representations with regard to LEMO product & services or use of them, express, implied or statutory, including for accuracy, completeness, or security. The user is fully responsible for his products and applications using LEMO components.

# Cables

Cable PartNumber	Material	Colour	Cable image
CMN.32.T30.058QGZE	TPR (medical)	Grey	
364080	PVC	Grey	

[https://www.lemo.com/int\\_en/solutions/redel/redel-p-push-pull/ckb-m32-gllg.html](https://www.lemo.com/int_en/solutions/redel/redel-p-push-pull/ckb-m32-gllg.html)

LEMO products and services are provided “as is”. LEMO makes no warranties or representations with regard to LEMO product & services or use of them, express, implied or statutory, including for accuracy, completeness, or security. The user is fully responsible for his products and applications using LEMO components.