

## SMA Female to MMCX Jack Adapter

SMA female to MMCX jack adapter part number FMAD1307 from Fairview Microwave is in-stock and ships same day. This Fairview SMA to MMCX adapter has a female to jack gender configuration. FMAD1307 SMA female to MMCX jack adapter. The SMA connector mates mechanically with commercially available 3.5mm and 2.92mm (K) connectors.

RF adapters can be used to enable connections between two connector types that would otherwise not mate. Certain RF adapter configurations can also be used to protect connectors on expensive equipment where the number of connect and disconnect cycles is high. An RF, microwave, or millimeter wave adapter is connected to the equipment and the commonly changed connection is made with the adapter which can be easily replaced when it wears out after high usage; such adapters are referred to as connector savers. Fairview Microwave also offers bulkhead, panel mount, hermetically sealed, reverse polarity, and isolated ground adapter varieties to serve all of your RF, microwave and millimeter wave needs.

### Mechanical Specifications

<b>Size</b>	
Length	0.682 in [17.3 mm]
Width	0.25 in [6.35 mm]
Weight	0.0084 lbs [3.81 g]

Description	Connector 1	Connector 2
Type	SMA Female	MMCX Jack
Polarity	Standard	Standard
Interface Specification	MIL-STD-348	MIL-C-39012

### Material Specifications

Description	Connector 1	Connector 2
Type	SMA Female	MMCX Jack
Contact Plating	Gold	Gold
Contact Plating Spec.	MIL-G-45204	MIL-G-45204
Insulation Material	PTFE	PTFE
Outer Contact Material	Brass	Brass
Outer Contact Plating	Nickel	Nickel
Outer Contact Plating Spec.	QQ-N-290	QQ-N-290

### Environmental Specifications

<b>Temperature</b>	
Operating Range	-65 to +165 deg C

**Compliance Certifications** (see [product page](#) for current document)

### Plotted and Other Data

Notes:



### Configuration:

- SMA Female Connector 1
- MMCX Jack Connector 2
- 50 Ohm
- Straight Body Geometry

### Features:

- SMA interface meets MIL-STD-348
- MMCX interface meets MIL-C-39012
- Contact plating according to MIL-G-45204

### Applications:

- Enables Between Series Connections
- General Purpose Test

Fairview Microwave  
301 Leora Ln., Suite 100  
Lewisville, TX 75056  
Tel: 1-800-715-4396 / (972) 649-6678  
Fax: (972) 649-6689  
[www.fairviewmicrowave.com](http://www.fairviewmicrowave.com)  
[sales@fairviewmicrowave.com](mailto:sales@fairviewmicrowave.com)

SMA Female to MMCX Jack Adapter from Fairview Microwave is in-stock and available to ship same-day. All of our RF/microwave products are available off-the-shelf from our ISO 9001:2008 certified facilities in Lewisville, Texas. Fairview Microwave is RF on-demand.

For additional information on this product, please click the following link: [SMA Female to MMCX Jack Adapter FMAD1307](#)

URL: <https://www.fairviewmicrowave.com/sma-female-to-mmcx-jack-adapter-fmad1307-p.aspx>

The information contained in this document is accurate to the best of our knowledge and representative of the part described herein. It may be necessary to make modifications to the part and/or the documentation of the part, in order to implement improvements. Fairview Microwave reserves the right to make such changes as required. Unless otherwise stated, all specifications are nominal. Fairview Microwave does not make any representation or warranty regarding the suitability of the part described herein for any particular purpose, and Fairview Microwave does not assume any liability arising out of the use of any part or documentation.

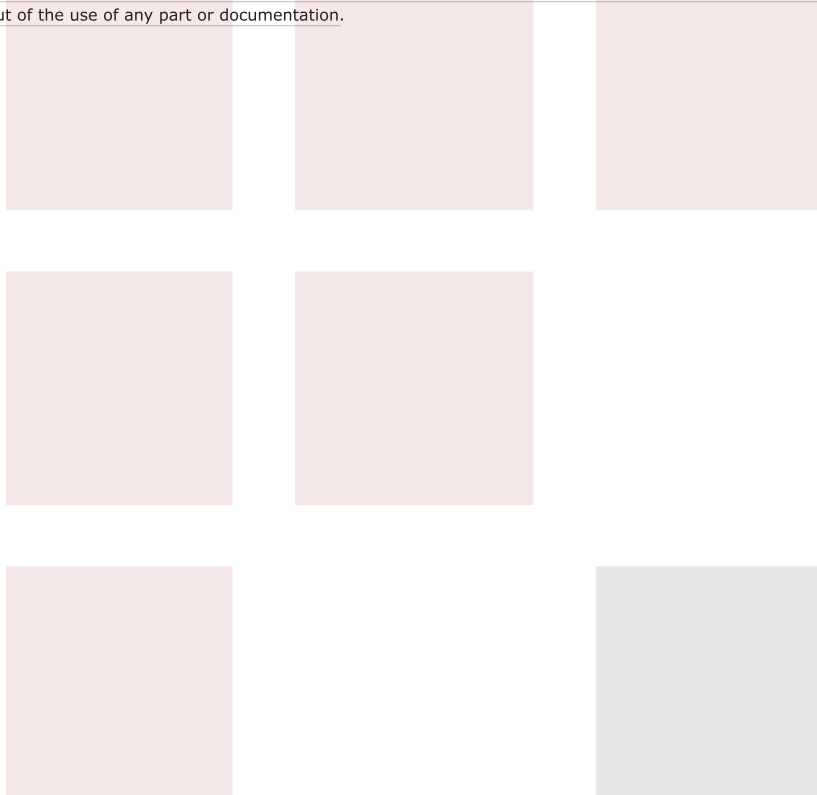

MMCX JACK

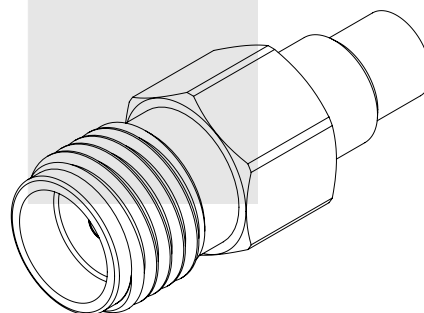
**Fairview Microwave**  
an INFINITE brand

TITLE

UNLESS OTHERWISE SPECIFIED LEADING DIMENSIONS ARE INCHES  
DIMENSIONS IN [ ] ARE MILLIMETERS

TOLERANCES:

CABLE LENGTH (L) TOLERANCES:

.X = ±.2	[.508]	FRACTIONS
.XX = ±.02	[.51]	± 1/32
.XXX = ±.005	[.13]	ANGLES ± 1°

$$\begin{aligned} L &\leq 12 \text{ [305]} = +1 \text{ [25]} / -0 \\ 12 \text{ [305]} &< L \leq 60 \text{ [1524]} = +2 \text{ [51]} / -0 \\ 60 \text{ [1524]} &< L \leq 120 \text{ [3048]} = +4 \text{ [102]} / -0 \\ 120 \text{ [3048]} &< L \leq 300 \text{ [7620]} = +6 \text{ [152]} / -0 \\ 300 \text{ [7620]} &< L = +5\% L / -0 \end{aligned}$$

THIRD-ANGLE PROJECTION



THE INFORMATION AND  
DESIGN IN THIS DOCUMENT  
IS THE PROPERTY OF  
FAIRVIEW MICROWAVE CORPORATION.  
ALL RIGHTS RESERVED.

SHEET 1 OF 1

SCALE
-------

N/A

ALL DIMENSIONS SHOWN ARE FOR REFERENCE ONLY.

SIZE	A
------	---

CAGE CODE	3FK
-----------	-----

DRAWN BY  
K.GLEES

ITEM NO.	
----------	--

FMAD1307

REV	
-----	--