

**EXACT12 SAFETY, PRE-WIRED CAP AND ATT. TERMINALS**10m PUR 20x0.34+3x0.75mm<sup>2</sup>

Art.No.: 8000-98749-4081000

Weight: 1.638

Country of origin: CZ

Model designation: MVZ-HSB 408 10.0m

for 8-way distribution boxes, 5-, 4-pole

Homerun cable with spring clamp terminals

11/12-pole

Further cable lengths on request.

Plastic housings with good resistance against chemicals and oils.

The resistance to aggressive media should be individually tested for your application. Further details on request.

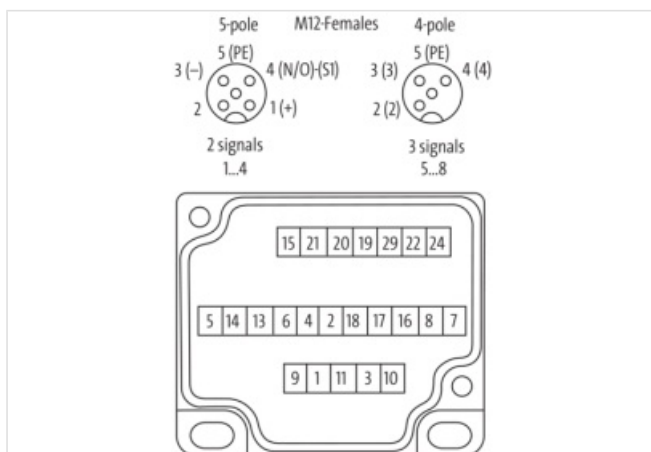
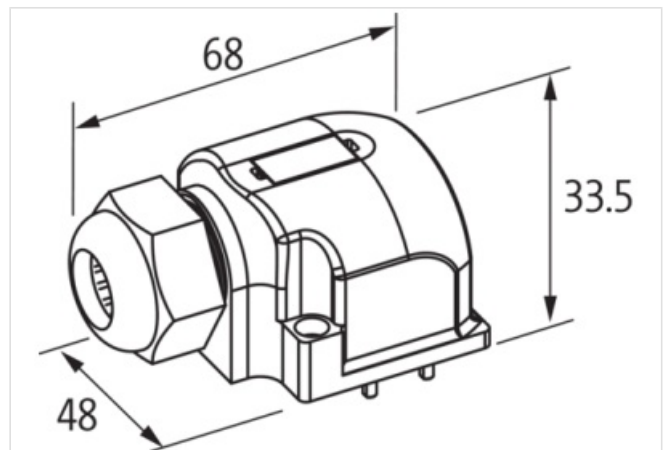
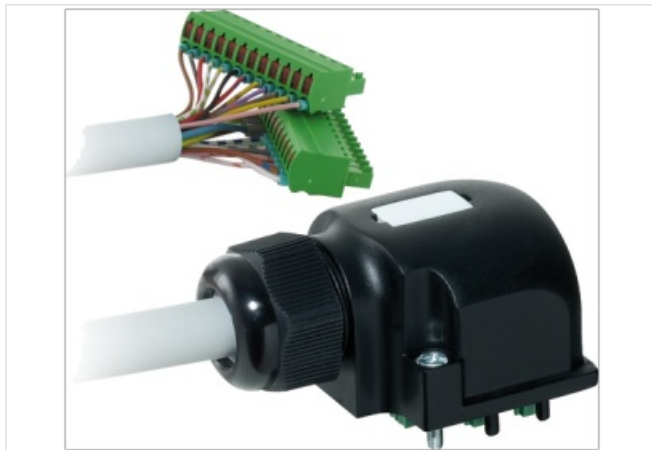
**[Link to Product](#)****Illustration**

Product may differ from Image

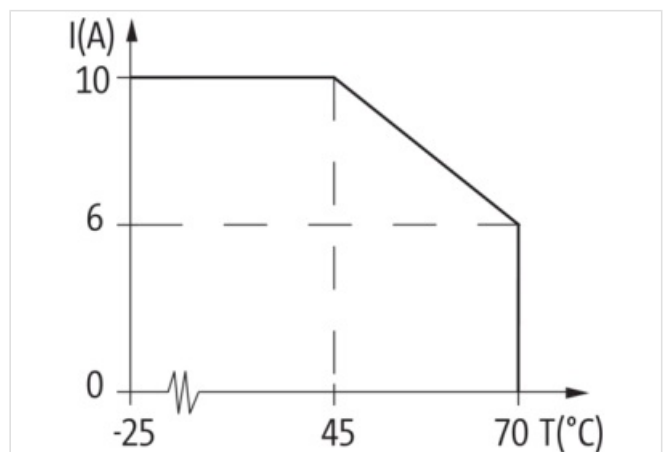
**Commercial data**

URL Webshop

<https://shop.murrelektronik.com/8000-98749-4081000>

GTIN	4048879315654
ECLASS-6.0	27143423
ECLASS-6.1	27279219
ECLASS-7.0	27279219
ECLASS-7.1	27279219
ECLASS-8.0	27279219
ECLASS-8.1	27279219
ECLASS-9.0	27440108
ECLASS-9.1	27440108
ECLASS-10.0.1	27440108
ECLASS-10.1	27440108
ECLASS-11.0	27440108
ECLASS-11.1	27440108
ECLASS-12.0	27440108
ECLASS-13.0	27440108
ECLASS-14.0	27440108
ETIM-5.0	EC002585
ETIM-6.0	EC002585
ETIM-7.0	EC002585
ETIM-8.0	EC002585
EAN	4048879315654

**Electrical data | Supply**

Total current max.	8 A
--------------------	-----

**Device protection | Media**

Flame resistance	flame retardant
------------------	-----------------

**Mechanical data | Material data**

Material housing	Plastic
------------------	---------

**Environmental characteristics | Climatic**

Operating temperature min.	-20 °C
Operating temperature max.	80 °C
Additional condition temperature range	depending on cable quality

**Installation | Cable**

Cable Type	3
Function cable	Hybrid, Signal, Power
Amount stranding	1
Stranding	Wires
Stranding factor min.	80 mm
Stranding factor max.	80 mm
Amount stranding (type 2)	1
Stranding (type 2)	Wires
Stranding factor min. (type 2)	140 mm
Stranding factor max. (type 2)	140 mm
Banding	Fleece
Filler	yes
Wire arrangement	green, red-blue, white, gray-pink, yellow-white, gray, brown-green, yellow, green-white, (, brown, blue, green-yellow, brown-blue, blue-white, brown-pink, white-pink, violet, brown-gray, black, gray-white, red, brown-yellow, pink, )
Cable weight	165.44 g/m
Material wire insulation	PP
Amount wires	20
Outer diameter insulation	1.3 mm
Outer diameter tolerance core insulation	± 0.1 mm

Shore hardness wire insulation	70
Ingredient freeness wire insulation	LABS-free, CFC-free, cadmium-free, silicone-free, halogen-free, lead-free
Amount strands (wire)	42
Diameter of single wires	0.1 mm
Conductor crosssection (wire)	0.34 mm <sup>2</sup>
Material conductor wire	Stranded copper wire, bare
Conductor type (wire)	strand class 6
Material wire insulation (Power)	PP
Outer diameter wire insulation (Power)	1.8 mm
Tolerance outer diameter wire insulation (Power)	± 0.1 mm
Shore hardness wire insulation (Power)	70
Ingredient freeness wire insulation (Power)	LABS-free, CFC-free, cadmium-free, silicone-free, halogen-free, lead-free
Amount wires (Power)	3
Amount strands wire (Power)	96
Diameter of single wires (Power)	0.1 mm
Wire conductor cross section (Power)	0.75 mm <sup>2</sup>
Material conductor wire (Power)	Stranded copper wire, bare
Conductor type wire (Power)	strand class 6
Outer-diameter (jacket)	10.2 mm
Tolerance outer diameter (sheath)	± 5 %
Material jacket	PUR
Shore hardness jacket	90
Freedom from ingredients (jacket)	LABS-free, CFC-free, cadmium-free, silicone-free, halogen-free, lead-free
Material property (jacket)	matte, good machinability, abrasion-resistant, low adhesion
Electrical resistance line constant wire	53 Ω/km @ 20 °C
Electrical resistance coating wire (Power)	26 Ω/km @ 20 °C
Max. rated voltage (conductor - ground)	300 V
Max. rated voltage (conductor - conductor)	500 V
AC withstand voltage (wire - wire)	2 kV @ 60 s
Power frequency withstand voltage (wire - jacket)	2 kV @ 60 s
Current load capacity (standard)	to DIN VDE 0298-4
Current load capacity min. wire	4 A
Current carrying capacity min. wire (Power)	12 A
Min. operating temperature (static)	-40 °C
Max. operating temperature (fixed)	80 °C / 90 °C @ 10000 h Operation
Operating temperature min. (dynamic)	-25 °C
Operating temperature max. (dynamic)	80 °C / 90 °C @ 10000 h Operation
Operating temperature min. (drag chain)	-5 °C
Operating temperature max. (drag chain)	60 °C
Bending radius (fixed)	7.5 × Outer diameter
Bending radius (dynamic)	10 × Outer diameter
No. of bending cycles (C-track)	5 Mio. @ 25 °C
Traversing distance (C-track)	10 m @ 25 °C   horizontal
Travel speed (C-track)	3 m/s @ 25 °C
Acceleration (C-track)	10 m/s <sup>2</sup> @ 25 °C
<b>Connection type 3</b>	
Family construction form	free cable end
No. of poles	23
Family construction form	M12
No. of poles	4
Coding	A

Gender	female
Color contact carrier	yellow
PIN 1	n.c.
PIN 2	2
PIN 3	3
PIN 4	4
PIN 5	PE
Family construction form	M12
No. of poles	5
Coding	A
Gender	female
Color contact carrier	black
PIN 1	+
PIN 2	NC S 2
PIN 3	-
PIN 4	NO S 1
PIN 5	PE