

HC-HPR-B06-BFH-EMR-BK - Housing



1411122

<https://www.phoenixcontact.com/us/products/1411122>

Please be informed that the data shown in this PDF document is generated from our online catalog. Please find the complete data in the user documentation. Our general terms of use for downloads are valid.



HEAVYCON B6 panel mounting base, HPR series, for screw locking, for increased environmental and EMC requirements

Your advantages

- Vibration and shock: IEC 61373/EN 50155, category 1, class 1B

Commercial data

Item number	1411122
Packing unit	1 pc
Minimum order quantity	1 pc
Sales key	BF60
Product key	AF7AAI
GTIN	4046356921428
Weight per piece (including packing)	152 g
Weight per piece (excluding packing)	22.22 g
Customs tariff number	85389099
Country of origin	CN

Technical data

Notes

General	For contact inserts HC-B6, BB10, DD24, M
---------	--

Product properties

Product type	Housing with screw locking
Housing type	Panel mounting base
Product family	HC-HPR-B
Series	HPR-B6
Application	Railway applications
Type	B6
Protective cover	no
Pg screw connection	none

Connection data

Tightening torque	4 Nm (Locking screw)
-------------------	----------------------

Dimensions

Dimensional drawing	
Width	58 mm
Height	20 mm
Length	132 mm
Drill hole distance, horizontal	70 mm
Drill hole distance, vertical	32 mm
Hole diameter	6.5 mm

Installation dimensions

Width of the assembly cutout	35 mm
Length of the assembly cutout	48 mm

Material specifications

Seal material	NBR
Housing material	Die-cast aluminum
Housing surface material	Powder-coated, black
Locking latch material	Stainless steel

Environmental and real-life conditions

Ambient conditions

IP66

HC-HPR-B06-BFH-EMR-BK - Housing



1411122

<https://www.phoenixcontact.com/us/products/1411122>

Degree of protection	IP68 (0.5 bar / 24 h)
	IP69 (ISO 20653:2013-02)
Impact strength	IK09
Ambient temperature (operation)	-40 °C ... 125 °C

Mechanical properties

Mechanical data

Locking type	Nut
--------------	-----

HC-HPR-B06-BFH-EMR-BK - Housing

1411122

<https://www.phoenixcontact.com/us/products/1411122>



Drawings

Dimensional drawing

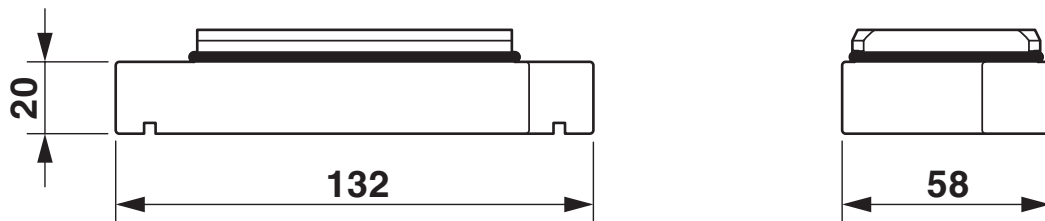

Dimensional drawing

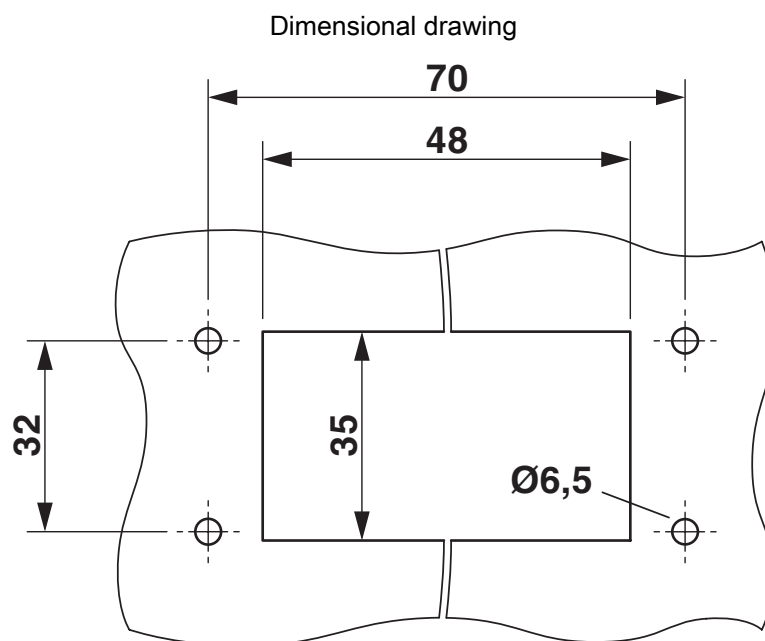

Mounting cutout

HC-HPR-B06-BFH-EMR-BK - Housing



1411122

<https://www.phoenixcontact.com/us/products/1411122>

Approvals

💡 To download certificates, visit the product detail page: <https://www.phoenixcontact.com/us/products/1411122>

DNV

Approval ID: TAE000037S



EAC

Approval ID: RU C-DE.AI30.B.01102

1411122

<https://www.phoenixcontact.com/us/products/1411122>

Classifications

ECLASS

ECLASS-13.0	27440202
ECLASS-15.0	27440202

ETIM

ETIM 9.0	EC000437
----------	----------

UNSPSC

UNSPSC 21.0	31261500
-------------	----------

Environmental product compliance

EU RoHS

Fulfills EU RoHS substance requirements	Yes, No exemptions
---	--------------------

China RoHS

Environment friendly use period (EFUP)	EFUP-E
	No hazardous substances above the limits

EU REACH SVHC

REACH candidate substance (CAS No.)	No substance above 0.1 wt%
-------------------------------------	----------------------------

Phoenix Contact 2025 © - all rights reserved
<https://www.phoenixcontact.com>

Phoenix Contact USA
586 Fulling Mill Road
Middletown, PA 17057, United States
(+717) 944-1300
info@phoenixcon.com