

HC-HV 10/16-TFQ-76/O1STM32G - Housing



1585676

<https://www.phoenixcontact.com/us/products/1585676>

Please be informed that the data shown in this PDF document is generated from our online catalog. Please find the complete data in the user documentation. Our general terms of use for downloads are valid.



HEAVYCON sleeve housing HV10/16, for double locking latch, height 76 mm, with thread 1xM32, straight conductor exit

Commercial data

Item number	1585676
Packing unit	10 pc
Minimum order quantity	100 pc
Product key	AF7AAB
GTIN	4046356291880
Weight per piece (including packing)	243.4 g
Weight per piece (excluding packing)	243.4 g
Country of origin	DE

HC-HV 10/16-TFQ-76/O1STM32G - Housing



1585676

<https://www.phoenixcontact.com/us/products/1585676>

Technical data

Notes

General	For contact inserts HC-HV10/16
---------	--------------------------------

Product properties

Product type	Housing with locking latch
Housing type	Sleeve housing
Type	HV10/16
Type of the screw connection	1x M32
Cable outlet	straight

Dimensions

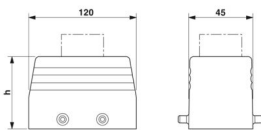
Dimensional drawing	
Width	43 mm
Height	76 mm
Length	120 mm

Material specifications

Housing material	Die-cast aluminum
Housing surface material	Powder-coated, gray

Mechanical properties

Mechanical data

Type of the screw connection	1x M32
------------------------------	--------

Environmental and real-life conditions

Ambient conditions

Degree of protection	IP65
Ambient temperature (operation)	-40 °C ... 125 °C

HC-HV 10/16-TFQ-76/O1STM32G - Housing

1585676

<https://www.phoenixcontact.com/us/products/1585676>



Drawings

Dimensional drawing

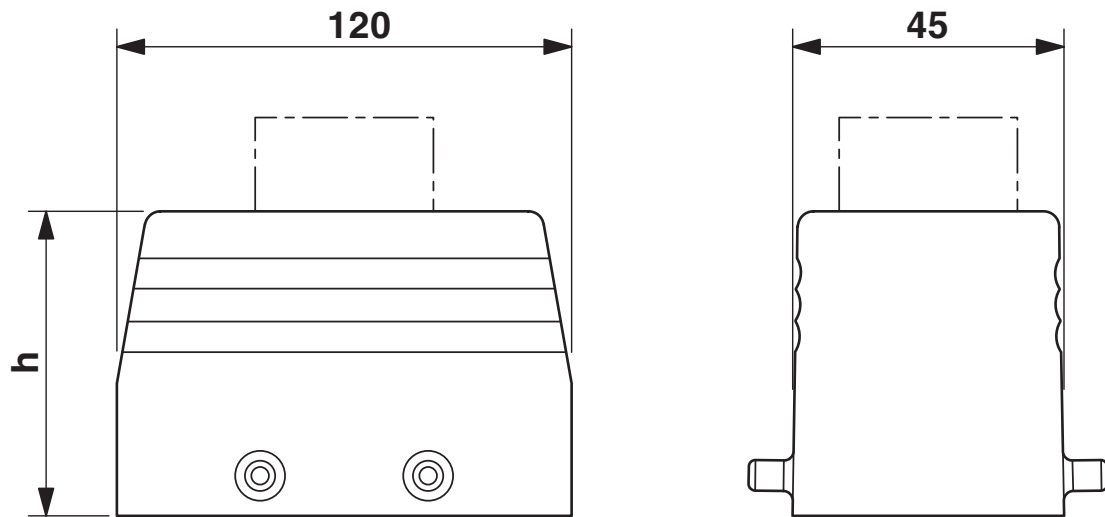

Dimensional drawing

HC-HV 10/16-TFQ-76/O1STM32G - Housing

1585676

<https://www.phoenixcontact.com/us/products/1585676>



Classifications

ECLASS

ECLASS-13.0	27440202
ECLASS-15.0	27440202

HC-HV 10/16-TFQ-76/O1STM32G - Housing



1585676
<https://www.phoenixcontact.com/us/products/1585676>

Environmental product compliance

China RoHS	
Environment friendly use period (EFUP)	EFUP-E
	No hazardous substances above the limits
EU REACH SVHC	
REACH candidate substance (CAS No.)	No substance above 0.1 wt%

Phoenix Contact 2025 © - all rights reserved
<https://www.phoenixcontact.com>

Phoenix Contact USA
586 Fulling Mill Road
Middletown, PA 17057, United States
(+717) 944-1300
info@phoenixcon.com