

# EV-T2G3C-3AC20A-10,0M2,5ESBK01 - AC charging cable



1072637

<https://www.phoenixcontact.com/us/products/1072637>

Please be informed that the data shown in this PDF document is generated from our online catalog. Please find the complete data in the user documentation. Our general terms of use for downloads are valid.



CHARX connect comfort, Type 2, AC charging cable, 20 A permanent, 480 V AC, with vehicle charging connector and open cable end, cable: 10 m, black, straight, with protective cap, housing: black, gray, PHOENIX CONTACT logo, NOTE: Signal transmission is dependent on the cable length and may be adversely affected., IEC 62196-2, for charging electric vehicles (EV) with alternating current (AC) via type 2 vehicle charging inlets

## Product description

AC charging cable with vehicle charging connector and free cable end for charging electric vehicles (EV) with alternating current (AC) via type 2 vehicle charging inlets, for installation at charging stations for e-mobility (EVSE)

## Your advantages

- Complete product range
- Convenient handling due to the ergonomic, triple award-winning design
- Available with your logo on request - for consistent branding of your charging station
- Longitudinal water tightness reliably prevents water ingress
- Developed and produced in accordance with the IATF 16949 automotive standard and ISO 9001
- Tested in accordance with automotive standards LV124, LV214, and LV215-2
- Tested in accordance with EV Ready 37 requirements
- Laser-marked mating face in accordance with DIN EN 17186

## Commercial data

Item number	1072637
Packing unit	1 pc
Minimum order quantity	1 pc
Sales key	EM01
Product key	XWBDBC
GTIN	4055626764771
Weight per piece (including packing)	3,180 g
Weight per piece (excluding packing)	2,487 g
Customs tariff number	85444290
Country of origin	PL

# EV-T2G3C-3AC20A-10,0M2,5ESBK01 - AC charging cable



1072637

<https://www.phoenixcontact.com/us/products/1072637>

## Technical data

### Product properties

Product type	AC charging cable
Product family	CHARX connect comfort
Application	for charging electric vehicles (EV) with alternating current (AC) via type 2 vehicle charging inlets
	for installation at charging stations for electromobility (EVSE)
Design	with protective cap
Charging standard	Type 2
Charging mode	Mode 3, Case C
Affixed logo	PHOENIX CONTACT logo
Customer variations	On request

### Electrical properties

#### Charging power and current (AC charging (3-phase))

Type of charging current	AC 3-phase
Charging current	20 A AC (3-phase)
Charging power	16.63 kW (3-phase)
Rated voltage	480 V

#### Pin assignment (Leistungskontakte)

Note on the connection method	Crimp connection, cannot be disconnected
Number	5 (L1, L2, L3, N, PE)
Rated voltage	480 V AC
Rated current	20 A

#### Pin assignment (Signalkontakte)

Note on the connection method	Crimp connection, cannot be disconnected
Type of signal transmission	Pulse width modulation
Number	2 (CP, PP)
Rated voltage	30 V AC
Rated current	2 A
Coding	680 $\Omega$ (between PE and PP)

### Dimensions

#### Vehicle charging connector

Width	70 mm
Height	137 mm
Depth	215.9 mm

### Material specifications

Color (Housing)	black (9005)
Color (Handle area)	gray (7042)

# EV-T2G3C-3AC20A-10,0M2,5ESBK01 - AC charging cable



1072637

<https://www.phoenixcontact.com/us/products/1072637>

Color (Mating face)	black (9005)
Color (Protective cap)	black (9005)
Color (Cable)	black (9005)
Material (Vehicle charging connector)	Plastic
Material (Cable outer sheath)	TPE-U
Material (Contact surface)	Silver
Note	The color appearance and gloss level of the charging cable may vary.

## Cable/line

Cable length	10 m
Wiring standards/regulations	prEN 50620/DIN EN 50620
Wiring certifications	VDE
Cable weight	max. 250.00 kg/km
Cable type	Class 5
Cable type	straight
Cable structure	5 x 2.5 mm <sup>2</sup> + 1 x 0.5 mm <sup>2</sup>
External cable diameter	12.80 mm ±0.4 mm
Outer sheath, material	TPE-U
Stripping length of the sheath	70 mm ±5 mm
Stripping length	70 mm ±5 mm
Cable resistance	≤ 0.00798 Ω/m (based on a power core, at an ambient temperature of 20°C)
Bending radius	min. 192 mm (15x diameter)

## Mechanical properties

### Mechanical data

Insertion/withdrawal cycles	> 10000
Insertion force	< 100 N
Withdrawal force	< 100 N

## Environmental and real-life conditions

### Ambient conditions

Degree of protection (Vehicle charging connector)	IP44 (plugged in; when plugged in and ready to operate, the degree of protection is only ensued if both plug-in components are original products from Phoenix Contact or suitable standard-compliant products)
Degree of protection (Protective cap)	IP54
Ambient temperature (operation)	-40 °C ... 50 °C
Ambient temperature (storage/transport)	-40 °C ... 80 °C
Altitude	5000 m (above sea level)

## Standards and regulations

Connection in accordance with standard

1072637  
<https://www.phoenixcontact.com/us/products/1072637>

Normative cable length restrictions	NOTE: Signal transmission is dependent on the cable length and may be adversely affected.
	The cable capacity must therefore be assessed in the overall system of the charging station and must not exceed 3100 pF (IEC 61851-1, Annex A, Table A.2, Note d).
	Interference-free V2G communication in accordance with ISO 15118 is not guaranteed for cable lengths over 10 m (ISO IEC 15118-3, A.11.3, Table A.11).
	Cable management is required in the US if the cable length exceeds 7.5 m (IEC 61851-1).
Standards	
Standards/regulations	IEC 62196-2

# EV-T2G3C-3AC20A-10,0M2,5ESBK01 - AC charging cable



1072637

<https://www.phoenixcontact.com/us/products/1072637>

## Drawings

Dimensional drawing

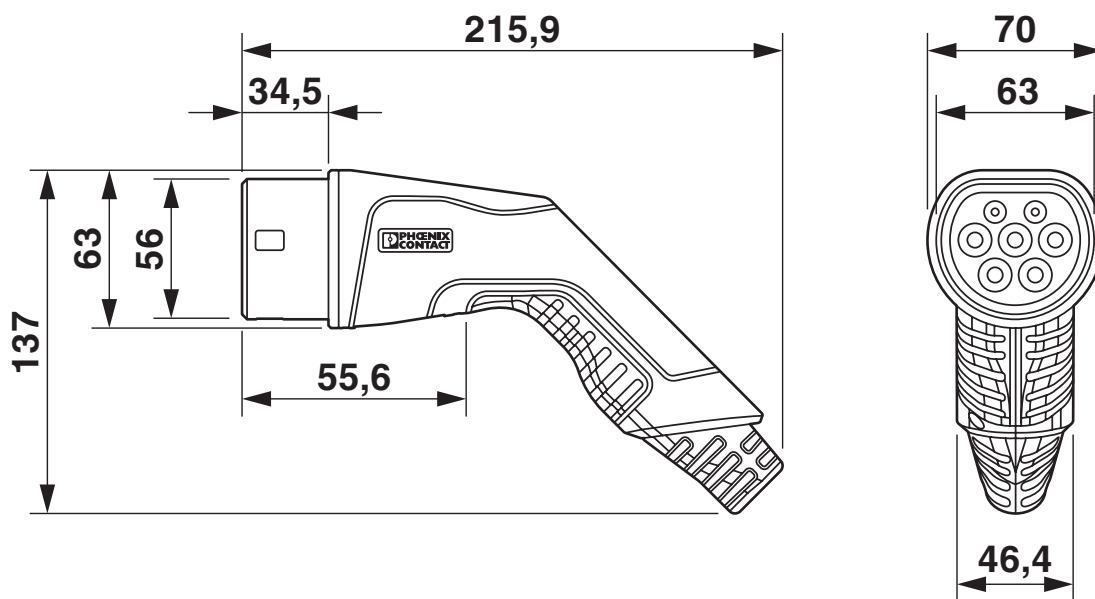

Make sure that the vehicle charging connector is placed in an appropriate charging connector holder, which ensures a minimum protection rating of IP24 in accordance with IEC 61851-1, for the entire time between charging. To create this charging connector holder, use the dimensions of the vehicle charging connector. Detailed dimensions can also be found in the Download area.

# EV-T2G3C-3AC20A-10,0M2,5ESBK01 - AC charging cable

1072637

<https://www.phoenixcontact.com/us/products/1072637>

Schematic diagram

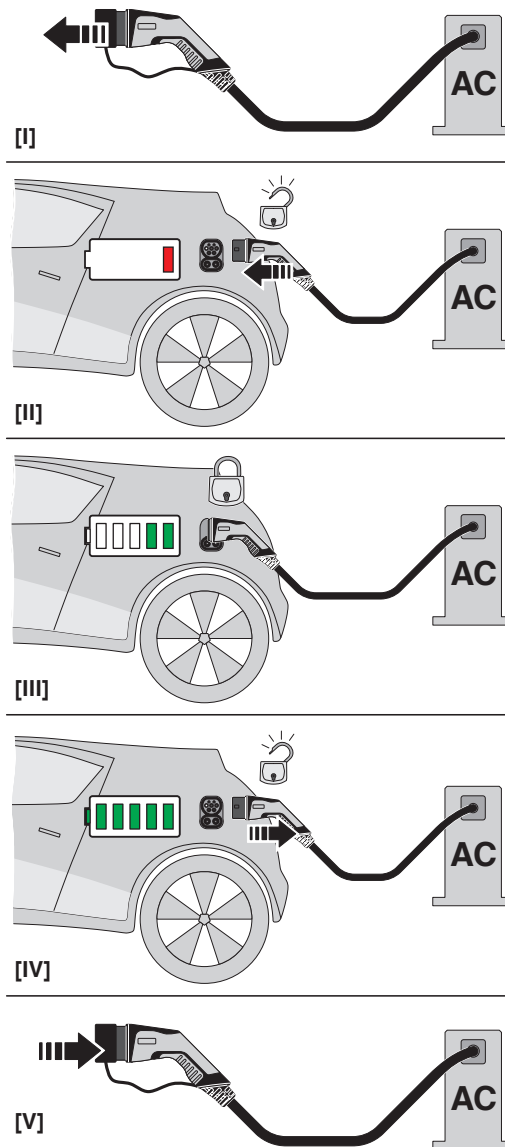

Operating instructions

# EV-T2G3C-3AC20A-10,0M2,5ESBK01 - AC charging cable

1072637

<https://www.phoenixcontact.com/us/products/1072637>

Schematic diagram

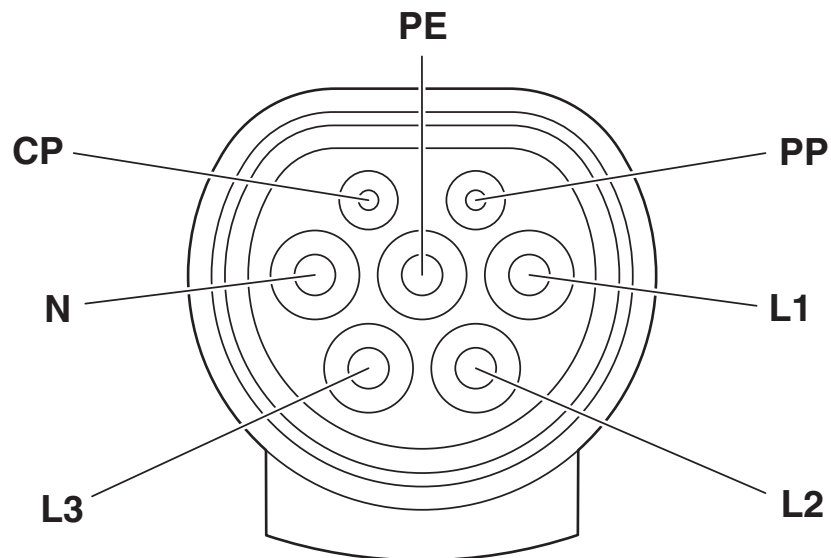

Pin assignment of the Vehicle Connector

Schematic diagram

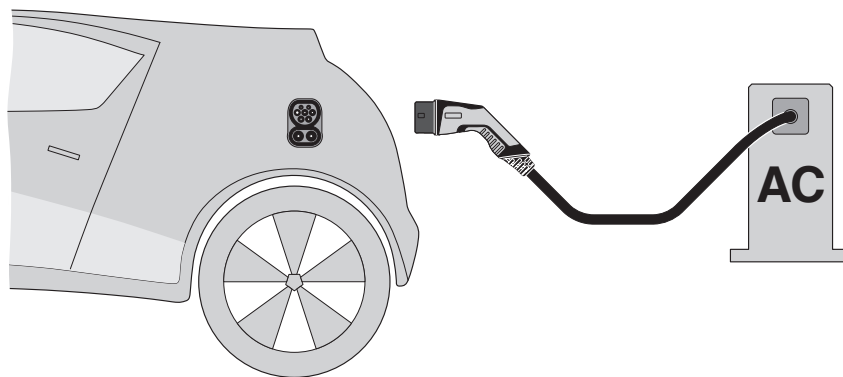



Terminology definition

1072637  
<https://www.phoenixcontact.com/us/products/1072637>

Approvals

To download certificates, visit the product detail page: <https://www.phoenixcontact.com/us/products/1072637>

	<b>IECEE CB Scheme</b> Approval ID: DE1-65898/M1			
	Nominal voltage U <sub>N</sub>	Nominal current I <sub>N</sub>	Cross section AWG	Cross section mm <sup>2</sup>
	keine			
	480 V	20 A	-	-

	<b>VDE approval of drawings</b> Approval ID: 40045387			
	Nominal voltage U <sub>N</sub>	Nominal current I <sub>N</sub>	Cross section AWG	Cross section mm <sup>2</sup>
	keine			
	480 V	20 A	-	-



# EV-T2G3C-3AC20A-10,0M2,5ESBK01 - AC charging cable



1072637  
<https://www.phoenixcontact.com/us/products/1072637>

## Classifications

### ECLASS

ECLASS-13.0	27144705
ECLASS-15.0	27144705

### ETIM

ETIM 9.0	EC002897
----------	----------

### UNSPSC

UNSPSC 21.0	39121500
-------------	----------

# EV-T2G3C-3AC20A-10,0M2,5ESBK01 - AC charging cable



1072637

<https://www.phoenixcontact.com/us/products/1072637>

## Environmental product compliance

### EU RoHS

Fulfills EU RoHS substance requirements	Yes
Exemption	6(c)

### China RoHS

Environment friendly use period (EFUP)	EFUP-50
	An article-related China RoHS declaration table can be found in the download area for the respective article under "Manufacturer declaration". For all articles with EFUP-E, no China RoHS declaration table issued and required.

### EU REACH SVHC

REACH candidate substance (CAS No.)	Lead(CAS: 7439-92-1)
SCIP	8d46daee-1f96-4887-a8bf-e01a15a7cc67

Phoenix Contact 2025 © - all rights reserved

<https://www.phoenixcontact.com>

Phoenix Contact USA  
586 Fulling Mill Road  
Middletown, PA 17057, United States  
(+717) 944-1300  
[info@phoenixcon.com](mailto:info@phoenixcon.com)