

Series 44 Banding Backshells

for MIL-DTL-38999 Series I and II Connectors

443F*024 Banding Backshell, Shrouded Environmental



Self-Locking

Adapter Code F

This accessory fits these connectors:
MIL-DTL-38999 Series I and Series II

PROFILE SELECTION GUIDE

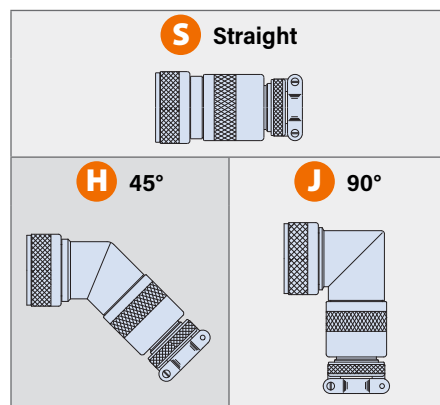

PART NUMBER

PART NUMBER		443FS024		NF	18	06-	3	S		
Base P/N	Base Part No.									
	Profile									
	443FS024	S	Straight							
	443FH024	H	45°							
	443FJ024	J	90°							
Material/Finish	M	Alum/ Electroless Nickel								
	MT	Alum/ Nickel-PTFE								
	NF	Alum/ Olive Drab Cadmium								
	ZR	Alum/ Black Zinc-Nickel								
	TZ	Alum/ Tin-Zinc								
	ZM	SST/ Electroless Nickel								
Shell Size	Shell Size									
	38999 Series I	9	11	13	15	17	19	21	23	25
	38999 Series II	8	10	12	14	16	18	20	22	24
	Size Code	08	10	12	14	16	18	20	22	24
Entry Size	See Table 1									
Length	2	1.0 inch	Applies to Profile S only. If Entry Size is greater than "Maximum Entry Size", then 1.5 inch minimum applies.							
	3	1.5 inches								
	4	2.0 inches								
	6	3.0 inches								
Self-Locking	S	Self-Locking Coupling Nut								

TABLE 1: ENTRY SIZE

Entry Size	Cable Range		J Max.	W Closed	ø X Min	Shell Sizes*
	Min.	Max.				
	in	mm	in	mm	in	
01	.125	3.2	.250	6.4	1.05	26.7 .264 6.7 .25 6.4 08-24
02	.188	4.8	.375	9.5	1.20	30.5 .344 8.7 .37 9.4 10-24
03	.312	7.9	.438	11.1	1.30	33.0 .460 11.7 .43 10.9 12-24
04	.343	8.7	.500	12.7	1.44	36.6 .545 13.8 .50 12.7 12-24
05	.438	11.1	.625	15.9	1.69	42.9 .698 17.7 .62 15.7 14-24
06	.562	14.3	.750	19.1	1.77	45.0 .780 19.8 .75 19.1 16-24
07	.688	17.5	.875	22.2	2.12	53.8 .950 24.1 .87 22.1 18-24
08	.812	20.6	1.000	25.4	2.50	63.5 1.015 25.8 1.00 25.4 20-24
09	.938	23.8	1.125	28.6	2.62	66.5 1.187 30.1 1.12 28.4 22-24
10	1.062	27.0	1.250	31.8	2.68	68.1 1.220 31.0 1.25 31.8 —
11	1.125	28.6	1.375	34.9	3.00	76.2 1.500 38.1 1.38 35.1 —
12	1.250	31.8	1.500	38.1	3.50	88.9 1.625 41.3 1.50 38.1 —

* If Entry Size exceeds the shell size range in this table, the backshell will include a "Style 2" adapter. See "Maximum Entry Size" on next page.

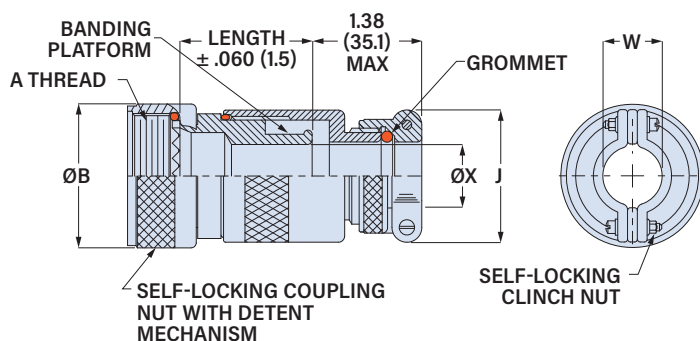

Shell Size	A Thread	øB Max	Max Entry Size*
8/9	0.4375-28	.860	21.8 01
10/11	0.5625-24	.970	24.6 02
12/13	0.6875-24	1.110	28.2 04
14/15	0.8125-20	1.210	30.7 05
16/17	0.9375-20	1.350	34.3 06
18/19	1.0625-18	1.460	37.1 07
20/21	1.1875-18	1.600	40.6 08
22/23	1.3125-18	1.700	43.2 09
24/25	1.4375-18	1.840	46.7 09

* If Entry Size exceeds the Max Entry Size in this table, the backshell will include a "Style 2" adapter. See "Maximum Entry Size" on next page.

Series 44 Banding Backshells

for MIL-DTL-38999 Series I and II Connectors

443F*024 Banding Backshell, Shrouded, Environmental

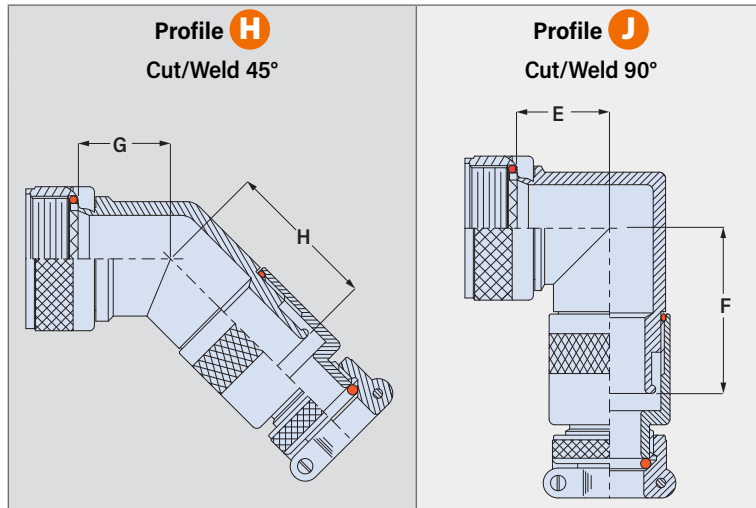

Shell Size	E Max.		F Max.		G Max.		H Max.	
	in	mm	in	mm	in	mm	in	mm
8/9	.75	19.1	1.50	38.1	.639	16.2	1.380	35.1
10/11	.81	20.6	1.55	39.4	.664	16.9	1.410	35.8
12/13	.87	22.1	1.61	40.9	.688	17.5	1.430	36.3
14/15	.92	23.4	1.68	42.7	.705	17.9	1.460	37.1
16/17	.98	24.9	1.74	44.2	.732	18.6	1.480	37.6
18/19	1.02	25.9	1.76	44.7	.748	19.0	1.490	37.8
20/21	1.08	27.4	1.82	46.2	.773	19.6	1.510	38.4
22/23	1.14	29.0	1.90	48.3	.800	20.3	1.550	39.4
24/25	1.20	30.5	1.97	50.0	.823	20.9	1.580	40.1

MAXIMUM ENTRY SIZE

If the selected entry size exceeds the maximum size in this table, the backshell will have a front adapter. This is called a **Style 2** backshell.

Shell Size	Max. Entry Size	Shell Size	Max. Entry Size
8/9	01	18/19	07
10/11	02	20/21	08
12/13	04	22/23	09
14/15	05	24/25	09
16/17	06		

Style 2 Straight Backshell

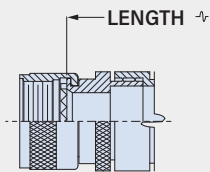

For Style 2 straight backshells, the minimum length code increases from 2 (1 inch) to 4 (2 inches).

Style 2 45° and 90° Backshells

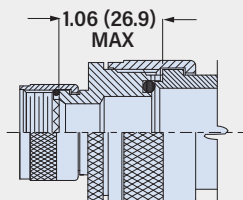

For Style 2 45° and 90° backshells, the length increases by 1.06 inches.

BAND

SST band strap (not included, ordered separately) provides fast, cost-effective and highly reliable termination of braided metallic shielding. The Band-Master ATS® Advanced Cable Shield Termination System is the overwhelming favorite throughout the military aerospace and defense industries, providing excellent static loading and corrosion resistance in electrical wire interconnect systems.

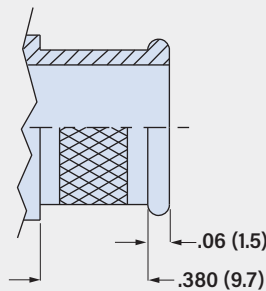

Band
601-041



Banding Tool
601-100

APPLICATION NOTE

This backshell has a **full radius** saddle clamp. This type of strain relief is designed to be fully closed. Saddle bars should be bottomed onto frame. Build up cable diameter with tape or sleeving to meet the diameter of the fully closed clamp.

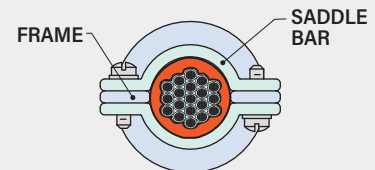

**FULL RADIUS
SADDLE CLAMP**
SADDLE BARS SHOULD BE FULLY
BOTTOMED ONTO FRAME.