

BACKSHELL KIT INCLUDES:

- (2) BACKSHELL HALVES
- (2) HOUSING SCREWS
- (2) HOUSING NUTS
- (2) 4-40 MOUNTING SCREWS
- (2) SADDLE WASHERS
- (2) STRAIN RELIEF CLAMPS
- (2) STRAIN RELIEF SCREWS

METALIZED PLASTIC:

- MATERIAL: ABS HIGH TEMPERATURE PLASTIC UL94HB
- METALIZED PLATING: NICKEL OVER COPPER
- OPERATING TEMP: 0°C TO 85°C

PLASTIC:

- MATERIAL: ABS HIGH TEMPERATURE PLASTIC UL94HB
- OPERATING TEMP: 0°C TO 85°C

MAXIMUM RECOMMEND TORQUE FOR ALL HARDWARE:
50 IN-OZ

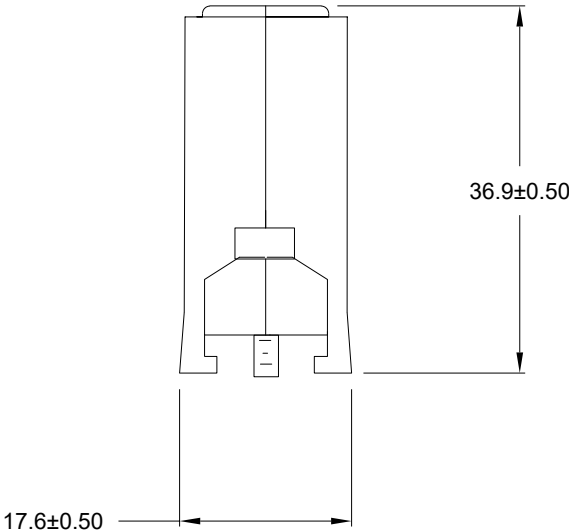
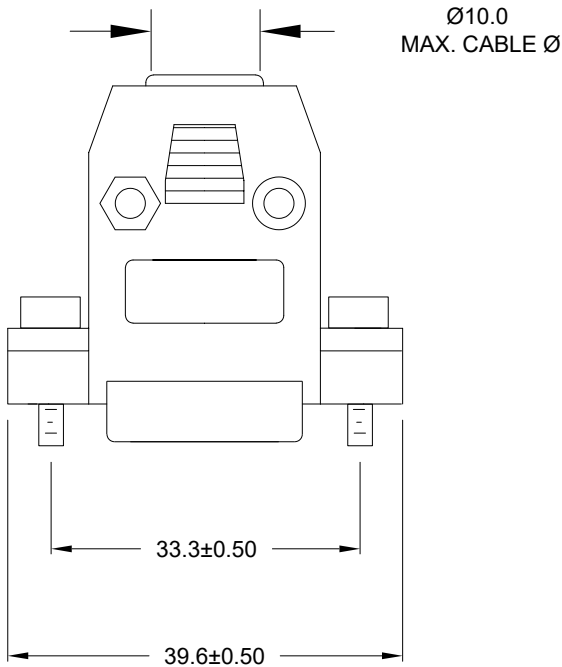

977-015-0Y0 R YY 1

SERIES _____

POSITIONS _____

015 _____

MATERIAL _____

010 = PLASTIC

020 = METALIZED PLASTIC

RoHS COMPLIANT _____

COLOR _____

03 = GREY (ONLY USE WITH 010 OPTION ABOVE)

12 = METALIZED (ONLY USE WITH 020 OPTION ABOVE)

PUT-UP _____

1 = KIT

RoHS COMPLIANT

DRAWN:
J. KADEL

DATE:
08/22/2019

UNITS = mm

DO NOT SCALE FROM DRAWING



THESE DRAWINGS AND SPECIFICATIONS ARE THE PROPERTY OF NorComp AND SHALL NOT BE REPRODUCED, COPIED OR USED AS THE BASIS FOR THE MANUFACTURE OR SALE OF APPARATUS WITHOUT WRITTEN PERMISSION.

NorComp

SCALE: NTS

SHEET 1 OF 1

REV 3

DWG NO. 977-015-0Y0RYY1