

SPECIFICATIONS:

<b>ELECTRICAL:</b>	
RATED CURRENT:	5A
RATED VOLTAGE:	300VDC
WITHSTANDING VOLTAGE:	500VAC (rms) FOR 1 MIN
INSULATION RESISTANCE:	> 1,000 mΩ at 500VDC
CONTACT RESISTANCE:	13mOhms MAX
DIELECTRIC STRENGTH:	1000VAC FOR 1 MIN
OPERATING TEMPERATURE:	-55°C TO +105°C
<b>MATERIALS:</b>	
SHELL:	NICKEL PLATED STEEL
BRACKET:	NICKEL PLATED STEEL
INSULATOR:	NYLON 6T, UL 94V-0, BLACK
PROCESS TEMP:	260°C
INSULATOR:	PATONE #322C, COLOR=Pc99
CONTACT:	TIN PLATED PHOSPHOR BRONZE
	MATING AREA (SEE P/N KEY)
	TIN PLATED PCB SOLDER AREA

190-025-163R00Y

CONTACT PLATING (MATING AREA):  
1 = GOLD FLASH  
2 = 30μ" GOLD

RoHS COMPLIANT



THESE DRAWINGS AND SPECIFICATIONS ARE THE PROPERTY OF NorComp AND SHALL NOT BE REPRODUCED, COPIED OR USED AS THE BASIS FOR THE MANUFACTURE OR SALE OF APPARATUS WITHOUT WRITTEN PERMISSION.	DRAWN: C. SMITH
	DATE: 04/14/2009

UNITS = inch [mm]

DO NOT SCALE FROM DRAWING

NorComp	SCALE: NTS	SHEET 1	OF 2	REV 14
	DWG NO. 190-025-163R001			

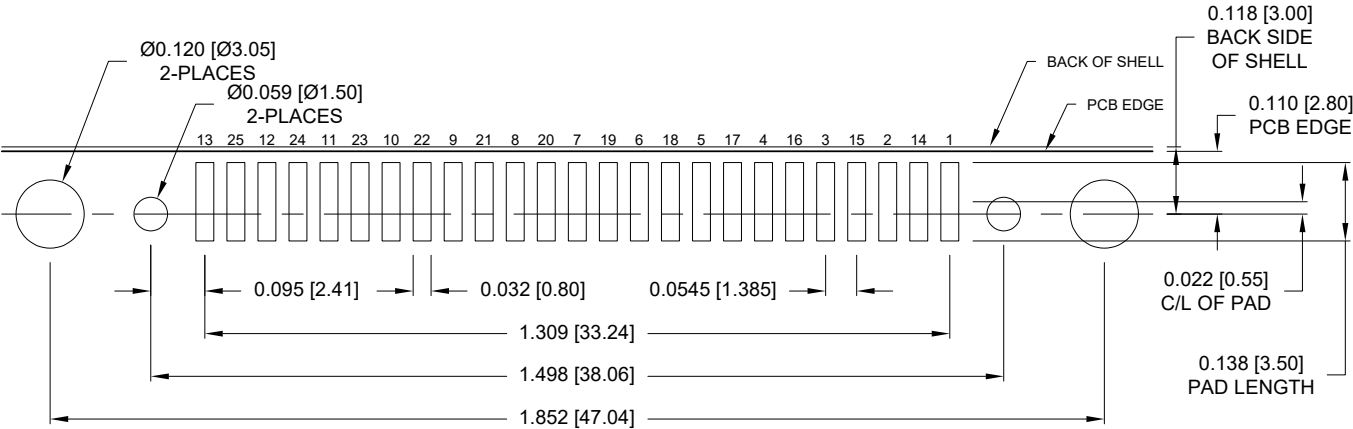

RECOMMENDED PCB LAYOUT

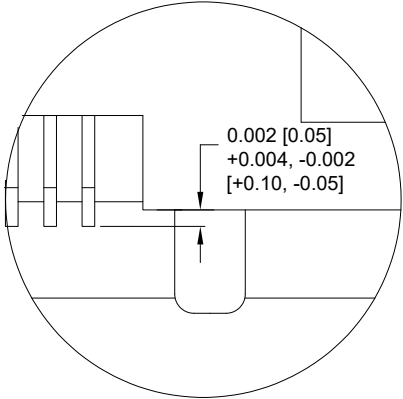

DETAIL "B"  
CONTACT COPLANARITY

SEE DETAIL "B"  
FOR CONTACT  
COPLANARITY

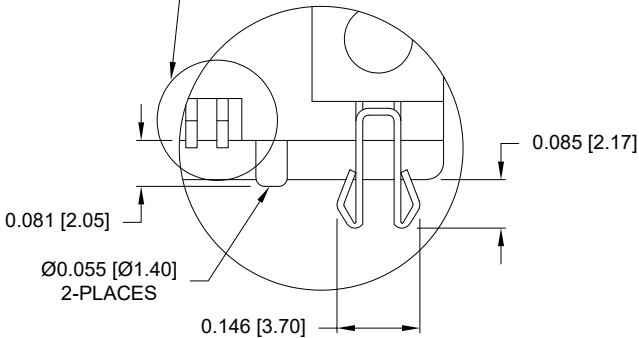

DETAIL "A"

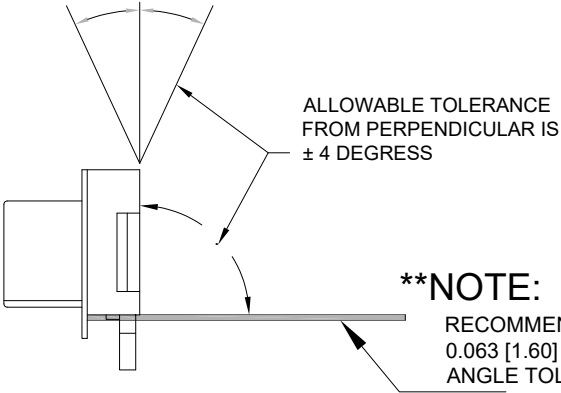

**\*\*NOTE:**  
RECOMMENDED PCB THICKNESS IS  
0.063 [1.60] ± 0.002 [0.05] TO MAINTAIN  
ANGLE TOLERANCE

RoHS COMPLIANT



THESE DRAWINGS AND SPECIFICATIONS ARE THE PROPERTY OF NorComp AND SHALL NOT BE REPRODUCED, COPIED OR USED AS THE BASIS FOR THE MANUFACTURE OR SALE OF APPARATUS WITHOUT WRITTEN PERMISSION.

DRAWN:  
C. SMITH

DATE:  
04/14/2009

UNITS = inch [mm]

DO NOT SCALE FROM DRAWING

NorComp

SCALE:  
NTS

SHEET 2 OF 2

REV 14

DWG NO. 190-025-163R001