

LED FESTOON LAMP

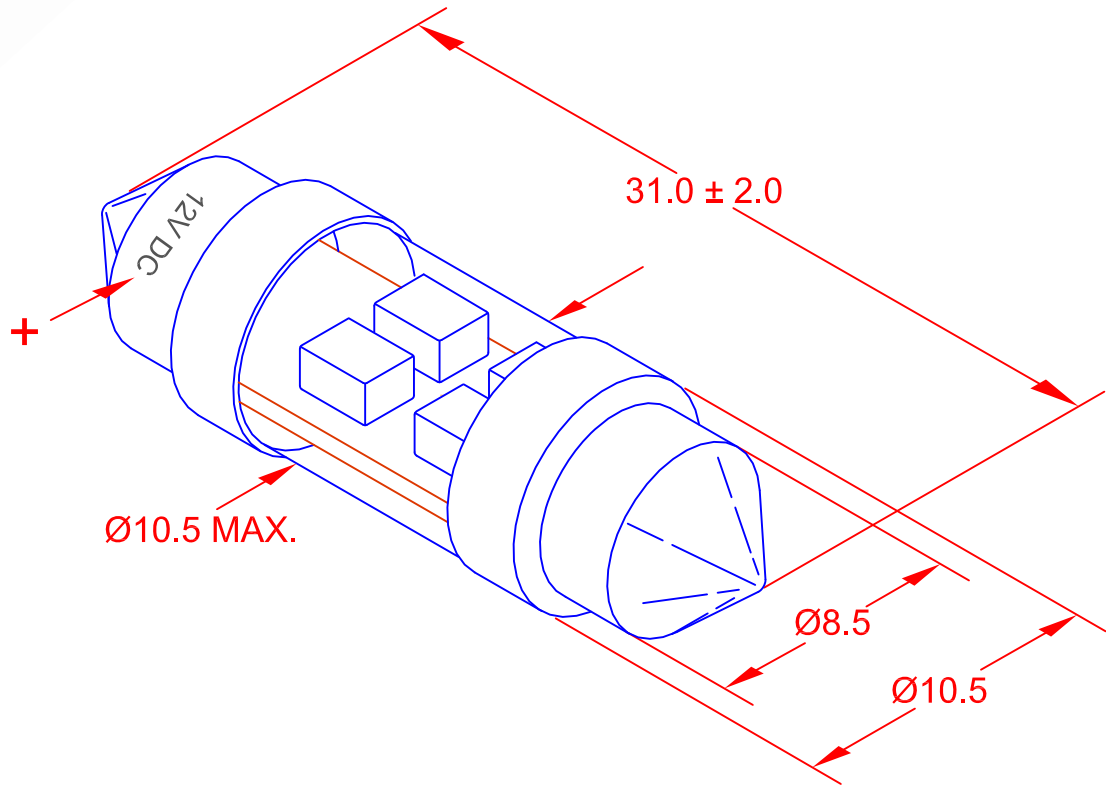

NOTES:

1. LED includes integrated diode for reverse voltage protection.
2. LED includes integrated resistor for current limiting.

TYPICAL ELECTRICAL & OPTICAL OPERATING CHARACTERISTICS

(Ta = 25 degree C)

PART NUMBER	EMITTING COLOR	AMPERAGE mA	VOLTAGE Vdc	LUMENS
LE-1031-02W	WHITE 9000K	20mA	12	7.6

			METRIC		DIMENSIONS ARE IN MILLIMETERS		JKL COMPONENTS CORPORATION			
					TOLERANCE UNLESS OTHERWISE SPECIFIED		TITLE			
			THIRD ANGLE PROJECTION		1 PL +/- 0.2 2 PL +/- 0 ANGLE +/- 0		LED FESTOON LAMP			
			DRAWN BY L. WENGSTROM		APPV'D BY S.N.		DATE 4/16/25	SIZE A	FSCM NO. 55335	DRAWING NO. LE-1031-02W
REV. NO.	DESCRIPTION/ECO NUMBER	DATE	- CAD DRAWING - MANUAL REVISIONS NOT PERMITTED			SCALE NONE	RELEASED DATE 7/15/13	REVISION DATE 4/16/25	REV. NO. A	SHEET 1 OF 1
A	CH TO SMD LED PACAKGE, UPDATE DRAWING + PHOTO	4/16/25								
	RELEASE	7/15/13								