

**Description:** Direct Mount LPT Style  
Antenna 698-2700 MHz, U.FL/SMA(M)

**PART NUMBER: W1978/W1979**

**Features:**

- LTE Monopole antenna
- 698-2700MHz
- Direct mount with coax feed
- Polarization: Vertical
- Pattern: Omni in H-plane
- Gain: 1.4 / 2.7 / 3.5dBi
- IP67
- Height 77.2mm / 3.04 inch

**Applications:**

- LTE Radio systems
- Public Safety
- Metering
- Transportation, logistics
- Vehicular use

**W1978****W1979**

All dimensions are in mm / inches

Issue: 2150

In the effort to improve our products, we reserve the right to make changes judged to be necessary.

CONFIDENTIAL AND PROPRIETARY INFORMATION

This document contains confidential and proprietary information of Pulse Electronics, Inc. (Pulse) and is protected by copyright, trade secret and other state and federal laws. Its receipt or possession does not convey any rights to reproduce, disclose its contents, or to manufacture, use or sell anything it may describe. Reproduction, disclosure or use without specific written authorization of Pulse is strictly forbidden.

For more information:

Pulse Worldwide Headquarters  
15255 Innovation Drive #100  
San Diego, CA 92128  
USA  
Tel: 1-858-674-8100

Pulse/Larsen Antennas  
18110 SE 34<sup>th</sup> St Bldg 2 Suite 250  
Vancouver, WA 98683  
USA  
Tel: 1-360-944-7551

Europe Headquarters  
Pulse GmbH & Co, KG  
Zeppelinstrasse 15  
Herrenberg, Germany  
Tel: 49 7032 7806 0

Pulse (Suzhou) Wireless Products Co, Inc.  
99 Huo Ju Road(#29 Bldg, 4<sup>th</sup> Phase  
Suzhou New District  
Jiangsu Province, Suzhou 215009 PR China  
Tel: 86 512 6807 9998

**Series: LPT Antenna****TECHNICAL DATA SHEET****Description:** Direct Mount LPT Style  
Antenna 698-2700 MHz, U.FL/SMA(M)**PART NUMBER: W1978/W1979****ELECTRICAL SPECIFICATIONS**

Antenna type	Monopole (All electrical performance measured with antenna centered on 12"x12" ground plane)	
Frequency	698-960/1710-2170/2300-2700	MHz
Nominal Impedance	50	$\Omega$
VSWR(698-960)	2.5:1	Max
VSWR(1710-2700)	2:1	Max
Peak Gain(698-960, typical)	1.4	dBi
Peak Gain(1710-2170, typical)	2.7	dBi
Peak Gain(2300-2700, typical)	3.5	dBi
Efficiency (all band typical)	60	%
Polarization	Vertical	
HPBW Horizontal Plane @0° EL	360	°
HPBW Vertical Plane (698-960)	66	° Avg
HPBW Vertical Plane (1710-2170)	48	° Avg
HPBW Vertical Plane (2300-2700)	43	° Avg
Power withstanding	10	W
Mounting	Direct mount	

**Series: LPT Antenna**

## TECHNICAL DATA SHEET

**Description:** Direct Mount LPT Style  
Antenna 698-2700 MHz, U.FL/SMA(M)

**PART NUMBER: W1978/W1979**

### MECHANICAL SPECIFICATIONS

Overall Length with cable	795.6mm
Weight	W1978:98.4g/W1979:117.6g
Antenna Color / Radome Material	Gray/ PC+ Polyester blend
Connector type	W1978:U.FL/W1979:SMA Male)
Cable type	W1978:1.37/W1979: RG174
Cable length	700mm

### ENVIRONMENTAL SPECIFICATIONS

Operating Temperature	-40/+85° C
Storage Temperature	-40/+85° C
Ingress Protection	IP67
Wind-loading	165m/h
RoHS Compliant	Yes

Issue: 2150

In the effort to improve our products, we reserve the right to make changes judged to be necessary.

CONFIDENTIAL AND PROPRIETARY INFORMATION

This document contains confidential and proprietary information of Pulse Electronics, Inc. (Pulse) and is protected by copyright, trade secret and other state and federal laws. Its receipt or possession does not convey any rights to reproduce, disclose its contents, or to manufacture, use or sell anything it may describe. Reproduction, disclosure or use without specific written authorization of Pulse is strictly forbidden.

## MECHANICAL DRAWING

W1978

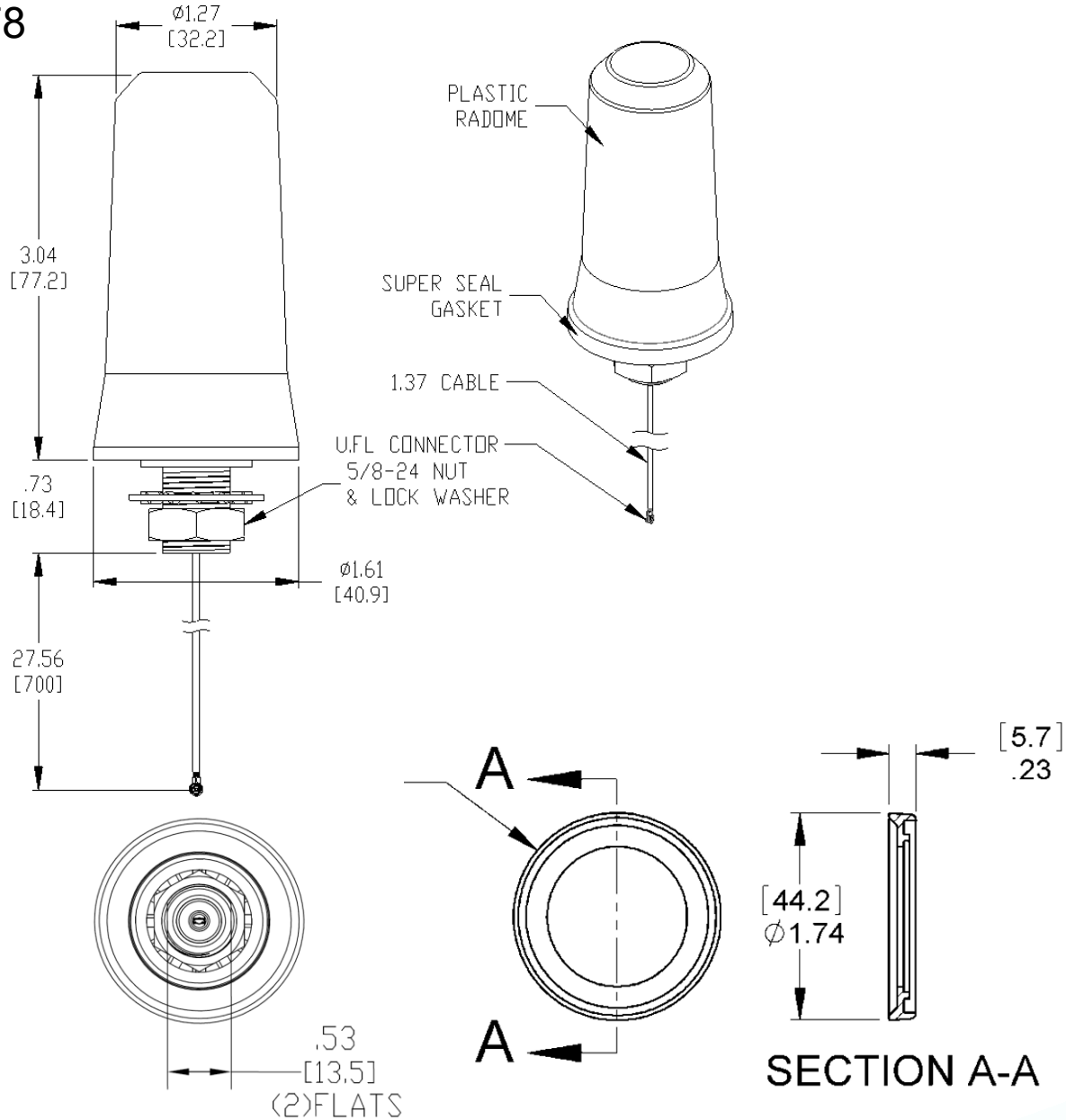

Issue: 2150

In the effort to improve our products, we reserve the right to make changes judged to be necessary.

CONFIDENTIAL AND PROPRIETARY INFORMATION

This document contains confidential and proprietary information of Pulse Electronics, Inc. (Pulse) and is protected by copyright, trade secret and other state and federal laws. Its receipt or possession does not convey any rights to reproduce, disclose its contents, or to manufacture, use or sell anything it may describe. Reproduction, disclosure or use without specific written authorization of Pulse is strictly forbidden.

## MECHANICAL DRAWING

W1979

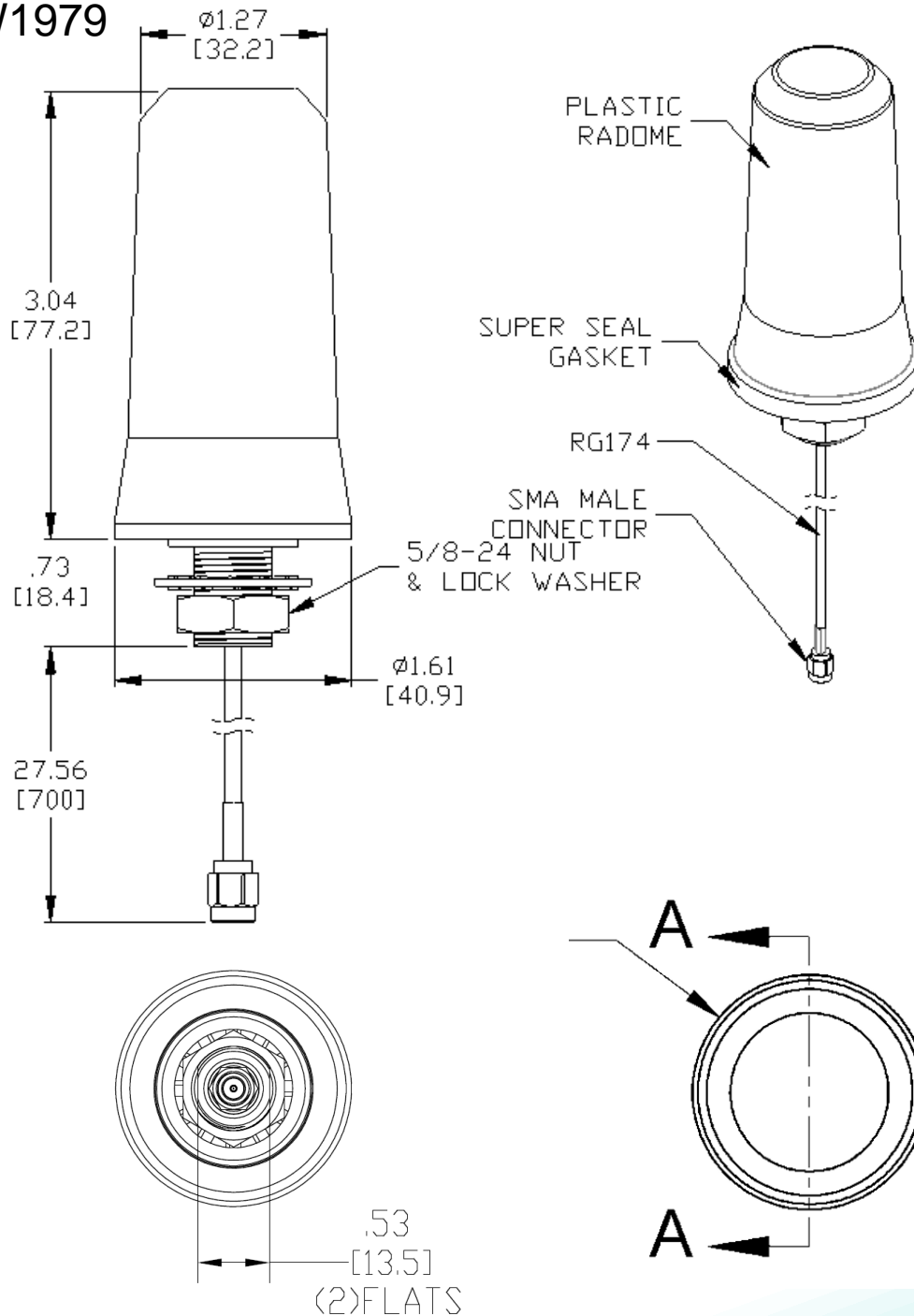

Issue: 2150

In the effort to improve our products, we reserve the right to make changes judged to be necessary.

CONFIDENTIAL AND PROPRIETARY INFORMATION

This document contains confidential and proprietary information of Pulse Electronics, Inc. (Pulse) and is protected by copyright, trade secret and other state and federal laws. Its receipt or possession does not convey any rights to reproduce, disclose its contents, or to manufacture, use or sell anything it may describe. Reproduction, disclosure or use without specific written authorization of Pulse is strictly forbidden.

**Series: LPT Antenna**

**TECHNICAL DATA SHEET**

**Description:** Direct Mount LPT Style  
Antenna 698-2700 MHz, U.FL/SMA(M)

**PART NUMBER: W1978/W1979**

**MECHANICAL DRAWING**

Item	Part Number	Description
1	W1978	Band 698-960/1710-2170/2300-2700 MHz with .7 meter cable assembly with U.FI
2	W1979	Band 698-960/1710-2170/2300-2700 MHz with .7 meter cable assembly with SMA

Issue: 2150

In the effort to improve our products, we reserve the right to make changes judged to be necessary.

CONFIDENTIAL AND PROPRIETARY INFORMATION

This document contains confidential and proprietary information of Pulse Electronics, Inc. (Pulse) and is protected by copyright, trade secret and other state and federal laws. Its receipt or possession does not convey any rights to reproduce, disclose its contents, or to manufacture, use or sell anything it may describe. Reproduction, disclosure or use without specific written authorization of Pulse is strictly forbidden.

**Series: LPT Antenna****TECHNICAL DATA SHEET****Description:** Direct Mount LPT Style  
Antenna 698-2700 MHz, U.FL/SMA(M)**PART NUMBER: W1978/W1979****TEST SETUP**

All electrical performance measured with antenna centered on  
12"x12" ground plane

## CHARTS

### VSWR

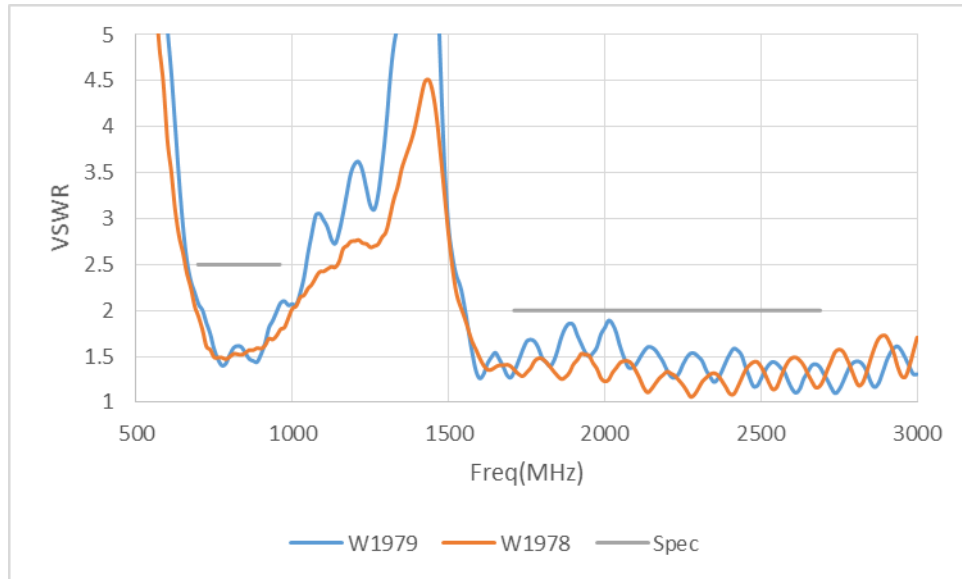

### Radiation Efficiency

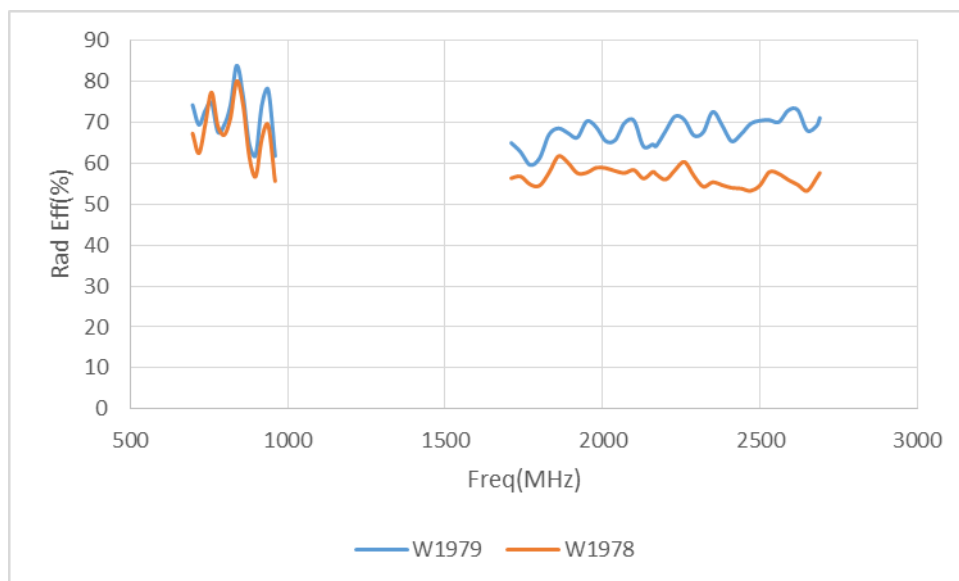

## CHARTS

### Peak Gain

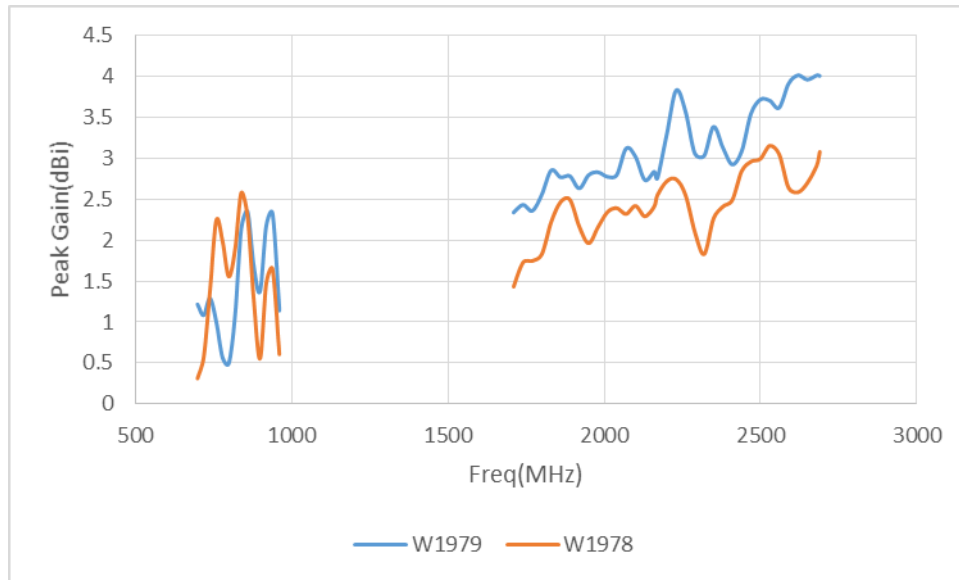

### Horizontal Plane radiation pattern at low band

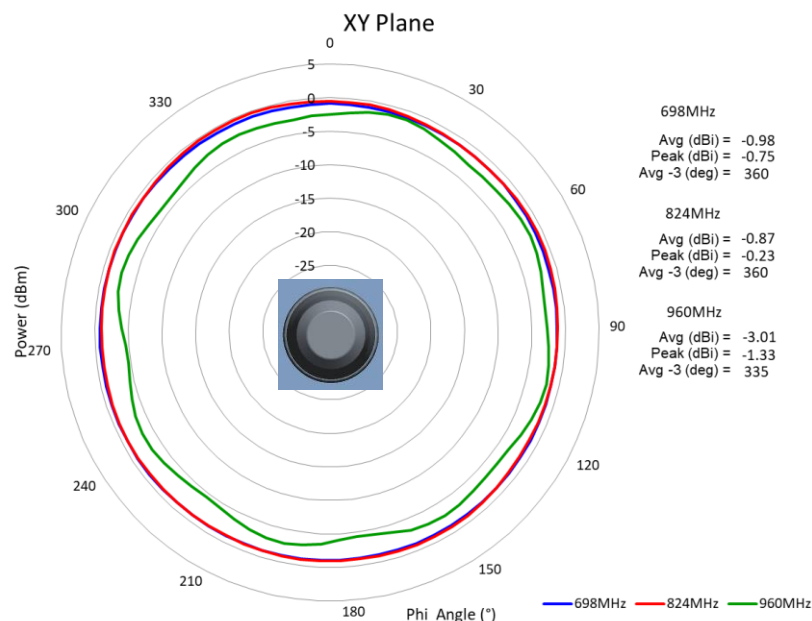

Issue: 2150

In the effort to improve our products, we reserve the right to make changes judged to be necessary.

CONFIDENTIAL AND PROPRIETARY INFORMATION

This document contains confidential and proprietary information of Pulse Electronics, Inc. (Pulse) and is protected by copyright, trade secret and other state and federal laws. Its receipt or possession does not convey any rights to reproduce, disclose its contents, or to manufacture, use or sell anything it may describe. Reproduction, disclosure or use without specific written authorization of Pulse is strictly forbidden.

## CHARTS

### Horizontal Plane radiation pattern at high band

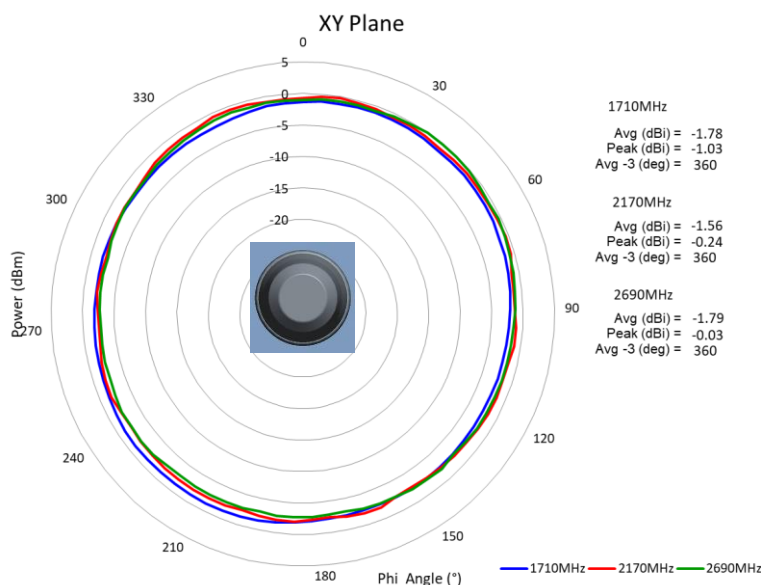

### Vertical Plane radiation pattern at low band

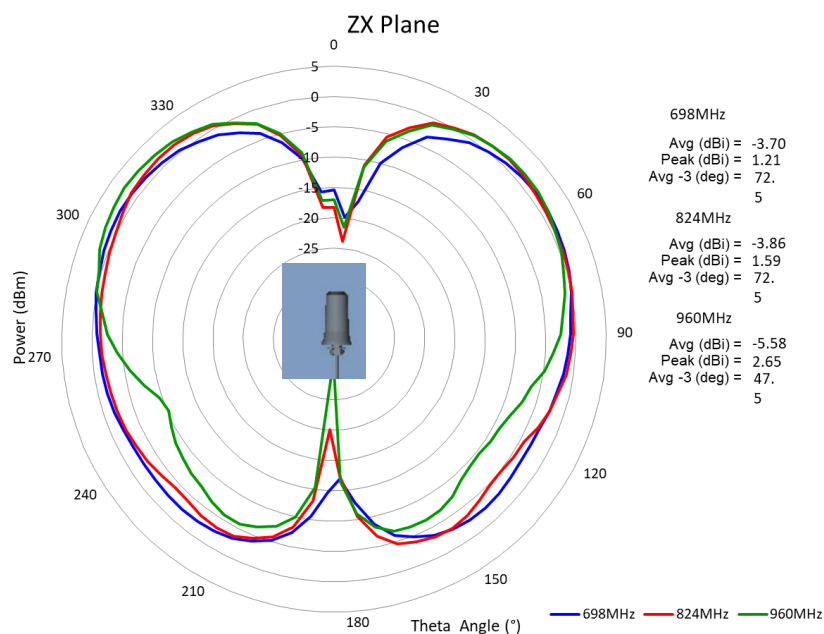

Issue: 2150

In the effort to improve our products, we reserve the right to make changes judged to be necessary.

CONFIDENTIAL AND PROPRIETARY INFORMATION

This document contains confidential and proprietary information of Pulse Electronics, Inc. (Pulse) and is protected by copyright, trade secret and other state and federal laws. Its receipt or possession does not convey any rights to reproduce, disclose its contents, or to manufacture, use or sell anything it may describe. Reproduction, disclosure or use without specific written authorization of Pulse is strictly forbidden.

## CHARTS

### Vertical Plane radiation pattern at high band

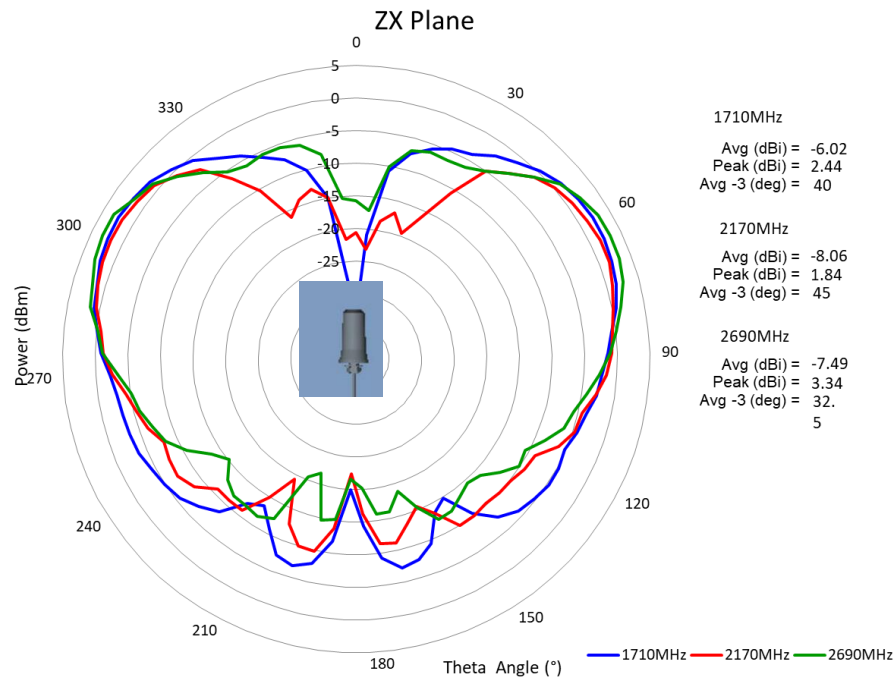

**Series: LPT Antenna****TECHNICAL DATA SHEET****Description:** Direct Mount LPT Style  
Antenna 698-2700 MHz, U.FL/SMA(M)**PART NUMBER: W1978/W1979****PACKAGING**

4pcs antenna per separated region, 6 separated regions per layer.  
Total 2 layers contain 48pcs antenna per box