

THIS DOCUMENT IS THE PROPERTY OF
KEYSTONE ELECTRONICS CORP. AND
SHALL NOT BE REPRODUCED, DISTRIBUTED
OR USED AS A BASIS FOR MANUFACTURE
WITHOUT PRIOR WRITTEN PERMISSION
FROM KEYSTONE ELECTRONICS CORP.

ACTUAL SIZE

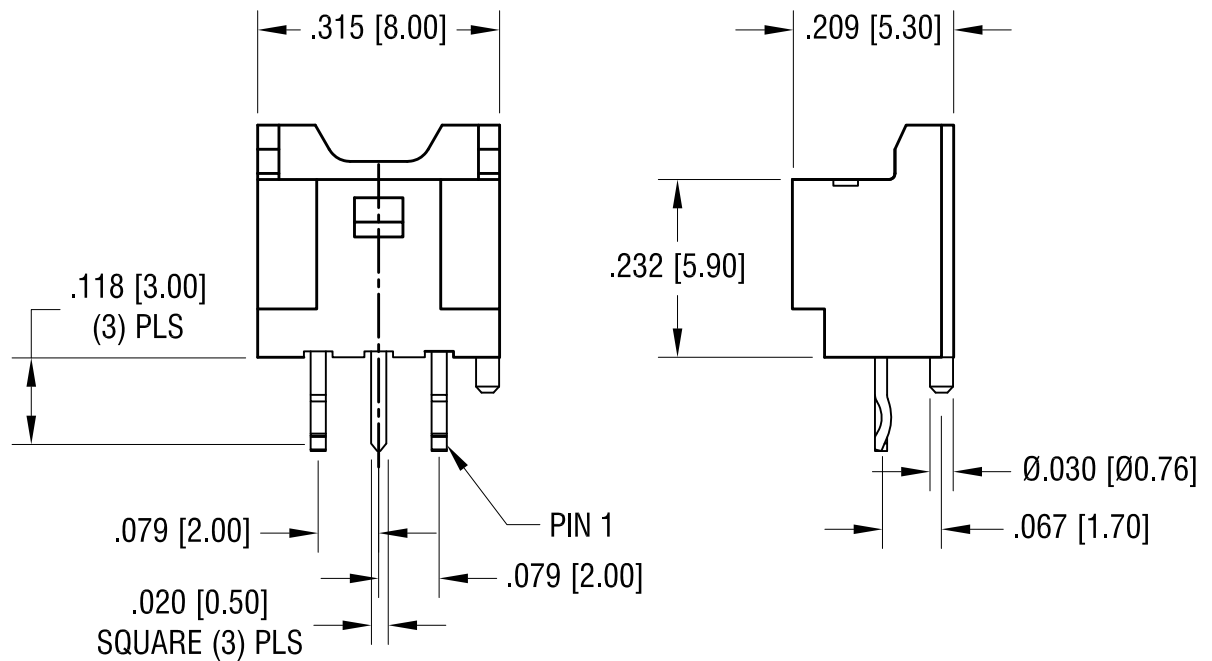
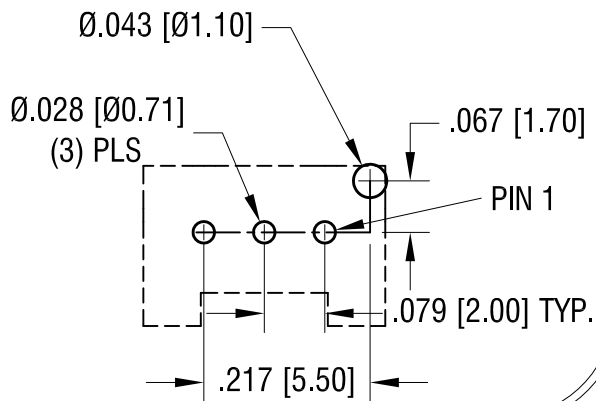
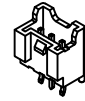

NOTE:

1. HOUSING: MAT'L- PA66, UL94V-0
2. POST: MAT'L- BRASS
TIN PLATED

12.17.24	UPDATED FEATURES&TOLERANCES.	B
6.10.21	REVISED LEG TOLERANCE CHANGE AS PER ECN 21-051	A
DATE	DESCRIPTION	REV.

KEYSTONE ELECTRONICS CORP.			
www.keyelco.com • NEW HYDE PARK, NY 11040 • Tel (516) 328-7500			
PART NAME THM TOP ENTRY CONNECTOR (3 CIRCUITS)			
MATERIAL AS NOTED			
FINISH AS NOTED		DRN BY NT	DATE 3.07.16
		APP'D RH	SCALE 4X
TOLERANCES	INCH [MM]	CODE	DWG NO.
DECIMAL	$\pm .015$ [± 0.38]	C	975
ANGULAR	$\pm 1^\circ$		
UNLESS OTHERWISE SPECIFIED			