

NOTES:

TAPE AND REEL SPECIFICATIONS:

1. TAPE:

MAT'L - ALL CONDUCTIVE POLYSTYRENE CARRIER
ANSI/EIA-481 STANDARD
1.260 [32.0] WIDE; .630 [16.0] PITCH

2. REEL:

13.0 [330.2] DIA. 600 PIECES OF
PART NO. 2996 PER REEL.

KEYSTONE ELECTRONICS CORP.

www.keyelco.com • ASTORIA, N.Y. 11105-2017 • Tel (718) 956-8900

PART NAME

11.6mm SM BUTTON CELL RETAINER ON TAPE

MATERIAL

AS NOTED

FINISH

AS NOTED

DRN BY

BOONE

DATE

6.20.07

APP'D

LN

SCALE

X

TOLERANCES

INCH [MM]

DECIMAL ±.015 [±0.38]

ANGULAR ± 1°

UNLESS OTHERWISE SPECIFIED

CODE

C

DWG NO.

2996TR

DATE

DESCRIPTION

REV.

MOUNTING DETAIL

NEG. CONTACT (PAD)
.156 [3.96] SQ. MIN.

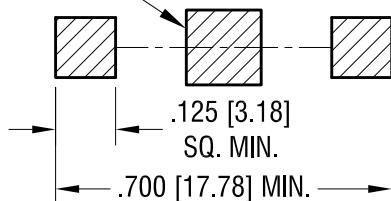

THIS DOCUMENT IS THE PROPERTY OF
KEYSTONE ELECTRONICS CORP. AND
SHALL NOT BE REPRODUCED, DISTRIBUTED
OR USED AS A BASIS FOR MANUFACTURE
WITHOUT PRIOR WRITTEN PERMISSION
FROM KEYSTONE ELECTRONICS CORP.

ACTUAL SIZE

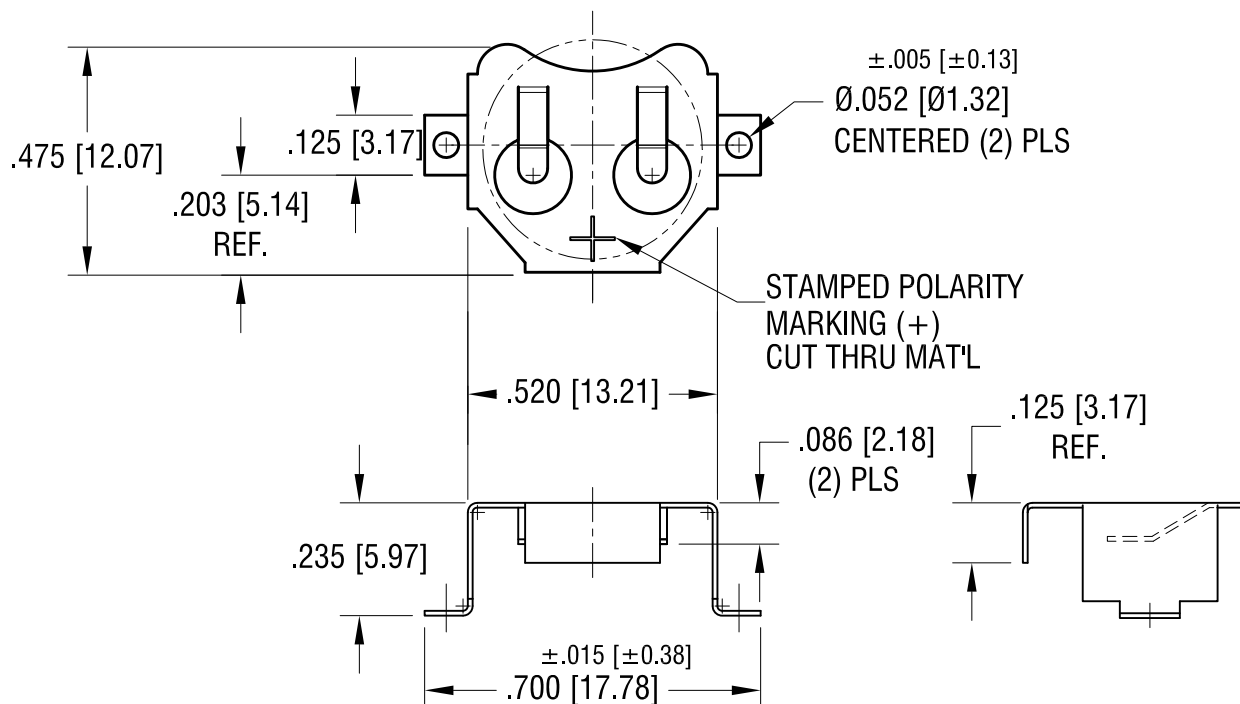

2.29.24 NO CHANGES TO PART

G

12.27.16 CHANGE AS PER ECN 16-121

F

3.10.08 CHANGE AS PER ECN 08-093

E

9.17.07 CHANGE AS PER ECN 07-057

D

5.29.07 CHANGE AS PER ECN 07-027

C

9.22.06 CHANGE AS PER ECN 06-063

B

| KEYSTONE ELECTRONICS CORP. | | | |
|--|-----------------------|--------|---------|
| www.keyelco.com • NEW HYDE PARK, NY 11040 • Tel (516) 328-7500 | | | |
| PART NAME | | | |
| 11.6mm SM BUTTON CELL RETAINER | | | |
| MATERIAL | | | |
| .010 [0.25] TH'K PHOSPHOR BRONZE | | | |
| FINISH | | DRN BY | DATE |
| TIN NICKEL PLATE | | BOONE | 5.10.05 |
| | | APP'D | SCALE |
| | | LN | 2.5X |
| TOLERANCES | INCH | CODE | DWG NO. |
| DECIMAL | $\pm .010 [\pm 0.25]$ | C | |
| ANGULAR | $\pm 1^\circ$ | | |
| UNLESS OTHERWISE SPECIFIED | | | |

DATE

DESCRIPTION

REV.

2996