

CAB469RF: MMCX R/A PLUG + SMA STRAIGHT BULKHEAD JACK WITH O-RING RATED TO IP67/68 + MULTIPLE CABLE SIZES, 6GHz

SPECIFICATIONS :

1. MMCX RIGHT ANGLE PLUG, P/N:  
FOR Ø1.37MM, RG178 CABLE: RFCT-MMCX003-M78.  
FOR Ø1.13MM LOW LOSS CABLE: RFCT-MMCX002-M13.
2. COAXIAL CABLE, SEE P/N OPTIONS.
3. SMA STRAIGHT BULKHEAD JACK WITH O-RING RATED TO IP67/68,  
P/N: RFCT-SMA069-F78.

## ENVIRONMENTAL:

- A. BULKHEAD MOUNTED CONNECTOR (RFCT-SMA069-F78) RATED TO THE FOLLOWING SPECIFICATION:
- i. IP6X – DUST TIGHT – NO PARTICLE INGRESS.
  - ii. IPX7 WATERPROOF FOR 30 MINUTES UP TO 1 METER UNDERWATER.
  - iii. IPX8 WATERPROOF FOR 48 HOURS AT 1 METER UNDERWATER.

NOTES:

1. THE ORIENTATION OF CONNECTORS ON DRAWING IS FOR REFERENCE ONLY, IF THE ORDER IS LEFT BLANK THE CONNECTOR WILL NOT HAVE FIXED ORIENTATION.
2. FIXED ORIENTATION IS SUGGESTED FOR CABLE LENGTH 50MM TO 100MM. PLEASE SPECIFY THE FIXED ORIENTATIONS FROM THE ORDER CODE (F1, F2, ETC)
3. CONTACT GCT IF THE ORIENTATION YOU REQUIRE IS NOT SHOWN.
4. WORKING FREQUENCY RANGE: DC-6GHz.
5. OPERATING TEMPERATURE: -40°C TO +125°C.
6. IMPEDANCE: 50 Ohm.

USAGE PRECAUTIONS: CABLES USING 'MICRO' COAX ARE DELICATE:

- (i) HANDLE WITH CARE.
- (ii) DO NOT TWIST; APPLY EXCESSIVE FORCES OR SHARP BENDS TO THE CABLE. DO NOT FORCEFULLY DEFORM WIRES.
- (iii) CONSULT CONNECTOR MANUFACTURER'S DATASHEETS FOR DETAILED NOTES ON HANDLING INSTRUCTIONS.

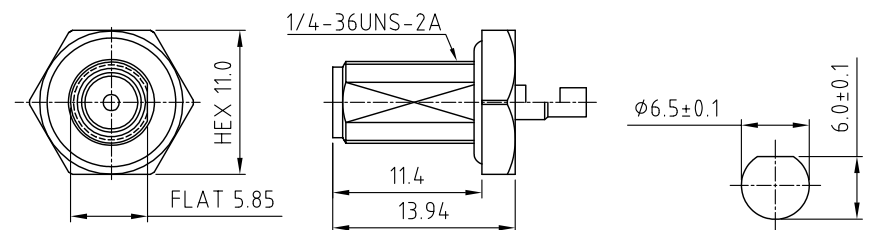
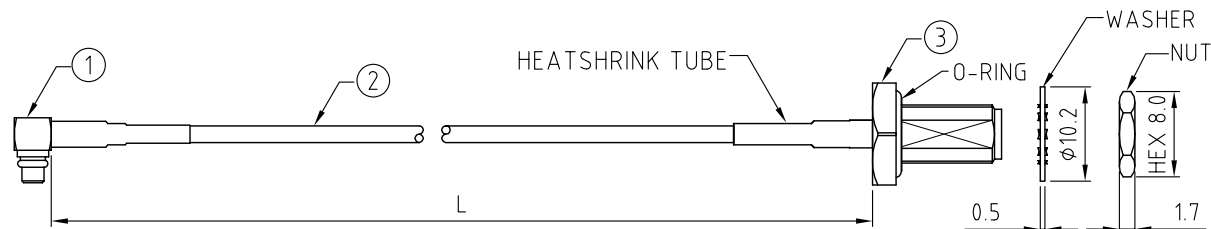

## HOW TO ORDER

CAB469RF - X X X X - X X - X - X

"L" LENGTH IN MM:  
eg: 100MM = 0100  
(MIN. 0050-MAX.0400  
STANDARD = 0100, 0150, 0200)  
TOLERANCE: 50-200mm:  $\pm 5$ mm.  
201-400mm:  $\pm 7$ mm.

CABLE SIZE OPTIONS:

- 1 = RG178 CABLE, COLOR: BROWN  
2 = Ø1.37MM CABLE, COLOR: BLACK  
3 = Ø1.13MM LOW LOSS CABLE, COLOR: GRAY

WASHER AND NUT OPTIONS:  
BLANK = SEPARATELY PACKED (STANDARD)  
A = ASSEMBLED WITH CONNECTOR

ORIENTATION OPTIONS:

BLANK = DOES NOT HAVE A FIXED ORIENTATION  
F1 = MMCX CONNECTION DOWN (L=50-200MM)  
F2 = MMCX CONNECTION UP (L=50-200MM)  
F3 = MMCX CONNECTION & SMA FLAT SAME ORIENTATION (L=50-200MM)  
F4 = MMCX CONNECTION & SMA FLAT OPPOSITE ORIENTATION (L=50-200MM)  
(SEE NOTES 1, 2, 3 AND DIAGRAMS FOR MORE INFORMATION)

RECOMMENDED SMA  
MOUNTING HOLE

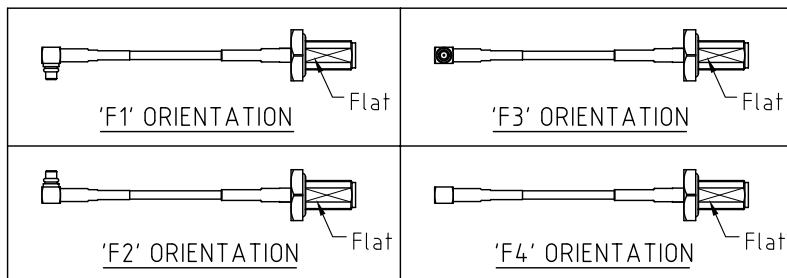
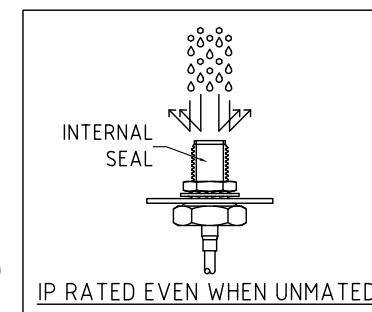

Scale: NTS	THIRD ANGLE		Unstated X XX XXX ANGLES	Tolerances: N/A N/A N/A N/A	IP Rated RF Products	 	Drawing Number:  CAB469RF	
Drawn: CC							www.gct.co	www.gradconn.com
App'd: XXX	Title CABLE ASSEMBLY							
Date: 16 Feb. '25	Revision: 1.6	Unit: mm	© THIS DRAWING IS CONFIDENTIAL AND MUST NOT BE COPIED OR DISCLOSED WITHOUT WRITTEN CONSENT				Drawing ©	E and O E