

NYLON 6/6 (RMS-01), COLOR: NATURAL. PART NO.	FLAME RETARDANT, NYLON (RMS-19). COLOR: NATURAL. PART NO.
WS-SE-A-3-01	WS-SE-A-3-19

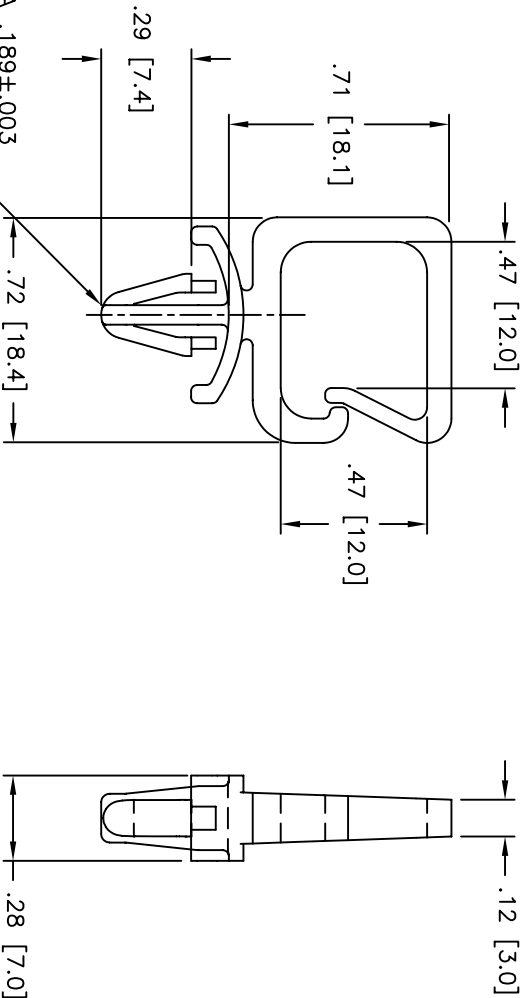
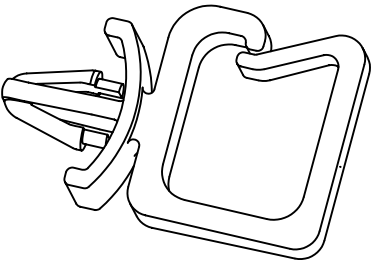

TO SNAP-LOCK IN A .189±.003
 (4.8±0.08) HOLE DIA. IN A
 .024-.071 (0.6-1.8) PANEL THICKNESS

TITLE: WIRE SADDLE, SIDE ENTRY WITH ARROWHEAD									
TOLERANCES UNLESS NOTED				FILE # WS-SE-A-3		DWN: SM		APP:	
.XX=±.010				MAT'L: SEE TABLE		DT: 03/20/02		DT:	
.XXX=±.005				RE: RICHCO, INC.		RICHCO INC.		PART #	
FRAC=±1/64						PO BOX 804238,CHICAGO,60680		SEE TABLE	
ANG=±1°						(773) 539-4060		PRINT	
								TYPE	
REV				DESCRIPTION		ENGR		DATE	
								CA	

Mouser Electronics

Authorized Distributor

Click to View Pricing, Inventory, Delivery & Lifecycle Information:

Essentra:

[WS-SE-A-3-01](#) [WS-SE-A-3-19](#)