

AVAILABLE BY SPECIAL ORDER - NAFTA REGION ONLY

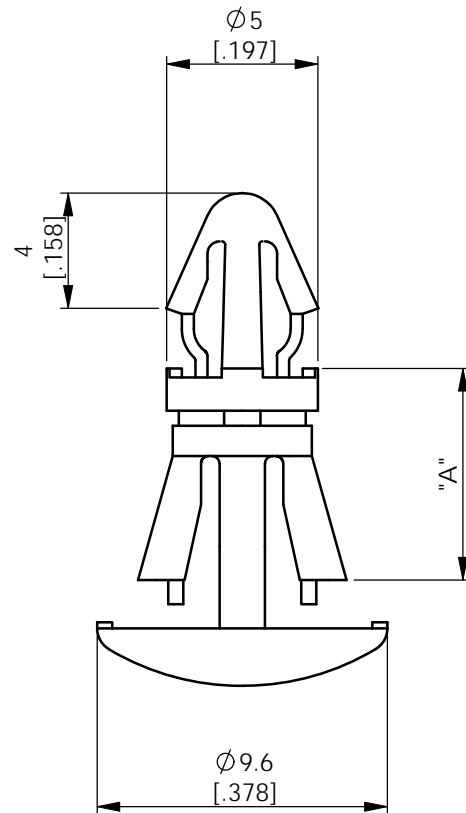

TO SNAP LOCK INTO A  $\varnothing 4 \pm 0.08$  [.158  $\pm$ .003] HOLE,  
INTO A 1.6 [.063] NOM THICK PANEL.

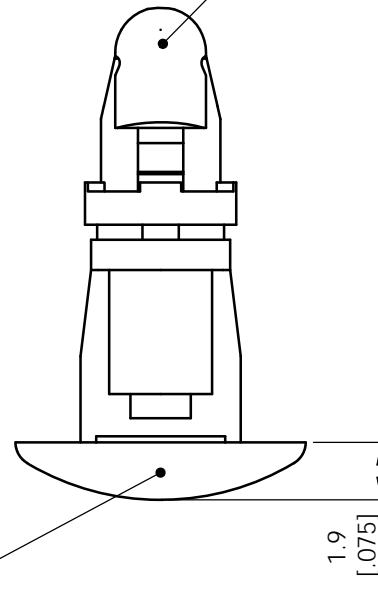

TO SNAP LOCK INTO A  $\varnothing 5.4 \pm 0.08$  [.213  $\pm$ .003] HOLE,  
INTO A 1.6 [.063] NOM THICK PANEL.



RLCBSK-14-YY	14.0 [.551]
RLCBSK-12-YY	12.0 [.472]
RLCBSK-10-YY	10.0 [.394]
RLCBSK-8-YY	8.0 [.315]
RLCBSK-7-YY	7.0 [.276]
RLCBSK-6-YY	6.0 [.236]
PART NUMBER	"A" DIMENSION

RLCBSK-X-19	NYLON 6/6 UL94-V0 (RMS-19)
RLCBSK-X-01	NYLON 6/6 UL94-V2 (RMS-01)
PART NUMBER	MATERIAL

NOTES:  
1a) METRIC PRIMARY UNITS:mm  
1b) IMPERIAL SECONDARY UNITS: [inches]  
2) PARTS AVAILABLE IN BLACK BY SPECIAL  
ORDER ADD BK TO END OF PART NUMBER.  
E.G. RLCBSK-6-01BK

INFORMATION CONTAINED IN THIS DOCUMENT IS CONFIDENTIAL TO  
RICHCO INTERNATIONAL Co. Ltd. AND MAY NOT BE DISCLOSED OR  
REPRODUCED IN WHOLE OR PART WITHOUT THEIR WRITTEN CONSENT.



GENERAL TOLERANCES  $\pm 0.25$  [.010]  
UNLESS OTHERWISE STATED  
ANGULAR  $\pm 1^\circ$



MATERIAL:		SEE TABLE		COLOUR:		NATURAL	
DESCRIPTION:		REVERSE LOCKING CIRCUIT BOARD SUPPORT		PART No:		See Table	
DRG No:		08-110		NPR No:		NA	
SHEET SIZE		A4		DATE		12/11/08	
DRN	OW	DATE	12/11/08	CHKD	TC	SCALE	NTS
SHEET No.		1 OF 1		FORM No. 0143/00			

# Mouser Electronics

Authorized Distributor

Click to View Pricing, Inventory, Delivery & Lifecycle Information:

Essentra:

[RLCBSK-10-01](#) [RLCBSK-12-01](#) [RLCBSK-14-01](#) [RLCBSK-16-01](#) [RLCBSK-6-01](#) [RLCBSK-7-01](#) [RLCBSK-8-01](#)