

PART NO.	"B"	THREAD	"C"	HEAD STYLE
NSS-4-#-01	.07 (1.8)	#4-40	.21 (5.3)	SLOTTED PAN
NSS-6-#-01	.08 (2.0)	#6-32	.27 (6.9)	
NSS-8-#-01	.08 (2.0)	#8-32	.32 (8.1)	
NSP-4-#-01	.08 (2.0)	#4-40	.21 (5.3)	PHILLIPS PAN
NSP-6-#-01	.09 (2.3)	#6-32	.26 (6.6)	
NSP-8-#-01	.11 (2.8)	#8-32	.32 (8.1)	

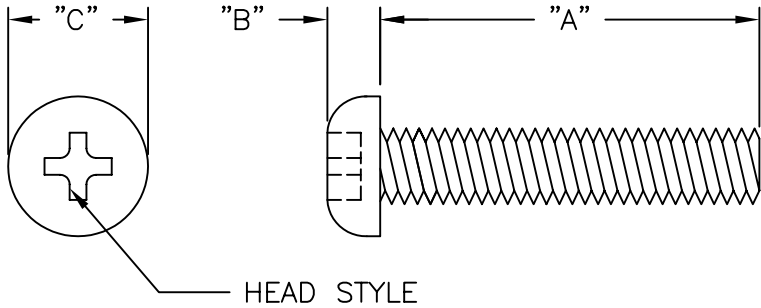

-#-	"A" $\begin{smallmatrix} +.000 \\ -.030 \\ (+0.00) \\ (-0.76) \end{smallmatrix}$
-2-	1/8 (3.2)
-3-	3/16 (4.8)
-4-	1/4 (6.4)
-5-	5/16 (7.9)
-6-	3/8 (9.5)
-7-	7/16 (11.1)
-8-	1/2 (12.7)
-10-	5/8 (15.9)
-12-	3/4 (19.1)
-14-	7/8 (22.2)
-16-	1.00 (25.4)

NOTES:
 1. MATERIAL: NYLON 6/6 (RMS-01).
 2. COLOR: NATURAL.

B	SEE ECN #1025 FOR CHANGES	SK 07.15.05
A	CHANGED FILE NO.	SM 08.16.02
REV	DESCRIPTION	ENGR DATE

TITLE: NYLON SCREWS					DWG IN IN(MM)	
TOLERANCES UNLESS NOTED .XX=±.010 .XXX=±.005 FRAC=±1/64 ANG=±1°	FILE # NSS-NSP	DWN: J.B.	APP:	FINAL		
	MAT'L: SEE NOTES	DT: 01-16-97	DT:	PART #		
	RE: RICHCO, INC.	RICHCO INC. PO BOX 804238, CHICAGO, 60680 (773) 539-4060		SEE TABLE		PRINT TYPE CA

Mouser Electronics

Authorized Distributor

Click to View Pricing, Inventory, Delivery & Lifecycle Information:

Essentra:

[NSP-6-5-01](#) [NSP-4-5-01](#) [NSP-6-8-01](#) [NSP-4-6-01](#) [NSP-6-3-01](#) [NSP-4-16-01](#) [NSP-6-6-01](#) [NSP-4-8-01](#)