

# UNCONTROLLED DOCUMENT

NOTE:  
PACKAGED IN BAGS OF 100 PIECES EACH  
MAX BUNDLE DIAMETER .866 [22.0MM]  
ADHESIVE TAPE ON BASE

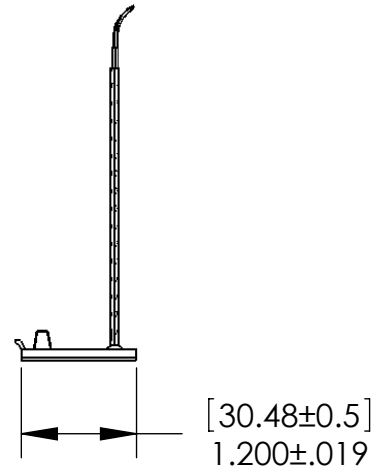
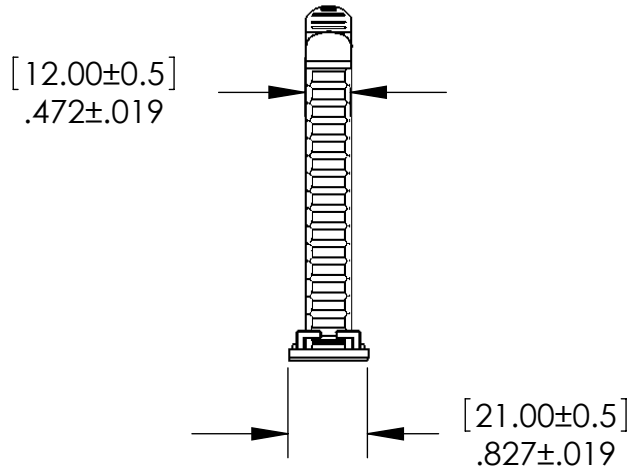

## TOLERANCES UNLESS NOTED

$\pm .005$  ON DIMENSIONS THRU  $.625$   
 $\pm .008$  ON DIMENSIONS  $.626$  THRU  $1.000$   
 $\pm .010$  ON DIMENSIONS  $1.001$  THRU  $1.500$   
 $\pm .015$  ON DIMENSIONS LARGER THAN  $1.500$   
 $\pm .015$  ON FRACTIONAL DIMENSIONS

WE RESERVE THE RIGHT  
TO DISCONTINUE ITEMS,  
CHANGE SPECIFICATIONS  
OR DESIGN AT ANY TIME  
WITHOUT NOTICE AND  
WITHOUT INCURRING  
ANY OBLIGATIONS

PROPERTY OF		
MICRO PLASTICS INC.		
CATALOG DRAWING LADDER STYLE ADJUSTABLE CABLE CLAMP MICRO P/N NM22LCC0812 DWG. # NM22LCC0812 FILE SERVER\ENG\WEB		
MATERIAL:		6/6 NYLON
DATE	SCALE 1:2	DSB

# Mouser Electronics

Authorized Distributor

Click to View Pricing, Inventory, Delivery & Lifecycle Information:

[Essentra:](#)

[NM22LCC0812](#)