

RoHS compliant



Weight : approx. 60 g

## ■ PART NUMBER DESIGNATION

LC20G - 101 1/10

Series name

Gear ratio

1/10	1/300
1/25	1/500
1/50	1/1000
1/100	1/1500
1/150	

## ■ LIST OF PART NUMBERS

Gear ratio	Part number
1/10	LC20G-101 1/10
1/25	LC20G-101 1/25
1/50	LC20G-101 1/50
1/100	LC20G-101 1/100
1/150	LC20G-101 1/150
1/300	LC20G-101 1/300
1/500	LC20G-101 1/500
1/1000	LC20G-101 1/1000
1/1500	LC20G-101 1/1500

※ Verify the above part numbers when placing orders.

# LC20G

## DC GEARED MOTORS

### STANDARD SPECIFICATIONS

<Motor only>

Part number	Rated voltage	Rated torque	Rated speed	Rated current	No load speed	No load current	Starting torque	Starting current
LC20G-101	12 V	0.98 mN·m	6000 min <sup>-1</sup>	110 mA	7100 min <sup>-1</sup>	40 mA	6.33 mN·m	450 mA

<With gearbox>

LC20G-101

Gear ratio	1/10	1/25	1/50	1/100	1/150	1/300	1/500	1/1000	1/1500
Rated torque mN·m	4.9	7.8	9.8	14.7	24.5				
Rated speed min <sup>-1</sup>	657	260	132	66	44	22	13.9	6.8	4.5
Rated current A	0.08	0.06				0.04		0.05	
No load speed min <sup>-1</sup>	680	272	136	68	45	23	14	6.8	4.5

### PERFORMANCE CURVES

(Figures in the table are typical values under rated operating condition.)

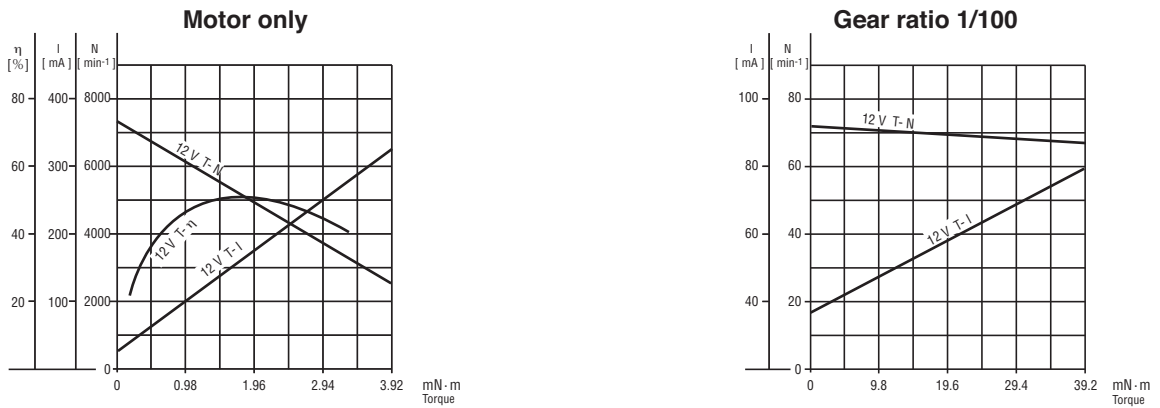

### OUTLINE DIMENSIONS

(Unit: mm)

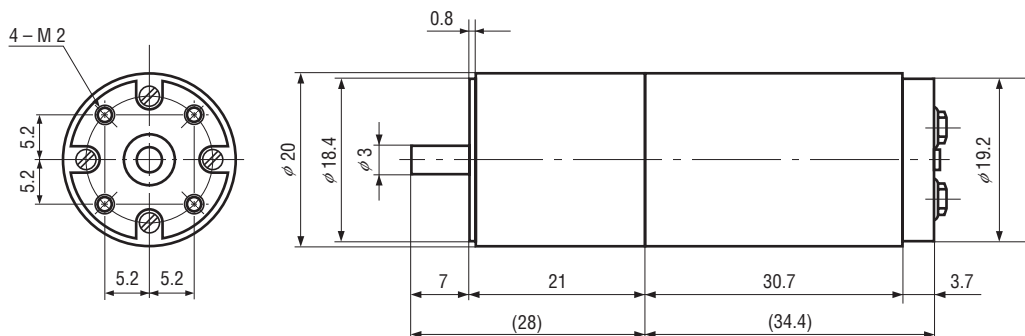

# Mouser Electronics

Authorized Distributor

Click to View Pricing, Inventory, Delivery & Lifecycle Information:

[Nidec:](#)

[LC20G-101 1/10](#) [LC20G-101 1/100](#) [LC20G-101 1/1000](#) [LC20G-101 1/150](#) [LC20G-101 1/1500](#) [LC20G-101 1/25](#)  
[LC20G-101 1/300](#) [LC20G-101 1/50](#) [LC20G-101 1/500](#)