

# CF-CA

## Right Angle Tactile Switches

Washable

RoHS Compliant

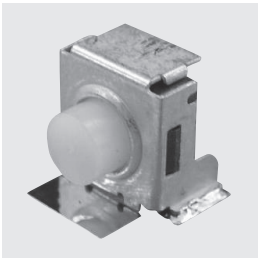

### Features

1. Right Angle Tactile Switch
2. Rich in Variation (Actuator Length, With/Without Support Terminal)
3. Silver-Plated / Gold-Plated Contacts
4. Resin Actuator
5. Washable

### Specifications

Rating	Max.		1 VA max. (32 VDC max. 50 mA max.)
	Min.	Silver Gold	5VDC 1 mA 5VDC 10 $\mu$ A
Initial contact resistance	100 m $\Omega$ max.		
Dielectric strength	250 VAC (50~60Hz) 1 minute		
Initial Insulation resistance	100 M $\Omega$ min. (100 VDC)		
Stroke	0.25 mm		
Operating force	3 $\pm$ 1.5 N {305 $\pm$ 153 g}		
Electrical life	max. Rating 100,000 cycles.		
Operating temperature range	-40~+90°C		
Storage temperature range	-40~+90°C		

### Part Numbering

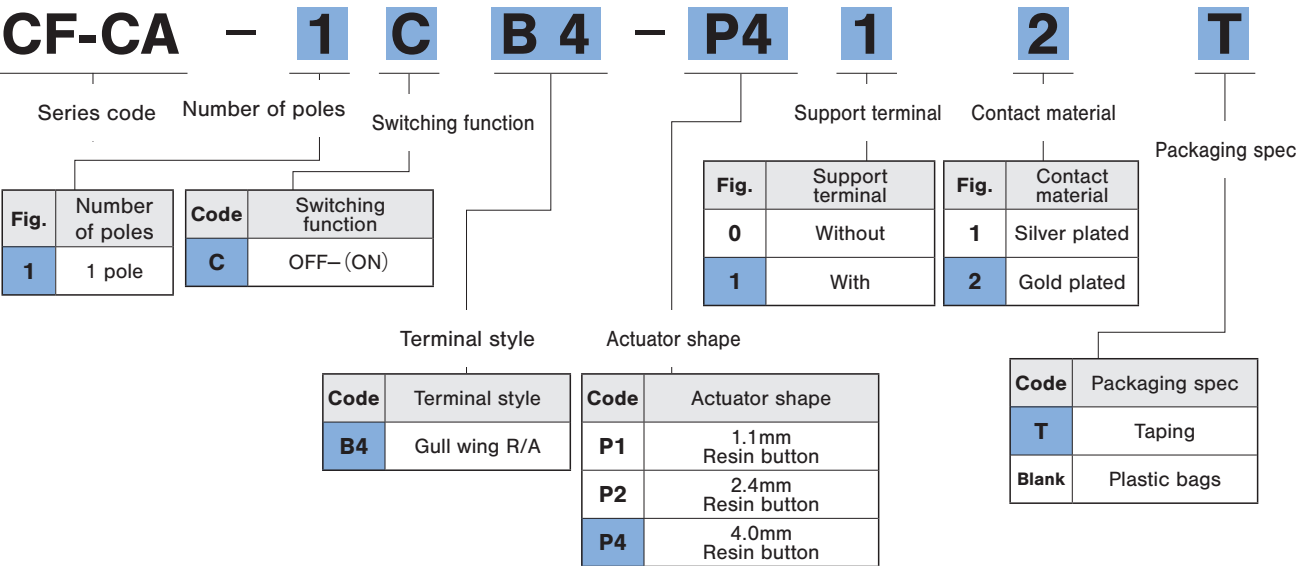

### PC Hole Layouts

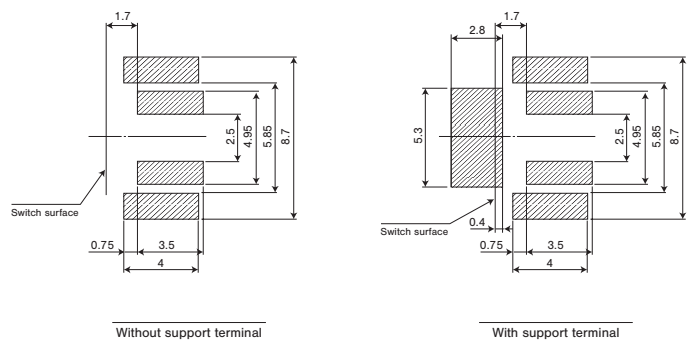

## Outline dimensions

### 1.1mm (Without Support Terminal)

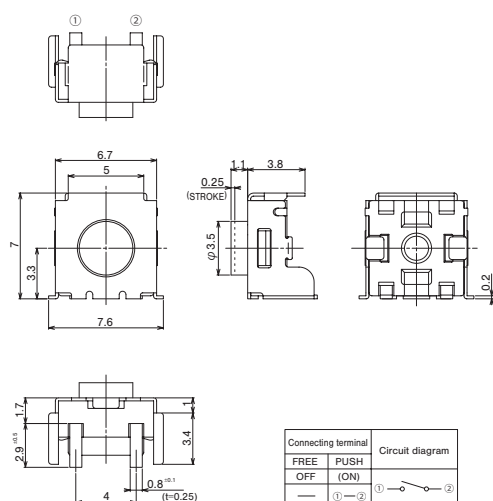

### 1.1mm (With Support Terminal)

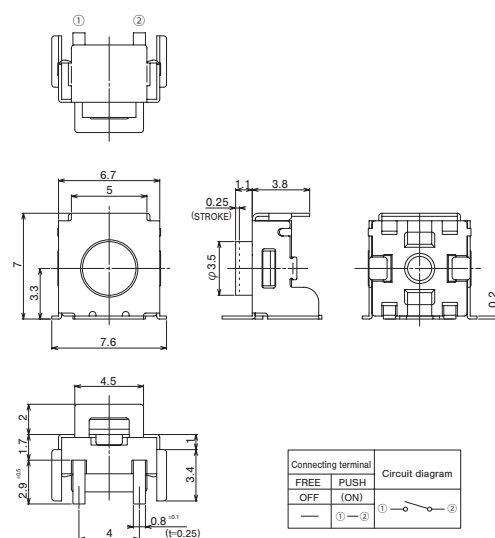

### 2.4 mm (Without Support Terminal)

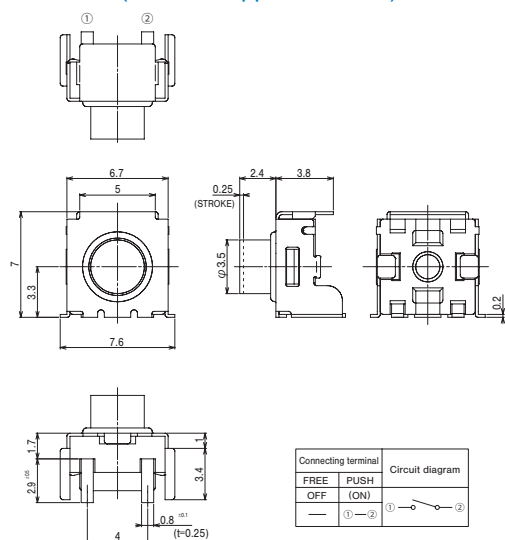

### 2.4 mm (With Support Terminal)

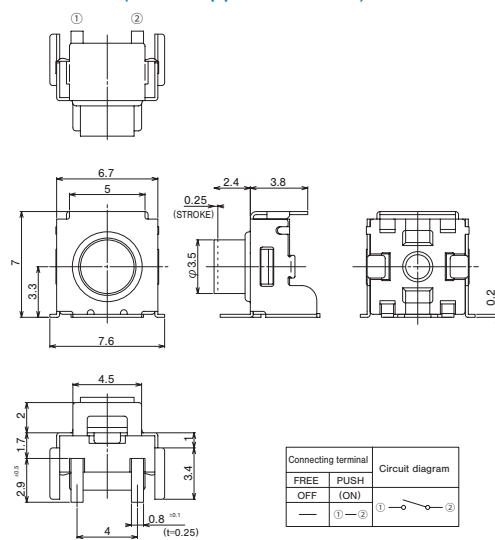

### 4.0mm (Without Support Terminal)

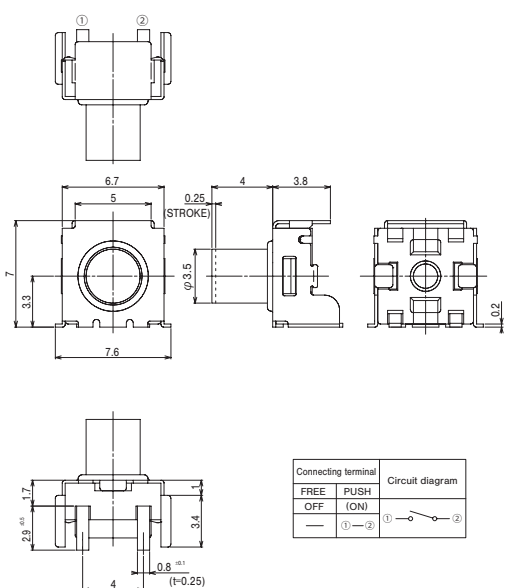

### 4.0mm (With Support Terminal)

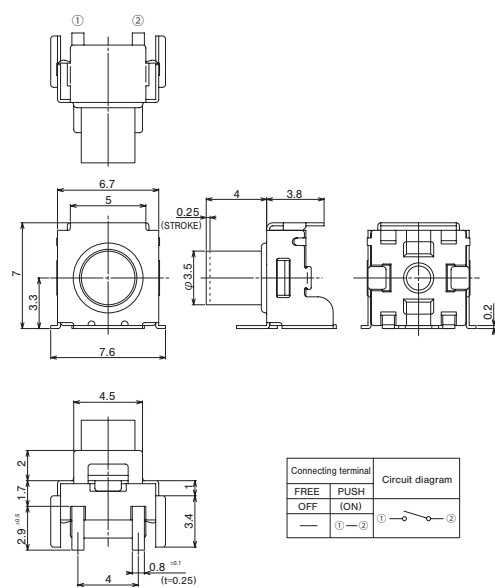

## List of part numbers

Number of poles	Switching function	Contact material	Form of Packaging	Actuator shape		Terminal style		Pieces in package
				Material	Hight	Without support terminal	With support terminal	
1 pole	OFF—(ON)	Silver plated	Taping	Resin	1.1mm	CF-CA-1CB4-P101T	CF-CA-1CB4-P111T	500pcs./reel
					2.4mm	CF-CA-1CB4-P201T	CF-CA-1CB4-P211T	500pcs./reel
					4.0mm	CF-CA-1CB4-P401T	CF-CA-1CB4-P411T	500pcs./reel
			Plastic bags		1.1mm	CF-CA-1CB4-P101	CF-CA-1CB4-P111	20pcs./pack
					2.4mm	CF-CA-1CB4-P201	CF-CA-1CB4-P211	20pcs./pack
					4.0mm	CF-CA-1CB4-P401	CF-CA-1CB4-P411	20pcs./pack
		Gold plated	Taping		1.1mm	CF-CA-1CB4-P102T	CF-CA-1CB4-P112T	500pcs./reel
					2.4mm	CF-CA-1CB4-P202T	CF-CA-1CB4-P212T	500pcs./reel
					4.0mm	CF-CA-1CB4-P402T	CF-CA-1CB4-P412T	500pcs./reel
			Plastic bags		1.1mm	CF-CA-1CB4-P102	CF-CA-1CB4-P112	20pcs./pack
					2.4mm	CF-CA-1CB4-P202	CF-CA-1CB4-P212	20pcs./pack
					4.0mm	CF-CA-1CB4-P402	CF-CA-1CB4-P412	20pcs./pack

## Soldering Specifications

### (1) Reflow Soldering

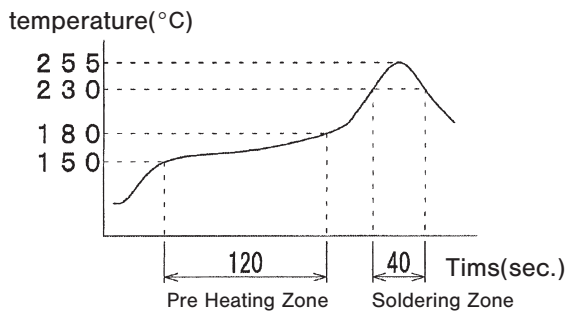

### (2) Manual Soldering

Device : Soldering iron  
350°C ±10°C, Max.; 3 seconds, Max.

Apply reflow soldering up to 2 times max.

## Flux Cleaning

- (1) For the solvent, use water or alcohol. In addition, pay careful attention to use the solvent.
- (2) The cleaning method is limited to immersion cleaning only. The cleaning time is 2 minutes, max, but be sure to minimize the time as much as possible.
- (3) To clean the switch after soldering, wait until the switch temperature has cooled down to room temperature (30°C or below).
- (4) The product must be dried sufficiently after cleaning. Improper drying may result in fluctuation in torque or electrical damage.

## ■ Packaging Specification

### (1) Taping

Packaging quantity is 500 pcs. per reel. Each reel is packed in a box.

The maximum number of consecutive missing pieces shall be two. The following illustration shows the leader length, empty portion and the product indication method.

Fig.1 Embossed tape dimensions

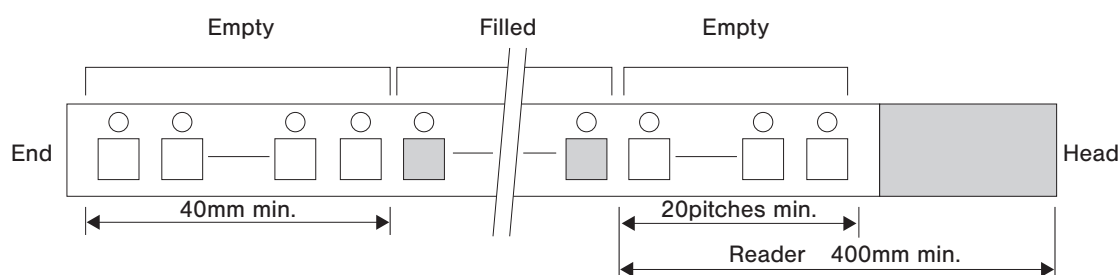

### 〈Tape dimensions〉

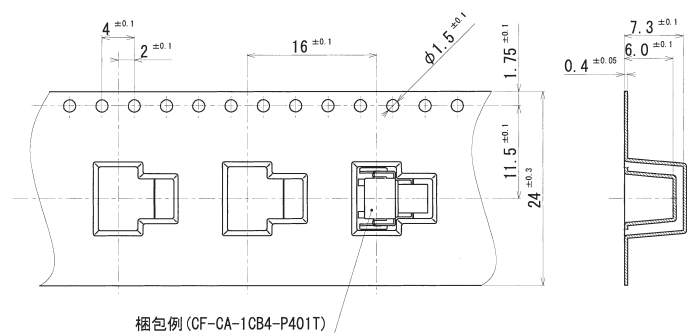

### 〈Reel dimensions〉

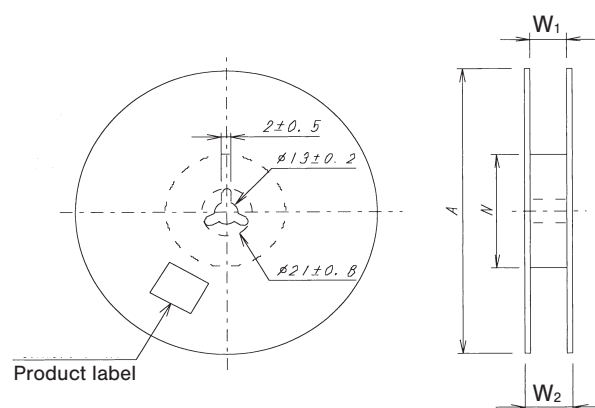

### (2) Bulk

Packaging quantity is 20pcs per bag. Please order in increments of 20pcs.

Unit (mm)

A	W <sub>1</sub>	W <sub>2</sub>	N
$\phi 330 \pm 2$	25.4 $\pm 1$	29.4 $\pm 1$	$\phi 80 \pm 1$

# Mouser Electronics

Authorized Distributor

Click to View Pricing, Inventory, Delivery & Lifecycle Information:

[Nidec:](#)

[CF-CA-1CB4-P102T](#) [CF-CA-1CB4-P111T](#) [CF-CA-1CB4-P112T](#) [CF-CA-1CB4-P202T](#) [CF-CA-1CB4-P211T](#) [CF-CA-1CB4-P212T](#) [CF-CA-1CB4-P411T](#) [CF-CA-1CB4-P412T](#) [CF-CA-1CB4-P101](#) [CF-CA-1CB4-P101T](#) [CF-CA-1CB4-P102](#) [CF-CA-1CB4-P111](#) [CF-CA-1CB4-P112](#) [CF-CA-1CB4-P201](#) [CF-CA-1CB4-P402](#) [CF-CA-1CB4-P402T](#) [CF-CA-1CB4-P411](#) [CF-CA-1CB4-P412](#) [CF-CA-1CB4-P201T](#) [CF-CA-1CB4-P202](#) [CF-CA-1CB4-P211](#) [CF-CA-1CB4-P212](#) [CF-CA-1CB4-P401](#) [CF-CA-1CB4-P401T](#)