

THIS INFORMATION IS CONFIDENTIAL AND PROPRIETARY TO CW INDUSTRIES INCORPORATED AND ITS AFFILIATES. IT MAY NOT BE DISCLOSED TO ANYONE, OTHER THAN CW INDUSTRIES PERSONNEL, WITHOUT WRITTEN AUTHORIZATION FROM CW INDUSTRIES INCORPORATED, SOUTHAMPTON, PENNSYLVANIA USA.

DIMENSIONS IN INCHES (MILLIMETERS)
DO NOT SCALE DRAWING

REVISES	Dwg. No.	G-2011-0042
	1	Updated & redrawn. .175±.005 was .200±.010 DGW 11/16/18

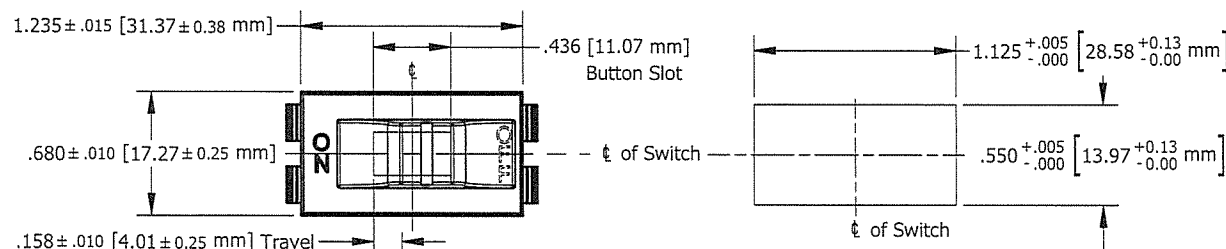

MATERIALS:
Button/Topper: Nylon 6/6, Color- Yellow
Housing: Nylon 6/6, Color- Yellow
Printing Color: Black

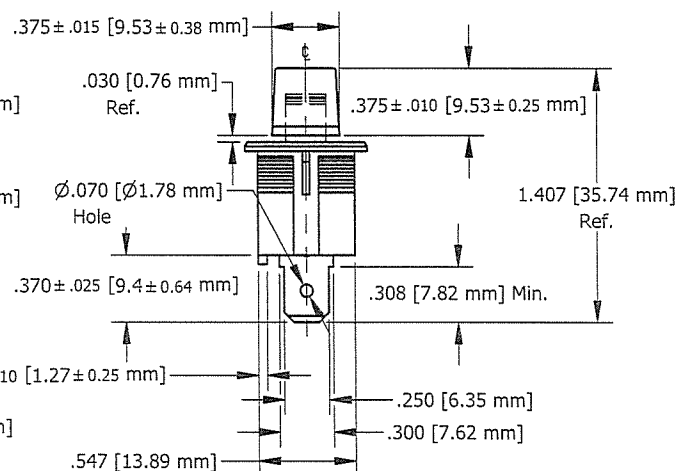
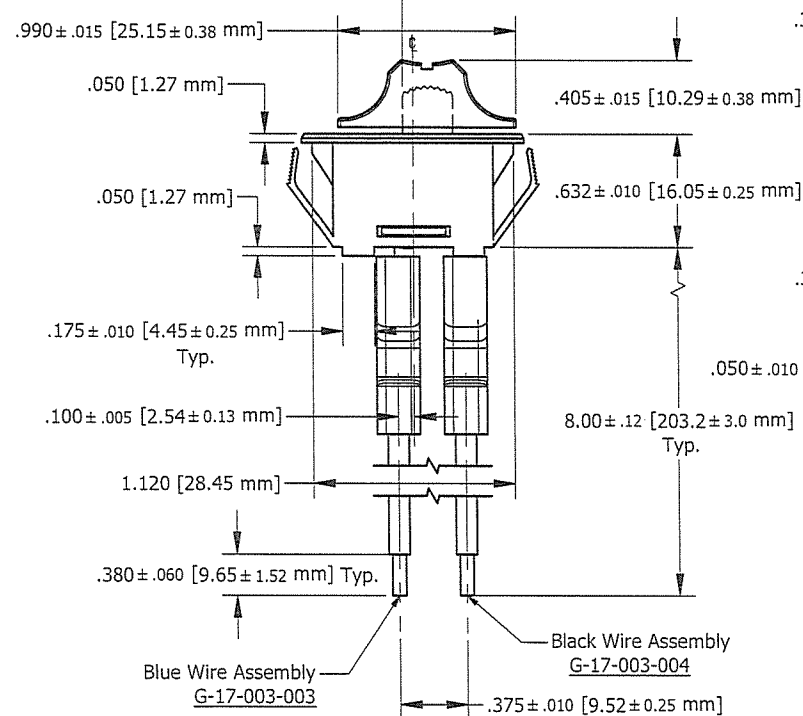

(Lead Wires Not Shown on this View for Clarity)

CW INDUSTRIES Southampton, Pa. 18966		Title: SNAP IN SWITCH ASSEMBLY S.P.-S.T. W/WIRE ASSEMBLY	
TOLERANCES UNLESS OTHERWISE SPECIFIED 2 Place Decimal ± .010 3 Place Decimal ± .005 Angles ± 1°		METRIC 1 Place Dec. ± .25mm 2 Place Dec. ± .13mm	
Made for: CW IND.		Division: SWITCH	
Drawn by: DGW 11/16/18		Dwg. No. G-2011-0042	
Checked by: G. GULD 11-16-18		Approval: [Signature] 11/16/18	

MASTER

Mouser Electronics

Authorized Distributor

Click to View Pricing, Inventory, Delivery & Lifecycle Information:

[CW Industries:](#)

[G-2011-0042](#)