

THIS INFORMATION IS CONFIDENTIAL AND PROPRIETARY TO CW INDUSTRIES INCORPORATED AND ITS AFFILIATES. IT MAY NOT BE DISCLOSED TO ANYONE, OTHER THAN CW INDUSTRIES PERSONNEL, WITHOUT WRITTEN AUTHORIZATION FROM CW INDUSTRIES INCORPORATED, SOUTHAMPTON, PENNSYLVANIA USA.

DIMENSIONS IN INCHES (MILLIMETERS)  
DO NOT SCALE DRAWING .....

Dwg. No.

GRS-4023B-0005

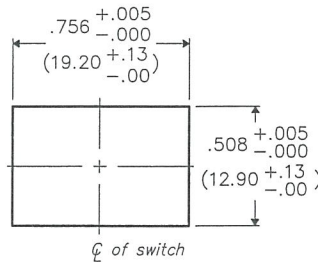
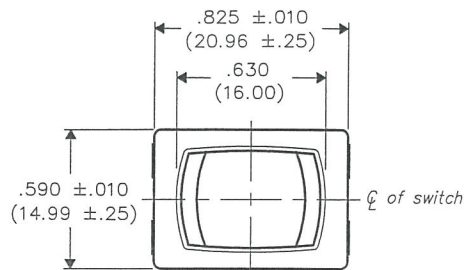

PANEL PIERCING

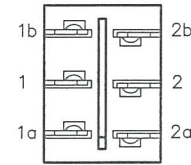

BOTTOM VIEW

BUTTON COLOR - Red  
HOUSING COLOR - Black

SWITCH RATINGS:

UL & CSA

13A. 125VAC 10A. 250VAC

1/2 H.P. 125-250VAC 5A. 14V (T)

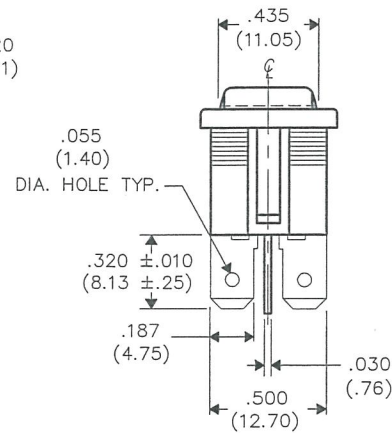
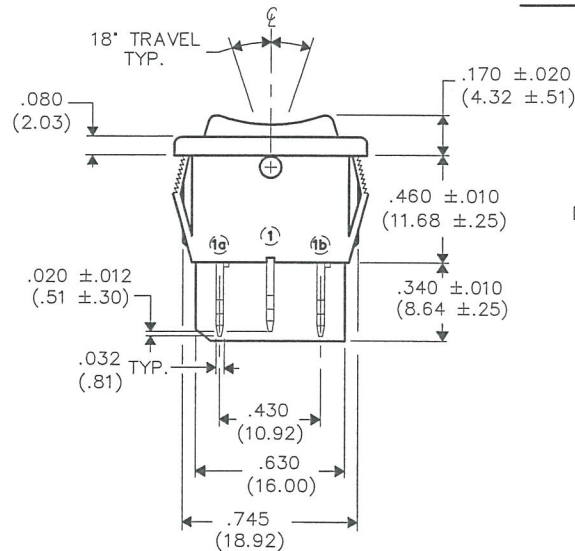

MASTER

REVISIONS

0

RELEASED  
7-03-13

JUL 19 2013

**CW INDUSTRIES**  
Southampton, Pa. 18966

TOLERANCES UNLESS OTHERWISE SPECIFIED  
2 Place Decimal ±.010 METRIC  
3 Place Decimal ±.005 1 Place Dec. ±.25mm  
Angles ..... ±1' 2 Place Dec. ±.13mm

Made for: CW IND.

Drawn by: DGW 7-03-13

Checked by: G. Guld 7-10-13

Approval: G. Guld 7-10-13

Title: **ROCKER SWIDGET  
ASSEMBLY**  
D.P.- CENTER OFF  
(MOM.-OFF-ON)

Division: **SWITCH**

Dwg. No.

GRS-4023B-0005

# Mouser Electronics

Authorized Distributor

Click to View Pricing, Inventory, Delivery & Lifecycle Information:

[CW Industries:](#)

[GRS-4023B-0005](#)