

DIMENSIONS IN INCHES (MILLIMETERS)
DO NOT SCALE DRAWING

Dwg. No.

GRS-4023A-0020

MATERIAL SPECIFICATIONS:

HOUSING- VALOX 357 UL94-V2 MIN. OR BETTER.

ACTUATOR- NYLON 6/6 UL94-V2 MINIMUM.

TERMINAL- COPPER ALLOY

MOVING CONTACT- COPPER ALLOY

COIL SPRING- MUSIC WIRE

PLUNGER- BRASS

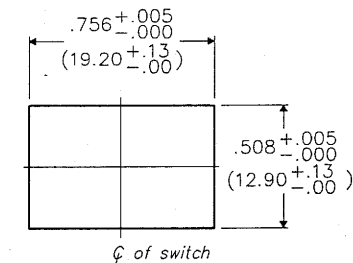
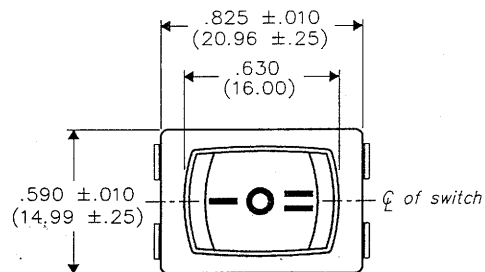

PANEL PIERCING

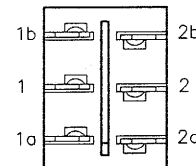

BOTTOM VIEW

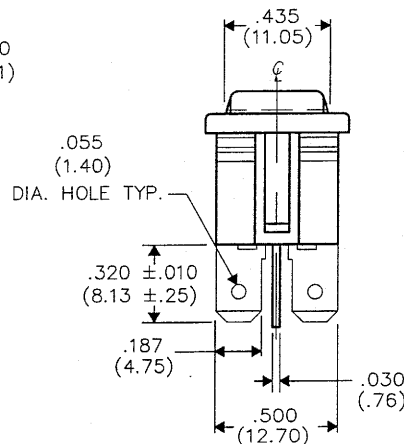
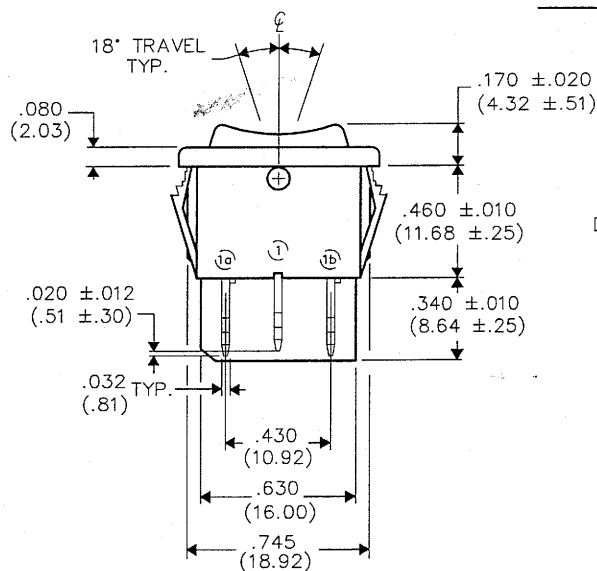

CW INDUSTRIES
Southampton, Pa. 18966

TOLERANCES UNLESS OTHERWISE SPECIFIED
2 Place Decimal ±.010 METRIC
3 Place Decimal ±.005 1 Place Dec. ±.25mm
Angles ±1° 2 Place Dec. ±.13mm

Made for: CW IND.

Drawn by: DGW 10-26-2006

Checked by: G. Guld 10-26-06

Approval: [Signature] 10-26-06

Title: MINI-ROCKER
SWITCH
SNAP-IN
D.P.- D.T.

Division: SWITCH

Dwg. No.
GRS-4023A-0020

B-FORMAT 2002

REVISIONS

RELEASED: 10-26-2006
DWG: 10-26-2006
DWG: 10-26-2006

Mouser Electronics

Authorized Distributor

Click to View Pricing, Inventory, Delivery & Lifecycle Information:

[CW Industries:](#)

[GRS-4023A-0020](#)