

THIS INFORMATION IS CONFIDENTIAL AND PROPRIETARY TO CW INDUSTRIES INCORPORATED AND ITS AFFILIATES. IT MAY NOT BE DISCLOSED TO ANYONE, OTHER THAN CW INDUSTRIES PERSONNEL, WITHOUT WRITTEN AUTHORIZATION FROM CW INDUSTRIES INCORPORATED, SOUTHAMPTON, PENNSYLVANIA USA.

DIMENSIONS IN INCHES (MILLIMETERS)  
DO NOT SCALE DRAWING .....

Dwg. No.  
GRS-4013C-0001

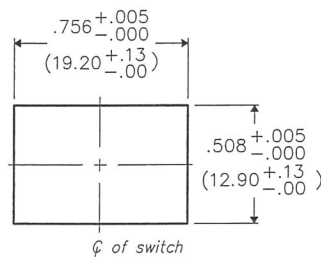
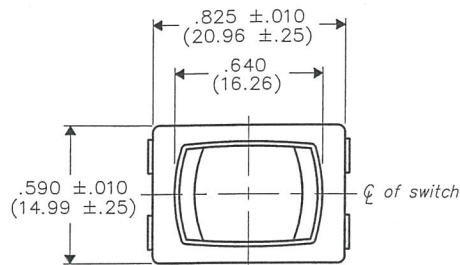

PANEL PIERCING

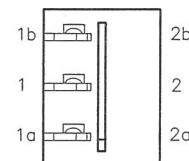

BOTTOM VIEW

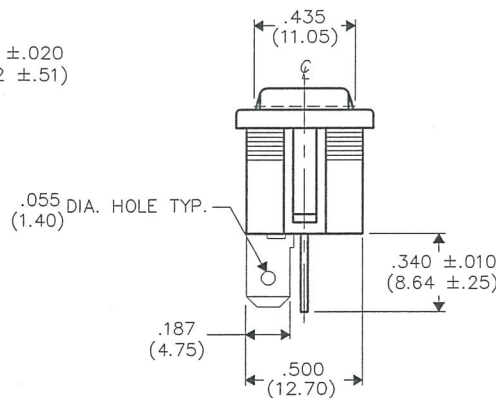
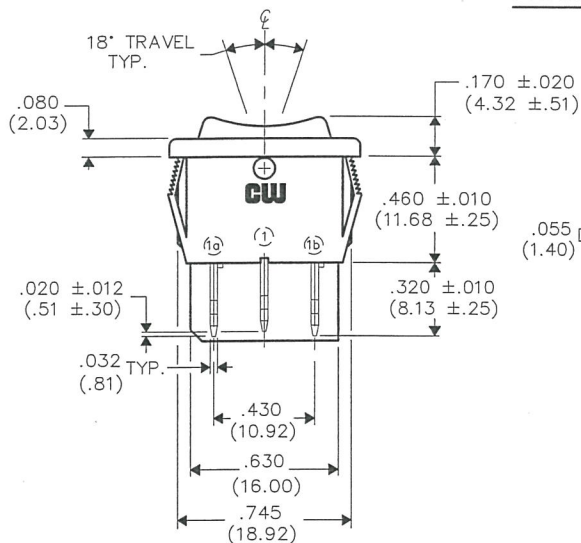

UL & CSA LISTED:

8A 125VAC  
4A 250VAC  
3A 277VAC

MATERIALS:

BUTTON & HOUSING - NYLON 6/6 94V-2, COLOR/BLACK  
TERMINAL & MOVING CONTACT - COPPER ALLOY

B-FORMAT 2002

REVISIONS

RELEASED  
DWG 2-25-13

FEB 26 2013

<b>cw INDUSTRIES</b> Southampton, Pa. 18966 TOLERANCES UNLESS OTHERWISE SPECIFIED 2 Place Decimal ±.010 METRIC 3 Place Decimal ±.005 1 Place Dec. ±.25mm Angles ..... ±1' 2 Place Dec. ±.13mm		Title: ASSEMBLY	
		ROCKER SWIDGET	
Made for: CW IND.		Division: SWITCH	
Drawn by: DGW 2-25-13		Dwg. No. GRS-4013C-0001	
Checked by: G. Guld 2-26-13			
Approval: C. Hume 2/26/13			

MASTER

# Mouser Electronics

Authorized Distributor

Click to View Pricing, Inventory, Delivery & Lifecycle Information:

[CW Industries:](#)

[GRS-4013C-0001](#)