

THIS INFORMATION IS CONFIDENTIAL AND PROPRIETARY TO CW INDUSTRIES INCORPORATED AND ITS AFFILIATES. IT MAY NOT BE DISCLOSED TO ANYONE, OTHER THAN CW INDUSTRIES PERSONNEL, WITHOUT WRITTEN AUTHORIZATION FROM CW INDUSTRIES INCORPORATED, SOUTHAMPTON, PENNSYLVANIA USA.

DIMENSIONS IN INCHES (MILLIMETERS)  
DO NOT SCALE DRAWING .....

Dwg. No.

GRS-4013A-0008

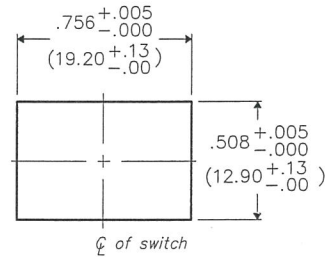
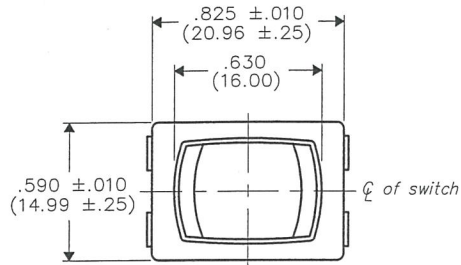

PANEL PIERCING

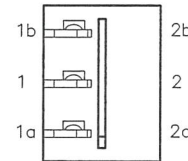

BOTTOM VIEW

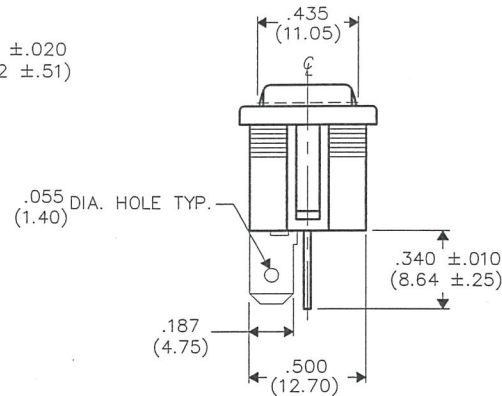
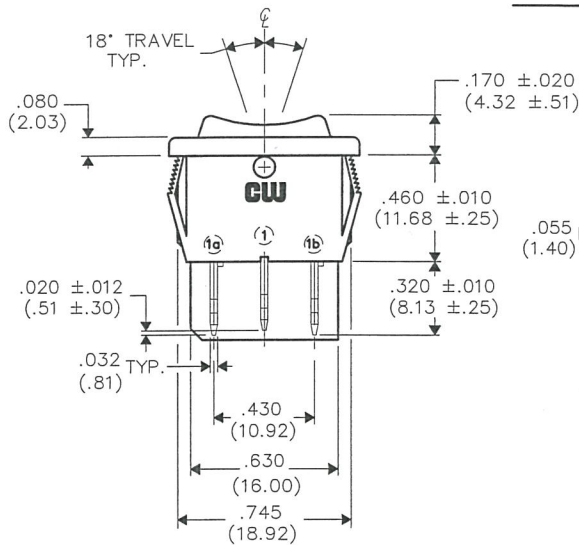

UL & CSA LISTED:

13A 125VAC 10A 250VAC  
1/2 H.P. 125-250VAC 5A 14V(T)

MATERIALS:

BUTTON - NYLON 6/6 94V-2 COLOR, RED  
HOUSING - NYLON 6/6 94V-2 COLOR, BLACK  
TERMINAL & MOVING CONTACT - COPPER ALLOY

REVISIONS

REV	DATE	DESCRIPTION
0	10-06-94	RELEASED.
1	OCT. 7, 1994	REDRAWN. UPDATED WITH NEW FORMAT.
	DWG 2-25-2013	
	FEB 26 2013	

<b>cw INDUSTRIES</b> Southampton, Pa. 18966	
TOLERANCES UNLESS OTHERWISE SPECIFIED	
2 Place Decimal ±.010	METRIC
3 Place Decimal ±.005	1 Place Dec. ±.25mm
Angles ..... ±1°	2 Place Dec. ±.13mm
Made for: CW IND.	
Drawn by: DGW 10-06-94	
Checked by: B. Gold 2-26-13	
Approval: C. H. 2/24/12	

Title:	ASSEMBLY
	ROCKER SWIDGET
	S.P.- CENTER OFF
	(ON-OFF-ON)
Division:	SWITCH
Dwg. No.	GRS-4013A-0008

MASTER

# Mouser Electronics

Authorized Distributor

Click to View Pricing, Inventory, Delivery & Lifecycle Information:

[CW Industries:](#)

[GRS-4013A-0008](#)