

Rating	10A 125VAC, 6A 250VAC 1/2HP 125/250VAC	
	20A 14VDC	
Contact Resistance	50m ohm Max.	
Insulation Resistance	DC 500V 100M OHM Min.	
DIELECTRIC STRENGTH	AC 1500V 1 MINUTE	
Operation Temp.	- 25 °C ~ 85 °C	
Function	3P SPST ON-OFF (LED)	

*MATERIAL:
 Frame: Nylon 66 (94-V2), Black
 Actuator: PC clear (94-V2), Red
 Waterproof Rubber: Silicone
 Terminals: Silver plated, Copper alloy
 LED: Red
 Waterproof Rubber: Black
 Printed: None
Waterproof: IP65

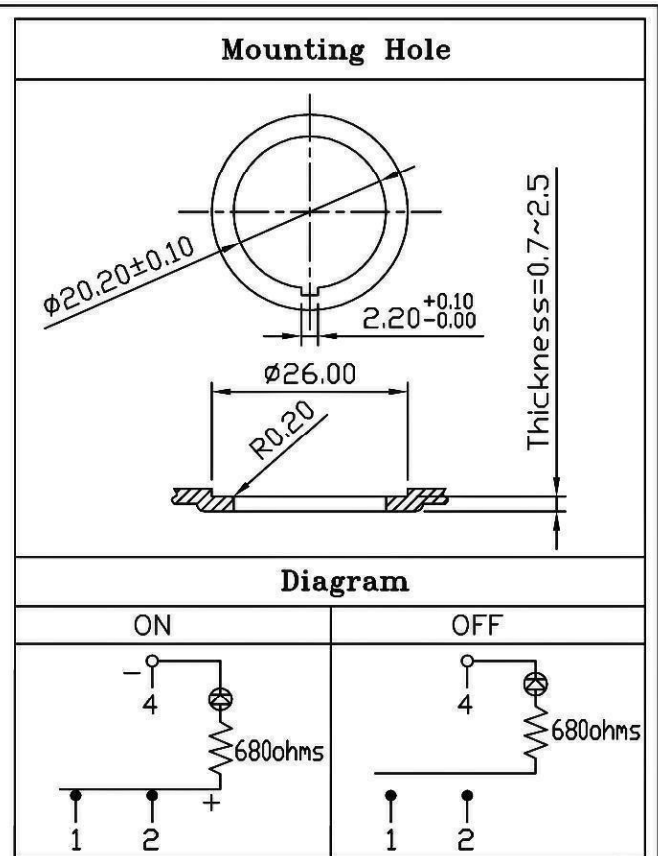
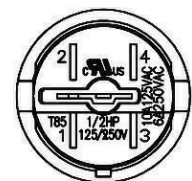
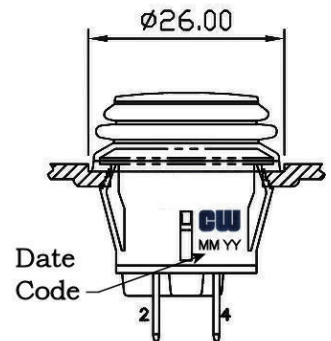
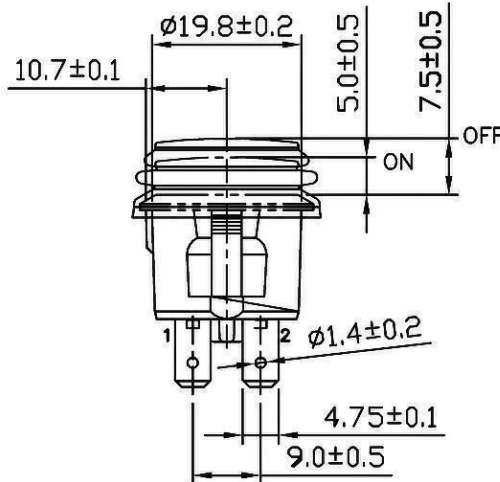
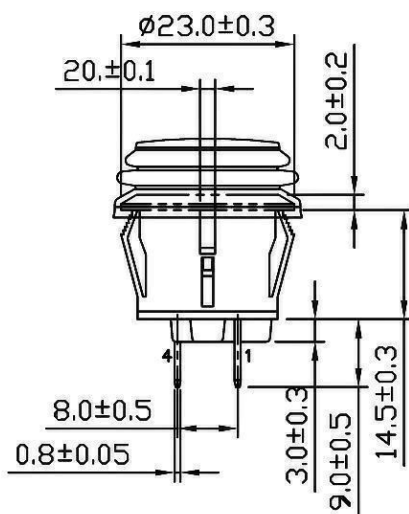
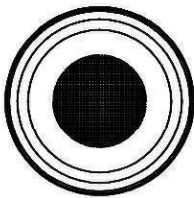

RoHS Compliant

1 Added date code. 1/18/11.

CW INDUSTRIES
 Southampton, Pa. 18966
 Tel 215.355.7080/www.cwind.com

Date Drawn: 1/18/11

Rev. 1

Unit: mm

Checked By: G.Guld

Title: PUSH BUTTON SWITCH

CW P/N: GPB527D2B02BR1

Mouser Electronics

Authorized Distributor

Click to View Pricing, Inventory, Delivery & Lifecycle Information:

[CW Industries:](#)

[GPB527D2B02BR1](#)