

Lampholder for Spot - Downlight Modules GH36d-4

28.720 - Lampholder for Spot - Downlight Modules GH36d-4

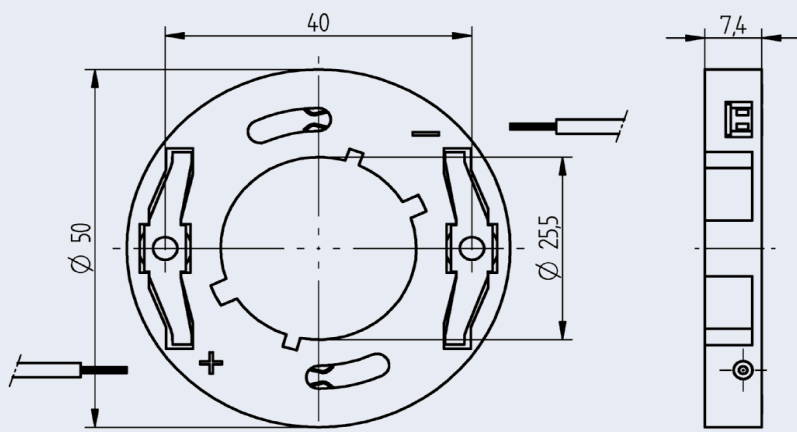

Part no.

28.720.1001.90

Lampholder for Twist 'n' Spot LED Module

- Housing: sturdy PPS for more durability
Power transmission
- Twist and Lock System
- Optimum thermal management: CrNi leaf springs
ensure permanent contact pressure to the LED module

Please note the polarity of the LED

Please observe the specifications of the LED manufacturer
When connecting LED modules in series, the creepage and clearance distances of the individual modules must be designed for the total voltage of the series connection

Mechanical data	
Screw fixing	M 3
Max. torque	0,3 Nm
Key	GH36-4
Material data	
Material housing	PPS
Colour	black
Material contacts	CuSn
Leaf spring	CrNi
Electrical data	
Voltage rating	150 V
Current rating	2 A
Connection data	
Connection technology	push-in terminals
Solid wires	0,5 mm ²
Strip length	
8 +1 mm	
Number of connection points	2
Country specific certificates	
VDE certificate	40041552
Commercial data	
Packaging quantity	250
Environmental requirements	
Max. Operating temperature	140°C

Mouser Electronics

Authorized Distributor

Click to View Pricing, Inventory, Delivery & Lifecycle Information:

[BJB Electric:](#)

[28.720.1001-001-00](#) [28.720.1002-001-00](#) [28.720.1003-001-00](#) [28.720.1004-001-00](#)