

# LUMOTAST 75 IP40 - Signal lamp, square collar, flush lens, housing

1.65.111.061/0000



## General information

Form of lens	flat
Form of collar	square
Color of collar	black

## Dimensions

Length of collar	18 mm
Width of collar	18 mm
Overall height	7.5 mm
Mounting depth	33.5 mm
Mounting hole	16.2 mm

## Mechanical design

Mounting	ring nut
Terminals	solder terminals
Lamp socket	T 4.5
Illumination	LED / filament lamp

## Electrical characteristics

Voltage limit max.	35 V
Power limit max.	1.2 W

## Other specifications

Degree of protection from front side	IP40 (DIN EN 60529)
Weight	5 g
Operation temperature min.	-25 °C
Ambient temp. operating max.	+55 °C
Storage temperature min.	-40 °C
Storage temperature max.	+80 °C
Environmental resistance	acc. to IEC 60068-2-14, -30, -33 and -78
ROHS compliant	yes
REACH compliant	yes

Mounting hole

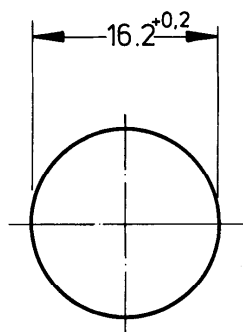

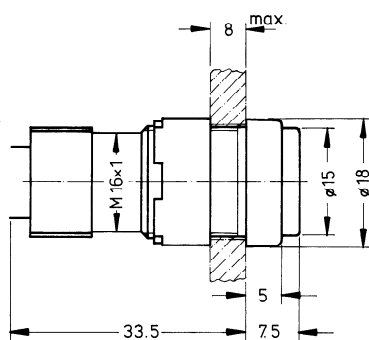
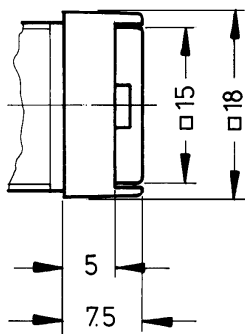

# Mouser Electronics

Authorized Distributor

Click to View Pricing, Inventory, Delivery & Lifecycle Information:

[RAFI:](#)

[1.65.111.061/0000](#)