

pi-top [4] dot-id



QUICK START GUIDE.



INTRODUCTION.

We want to make transitioning to a virtual classroom simple for you, from setting up hardware for remote instruction to giving you access to your core learning management tools such as Google Classroom and Office 365. All of this is possible with pi-top [4], our versatile computing device that combines digital making, coding and practical projects into a single platform while still functioning as a standard computer.

New to pi-top's ecosystem? Use this guide to learn the basics and find out how to get started.



What's in the box?

Page 3

Getting started

Page 4

- Option A: Connecting to a computer
- Option B: Connecting to a monitor or TV

Page 5

Page 6

Connecting to the internet

Page 7

- Connecting via Wi-Fi
- Connecting via cable (Ethernet)

Connecting to Google Classrooms & Office 365

Page 8

WHAT'S IN THE BOX?

Your mini-desktop PC, the pi-top [4]

Containing the Raspberry Pi 4

- SD card with pi-topOS
- Power supply
- pi-top Display Cable
- HDMI Adapter
- USB Adapter



Having trouble?

pi-top.com
/support

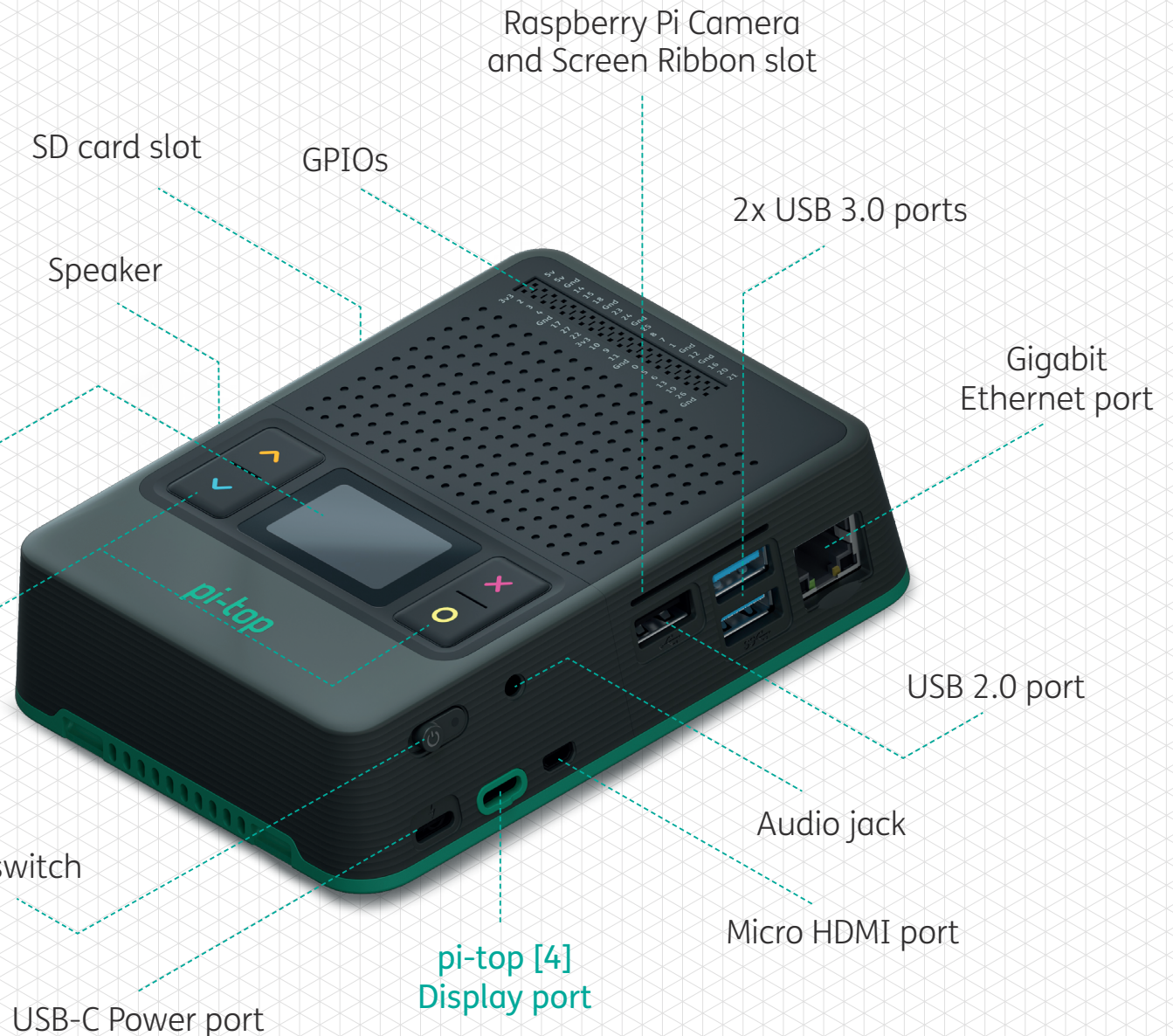

There is a small amount of charge in your pi-top [4] battery, but please plug in the power supply to fully charge it before you begin!

GETTING STARTED.

As a portable computing device, pi-top [4] is easy to set up and get going. You can plug it into your existing HDMI TV or monitor, with our included Display Cable, or you can easily connect pi-top [4] to your existing Windows, Apple and Chromebook computers with VNC. Follow these steps to get started.

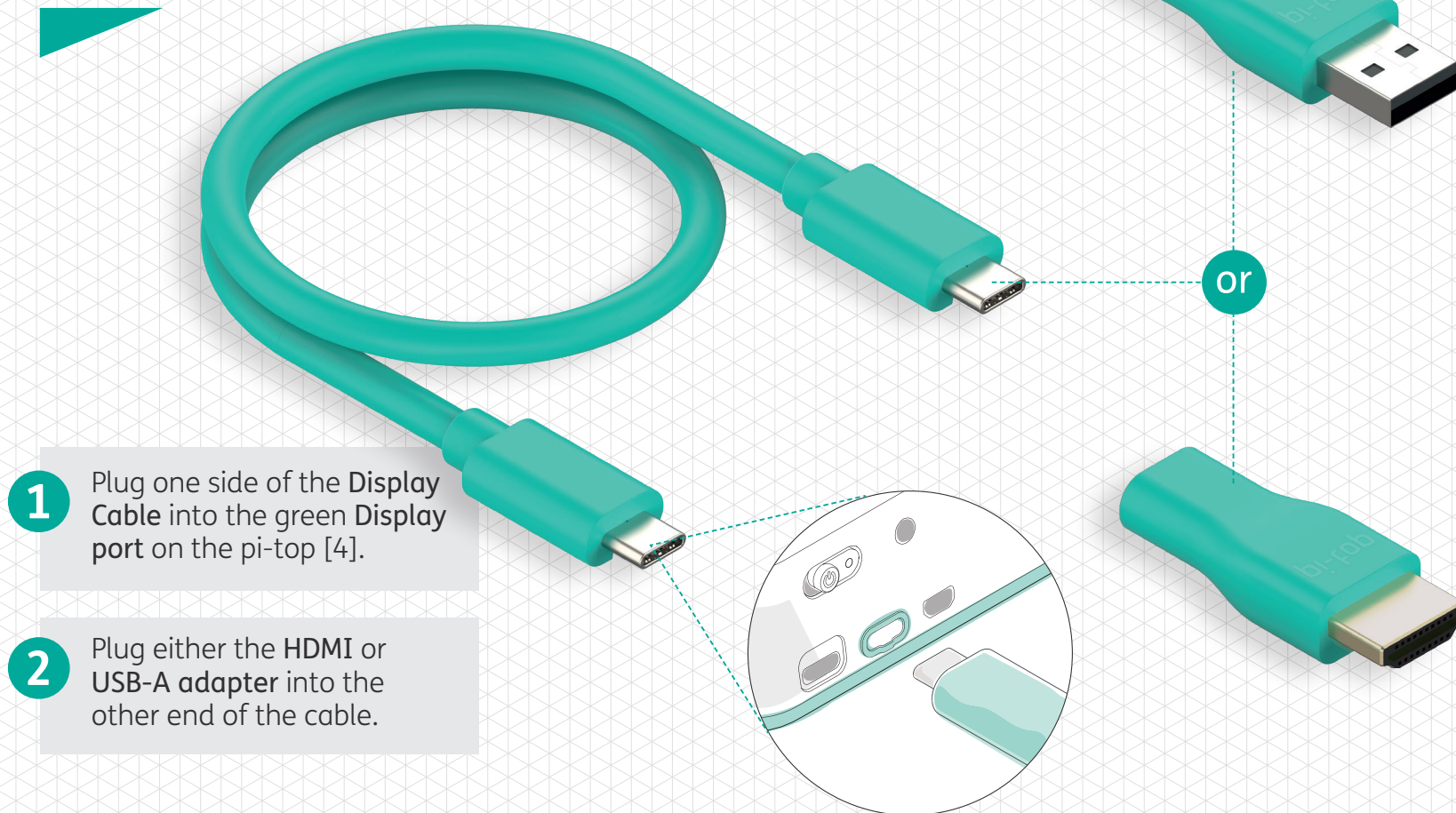

- 1 Plug one side of the Display Cable into the green Display port on the pi-top [4].
- 2 Plug either the HDMI or USB-A adapter into the other end of the cable.

Option A

USB-A adapter
For connecting
to a computer
[Page 5](#)

Option B

HDMI adapter
For connecting to
a monitor or TV
[Page 6](#)

Option A Connecting to a computer

1 REALVNC

Install and launch VNC on your computer. This is a third-party screen sharing software. You can download it for free here:

pi-top.com/vnc

2 Plug the Display Cable into pi-top [4] and your computer via the USB-A adapter.

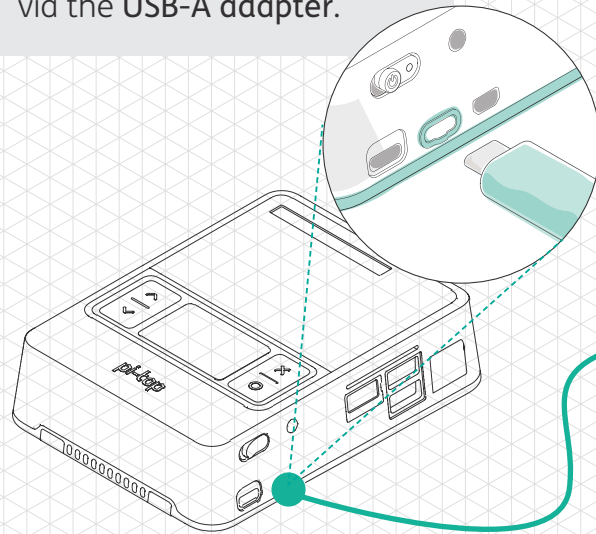

3 Power up the pi-top [4] and enter this IP address into the VNC viewer:

192.168.64.1

You will then need to enter these details to login:

Username: **pi**

Password: **pi-top**

4 GET MAKING!

! If your computer only has USB-C ports, you'll need a USB-A dongle to connect.

Option B Connecting to a monitor or TV

1 Plug the Display Cable into the pi-top [4] and your monitor via the HDMI adapter.

2 Plug in your mouse and keyboard via USB.

3 GET MAKING!

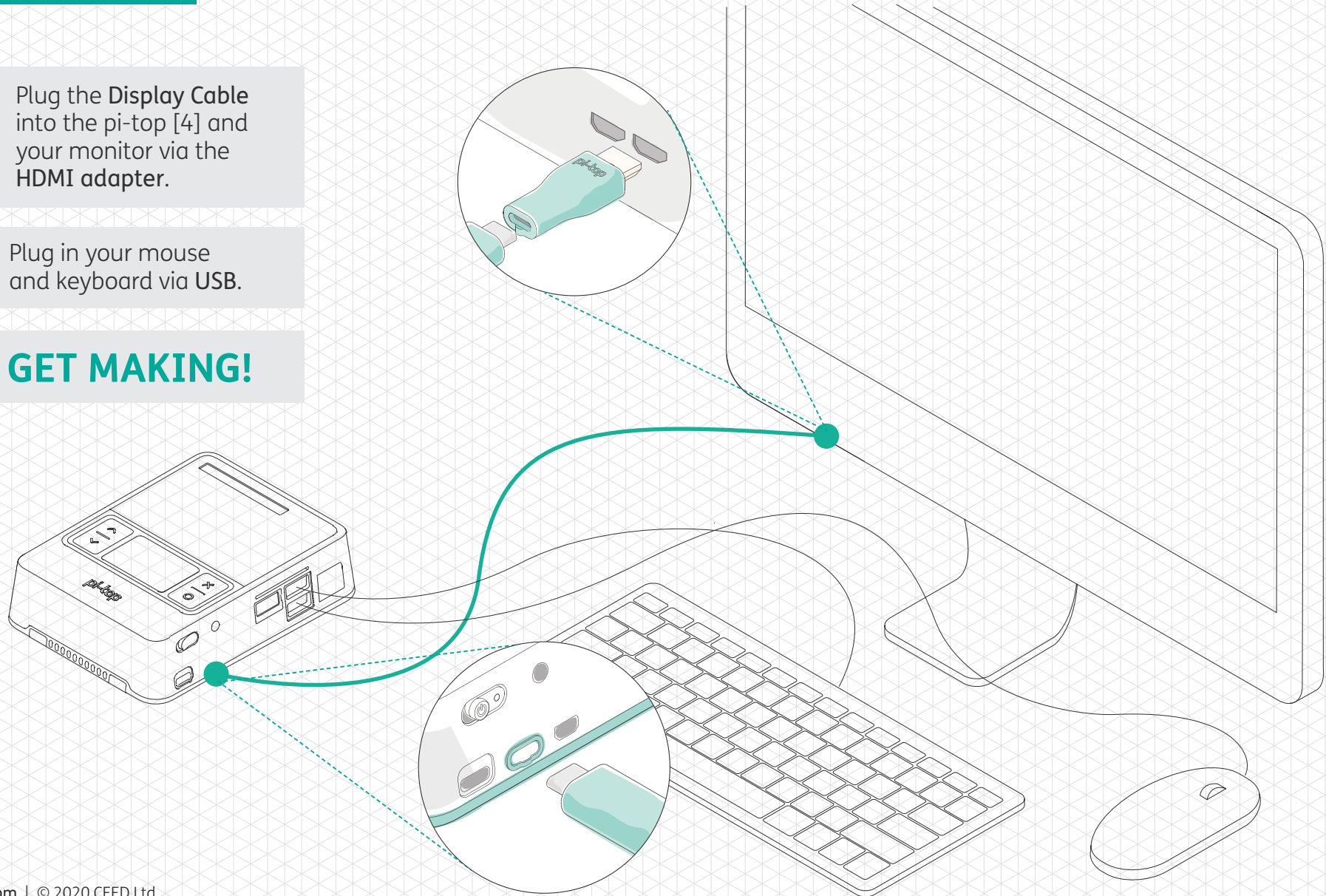

CONNECTING TO THE INTERNET.

Connecting via Wi-Fi

Click on either of these icons on the bottom toolbar and follow the on-screen instructions.

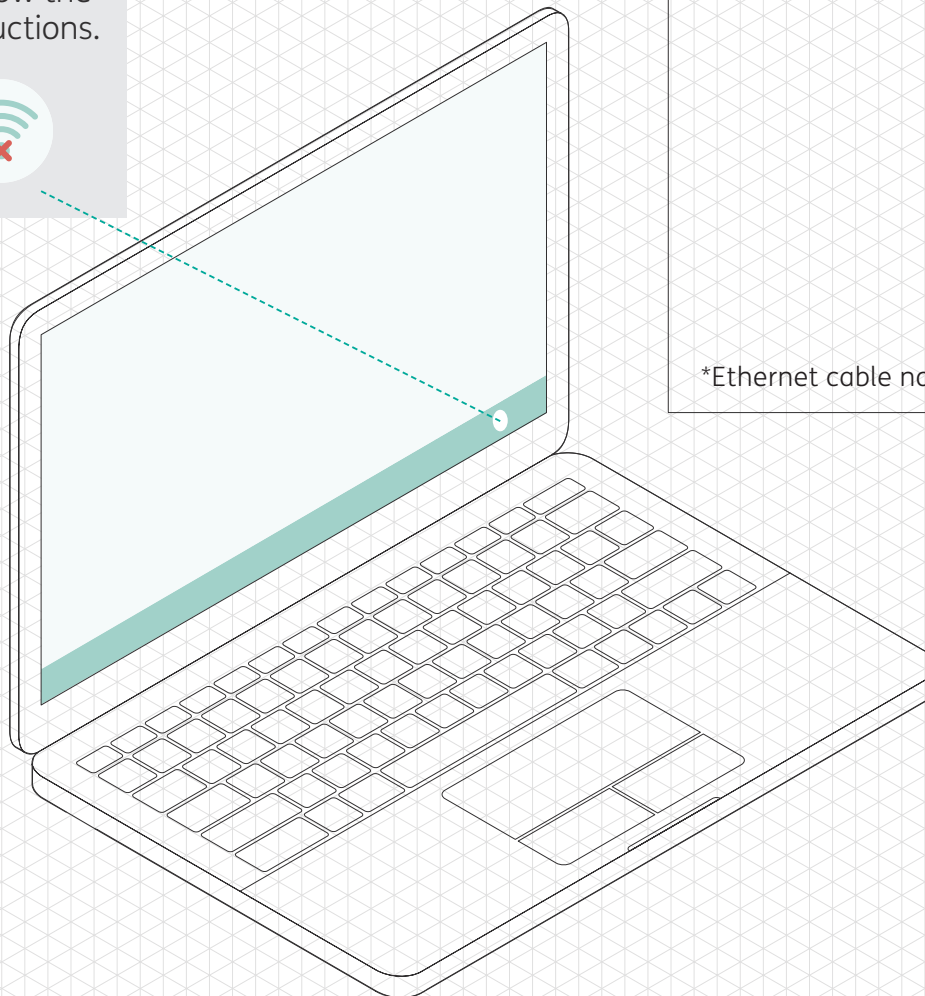
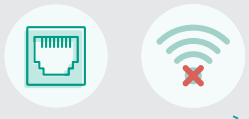

Connecting via cable (Ethernet)

Plug the Ethernet cable into the pi-top [4].

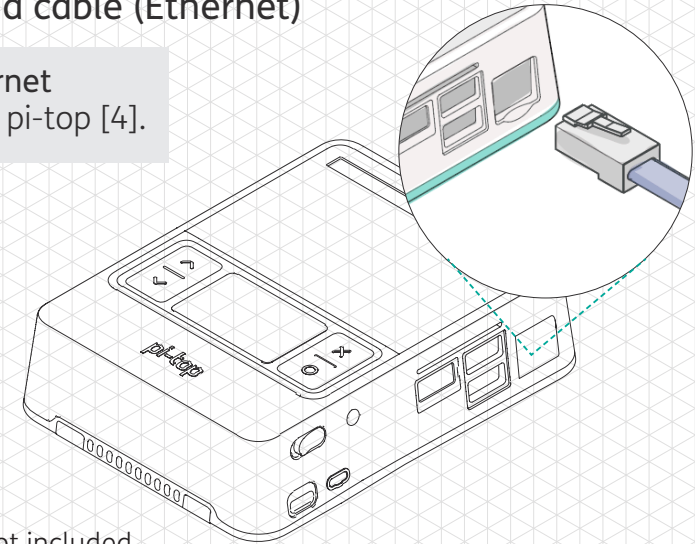

*Ethernet cable not included



Having trouble?

pi-top.com
/support

CONNECTING TO GOOGLE CLASSROOMS & OFFICE 365.

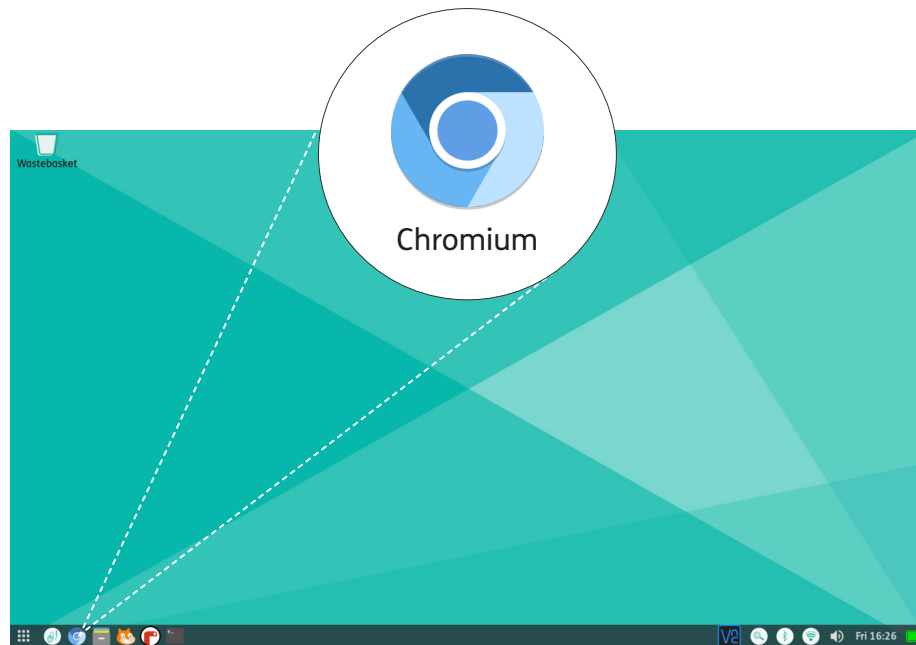

- 1 Open up the **Search Portal** and click on the **Chromium** application. A new browser tab should open.

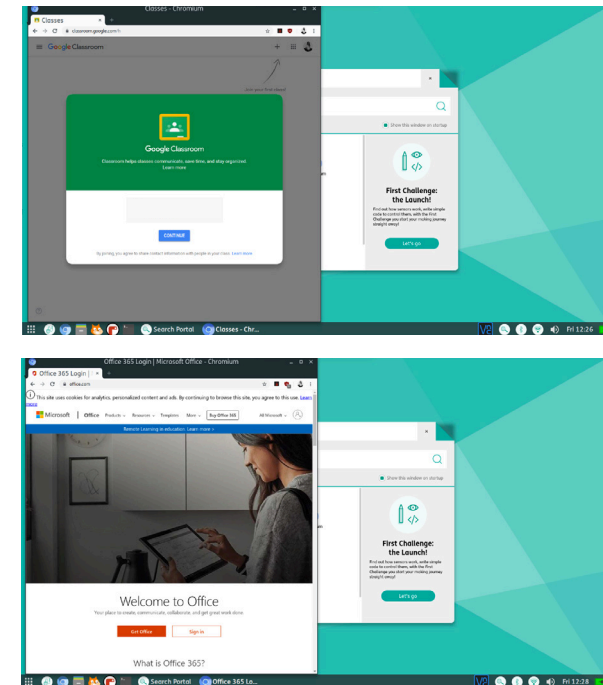

- 2 To get to Google Classrooms or Office 365, enter their URL into the search bar at the top.

pi-top

pi-top is one of the fastest growing ed-tech companies and has a unique vision to increase access to coding and technical education through project-based learning. We want to inspire a generation of makers and give them the skills they need in a rapidly changing world.

If you want to learn more about project-based learning or pi-top, visit this [resource page](#) or contact sales@pi-top.com

pi-top.com



Having trouble?

[pi-top.com
/support](https://pi-top.com/support)

Mouser Electronics

Authorized Distributor

Click to View Pricing, Inventory, Delivery & Lifecycle Information:

[SparkFun Electronics:](#)

[DEV-16827](#)