

C-FILTER D-SUB HIGH DENSITY

Solder pin – Straight – Precision machined contacts



RoHS compliant – CSA listed, File No.: LR 115000-1 – UL listed, File No.: E202784

SOCKET CONNECTOR

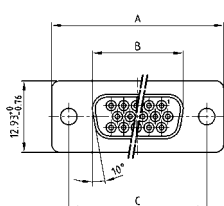

No. of pos.	A -0.76	B -0.25	C
15	31.19	16.46	25.00
26	39.52	24.79	33.30
44	53.42	38.50	47.04
62	69.70	54.96	63.50

PCB layout: Kat1iT9A

Mounting style: Threaded rear spacer

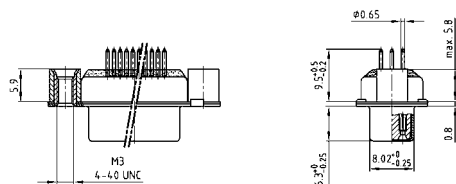

Mounting style: Front and threaded rear spacer

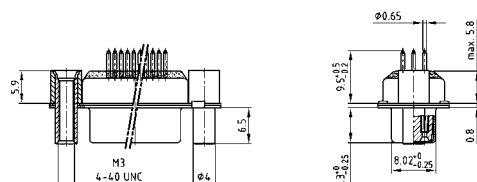

DESCRIPTION

- Mounting styles:
 - with 4-40 UNC or M3 threaded rear spacer
 - with 4-40 UNC or M3 front and threaded rear spacer
- Quality class 3 (also available in quality class 1)
- Shell: Steel tin plated (brass tin plated on request)

PLUG CONNECTOR

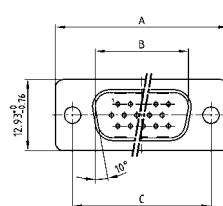

No. of pos.	A -0.76	B +0.25	C	D -0.3
15	31.19	16.79	25.00 ^{+ 0.12} _{- 0.13}	6.12
26	39.52	25.12	33.30 ^{+ 0.15} _{- 0.10}	6.12
44	53.42	38.84	47.04 ^{± 0.13}	5.99
62	69.70	55.30	63.50 ^{± 0.13}	5.99

PCB layout: Kat1iU0A

Mounting style: Threaded rear spacer

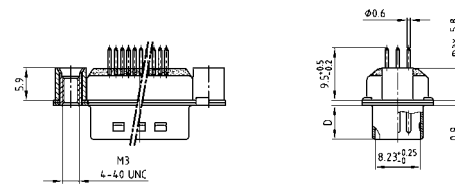

Mounting style: Front and threaded rear spacer

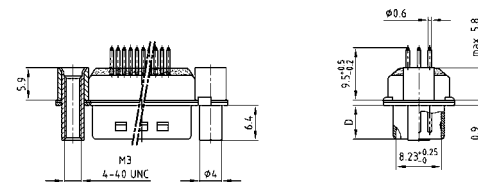

ORDER DATA

Capacitance 180 pF

SOCKET CONNECTOR			PLUG CONNECTOR		
No. of pos.	Mounting style	Part Number	No. of pos.	Mounting style	Part Number
15	4-40 UNC Threaded rear spacer	242 A 27500 X	15	4-40 UNC Threaded rear spacer	241 A 27600 X
26	4-40 UNC Threaded rear spacer	242 A 27510 X	26	4-40 UNC Threaded rear spacer	241 A 27610 X
44	4-40 UNC Threaded rear spacer	242 A 27520 X	44	4-40 UNC Threaded rear spacer	241 A 27620 X
62	4-40 UNC Threaded rear spacer	242 A 27530 X	62	4-40 UNC Threaded rear spacer	241 A 27630 X
15	M3 Threaded rear spacer	242 A 27540 X	15	M3 Threaded rear spacer	241 A 27640 X
26	M3 Threaded rear spacer	242 A 27550 X	26	M3 Threaded rear spacer	241 A 27650 X
44	M3 Threaded rear spacer	242 A 27560 X	44	M3 Threaded rear spacer	241 A 27660 X
62	M3 Threaded rear spacer	242 A 27570 X	62	M3 Threaded rear spacer	241 A 27670 X
15	4-40 UNC Front/Threaded rear spacer	242 A 27580 X	15	4-40 UNC Front/Threaded rear spacer	241 A 27680 X
26	4-40 UNC Front/Threaded rear spacer	242 A 27590 X	26	4-40 UNC Front/Threaded rear spacer	241 A 27690 X
44	4-40 UNC Front/Threaded rear spacer	242 A 27600 X	44	4-40 UNC Front/Threaded rear spacer	241 A 27700 X
62	4-40 UNC Front/Threaded rear spacer	242 A 27610 X	62	4-40 UNC Front/Threaded rear spacer	241 A 27710 X
15	M3 Front/Threaded rear spacer	242 A 27620 X	15	M3 Front/Threaded rear spacer	241 A 27720 X
26	M3 Front/Threaded rear spacer	242 A 27630 X	26	M3 Front/Threaded rear spacer	241 A 27730 X
44	M3 Front/Threaded rear spacer	242 A 27640 X	44	M3 Front/Threaded rear spacer	241 A 27740 X
62	M3 Front/Threaded rear spacer	242 A 27650 X	62	M3 Front/Threaded rear spacer	241 A 27750 X

C-FILTER D-SUB HIGH DENSITY

Solder pin – Straight – Precision machined contacts

ORDER DATA

Capacitance 370 pF

SOCKET CONNECTOR			PLUG CONNECTOR		
No. of pos.	Mounting style	Part Number	No. of pos.	Mounting style	Part Number
15	4-40 UNC Threaded rear spacer	242 A 18220 X	15	4-40 UNC Threaded rear spacer	241 A 16620 X
26	4-40 UNC Threaded rear spacer	242 A 18230 X	26	4-40 UNC Threaded rear spacer	241 A 16630 X
44	4-40 UNC Threaded rear spacer	242 A 18240 X	44	4-40 UNC Threaded rear spacer	241 A 16640 X
62	4-40 UNC Threaded rear spacer	242 A 18250 X	62	4-40 UNC Threaded rear spacer	241 A 16650 X
15	M3 Threaded rear spacer	242 A 18300 X	15	M3 Threaded rear spacer	241 A 16700 X
26	M3 Threaded rear spacer	242 A 18310 X	26	M3 Threaded rear spacer	241 A 16710 X
44	M3 Threaded rear spacer	242 A 18320 X	44	M3 Threaded rear spacer	241 A 16720 X
62	M3 Threaded rear spacer	242 A 18330 X	62	M3 Threaded rear spacer	241 A 16730 X
15	4-40 UNC Front/Threaded rear spacer	242 A 18380 X	15	4-40 UNC Front/Threaded rear spacer	241 A 16780 X
26	4-40 UNC Front/Threaded rear spacer	242 A 18390 X	26	4-40 UNC Front/Threaded rear spacer	241 A 16790 X
44	4-40 UNC Front/Threaded rear spacer	242 A 18400 X	44	4-40 UNC Front/Threaded rear spacer	241 A 16800 X
62	4-40 UNC Front/Threaded rear spacer	242 A 18410 X	62	4-40 UNC Front/Threaded rear spacer	241 A 16810 X
15	M3 Front/Threaded rear spacer	242 A 18460 X	15	M3 Front/Threaded rear spacer	241 A 16860 X
26	M3 Front/Threaded rear spacer	242 A 18470 X	26	M3 Front/Threaded rear spacer	241 A 16870 X
44	M3 Front/Threaded rear spacer	242 A 18480 X	44	M3 Front/Threaded rear spacer	241 A 16880 X
62	M3 Front/Threaded rear spacer	242 A 18490 X	62	M3 Front/Threaded rear spacer	241 A 16890 X

Capacitance 830 pF

SOCKET CONNECTOR			PLUG CONNECTOR		
No. of pos.	Mounting style	Part Number	No. of pos.	Mounting style	Part Number
15	4-40 UNC Threaded rear spacer	242 A 18260 X	15	4-40 UNC Threaded rear spacer	241 A 16660 X
26	4-40 UNC Threaded rear spacer	242 A 18270 X	26	4-40 UNC Threaded rear spacer	241 A 16670 X
44	4-40 UNC Threaded rear spacer	242 A 18280 X	44	4-40 UNC Threaded rear spacer	241 A 16680 X
62	4-40 UNC Threaded rear spacer	242 A 18290 X	62	4-40 UNC Threaded rear spacer	241 A 16690 X
15	M3 Threaded rear spacer	242 A 18340 X	15	M3 Threaded rear spacer	241 A 16740 X
26	M3 Threaded rear spacer	242 A 18350 X	26	M3 Threaded rear spacer	241 A 16750 X
44	M3 Threaded rear spacer	242 A 18360 X	44	M3 Threaded rear spacer	241 A 16760 X
62	M3 Threaded rear spacer	242 A 18370 X	62	M3 Threaded rear spacer	241 A 16770 X
15	4-40 UNC Front/Threaded rear spacer	242 A 18420 X	15	4-40 UNC Front/Threaded rear spacer	241 A 16820 X
26	4-40 UNC Front/Threaded rear spacer	242 A 18430 X	26	4-40 UNC Front/Threaded rear spacer	241 A 16830 X
44	4-40 UNC Front/Threaded rear spacer	242 A 18440 X	44	4-40 UNC Front/Threaded rear spacer	241 A 16840 X
62	4-40 UNC Front/Threaded rear spacer	242 A 18450 X	62	4-40 UNC Front/Threaded rear spacer	241 A 16850 X
15	M3 Front/Threaded rear spacer	242 A 18500 X	15	M3 Front/Threaded rear spacer	241 A 16900 X
26	M3 Front/Threaded rear spacer	242 A 18510 X	26	M3 Front/Threaded rear spacer	241 A 16910 X
44	M3 Front/Threaded rear spacer	242 A 18520 X	44	M3 Front/Threaded rear spacer	241 A 16920 X
62	M3 Front/Threaded rear spacer	242 A 18530 X	62	M3 Front/Threaded rear spacer	241 A 16930 X

Mouser Electronics

Authorized Distributor

Click to View Pricing, Inventory, Delivery & Lifecycle Information:

CONEC:

<u>241A16680X</u>	<u>242A18270X</u>	<u>242A18380X</u>	<u>241A27730X</u>	<u>241A27680X</u>	<u>241A27600X</u>	<u>241A27700X</u>	<u>241A27710X</u>
<u>241A27660X</u>	<u>241A27610X</u>	<u>241A27690X</u>	<u>241A27620X</u>	<u>241A27720X</u>	<u>241A27670X</u>	<u>241A27750X</u>	<u>241A27630X</u>
<u>241A16740X</u>	<u>241A16820X</u>	<u>241A16910X</u>	<u>241A16710X</u>	<u>241A16720X</u>	<u>241A16790X</u>	<u>241A16880X</u>	<u>241A16750X</u>
<u>241A16840X</u>	<u>241A16930X</u>	<u>241A16650X</u>	<u>241A16810X</u>	<u>241A16690X</u>	<u>241A16770X</u>	<u>241A16670X</u>	<u>241A16760X</u>
<u>241A16850X</u>	<u>241A16920X</u>	<u>241A16830X</u>	<u>241A16900X</u>	<u>242A27560X</u>	<u>242A27620X</u>	<u>242A27570X</u>	<u>242A27640X</u>
<u>242A27590X</u>	<u>242A27530X</u>	<u>242A27540X</u>	<u>242A27630X</u>	<u>242A27510X</u>	<u>241A16660X</u>	<u>242A27520X</u>	<u>242A27600X</u>
<u>242A27610X</u>	<u>241A16890X</u>	<u>242A27650X</u>	<u>242A27550X</u>	<u>241A16630X</u>	<u>241A16640X</u>	<u>241A16800X</u>	<u>241A16730X</u>
<u>242A27500X</u>	<u>242A27580X</u>	<u>241A16620X</u>	<u>241A16700X</u>	<u>241A16780X</u>	<u>241A16860X</u>	<u>241A16870X</u>	<u>242A18260X</u>
<u>242A18510X</u>	<u>242A18340X</u>	<u>242A18350X</u>	<u>242A18420X</u>	<u>242A18240X</u>	<u>242A18330X</u>	<u>242A18520X</u>	<u>242A18220X</u>
<u>242A18300X</u>	<u>242A18290X</u>	<u>242A18370X</u>	<u>242A18440X</u>	<u>242A18450X</u>	<u>242A18460X</u>	<u>242A18480X</u>	<u>242A18410X</u>
<u>242A18490X</u>	<u>242A18500X</u>	<u>242A18250X</u>	<u>242A18320X</u>	<u>241A27640X</u>	<u>241A27650X</u>	<u>242A18360X</u>	<u>242A18530X</u>
<u>242A18230X</u>	<u>242A18310X</u>	<u>242A18470X</u>					