

C-FILTER D-SUB STANDARD

Solder pin – Angled – .370" / 9.4 mm – Precision machined contacts – Plastic bracket

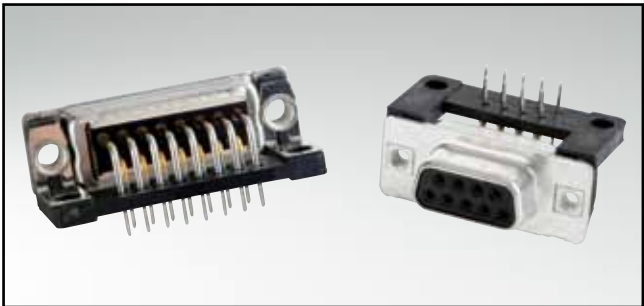

RoHS compliant – CSA listed, File No.: LR 115000-1 – UL listed, File No.: E202784

SOCKET CONNECTOR

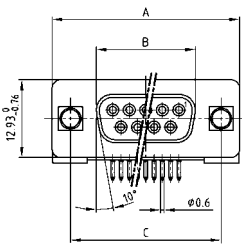

No. of pos.	A -0.76	B -0.25	C
09	31.19	16.46	25.00 ^{+0.12} _{-0.13}
15	39.52	24.79	33.30 ^{+0.15} _{-0.10}
25	53.42	38.50	47.04 ^{+0.13} _{-0.10}
37	69.70	54.96	63.50 ^{+0.13} _{-0.10}

PCB layout: Kat1kGA

Mounting style: Through-hole

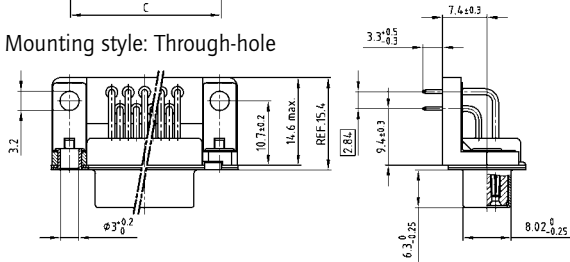

Mounting style: Threaded insert

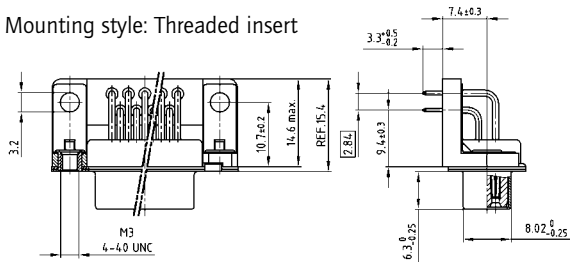

DESCRIPTION

- Mounting styles:
 - Mounting bracket, grounding strap with through-hole Ø .118" / 3.0 mm
 - Mounting bracket, grounding strap with 4-40 UNC or M3 threaded insert
- Quality class 3 (also available in quality class 1)
- Shell: Steel tin plated (brass tin plated on request)

PLUG CONNECTOR

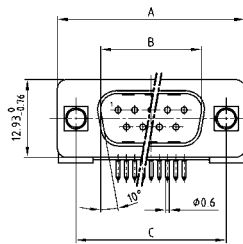

No. of pos.	A -0.76	B +0.25	C	D -0.3
09	31.19	16.79	25.00 ^{+0.12} _{-0.13}	6.12
15	39.52	25.12	33.30 ^{+0.15} _{-0.10}	6.12
25	53.42	38.84	47.04 ^{+0.13} _{-0.10}	5.99
37	69.70	55.30	63.50 ^{+0.13} _{-0.10}	5.99

PCB layout: Kat1kGHA

Mounting style: Through-hole

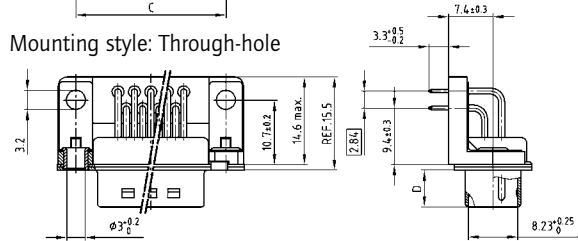

Mounting style: Threaded insert

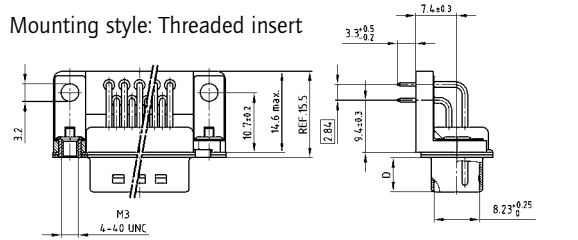

ORDER DATA

Capacitance 180 pF

SOCKET CONNECTOR

No. of pos.	Mounting style	Part Number
09	Through-hole	242 A 16780 X
15	Through-hole	242 A 16790 X
25	Through-hole	242 A 16800 X
37	Through-hole	242 A 16810 X
09	Grounding strap / 4-40 UNC Threaded insert	242 A 16820 X
15	Grounding strap / 4-40 UNC Threaded insert	242 A 16830 X
25	Grounding strap / 4-40 UNC Threaded insert	242 A 16840 X
37	Grounding strap / 4-40 UNC Threaded insert	242 A 16850 X
09	Grounding strap / M3 Threaded insert	242 A 16860 X
15	Grounding strap / M3 Threaded insert	242 A 16870 X
25	Grounding strap / M3 Threaded insert	242 A 16880 X
37	Grounding strap / M3 Threaded insert	242 A 16890 X

PLUG CONNECTOR

No. of pos.	Mounting style	Part Number
09	Through-hole	241 A 19400 X
15	Through-hole	241 A 19410 X
25	Through-hole	241 A 19420 X
37	Through-hole	241 A 19430 X
09	Grounding strap / 4-40 UNC Threaded insert	241 A 19440 X
15	Grounding strap / 4-40 UNC Threaded insert	241 A 19450 X
25	Grounding strap / 4-40 UNC Threaded insert	241 A 19460 X
37	Grounding strap / 4-40 UNC Threaded insert	241 A 19470 X
09	Grounding strap / M3 Threaded insert	241 A 19480 X
15	Grounding strap / M3 Threaded insert	241 A 19490 X
25	Grounding strap / M3 Threaded insert	241 A 19500 X
37	Grounding strap / M3 Threaded insert	241 A 19510 X

C-FILTER D-SUB STANDARD

Solder pin – Angled – .370" / 9.4 mm – Precision machined contacts – Plastic bracket

ORDER DATA

Capacitance 370 pF					
SOCKET CONNECTOR			PLUG CONNECTOR		
No. of pos.	Mounting style	Part Number	No. of pos.	Mounting style	Part Number
09	Through-hole	242 A 10970 X	09	Through-hole	241 A 10970 X
15	Through-hole	242 A 10980 X	15	Through-hole	241 A 10980 X
25	Through-hole	242 A 10990 X	25	Through-hole	241 A 10990 X
37	Through-hole	242 A 11000 X	37	Through-hole	241 A 11000 X
09	Grounding strap / 4-40 UNC Threaded insert	242 A 11090 X	09	Grounding strap / 4-40 UNC Threaded insert	241 A 11090 X
15	Grounding strap / 4-40 UNC Threaded insert	242 A 11100 X	15	Grounding strap / 4-40 UNC Threaded insert	241 A 11100 X
25	Grounding strap / 4-40 UNC Threaded insert	242 A 11110 X	25	Grounding strap / 4-40 UNC Threaded insert	241 A 11110 X
37	Grounding strap / 4-40 UNC Threaded insert	242 A 11120 X	37	Grounding strap / 4-40 UNC Threaded insert	241 A 11120 X
09	Grounding strap / M3 Threaded insert	242 A 11210 X	09	Grounding strap / M3 Threaded insert	241 A 11210 X
15	Grounding strap / M3 Threaded insert	242 A 11220 X	15	Grounding strap / M3 Threaded insert	241 A 11220 X
25	Grounding strap / M3 Threaded insert	242 A 11230 X	25	Grounding strap / M3 Threaded insert	241 A 11230 X
37	Grounding strap / M3 Threaded insert	242 A 11240 X	37	Grounding strap / M3 Threaded insert	241 A 11240 X

Capacitance 830 pF					
SOCKET CONNECTOR			PLUG CONNECTOR		
No. of pos.	Mounting style	Part Number	No. of pos.	Mounting style	Part Number
09	Through-hole	242 A 11050 X	09	Through-hole	241 A 11050 X
15	Through-hole	242 A 11060 X	15	Through-hole	241 A 11060 X
25	Through-hole	242 A 11070 X	25	Through-hole	241 A 11070 X
37	Through-hole	242 A 11080 X	37	Through-hole	241 A 11080 X
09	Grounding strap / 4-40 UNC Threaded insert	242 A 11170 X	09	Grounding strap / 4-40 UNC Threaded insert	241 A 11170 X
15	Grounding strap / 4-40 UNC Threaded insert	242 A 11180 X	15	Grounding strap / 4-40 UNC Threaded insert	241 A 11180 X
25	Grounding strap / 4-40 UNC Threaded insert	242 A 11190 X	25	Grounding strap / 4-40 UNC Threaded insert	241 A 11190 X
37	Grounding strap / 4-40 UNC Threaded insert	242 A 11200 X	37	Grounding strap / 4-40 UNC Threaded insert	241 A 11200 X
09	Grounding strap / M3 Threaded insert	242 A 11290 X	09	Grounding strap / M3 Threaded insert	241 A 11290 X
15	Grounding strap / M3 Threaded insert	242 A 11300 X	15	Grounding strap / M3 Threaded insert	241 A 11300 X
25	Grounding strap / M3 Threaded insert	242 A 11310 X	25	Grounding strap / M3 Threaded insert	241 A 11310 X
37	Grounding strap / M3 Threaded insert	242 A 11320 X	37	Grounding strap / M3 Threaded insert	241 A 11320 X

Capacitance 1300 pF					
SOCKET CONNECTOR			PLUG CONNECTOR		
No. of pos.	Mounting style	Part Number	No. of pos.	Mounting style	Part Number
09	Through-hole	242 A 11010 X	09	Through-hole	241 A 11010 X
15	Through-hole	242 A 11020 X	15	Through-hole	241 A 11020 X
25	Through-hole	242 A 11030 X	25	Through-hole	241 A 11030 X
37	Through-hole	242 A 11040 X	37	Through-hole	241 A 11040 X
09	Grounding strap / 4-40 UNC Threaded insert	242 A 11130 X	09	Grounding strap / 4-40 UNC Threaded insert	241 A 11130 X
15	Grounding strap / 4-40 UNC Threaded insert	242 A 11140 X	15	Grounding strap / 4-40 UNC Threaded insert	241 A 11140 X
25	Grounding strap / 4-40 UNC Threaded insert	242 A 11150 X	25	Grounding strap / 4-40 UNC Threaded insert	241 A 11150 X
37	Grounding strap / 4-40 UNC Threaded insert	242 A 11160 X	37	Grounding strap / 4-40 UNC Threaded insert	241 A 11160 X
09	Grounding strap / M3 Threaded insert	242 A 11250 X	09	Grounding strap / M3 Threaded insert	241 A 11250 X
15	Grounding strap / M3 Threaded insert	242 A 11260 X	15	Grounding strap / M3 Threaded insert	241 A 11260 X
25	Grounding strap / M3 Threaded insert	242 A 11270 X	25	Grounding strap / M3 Threaded insert	241 A 11270 X
37	Grounding strap / M3 Threaded insert	242 A 11280 X	37	Grounding strap / M3 Threaded insert	241 A 11280 X

Mouser Electronics

Authorized Distributor

Click to View Pricing, Inventory, Delivery & Lifecycle Information:

CONEC:

<u>241A11060X</u>	<u>242A11290X</u>	<u>241A11000X</u>	<u>241A10980X</u>	<u>241A11160X</u>	<u>241A11230X</u>	<u>241A11320X</u>	<u>241A11130X</u>
<u>242A11070X</u>	<u>242A11040X</u>	<u>242A11120X</u>	<u>242A11210X</u>	<u>242A10980X</u>	<u>242A11050X</u>	<u>242A11220X</u>	<u>242A11080X</u>
<u>242A11170X</u>	<u>242A11090X</u>	<u>242A11000X</u>	<u>242A11160X</u>	<u>242A11240X</u>	<u>242A11250X</u>	<u>242A11060X</u>	<u>242A11140X</u>
<u>242A11230X</u>	<u>242A11310X</u>	<u>242A16860X</u>	<u>242A11280X</u>	<u>242A11180X</u>	<u>242A11270X</u>	<u>241A19490X</u>	<u>241A19500X</u>
<u>241A19460X</u>	<u>241A11080X</u>	<u>241A11090X</u>	<u>241A11170X</u>	<u>241A11250X</u>	<u>241A19430X</u>	<u>242A16840X</u>	<u>242A16800X</u>
<u>242A16870X</u>	<u>242A16880X</u>	<u>242A16830X</u>	<u>242A16780X</u>	<u>242A16850X</u>	<u>242A16810X</u>	<u>242A16820X</u>	<u>242A16890X</u>
<u>242A11030X</u>	<u>242A11110X</u>	<u>242A11200X</u>	<u>241A11300X</u>	<u>241A11150X</u>	<u>241A11030X</u>	<u>241A11110X</u>	<u>241A11190X</u>
<u>241A19450X</u>	<u>241A19400X</u>	<u>241A19510X</u>	<u>241A19440X</u>	<u>241A19420X</u>	<u>241A19470X</u>	<u>241A19480X</u>	<u>242A10970X</u>
<u>242A11150X</u>	<u>242A11300X</u>	<u>242A11010X</u>	<u>242A11020X</u>	<u>242A11100X</u>	<u>242A11190X</u>	<u>241A11010X</u>	<u>241A11100X</u>
<u>241A11180X</u>	<u>241A11260X</u>	<u>241A11020X</u>	<u>241A11200X</u>	<u>241A11280X</u>	<u>241A11140X</u>	<u>241A11220X</u>	<u>241A11070X</u>
<u>241A11240X</u>	<u>241A11310X</u>	<u>241A10970X</u>	<u>241A11040X</u>	<u>241A11050X</u>	<u>241A11210X</u>	<u>241A11120X</u>	