

4

3

2

1

used for:

D-SUB

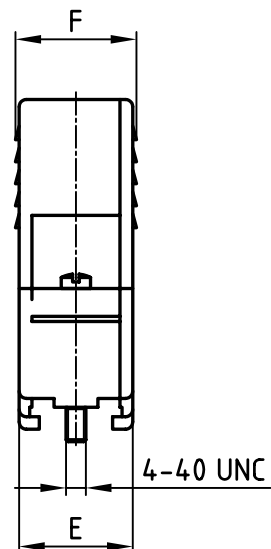
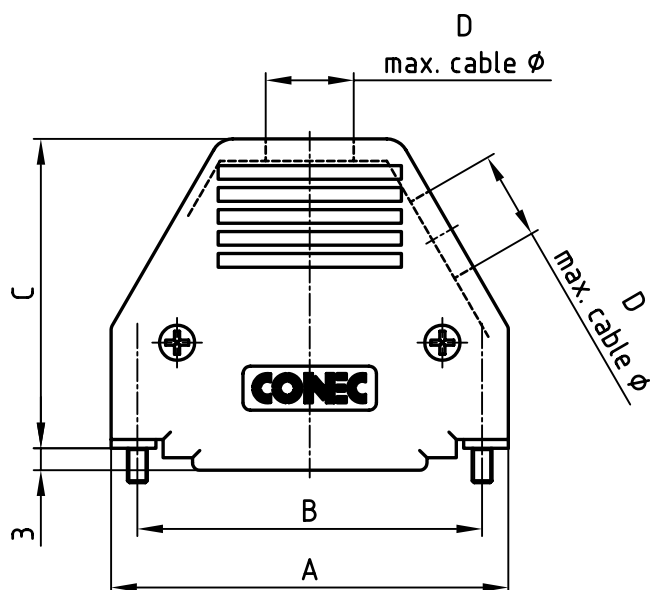

(b)

| POS. | A    | B    | C    | D<br>max. cable ø | E    | F    | Part No.<br>Single package |
|------|------|------|------|-------------------|------|------|----------------------------|
| 9    | 32.0 | 25.0 | 36.7 | 6.3               | 15.5 | 16.5 | 165X11319XE                |
| 15   | 40.0 | 33.3 | 38.2 | 8.0               | 15.5 | 16.5 | 165X11329XE                |
| 25   | 54.2 | 47.0 | 42.2 | 10.5              | 15.5 | 16.5 | 165X11339XE                |
| 37   | 70.6 | 63.5 | 47.2 | 11.5              | 15.5 | 16.5 | 165X11349XE                |

## NOTES:

- HOOD + COVER: ABS UL 94 V-0, METALLIZED
- BLIND PLUG: ABS UL 94 V-0, METALLIZED
- CABLE STRAIN RELIEF: STEEL; NICKEL PLATED
- COUNTERSUNK HEAD SCREW: STEEL; NICKEL PLATED
- JACKSCREW: BRASS; NICKEL PLATED

Directive 2002/95/EC  
"RoHS"  
Compliant

THIS DRAWING MAY NOT BE COPIED OR  
REPRODUCED IN ANY WAY, AND MAY NOT  
BE PASSED ON TO A THIRD PARTY WITHOUT  
WRITTEN PERMISSION.  
OWNERSHIP AND COPYRIGHT OF CONEC GmbH  
DO NOT ALTER CAD DRAWING BY HAND

|       |             |            |        | tolerance |        |              |
|-------|-------------|------------|--------|-----------|--------|--------------|
| 1 x b | Ä 2607      | 21.11.2006 | Lehmen | 2006      | date   |              |
| a     | Origin      |            |        | drawn     | 07.02. | Lehmenkühler |
| rev.  | description | date       | name   | appd.     | 07.02. | Mickenbecker |
|       |             |            |        | norm      |        |              |
|       |             |            |        | d-old     |        |              |

**CONEC**®

|           |  |
|-----------|--|
| scale:    | 1:1  |
| material: | SEE NOTES  |
| title:    | <b>PLASTIC HOOD</b><br>9-37pos. WITH TOP AND SIDE CABLE EXIT<br>with jack screws |
| dwg no:   | AutoCAD 2004   |
| part no:  | SEE TABLE  |
|           | DIN-A<br>4<br>sh: 1/1  |

4

3

2

1

# Mouser Electronics

Authorized Distributor

Click to View Pricing, Inventory, Delivery & Lifecycle Information:

[CONEC:](#)

[165X11349XE](#)