



BRIGHT LED ELECTRONICS CORP.

Total Page: 6
Page: 1
Revision: 2.0

- Customer P/N:
- Device Number : BPI-3C1-05
- Features:
 - Non-contact switching.
 - For direct PC board or dual-in-line socket mounting.
 - Fast switching speed.
 - This product doesn't contain restriction substance, comply ROHS standard.

| Sheet Date | 1 | 2 | 3 | 4 | 5 | 6 | Contents |
|---------------|-----|-----|-----|-----|-----|-----|--|
| 2001.12.20 | 1.0 | 1.0 | 1.0 | 1.0 | 1.0 | 1.0 | Initial Released |
| 2002.01.08 | 1.1 | 1.0 | 1.1 | 1.0 | 1.0 | 1.1 | Packaging Dimensions: Pin Length: 9.12mm→3.5mm 2. Packaging Bag Dimensions |
| 2002.03.21 | 1.2 | 1.1 | 1.1 | 1.0 | 1.0 | 1.1 | Light Current: IL: max 10Ma→5Ma |
| 2002.12.12 | 1.3 | 1.0 | 1.2 | 1.1 | 1.0 | 1.2 | Packaging Dimensions: Slit Width 1.1mm→0.4mm 2. Packaging Bag Dimensions |
| 2004.10.26 | 1.4 | -- | - | - | - | - | Features |
| 2004.11.26 | 2.0 | 1.0 | 1.2 | 1.1 | 1.0 | 1.3 | Packaging |

| | | | | | | | | | | | | | | | | | | | |
|------------|---|--|--|--|--|--|--|--|--|--|--|--|--|--|--|--|--|--|--|
| Total Page | 6 | | | | | | | | | | | | | | | | | | |
|------------|---|--|--|--|--|--|--|--|--|--|--|--|--|--|--|--|--|--|--|

佰鴻工業股份有限公司

BRIGHT LED ELECTRONICS CORP.

台北縣板橋市和平路 19 號 3 樓
3F., No. 19, Ho Ping Road, Pan Chiao City,
Taipei, Taiwan, R. O. C.

Tel: 886-2-29591090

Fax: 886-2-29547006/29558809

www.brtled.com

廣東省東莞市高步鎮蘆溪管理區高龍東路號
No.8 Gaolong eastwayLuxiprecinctGaobu
Town Dongguan city Guangdong Province
China

Tel : 886-0769-8730255 8731855

Fax : 886-0769-8733355 8738706

www.brtled.com

| Approved | Checked | Drawn |
|---------------------------|---------------------------|--------------------------|
| 郝 2004.11.26 志群 | 郝 2004.11.26 志群 | 彭 2004.11.26 洁 |

BRIGHT LED ELECTRONICS

- Device Number : BPI-3C1-05
- Absolute Maximum Rating (Ta=25°C)

Page: 2
Version: 1.1

| Item | | Symbol | Rating | Unit |
|----------------------------|-----------------------------|------------------|------------|------|
| Input | Power Dissipation | Pd | 75 | mW |
| | Reverse Voltage | V _R | 5 | V |
| | Forward Current | I _F | 50 | mA |
| | Peak Forward Current (*1) | I _{FP} | 1 | A |
| Output | Collector Power Dissipation | P _C | 100 | mW |
| | Collector Current | I _C | 40 | mA |
| | C-E Voltage | V _{CEO} | 30 | V |
| | E-C Voltage | V _{ECO} | 5 | V |
| Operating Temperature | | Topr | -25 ~ +85 | °C |
| Storage Temperature | | Tstg | -40 ~ +100 | °C |
| Soldering Temperature (*2) | | Tsol | 260 | °C |

(*1) tw=100 uSec. · T=10 mSec.

(*2) t=5 Sec

- Electrical Optical Characteristics (Ta=25°C)

| Parameter | | Symbol | Condition | Min. | Typ. | Max. | Unit |
|---------------|------------------------|----------------------|--|------|------|------|------|
| Input | Forward Voltage | V _F | I _F =20mA | — | 1.2 | 1.5 | V |
| | Reverse Current | I _R | V _R =5V | — | — | 100 | μA |
| | Peak Wavelength | λ _p | I _F =10mA | | 940 | | nm |
| Output | Dark Current | I _D | V _{CE} =10V | — | — | 100 | nA |
| | C-E Saturation Voltage | V _{CE(sat)} | I _C =0.25mA I _F =10mA | — | — | 0.4 | V |
| Light Current | | I _L | V _{CE} =5V I _F =10mA | 0.5 | — | 5.0 | mA |
| Speed | Rise Time | Tr | I _{FP} =20mA V _{CE} =5V | — | 20 | — | μsec |
| | Fall Time | Tf | R _L =1000Ω | — | 20 | — | μsec |

BRIGHT LED ELECTRONICS

- Device Number : BPI-3C1-05
- Package Dimensions

Page: 3
Version: 1.2

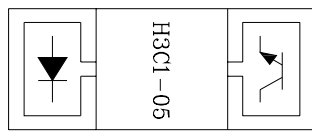

Top View

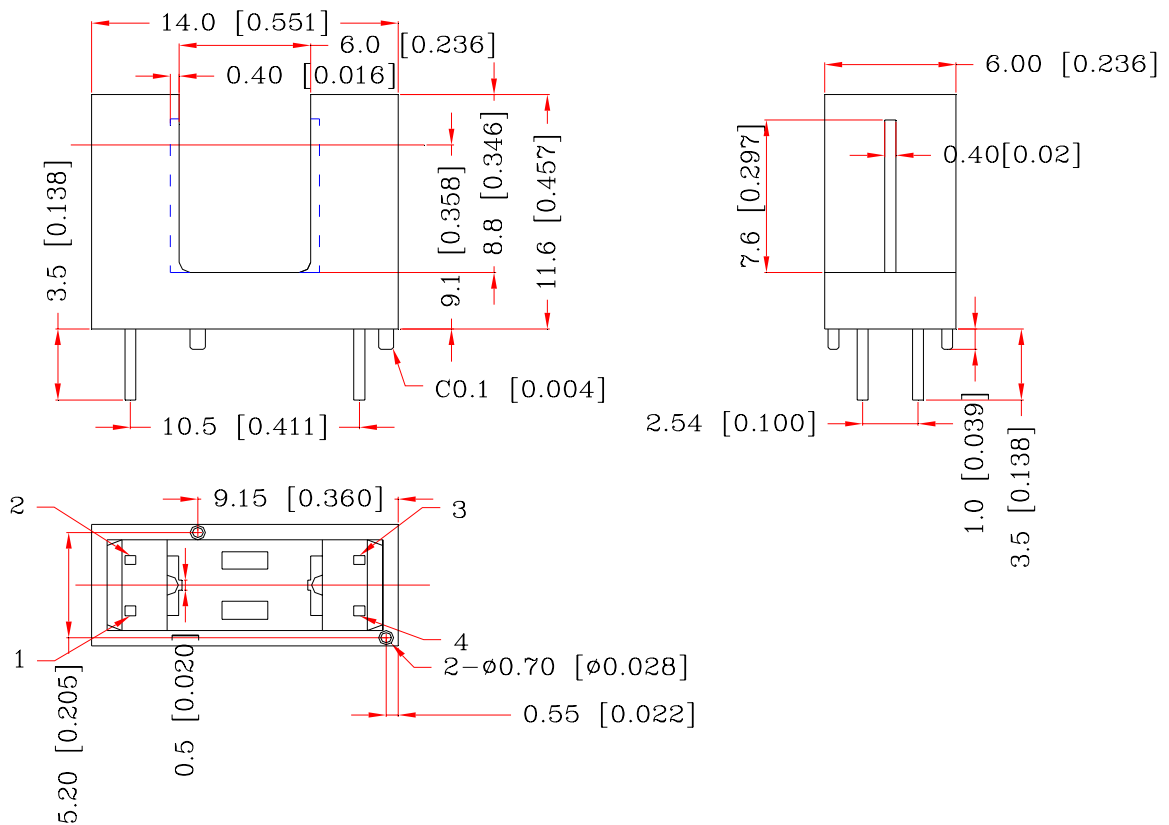
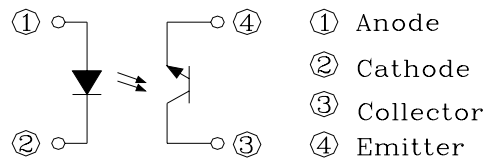

Notes:

1. All dimensions are in millimeters (inches).
2. Tolerance is ± 0.25 mm unless otherwise specified.
3. Lead spacing is measured where the leads emerge from the package.
4. Specifications are subject to change without notice.

BRIGHT LED ELECTRONICS

- Device Number : BPI-3C1-05
- Typical Electrical / Optical Characteristics Curves (Ta=25°C)

Page: 4
Version: 1.0

Fig.1 Power Dissipation vs. Ambient Temperature

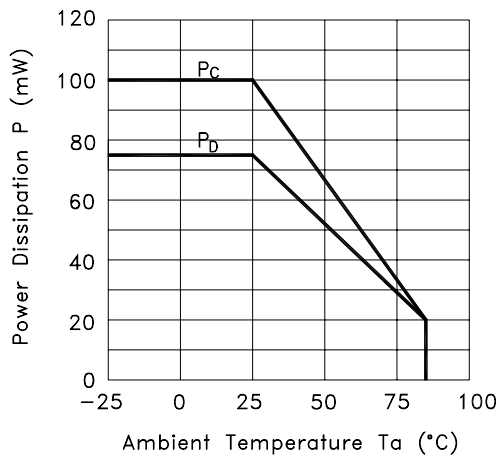

Fig.2 Forward Current vs. Forward Voltage

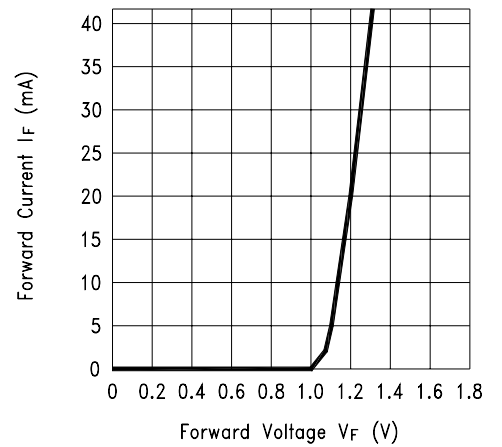

Fig.3 Collector Current vs. Collector-emitter Voltage

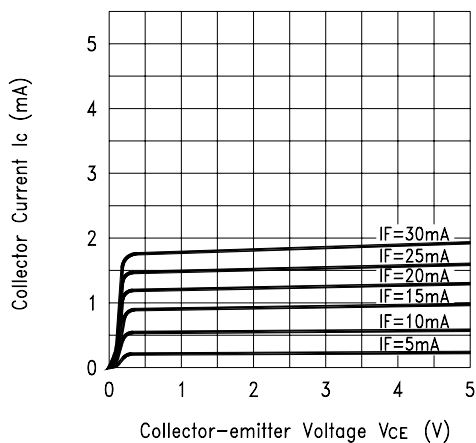
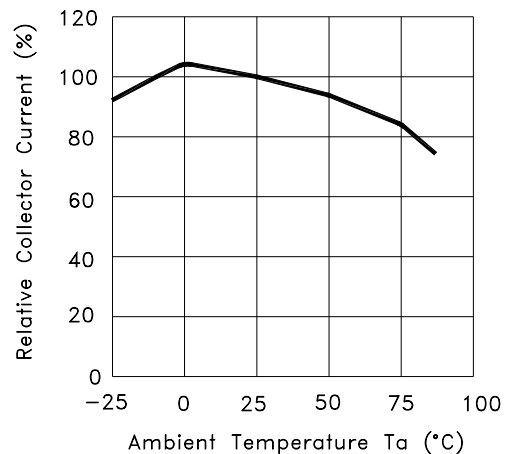

Fig.4 Collector Current vs. Ambient Temperature



BRIGHT LED ELECTRONICS

- Device Number : BPI-3C1-05
- Typical Electric / Optical Characteristics Curves ($T_a=25^\circ\text{C}$)

Page: 5
Version: 1.0

Fig.5 Collector-emitter Saturation Voltage vs. Ambient Temperature

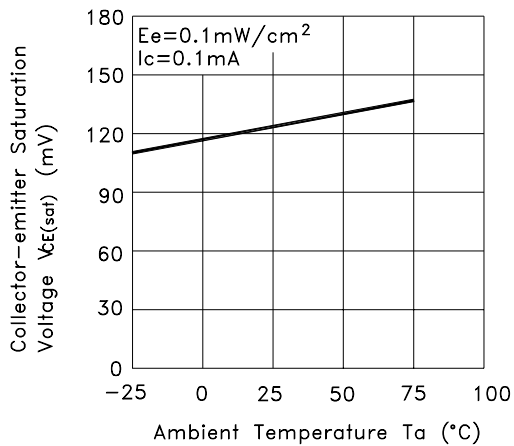

Fig.6 Response Time vs. Load Resistance

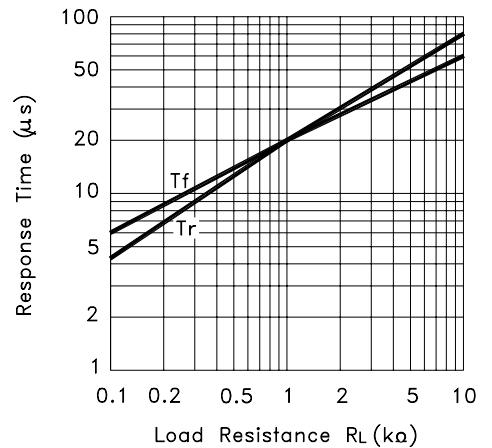
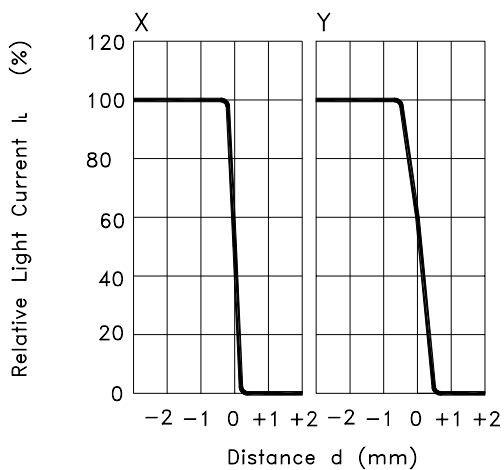
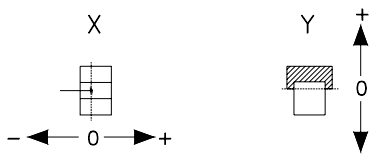

Fig.7 Sensing Position Characteristics (Typical)



(Center of Optical axis)



Test Circuit for Response Time

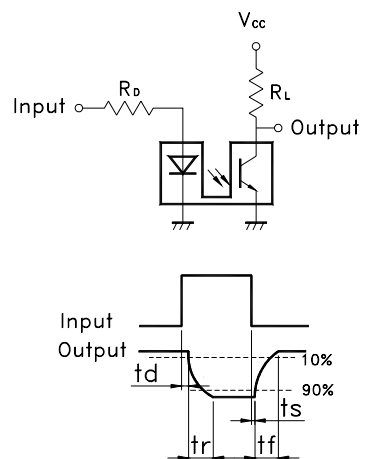

BRIGHT LED ELECTRONICS

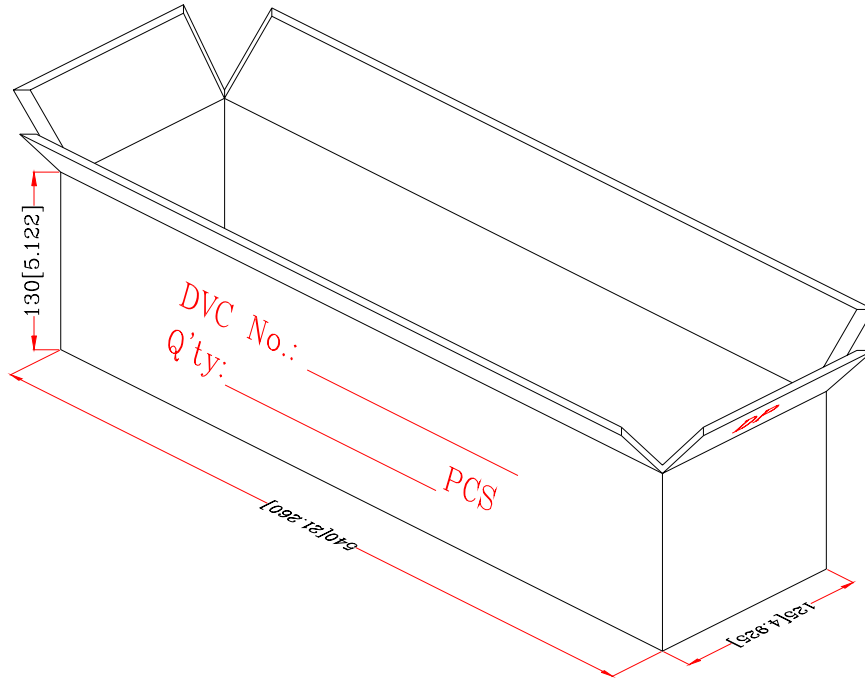

- Device Number : BPI-3C1-05
- Packaging Box Dimensions

Page: 6
Version: 1.3

- Packaging Tube Dimensions

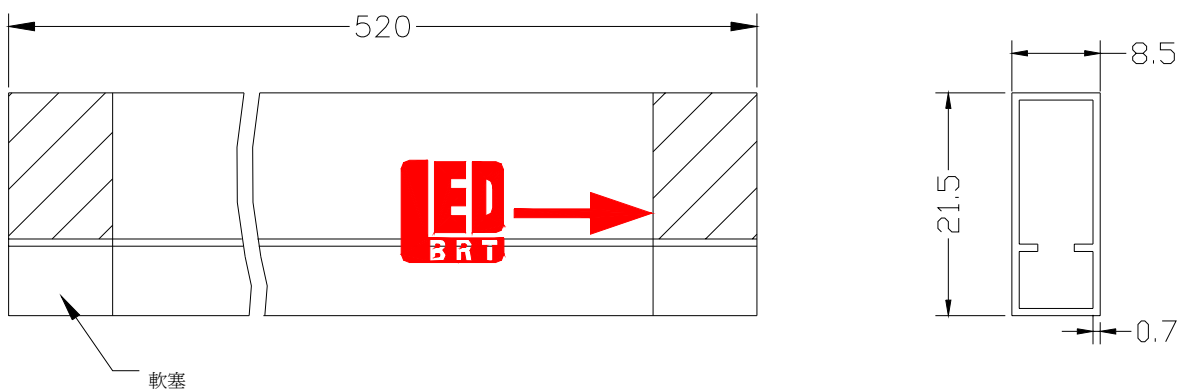

Notes:

1. 35pcs per tube, 2.73kpcs per box.
2. All Dimensions are in millimeters (inches).
3. Specifications are subject to change without notice.

Mouser Electronics

Authorized Distributor

Click to View Pricing, Inventory, Delivery & Lifecycle Information:

[American Bright LED:](#)

[BPI-3C1-05](#)