

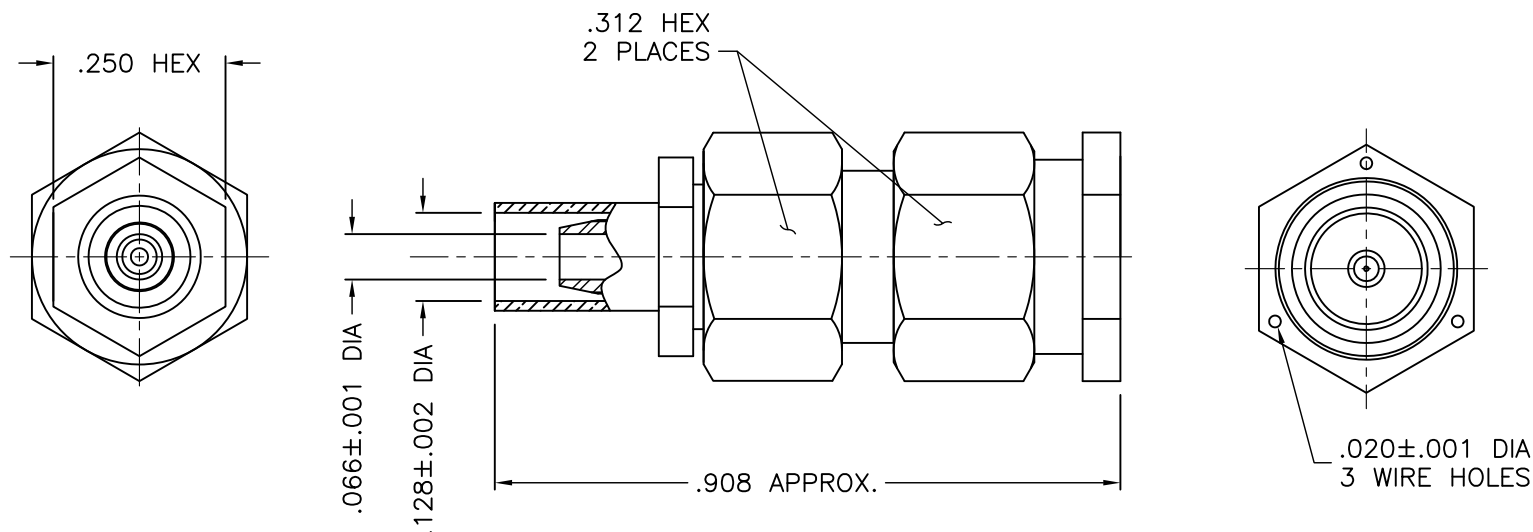

1301-037-K00E



NOTES:

1. ASSEMBLED CONNECTOR INTERFACE IS DESIGNED IN ACCORDANCE WITH MIL-STD-348.
2. MATERIAL: CONTACT - BRASS PER ASTM B16
INSULATOR - TEFLON PER ASTM D4894
GASKET - SILICONE RUBBER PER A-A-59588
CRIMP SLEEVE - D.H.P. COPPER CDA ALLOY 122
ALL OTHER METAL PARTS - CORROSION RESISTANT STEEL PER ASTM A582
3. FINISHES: CONTACT, CLAMP & SOLDER SLEEVE - GOLD PLATE PER ASTM B488
ALL OTHER METAL PARTS - PASSIVATE PER QQ-P-35

UNLESS OTHERWISE SPECIFIED: TOLERANCES: 3 PLACES = $\pm .005$, 2 PLACES = $\pm .02$, ANGLES = $\pm 1/2^\circ$, SURFACE FINISH = 63

THESE DRAWINGS AND SPECIFICATIONS ARE THE PROPERTY OF DELTA ELECTRONICS MFG CORP. AND SHALL NOT BE REPRODUCED, OR COPIED OR USED AS THE BASIS FOR THE MANUFACTURE OR SALE OF APPARATUS OR DEVICES WITHOUT THEIR EXPRESS WRITTEN CONSENT.

M39012/55-3007

DELTA ELECTRONICS MFG. CORP. Beverly, MA 01915

TITLE: 'SMA' SOLDER SLEEVE PLUG
RG-188 & 316/U CABLES

Drawn by BJM 2/7/08	Scale 4/1	Ckd. by MR	Engr Appd MR	FILE NAME: 1301037K00E-000T
---------------------------	--------------	---------------	-----------------	--------------------------------

CODE IDENT.-00795

1301-037-K00E

Mouser Electronics

Authorized Distributor

Click to View Pricing, Inventory, Delivery & Lifecycle Information:

Delta:

1301037K00E-000