

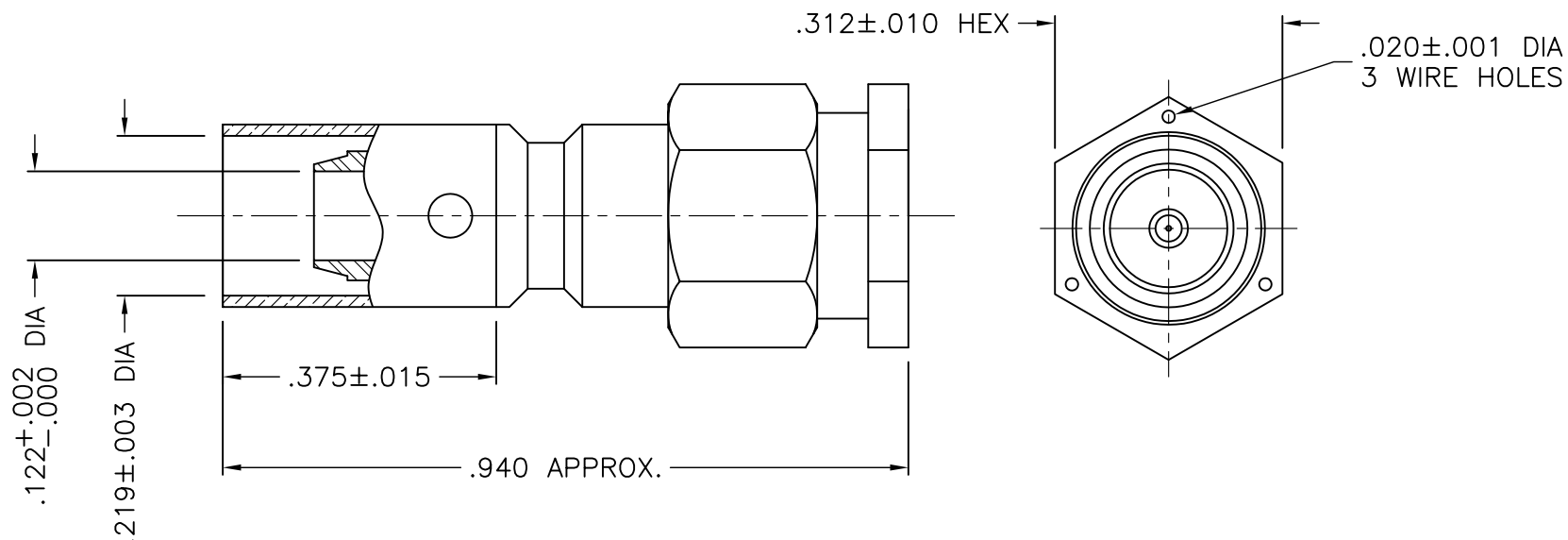

1301-015-K00E



NOTES:

1. ASSEMBLED CONNECTOR INTERFACE IS DESIGNED IN ACCORDANCE WITH MIL-STD-348.
2. MATERIAL: BODY & HEX COUPLING NUT- CORROSION RESISTANT STEEL PER ASTM A582
CONTACT - BERYLLIUM COPPER PER ASTM B196.
INSULATOR - TEFLON PER ASTM D4894
GASKET - SILICONE RUBBER PER A-A-59588
SOLDER SLEEVE - D.H.P. COPPER CDA ALLOY 122
3. FINISHES: CONTACT, BODY, & SOLDER SLEEVE - GOLD PLATE PER ASTM B488
COUPLING NUT - PASSIVATE PER AMS-QQ-P-35

M39012/55-3009

UNLESS OTHERWISE SPECIFIED: TOLERANCES: 3 PLACES = ± 0.005 , 2 PLACES = ± 0.02 , ANGLES = $\pm 1/2^\circ$, SURFACE FINISH = 63

-	OUTLINE	3/22/05
ALT.	REVISIONS	DATE

Drawn by BJM	Scale 4/1	Ckd. by MR	Engr Appd MR	FILE NAME: 1301015K00E-000T
3/22/05				

THESE DRAWINGS AND SPECIFICATIONS ARE THE PROPERTY OF DELTA ELECTRONICS MFG CORP. AND SHALL NOT BE REPRODUCED, OR COPIED OR USED AS THE BASIS FOR THE MANUFACTURE OR SALE OF APPARATUS OR DEVICES WITHOUT THEIR EXPRESS WRITTEN CONSENT.

CODE IDENT.-00795

1301-015-K00E

Mouser Electronics

Authorized Distributor

Click to View Pricing, Inventory, Delivery & Lifecycle Information:

Delta:

[1301015K00E-000](#)