

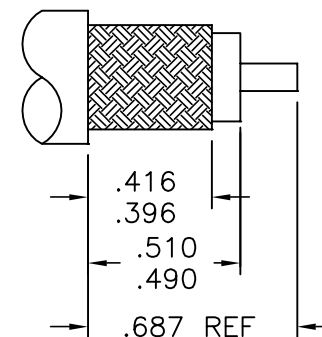

1103-018-A00E

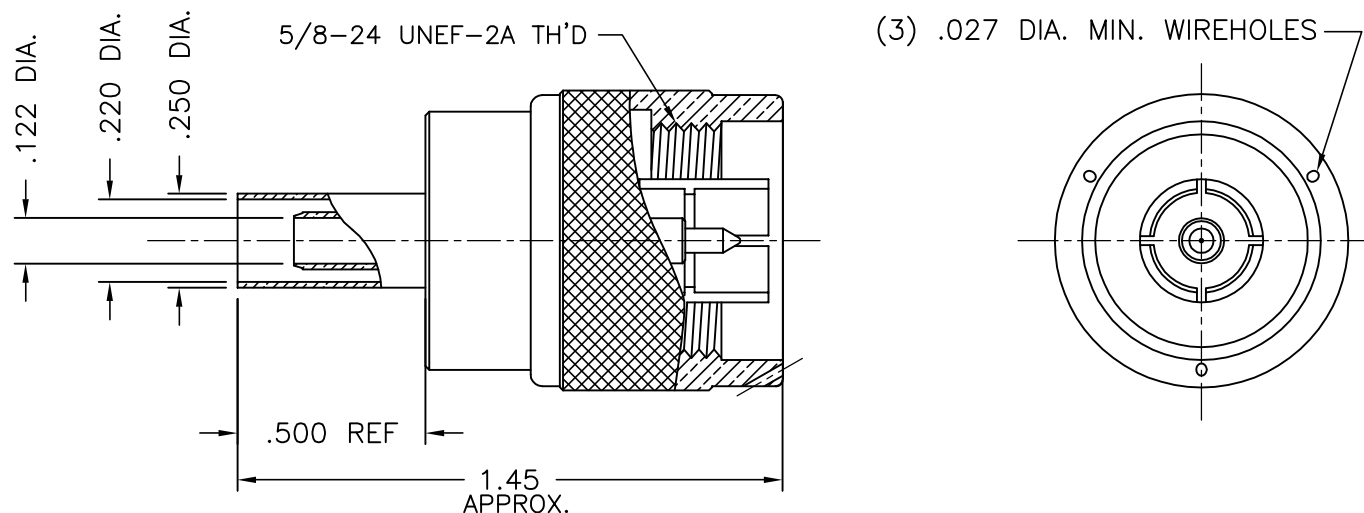

CABLE CUTTING DIMENSIONS

NOTES:

1. ASSEMBLED CONNECTOR INTERFACE IS DESIGNED IN ACCORDANCE WITH MIL-STD-348.
2. MATERIAL: ALL METAL PARTS ARE - BRASS PER ASTM B16, EXCEPT
SNAP RING - PHOSPHOR BRONZE PER QQ-P-330
CRIMP SLEEVE - D.H.P. COPPER CDA ALLOY 122
GASKET - SILICONE RUBBER PER ZZ-R-765
INSULATOR - TEFLON PER ASTM D1710
3. FINISHES: ALL METAL PARTS ARE - SILVER PLATE PER QQ-S-365
CONTACT - GOLD PLATE PER MIL-G-45204
4. RECOMMENDED CRIMP TOOL: M22520/5-01 WITH CRIMP DIE M22520/5-19 CLOSURE B (.213 HEX).

A	REVISED	1/7/03
-	OUTLINE	10/2/96
ALT.	REVISIONS	DATE

UNLESS OTHERWISE SPECIFIED: TOLERANCES: 3 PLACES = $\pm .005$, 2 PLACES = $\pm .02$, ANGLES = $\pm 1/2^\circ$, SURFACE FINISH = 63

THESE DRAWINGS AND SPECIFICATIONS ARE THE PROPERTY OF DELTA ELECTRONICS MFG CORP. AND SHALL NOT BE REPRODUCED, OR COPIED OR USED AS THE BASIS FOR THE MANUFACTURE OR SALE OF APPARATUS OR DEVICES WITHOUT THEIR EXPRESS WRITTEN CONSENT.

M39012/01-0503

DELTA ELECTRONICS MFG. CORP. Beverly, MA 01915

TITLE: 'N' CRIMP TYPE PLUG W/CAPTIVE CONTACT
FOR RG-142, 223, 400/U CABLE

Drawn by RWP	Scale 2/1	Ckd. by	Engr Appd	FILE NAME: 1103018A00E-000T
10/2/96				

CODE IDENT.-00795

1103-018-A00E

Mouser Electronics

Authorized Distributor

Click to View Pricing, Inventory, Delivery & Lifecycle Information:

Delta:

1103018A00E-000