

THIS IS ISSUED IN STRICT CONFIDENCE THAT IT IS NOT USED AS A BASIS FOR MANUFACTURE OR SALE AND THAT IT IS NOT COPIED, REPRINTED OR DISCLOSED TO A THIRD PARTY EITHER WHOLLY OR IN PART WITHOUT THE PRIOR WRITTEN CONSENT OF CAL TEST ELECTRONICS, INC.

REVISIONS			
REV.	DESCRIPTIONS	DATE	APPROVED
—	CLASS A RELEASED	7/12/99	

1. 4mm UNINSULATED SOCKET (JACK) w/ \varnothing .080 (\varnothing 2.0) SOLDER HOLE.
2. SPECIFICATIONS:
SOCKET BODY: BRASS, NICKEL PLATED.
3. RATING:
CURRENT: 36A MAX.
TEMPERATURE: -20° C TO $+150^{\circ}$ C.
4. MOUNTING HOLE: REFERENCE DIAGRAM.
5. MAXIMUM PANEL THICKNESS: .50 (12.7)

PART NUMBER
CT2220

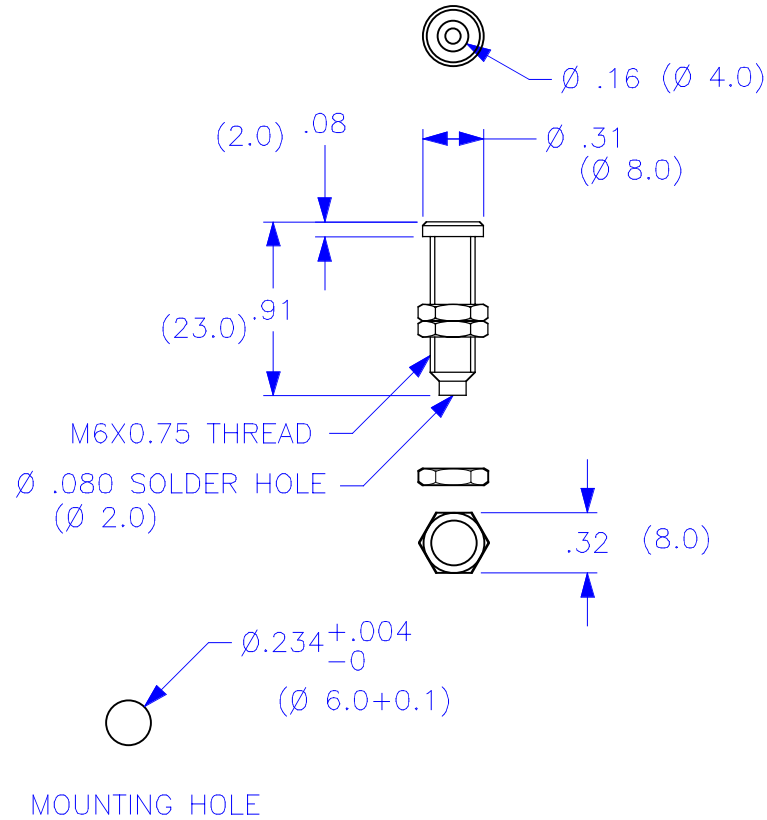

THIRD ANGLE PROJECTION		UNLESS OTHERWISE SPECIFIED DIMENSIONS ARE IN INCHES TOLERANCES ARE: FRACTIONS DECIMALS $\pm 1/32$.XX \pm .02 .XXX \pm .005 DO NOT SCALE DRAWING		CONTRACT NO.		Cal Test Electronics 22820 Savi Ranch Parkway Yorba Linda, CA 92887-4610			
		MATERIAL		APPROVALS		DATE		TITLE 4mm SOCKET, UNINSULATED	
		FINISH		DRAWN WDH		7/12/99			
NEXT ASSY		USED ON		ENGR.		SIZE A		CAGE CODE	
APPLICATION				DESIGN ACTIVITY		DWG. NO. P222000		REV. —	
						SCALE 1:1		SHEET 1 OF 1	

Mouser Electronics

Authorized Distributor

Click to View Pricing, Inventory, Delivery & Lifecycle Information:

[Cal Test Electronics:](#)

[CT2220](#)