

REV/ISSUES				
REV	ECOA	DESCRIPTION	BY	APP'D
STAMP	NUMBER		DATE	DATE
1		ORIGINAL RELEASE	6/14/88	6/14/88

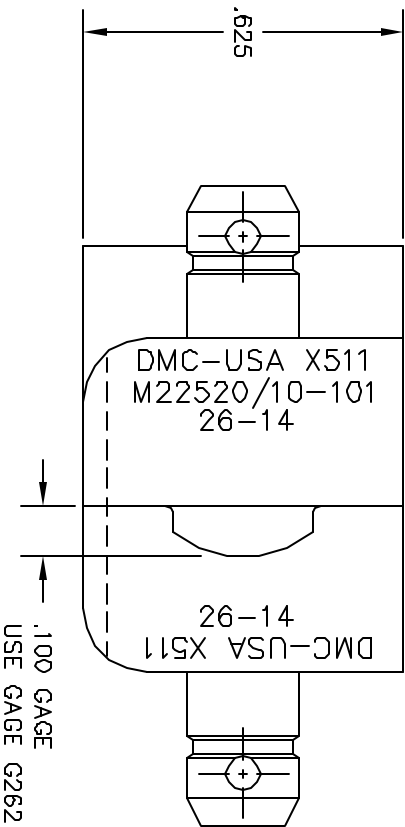

UNCONTROLLED DOCUMENT
WILL NOT BE UPDATED

RESTRICTED & CONFIDENTIAL				
CONFIDENTIAL PROPERTY OF DANIEL'S MANUFACTURING CORP. NO PART OF THIS DOCUMENT IS TO BE REPRODUCED OR USED FOR ANY OTHER PURPOSES EXCEPT AS AUTHORIZED IN WRITING BY DANIEL'S MANUFACTURING. THIS DRAWING IS THE PROPERTY OF DANIEL'S MANUFACTURING CORP. ON COMPLETION OF ORDER OR DELIVERY OF PARTS, THIS DRAWING IS TO BE RETURNED TO DANIEL'S MANUFACTURING CORP.				
MATERIAL		ITEM	PART NO.	QTY.
HEAT TREAT		DATE	DATE	DATE
FINISH		DATE	DATE	DATE
DO NOT SCALE DRAWING		DATE	DATE	DATE
TITLE		DATE	DATE	DATE
WHERE USED		DATE	DATE	DATE
SIZE		DATE	DATE	DATE
SCALE		DATE	DATE	DATE
POSTING		DATE	DATE	DATE
P/N		DATE	DATE	DATE
X511-ENV		DATE	DATE	DATE
X511-ENV		DATE	DATE	DATE
SHEET		DATE	DATE	DATE
OF		DATE	DATE	DATE
1		DATE	DATE	DATE
REV		DATE	DATE	DATE
1		DATE	DATE	DATE

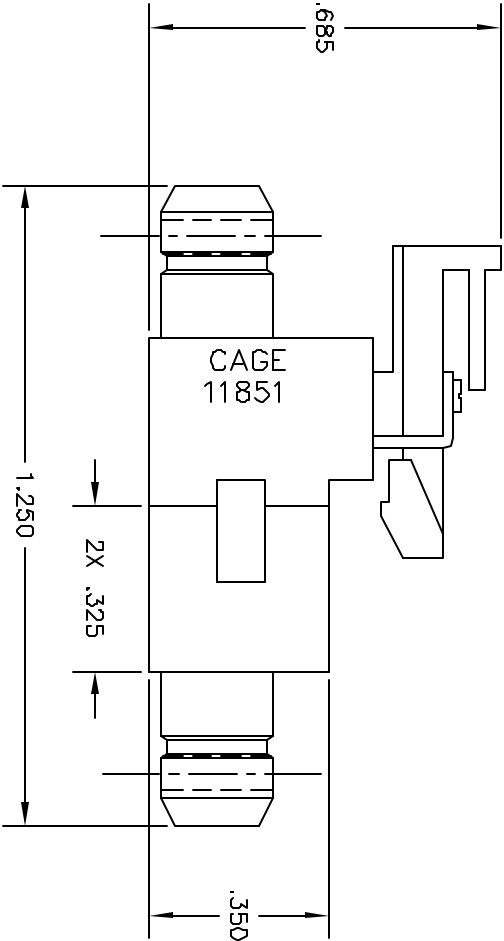

DANIEL'S MANUFACTURING CORP.
ORLANDO, FLORIDA
CAGE 11851

DIE SET
ENVELOPE DRAWING
(M22520/10-101)

Mouser Electronics

Authorized Distributor

Click to View Pricing, Inventory, Delivery & Lifecycle Information:

[Daniels Manufacturing:](#)

[X511](#)