

REVISIONS				
REV. SYM.	E.C.O. NUMBER	DESCRIPTION	BY DATE	APP'D DATE
1		ORIGINAL RELEASE	JMJ 3/16/04	RRR 3/16/04

UNCONTROLLED DOCUMENT
WILL NOT BE UPDATED

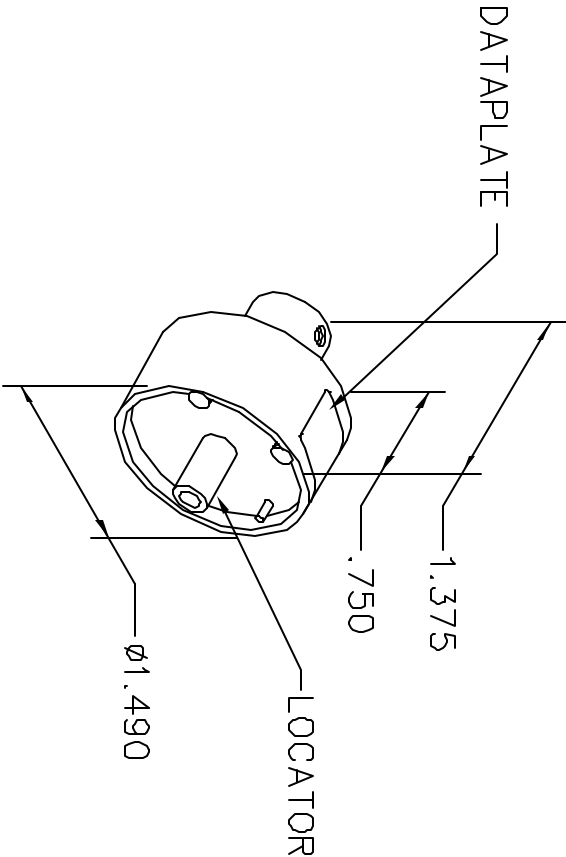

CONTACTS CKB	0.22	0.38	0.60	0.93	1.34	1.91	2.50	mm 2
S1545-0008-B	P	2	3	4	5			SEL NO
S1545-0009-B	S							
S1545-0007-B	P			4	5	6	7	
S1545-0005-B	S							
S1545-0006-B	P				6	7	8	
S1545-0004-B	S							

DATAPLATE

LOCATOR	
HOLE DIMENSIONS	ADDITIONAL FEATURES
ø.187	└┐ ø.203
▽ 1.14 MIN.	▽ .160

<div>RESTRICTED & CONFIDENTIAL</div> <div> CONFIDENTIAL PROPERTY OF DANIELS MANUFACTURING CORP. NOT TO BE DISCLOSED TO OTHERS. REPRODUCED OR USED FOR ANY OTHER PURPOSE, EXCEPT AS AUTHORIZED IN WRITING BY DANIELS MANUFACTURING. MUST BE RETURNED TO DANIELS MANUFACTURING CORP. ON COMPLETION OF ORDER OR OTHER PURPOSE FOR WHICH LENT. </div>		<div> DRN. J. JOYCE CHK'D. RRR APP'D. DATE DATE DATE </div>		<div> TITLE SINGLE POSITION HEAD ENVELOPE DRAWING </div>	
<div>DO NOT SCALE DRAWING</div>		<div> NOTE: THIS DRAWING IS AN OUTLINE DRAWING OF THE RESPECTIVE DMC PART NUMBER INDICATED. ACTUAL DMC PART NUMBER IS DRAWING NUMBER WITHOUT THE " -ENV " SUFFIX. </div>		<div> WHERE USED: AFB SIZE SCALE A NTS POSTING DWG. NO. TP900-1-ENV SHEET 1 OF 1 REV. 1 </div>	

DANIELS MANUFACTURING CORP.
ORLANDO, FLORIDA
CAGE 11851

Mouser Electronics

Authorized Distributor

Click to View Pricing, Inventory, Delivery & Lifecycle Information:

[Daniels Manufacturing:](#)

[TP900-1](#)