

REVISIONS				
REV. SYM.	E.C.D. NUMBER	DESCRIPTION	BY DATE	APP'D DATE
1		ORIGINAL RELEASE	JMU 10/8/04	RRR 10/8/04

UNCONTROLLED DOCUMENT
WILL NOT BE UPDATED

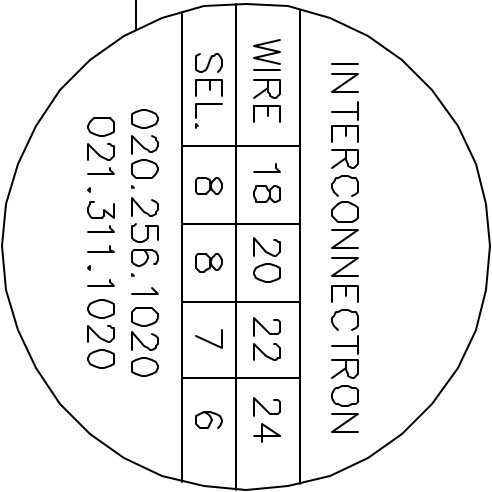
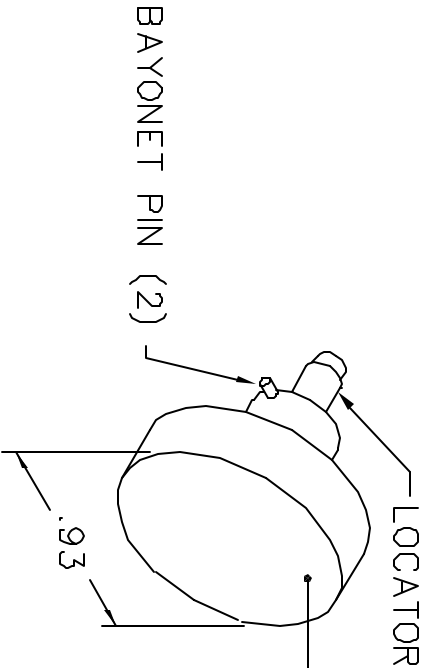
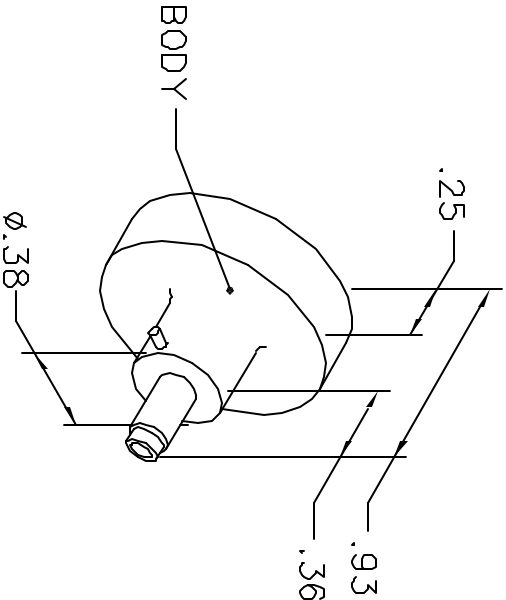

NOTE: FOR USE WITH DANIELS CRIMP TOOL, AFM8.

LOCATOR	
HOLE DIMENSIONS	ADDITIONAL FEATURES
Ø.045	└┐ Ø.084
±.58 MIN.	±.366

RESTRICTED & CONFIDENTIAL
CONFIDENTIAL PROPERTY OF DANIELS MANUFACTURING CORP. NOT TO BE DISCLOSED TO OTHERS, REPRODUCED OR USED FOR ANY OTHER PURPOSE, EXCEPT AS AUTHORIZED IN WRITING BY DANIELS MANUFACTURING. MUST BE RETURNED TO DANIELS MANUFACTURING CORP. ON COMPLETION OF ORDER OR OTHER PURPOSE FOR WHICH LENT.
DO NOT SCALE DRAWING

DRN. J. JOYCE	DATE 10/8/04	<div> DANIELS MANUFACTURING CORP. ORLANDO, FLORIDA CAGE 11851 </div>	
CHKD. RRR	DATE 10/8/04		
APP'D.	DATE		
APP'D.	DATE	NOTE: THIS DRAWING IS AN OUTLINE DRAWING OF THE RESPECTIVE DMC PART NUMBER INDICATED. ACTUAL DMC PART NUMBER IS DRAWING NUMBER WITHOUT THE "-ENV" SUFFIX.	
TITLE		POSITIONER ENVELOPE DRAWING	
WHERE USED:		SIZE SCALE CAD P/N SHEET OF A NTS K1536-ENV 1 1 POSTING DWG. NO. K1536-ENV REV. 1	

Mouser Electronics

Authorized Distributor

Click to View Pricing, Inventory, Delivery & Lifecycle Information:

[Daniels Manufacturing:](#)

[K1536](#)