

REVISIONS				
REV. SYM.	E.C.O. NUMBER	DESCRIPTION	BY DATE	APP'D DATE
1		ORIGINAL RELEASE	AAM 4-19-99	RRR 4-19-99

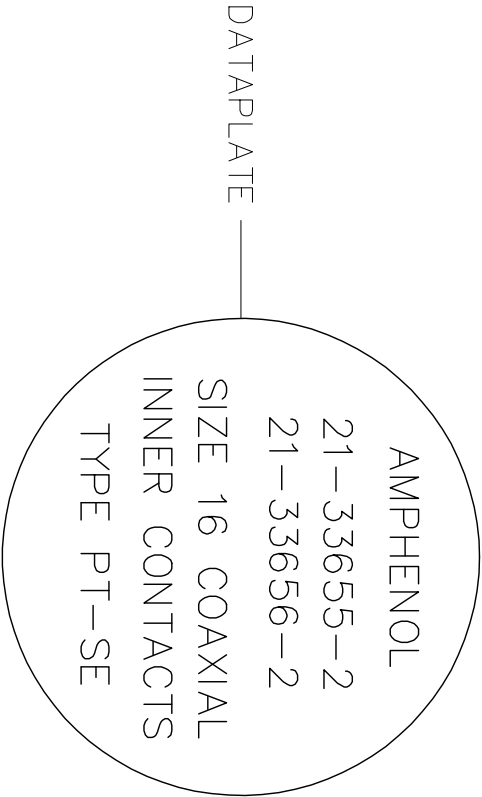
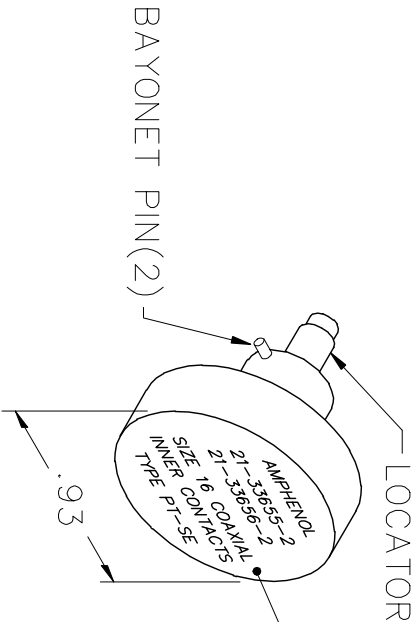
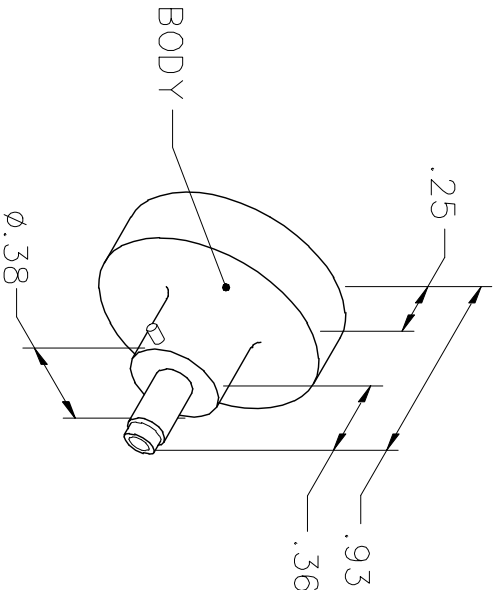

NOTE: FOR USE WITH DANIELS CRIMP TOOLS  
ACCOMMODATING "K" SERIES POSITIONERS

LOCATOR	
HOLE DIMENSIONS	ADDITIONAL FEATURES
∅.038	└┐ ∅.049
∓.580 MIN.	∓.031

<div>RESTRICTED &amp; CONFIDENTIAL</div> <div>CONFIDENTIAL PROPERTY OF DANIELS MANUFACTURING CORP. NOT TO BE DISCLOSED TO OTHERS, REPRODUCED OR USED FOR ANY OTHER PURPOSE, EXCEPT AS AUTHORIZED IN WRITING BY DANIELS MANUFACTURING.</div> <div>MUST BE RETURNED TO DANIELS MANUFACTURING CORP. ON COMPLETION OF ORDER OR OTHER PURPOSE FOR WHICH LENT.</div>	DRN.	A. MOO-YOUNG	DATE	4-19-99
	CHK'D.	RRR	DATE	4-19-99
	APP'D.		DATE	
	APP'D.		DATE	
	NOTE: THIS DRAWING IS AN OUTLINE DRAWING OF THE RESPECTIVE DMC PART NUMBER INDICATED. ACTUAL DMC PART NUMBER IS DRAWING NUMBER WITHOUT THE "-ENV" SUFFIX.			
DO NOT SCALE DRAWING	<div><div><div>DMC</div><div>DMC</div></div><div>DANIELS MANUFACTURING CORP. ORLANDO, FLORIDA CAGE 11851</div></div>			
	TITLE			
	ENVELOPE DRAWING POSITIONER			
	WHERE USED: AFM8			
	SIZE	SCALE	CAD P/N	SHEET
A	NONE	K1283-ENV	1	1
POSTING	DWG. NO.	REV.		
	K1283-ENV	1		

# Mouser Electronics

Authorized Distributor

Click to View Pricing, Inventory, Delivery & Lifecycle Information:

[Daniels Manufacturing:](#)

[K1283](#)