

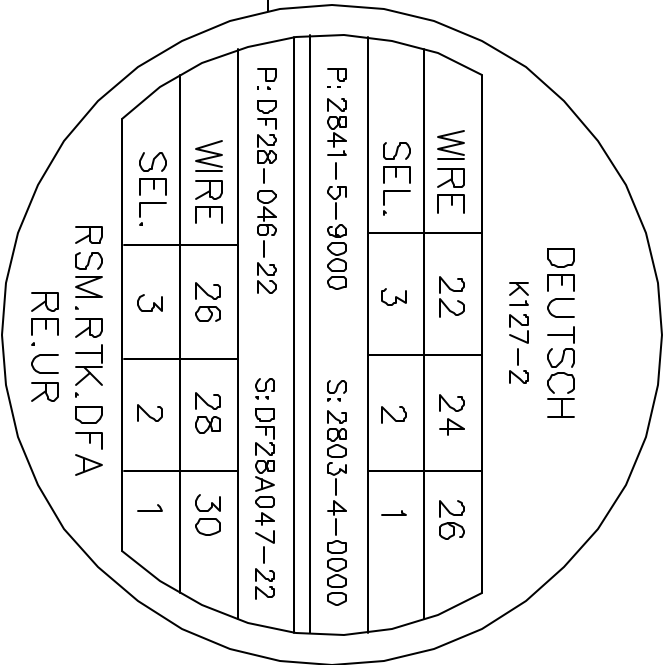

REVISIONS				
REV. SYM.	E.C.O. NUMBER	DESCRIPTION	BY DATE	APP'D DATE
1		ORIGINAL RELEASE	LGV 7-22-91	PD 7-22-91

UNCONTROLLED DOCUMENT  
WILL NOT BE UPDATED

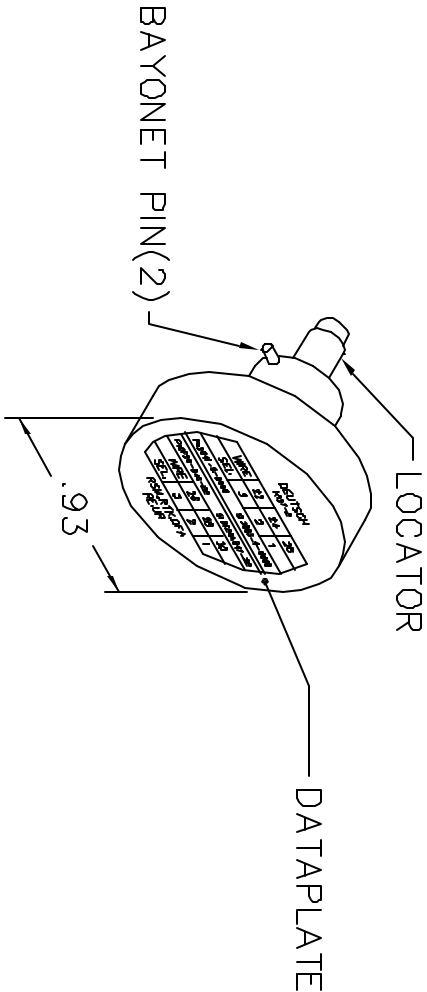
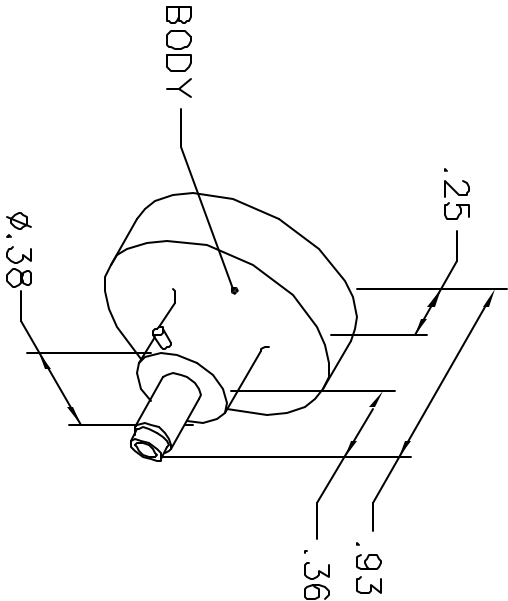

NOTE: FOR USE WITH DANIELS CRIMP TOOL, AFM8.

LOCATOR	
HOLE DIMENSIONS	ADDITIONAL FEATURES
$\varnothing .052$ $\nabla .430$	 $\varnothing .062$ $\nabla .100$

<div> <div>RESTRICTED &amp; CONFIDENTIAL</div> <div>           CONFIDENTIAL PROPERTY OF DANIELS MANUFACTURING CORP. NOT TO BE DISCLOSED TO OTHERS. REPRODUCED OR USED FOR ANY OTHER PURPOSE, EXCEPT AS AUTHORIZED IN WRITING, BY DANIELS MANUFACTURING. MUST BE RETURNED TO DANIELS MANUFACTURING CORP. ON COMPLETION OF ORDER OR OTHER PURPOSE FOR WHICH LENT.         </div> </div>		<div> <div> <div>DRN.</div> <div>LGV</div> <div>DATE 7-22-91</div> </div> <div> <div>CHK'D.</div> <div>PD</div> <div>DATE 7-22-91</div> </div> <div> <div>APP'D.</div> <div>DATE</div> </div> </div>		<div> <div> <div>TITLE</div> <div>ENVELOPE DRAWING POSITIONER</div> </div> <div> <div>WHERE USED: AFM8</div> <div> <div>SIZE A</div> <div>SCALE NTS</div> <div>POSTING</div> </div> </div> </div>		<div> <div> <div>DANIELS MANUFACTURING CORP.</div> <div>ORLANDO, FLORIDA</div> <div>CAGE 11851</div> </div> <div> <div>GAD P/N</div> <div>K127-2-ENV</div> </div> <div> <div>SHEET 1</div> <div>OF 1</div> </div> </div>	
DO NOT SCALE DRAWING				<div> <div>P/N</div> <div>K127-2-ENV</div> </div>		<div> <div>REV.</div> <div>1</div> </div>	

# Mouser Electronics

Authorized Distributor

Click to View Pricing, Inventory, Delivery & Lifecycle Information:

[Daniels Manufacturing:](#)

[K127-2](#)