

REVISIONS				
REV. SYM.	E.C.O. NUMBER	DESCRIPTION	BY DATE	APP'D DATE
1		ORIGINAL RELEASE	AAM 2-19-02	RRR 2-19-02

**UNCONTROLLED DOCUMENT
WILL NOT BE UPDATED**

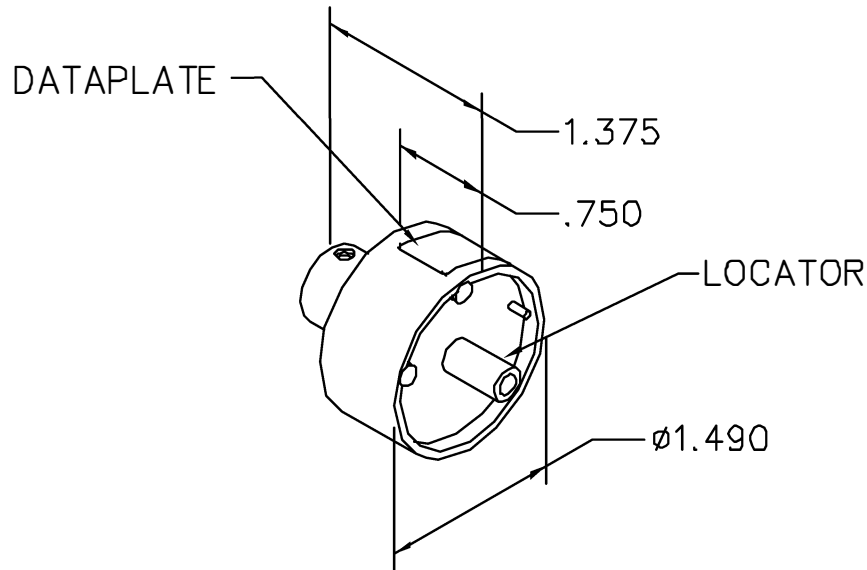

AMPHENOL CORPORATION
21-33628-81 & 21-33621-71
INTERMEDIATE CONTACTS

USE WITH GS212

DATAPLATE

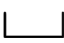
LOCATOR	
HOLE DIMENSIONS	ADDITIONAL FEATURES
Ø.074 ▽1.14 MIN.	 Ø.102 ▽.053

RESTRICTED & CONFIDENTIAL

CONFIDENTIAL PROPERTY OF DANIELS MANUFACTURING CORP. NOT TO BE DISCLOSED TO OTHERS, REPRODUCED OR USED FOR ANY OTHER PURPOSE, EXCEPT AS AUTHORIZED IN WRITING BY DANIELS MANUFACTURING. MUST BE RETURNED TO DANIELS MANUFACTURING CORP. ON COMPLETION OF ORDER OR OTHER PURPOSE FOR WHICH LENT.

DO NOT SCALE DRAWING

DRN. A. MOO-YOUNG	DATE 2-19-02
CHK'D. RRR	DATE 2-19-02
APP'D.	DATE
APP'D.	DATE



DANIELS MANUFACTURING CORP.
ORLANDO, FLORIDA
CAGE 11851

TITLE
**ENVELOPE DRAWING
SINGLE POSITION HEAD**

WHERE USED: GS212

SIZE A	SCALE NTS	GAD P/N GP1437-ENV	SHEET 1	OF 1
POSTING		P/N GP1437-ENV	REV. 1	

Mouser Electronics

Authorized Distributor

Click to View Pricing, Inventory, Delivery & Lifecycle Information:

[Daniels Manufacturing:](#)

[GP1437](#)